

NPS Form 10-900
(Rev. 8-86)

OMB No. 1024-0018

United States Department of the Interior
National Park Service

RECEIVED

**NATIONAL REGISTER OF HISTORIC PLACES
REGISTRATION FORM**

JAN 13 1994

**NATIONAL
REGISTER**

1. Name of Property

Historic Name: NAS Chase Field, Quarters R

Other name/site number: Commanding Officer's Quarters

2. Location

Street & Number: Essex Street, 0.43 miles south-southwest of the intersection of
Texas State Highway 202 and Independence Street

City/Town: Beeville

Not for Publication: N/A

State: TX Code: 041 County: Bee

Code: 025 Zip Code: 78102

3. Classification

Ownership of Property: Public: federal

Category of Property: Building

Number of Resources within Property: 1

Contributing	Noncontributing	
1	0	buildings
0	0	sites
0	0	structures
0	0	objects
1	0	Total

Number of contributing resources previously listed in the National Register: 0

Name of related multiple property listing: Historic and Architectural
Resources of NAS Chase Field,
Beeville, Texas.

4. State/Federal Agency Certification

As the designated authority under the National Historic Preservation Act of 1986, as amended, I hereby certify that this nomination request for determination of eligibility meets the documentation standards for registering properties in the National Register of Historic Places and meets the procedural and professional requirements set forth in 36 CFR Part 60. In my opinion, the property x meets does not meet the National Register Criteria. See continuation sheet

[Signature] 15 Dec. 1993
Signature of certifying official Date

State Historic Preservation Officer, Texas Historical Commission
State or Federal agency and bureau

In my opinion, the property ✓ meets does not meet the National Register criteria. See continuation sheet.

[Signature] January 6, 1994
Signature of commenting or other official Date

Department of the Navy Federal Preservation Officer
State or Federal agency and bureau

5. National Park Service Certification

I, hereby certify that this property is:

- entered in the National Register See continuation sheet.
- determined eligible for the National Register See continuation sheet.
- determined not eligible for the National Register
- removed from the National Register
- other (explain):

[Signature] Entered in the National Register

[Signature] 2/23/94
Signature of Keeper Date of Action

6. Function or Use

Historic: Defense Sub: Naval Facility
Current : Vacant/Not in Use Sub:

7. Description

Architectural Classification: No Style

Materials: foundation: Concrete
walls: Synthetics
roof: Other
other:

Describe present and historic physical appearance.

See continuation sheet.

8. Statement of Significance

Certifying official has considered the significance of this property in relation to other properties:

Applicable National Register Criteria: A

Criteria Considerations (Exceptions): Not Applicable

Areas of Significance: Military

Period(s) of Significance: 1943-1945

Significant Dates: 1943

Significant Person(s): Not Applicable

Cultural Affiliation: Not Applicable

Architect/Builder: Robert & Company/Brown Bellows & Columbia

State significance of property, and justify criteria, criteria considerations, and areas and periods of significance noted above.

See continuation sheet.

9. Major Bibliographical References

See Historic Context List of References.

Previous documentation on file (NPS):

- preliminary determination of individual listing (36 CFR 67) has been requested.
- previously listed in the National Register
- previously determined eligible by the National Register designated a National Historic Landmark
- recorded by Historic American Buildings Survey # HABS No. TX-3397-F
- recorded by Historic American Engineering Record #

Primary Location of Additional Data:

- State historic preservation office
- Other state agency
- Federal agency
- Local government
- University
- Other -- Specify Repository:

10. Geographical Data

Acreeage of Property: less than one acre

UTM References: 14/630920/3139200

Verbal Boundary Description:

The boundary of NAS Chase Field, Quarters R is shown as the dashed line on the accompanying map entitled "NAS Chase Field, Site Plan of Quarters R"

Boundary Justification:

The boundary encompasses Quarters R and the grounds immediately surrounding it that distinguish the historic resource from adjoining property.

11. Form Prepared By

Name/Title: David Moore/Project Director, Historian
 Terri Myers/Historian
 Diana Nicklaus/Research Assistant

Organization: Hardy·Heck·Moore & Associates Date: June 1993
Street & Number: 2112 Rio Grande Telephone: 512-478-8014
City or Town: Austin State: TX Zip: 78705

United States Department of the Interior
National Park Service

NATIONAL REGISTER OF HISTORIC PLACES
CONTINUATION SHEET

Section numbers 7 and 8

Description

Quarters R is a 1-story frame dwelling that was built in 1943 when NAS Chase Field began operations. Used as the quarters for the commanding officer in charge of the naval facility, the building fronts onto Essex Street and is close to the Administrative Building (Building 1001). Quarters R has a modified rectangular plan, with a pier-and-beam foundation, wood-frame construction and galbestos siding. Like most of the World War II-era buildings at the base, Quarters R exhibits no distinctive stylistic ornamentation, but the property is in good condition and its exterior has changed very little since its completion.

The house is located on the southwest side of Essex Street, just west of its intersection with Independence Street. The surrounding lot contains trees and a well-maintained grass lawn with a wooden fence that encloses the back yard. A one-story, wood-frame building with wood and galbestos siding, the house has a modified rectangular plan and a pier-and-beam foundation. The flat roof has extended eaves and a brick interior chimney. The main entrance, facing northeast onto Essex Street, is set within a small, two-bay, integral porch supported by square posts. Most of the windows are double hung with metal sashes and 6/6 lights, although a large, fixed-glass, display window is between the double-hung windows within the front porch. The exterior of the building is virtually unaltered. A small, detached, frame garage stands southwest of the house.

United States Department of the Interior
National Park Service

NATIONAL REGISTER OF HISTORIC PLACES
CONTINUATION SHEET

Section numbers 7 and 8

Statement of Significance

Quarters R, the Commanding Officer's residence, was part of the earliest and most historically significant phase of construction at NAS Chase Field, a World War II-era naval auxiliary air station built near Beeville, Texas. Although the building appears much as it did when it was completed in 1943, Quarters R was one of thousands of temporary buildings constructed at bases across the United States in response to the worldwide military emergency. As such, it lacks architectural distinction. However, as one of only two individual dwellings built at NAS Chase Field during the war era, Quarters R is a rare example of single-family housing at the base from that period. Furthermore, the building's historic and symbolic role as the residence of the base's highest ranking officer adds to its individual merit. Quarters R relates to the historic context, *Chase Field: A World War II Naval Auxiliary Air Station, 1943-1946*, and to the statewide context, *U.S. Military 1919-1945*. Quarters R is nominated to the National Register under Criterion A, at the local level of significance, for its historic associations with the World War II-era naval auxiliary air station.

Like most of the original World War II-era buildings at NAS Chase Field, the Commanding Officer's Quarters was designed by the Atlanta, Georgia-based architectural firm, Robert & Company, and erected by Brown Bellows & Columbia, a consortium of three separate firms operating from offices in Houston. As its name suggests, the building was the residence of the commanding officer who oversaw the operation of NAS Chase Field. The only other base residence that pre-dates 1950 is the nearby Executive Officer's Quarters (Quarters S). As one of only two single-family dwellings built at the naval air station during World War II, the Commanding Officer's Quarters represents an exception to the austerity program for base construction that went into effect in 1942. As such, the building illustrates the esteem granted to the commanding officer.

During the 1950s, the Navy commissioned the construction of single-family officers' quarters near the main entrance at the north of the base but Quarters R remained the Commanding Officer's residence until the base closed in 1993. Minor alterations, including partial enclosure of the front porch, detract minimally from the building's overall historic character. With its historic integrity largely intact, the building appears much as it did when it was first completed and offers a glimpse of the type of residence that the Navy provided its most important officer at the naval auxiliary air station. Its significance lies primarily in its historic and symbolic associations with the original World War II period of construction at NAS Chase Field.

NAS Chase Field, Site Plan of Quarters R

----- Boundaries

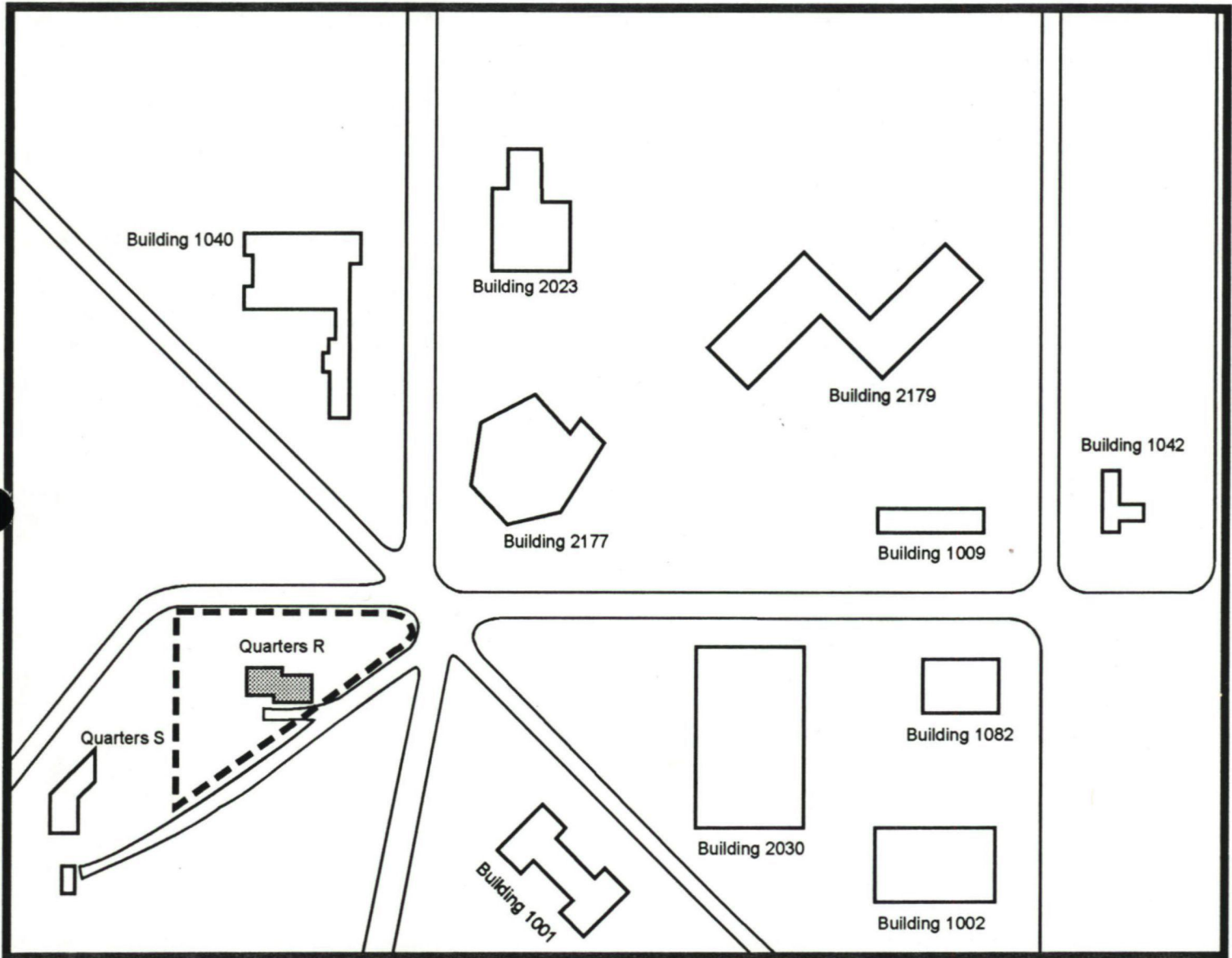

HMM & Associates, June 1993

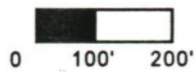

UNITED STATES DEPARTMENT OF THE INTERIOR
NATIONAL PARK SERVICE

NATIONAL REGISTER OF HISTORIC PLACES
EVALUATION/RETURN SHEET

REQUESTED ACTION: NOMINATION

PROPERTY NAME: NAS Chase Field--Quarters R

MULTIPLE NAME: NAS Chase Field MPS

STATE & COUNTY: TEXAS, Bee

DATE RECEIVED: 1/13/94 DATE OF PENDING LIST: 1/26/94
DATE OF 16TH DAY: 2/11/94 DATE OF 45TH DAY: 2/27/94
DATE OF WEEKLY LIST:

REFERENCE NUMBER: 94000055

NOMINATOR: STATE

REASONS FOR REVIEW:

APPEAL: N DATA PROBLEM: N LANDSCAPE: N LESS THAN 50 YEARS: N
OTHER: N PDIL: N PERIOD: N PROGRAM UNAPPROVED: N
REQUEST: N SAMPLE: N SLR DRAFT: N NATIONAL: N

COMMENT WAIVER: N

ACCEPT RETURN REJECT 2/23/94 DATE

Entered in the
National Register

ABSTRACT/SUMMARY COMMENTS:

RECOM./CRITERIA _____
REVIEWER _____
DISCIPLINE _____
DATE _____

DOCUMENTATION see attached comments Y/N see attached SLR Y/N

CLASSIFICATION

count resource type

STATE/FEDERAL AGENCY CERTIFICATION

FUNCTION

historic current

DESCRIPTION

architectural classification
 materials
 descriptive text

SIGNIFICANCE

Period Areas of Significance--Check and justify below

Specific dates Builder/Architect
Statement of Significance (in one paragraph)

summary paragraph
 completeness
 clarity
 applicable criteria
 justification of areas checked
 relating significance to the resource
 context
 relationship of integrity to significance
 justification of exception
 other

BIBLIOGRAPHY

GEOGRAPHICAL DATA

acreage verbal boundary description
 UTM's boundary justification

ACCOMPANYING DOCUMENTATION/PRESENTATION

sketch maps USGS maps photographs presentation

OTHER COMMENTS

Questions concerning this nomination may be directed to

_____ Phone _____

Signed _____ Date _____



NAME OF PROPERTY: QUARTERS R

LOCATION: ESSEX STREET

NAS CHASE FIELD, BEEVILLE, TEXAS

PHOTO BY: DANIEL HARDY

DATE OF PHOTOGRAPH: JUNE 1992

LOCATION OF NEGATIVE: TEXAS HIST. COMMISSION
AUSTIN, TEXAS

CAMERA LOOKING: NORTHEAST

PHOTOGRAPH: 11 OF 14



NAME OF PROPERTY: QUARTERS R

LOCATION: ESSEX STREET

NAS CHASE FIELD, BEEVILLE, TEXAS

PHOTO BY: DANIEL HARDY

DATE OF PHOTOGRAPH: JUNE 1992

LOCATION OF NEGATIVE: TEXAS HIST. COMMISSION

AUSTIN, TEXAS

CAMERA LOOKING: WEST

PHOTOGRAPH: 12 OF 14