

United States Department of the Interior  
National Park Service

RECEIVED  
MAY 06 1991

NATIONAL REGISTER

National Register of Historic Places  
Registration Form

This form is for use in nominating or requesting determinations of eligibility for individual properties or districts. See instructions in *Guidelines for Completing National Register Forms* (National Register Bulletin 16). Complete each item by marking "x" in the appropriate box or by entering the requested information. If an item does not apply to the property being documented, enter "N/A" for "not applicable." For functions, styles, materials, and areas of significance, enter only the categories and subcategories listed in the instructions. For additional space use continuation sheets (Form 10-900a). Type all entries.

1. Name of Property

historic name: Burton High School  
other names/site number: Site No. 2

2. Location

street & number: Main Street  
city, town: Burton  
state: Texas code: TX county: Washington code: 477  
zip code: 77835  
N/A not for publication  
N/A vicinity

3. Classification

Ownership of Property	Category of Property	Number of Resources within Property	
		Contributing	Noncontributing
<input type="checkbox"/> private	<input checked="" type="checkbox"/> building(s)	<u>1</u>	<u>3</u> buildings
<input checked="" type="checkbox"/> public-local	<input type="checkbox"/> district	<u>0</u>	<u>0</u> sites
<input type="checkbox"/> public-State	<input type="checkbox"/> site	<u>0</u>	<u>0</u> structures
<input type="checkbox"/> public-Federal	<input type="checkbox"/> structure	<u>0</u>	<u>0</u> objects
	<input type="checkbox"/> object	<u>1</u>	<u>3</u> Total

Name of related multiple property listing: Historic and Architectural Resources of  
Number of contributing resources previously listed in the National Register 0

4. State/Federal Agency Certification Burton, Texas

As the designated authority under the National Historic Preservation Act of 1966, as amended, I hereby certify that this  nomination  request for determination of eligibility meets the documentation standards for registering properties in the National Register of Historic Places and meets the procedural and professional requirements set forth in 36 CFR Part 60. In my opinion, the property  meets  does not meet the National Register criteria.  See continuation sheet.

[Signature] April 30, 1991  
Signature of certifying official Date  
State Historic Preservation Officer, Texas Historical Commission  
State or Federal agency and bureau

In my opinion, the property  meets  does not meet the National Register criteria.  See continuation sheet.

\_\_\_\_\_  
Signature of commenting or other official Date  
\_\_\_\_\_  
State or Federal agency and bureau

5. National Park Service Certification

I hereby certify that this property is:  
 entered in the National Register.

See continuation sheet.  
 determined eligible for the National Register. See continuation sheet.  
 determined not eligible for the National Register.

removed from the National Register.  
 other, (explain): \_\_\_\_\_

entered in the National Register  
[Signature] 6/11/91  
\_\_\_\_\_  
\_\_\_\_\_  
[Signature] Signature of the Keeper Date of Action

---

**6. Function or Use**

Historic Functions (enter categories from instructions):

Education/School

Current Functions (enter categories from instructions):

Education/School

---

**7. Description**

Architectural Classification

(enter categories from instructions):

International Style

Other: Rustic Style

Material (enter categories from instructions):

foundation: Concrete

walls: Masonry, plaster

roof: Asphalt

other: Cinder block (concrete)

---

Describe present and historic physical appearance.

 See continuation sheet

---

**8. Statement of Significance**

Certifying official has considered the significance of this property in relation to other properties:

 nationally  statewide  locallyApplicable National Register Criteria A B C DCriteria Considerations (Exceptions) A B C D E F G N/A

Areas of Significance (enter categories from instructions):

Architecture

Education

Period of Significance:

1938-1941

Significant Dates:

1938-1940

Cultural Affiliation:

N/A

Significant Person:

N/A

Architect/Builder:

Travis Broesche

Will H. Weeren

Rudi Rosenbaum

---

State significance of property, and justify criteria, criteria considerations, and areas and periods of significance noted above.

 See continuation sheet

LANCASTER BOND

**United States Department of the Interior  
National Park Service**

**National Register of Historic Places  
Continuation Sheet**

Section number   7   Page   1  

---

Among the largest buildings in Burton, the 1938-1940 Burton High School is conspicuous for its scale, materials and use of motifs associated with the Rustic and International Styles. Constructed with locally available building materials in the traditions of the Rustic Style, the Burton High School combines a native field stone veneer with metal factory-sash and massing reminiscent of the International Style. Ranging from 1 1/2 to 2 stories, the structure is composed of geometric building blocks expressive of different functions housed within.

---

On a large parcel of land on Main Street at the northern edge of town, the Burton High School exhibits an asymmetrical rectangular plan. A central 2-story main block is intersected by a 1 1/2-story wing on the south. Both are faced with variegated local stone and capped with flat roofs. A curved wall and cantilevered awning emphasize the main entrance. Pierced by an oculus, the curved wall provides a visual transition between blocks. A 3-story tower with hipped roof enlivens the composition by providing a vertical thrust in contrast to the horizontality of the main blocks.

The 2-story main block exhibits multipaned casement windows arranged symmetrically in two tiers above and alongside the main entrance. The southern wing features five multipaned windows separated by vertical cement dividers. Above each casement window is cement infill. A series of tripartite casement windows runs across the north elevation. A modern (1964) 1-story cinder block addition has been attached to the northeast corner of the building.

Three Noncontributing buildings occur at the rear of the lot, including a modern metal building with a shed roof, a 1-story cinder block restroom with a flat roof, and a 2-part, 1-story classroom building comprised of a brick-veneered quonset hut joined with a 1-story brick-veneered addition.

United States Department of the Interior  
National Park Service

# National Register of Historic Places Continuation Sheet

Section number 7 Page 2

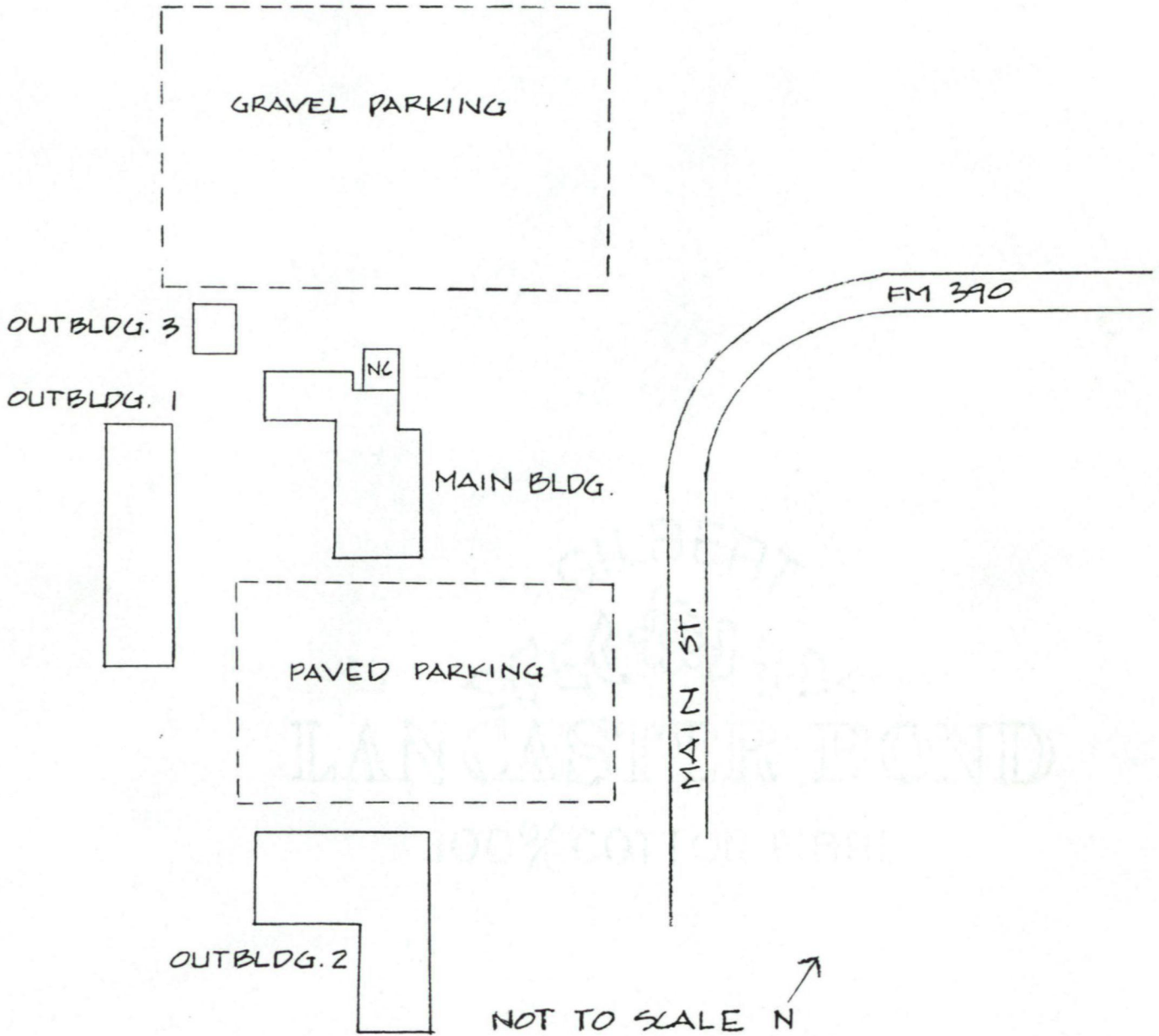

NOT TO SCALE N

BURTON HIGH SCHOOL

United States Department of the Interior  
National Park Service

## National Register of Historic Places Continuation Sheet

Section number 8 Page 1

---

The Burton High School, built 1938-1940, equals the Burton Farmers Gin as one of the most significant buildings in Burton's architectural landscape. It is nominated under Criterion C as a construction project of the Works Progress Administration, unique in Burton (and rare in the county) for its combination of design elements inspired by the Rustic and International Styles. It is also eligible for nomination under Criterion A as the site of secondary education for students from Burton and surrounding communities, thereby enhancing Burton's status as the focus of western agrarian Washington County.

---

In 1938, construction began of the first school designed exclusively for high school students in Burton. It was funded by the federal Works Progress Administration, and was constructed under the direction of local builders Rudie Rosenbaum and Will Weeren. The high school culminated decades of public and private effort to fulfill the state mandate for educating the children of western Washington County.

In 1874, Burton land was deeded to F. Van Draiss, superintendent of public instruction, to construct public schools for local students. The Burton Free School for white students was erected by the mid 1870s in the residential area east of Burton's commercial main street. By 1878, a school for black students was situated south of the present Highway 290 underpass on the corner of Branch and Brazos Streets.

In 1900, a private school was established on Main Street. Organized and funded by local farmers, the school provided instruction through the eighth grade until 1914. In that year its supporters joined with the Burton Free School and the Washington County School District #22 to purchase land for a new public school. Also built in the residential section east of Main Street, it provided nine grades of instruction. Beginning in 1926, Burton area students above the ninth grade traveled to Brenham to finish high school and achieve a diploma.

In 1938, construction began on a new facility to provide area students a high school curriculum. With its completion and opening in 1940, Burton students for the first time could attend high school and graduate from a local school. The school is therefore nominated under Criterion A as it reinforced the town's role, within the sphere of education, as a focus of the agrarian community in western Washington County.

The Burton High School is a local landmark example of a WPA project combining the Rustic Style with massing and materials more typical of the International Style. Use of local stone and emphasis on horizontality are common features of Rustic architecture. Blocky, geometric, stark lines and massing drawn from the International Style create a bold, fresh and

United States Department of the Interior  
National Park ServiceNational Register of Historic Places  
Continuation SheetSection number 8 Page 2

unique design component within Burton. Combining features such as metal factory sash and concrete design elements with native stone facing and red brick detailing leads to an interesting synthesis of two seemingly diametric styles. This approach marks other examples of labor-intensive New Deal era projects in Washington County, including the Brenham High School Gymnasium (NR 1990), but is unique in Burton. The building's design and physical prominence in an architectural landscape dominated by vernacular building traditions qualify it for nomination under Criterion C.

Construction of the school was supervised by Will H. Weeren (1885-1976) and his protege' Rudie Rosenbaum. Although little is known about the architect of record, Travis Broesche, Weeren was a prolific local builder who made significant contributions to Burton's built environment. Born of a family German immigrants that established Burton's first bank, Weeren was a builder, carpenter, and wood carver. He also was co-owner during the 1920s and 1930s of the Homeyer Lumber Company (District Site No. 1), the only lumberyard in town.

Weeren's productive building period embraces the years between about 1905 and 1940. The ready availability of plan and pattern books during this period probably facilitated the range of domestic, industrial, and public projects Weeren is associated with in Burton. Weeren adeptly built small, square-plan, pyramidal-roofed dwellings like the Awalt Wehring House (c. 1910), as well as many dwellings using vernacular forms combined with bungalow techniques and motifs. He built numerous Craftsman-inspired and simpler bungalows, like the Schultz House and Rosenaum House (1913). Weeren also constructed dwellings with a hint of Prairie School influence, such as the Hons Ehlert and Wilkening Houses, and he used the Tudor Revival Style, as demonstrated by the Herbert Nienstedt House (Individual Site No. 9). He erected the Burton Farmers Gin in 1914 with his brother.

As Burton's reporter to the Brenham Banner Press in the 1930s, Weeren wrote under the appropriate moniker "Sawdust Bill." He contributed social news and commemorative pieces on Burton's older residents, as well as articles on Burton's historic buildings. Through such articles, Weeren documented 19th century building practices in Burton.

Weeren's building activities and his community activities--about 1915 he brought boy scouting to Burton and served as troop leader for years--lent him prominence in Burton. Built toward the end of an active career, the Burton High School is prominent for its scale, materials, and stylistic allusions. It exhibits Weeren's flexibility with new materials, new design ideas, and his sustained contribution to Burton's built environment for much of the first half of the 20th century.

## 9. Major Bibliographical References

See continuation sheet

See Bibliography of Context Statement.

Previous documentation on file (NPS): N/A  
 preliminary determination of individual listing  
(36 CFR 67) has been requested  
 previously listed in the National Register  
 previously determined eligible by the National Register  
 designated a National Historic Landmark  
 recorded by Historic American Buildings  
Survey #  
 recorded by Historic American Engineering  
Record #

Primary location of additional data:  
 State historic preservation office  
 Other State agency  
 Federal agency  
 Local government  
 University  
 Other

Specify repository:

Texas Historical Commission, Austin, TX

## 10. Geographical Data

Acreage of property: less than one acre

UTM References:

A 1/4 / 731/260 334 1420  
Zone Easting Northing

C / / / / /  
Zone Easting Northing

B / / / / /  
Zone Easting Northing

D / / / / /  
Zone Easting Northing

See continuation sheet

Verbal Boundary Description: City of Burton. V 5-8

See continuation sheet

Boundary Justification: Boundaries are those historically associated with the property.

See continuation sheet

## 11. Form Prepared By (with Bruce Jensen, Architectural

name/title: Julie Strong Historian, THC)  
organization: for the Burton Heritage Society  
street & number: 4105 Duval Street  
city or town: Austin

date: July 1989; April 1991  
telephone: 512/454-0145  
state: TX zip code: 78751

5/6/91

United States Department of the Interior  
National Park Service

National Register of Historic Places  
Continuation Sheet

Section number \_\_\_\_\_ Page \_\_\_\_\_

Burton MPS

Washington County, TEXAS

		Date Listed
COVER	<del>Substantive Review</del>	6/11/91
1. Burton Commercial Historic District	<del>Substantive Review</del>	6/11/91
2. Burton Farmers Gin	<del>Substantive Review</del>	6/11/91
3. Burton High School	<del>Entered in the National Register</del>	6/11/91
4. Hodge Drugstore	<del>Substantive Review</del>	6/11/91
5. Kneip--Bredthauer House	<del>Entered in the National Register</del>	6/11/91
6. Laas, Dr. Charles, House	<del>Substantive Review</del>	6/11/91
7. Neumann, William, House	<del>Substantive Review</del>	6/18/91
8. Nienstedt, Herbert, House	<del>Entered in the National Register</del>	6/11/91
9. Nienstedt, William, House	<del>Substantive Review</del>	6/11/91
10. Sanders, William Edward, House	<del>Entered in the National Register</del>	6/11/91
11. Wehring Shoe Shop and Residence	<del>Substantive Review</del>	6/11/91



UNITED STATES DEPARTMENT OF THE INTERIOR  
NATIONAL PARK SERVICE

NATIONAL REGISTER OF HISTORIC PLACES  
EVALUATION/RETURN SHEET

REQUESTED ACTION: NOMINATION

PROPERTY NAME: Burton High School

MULTIPLE NAME: Burton MPS

STATE & COUNTY: TEXAS, Washington

DATE RECEIVED: 5/06/91 DATE OF PENDING LIST: 5/22/91  
DATE OF 16TH DAY: 6/07/91 DATE OF 45TH DAY: 6/20/91  
DATE OF WEEKLY LIST:

REFERENCE NUMBER: 91000711

NOMINATOR: STATE

REASONS FOR REVIEW:

APPEAL: N DATA PROBLEM: N LANDSCAPE: N LESS THAN 50 YEARS: N  
OTHER: N PDIL: N PERIOD: N PROGRAM UNAPPROVED: N  
REQUEST: N SAMPLE: N SLR DRAFT: N NATIONAL: N

COMMENT WAIVER: N

ACCEPT  RETURN  REJECT 6/11/91 DATE

Entered in the  
National Register

ABSTRACT/SUMMARY COMMENTS:

RECOM./CRITERIA \_\_\_\_\_  
REVIEWER \_\_\_\_\_  
DISCIPLINE \_\_\_\_\_  
DATE \_\_\_\_\_

DOCUMENTATION see attached comments Y/N see attached SLR Y/N

---

CLASSIFICATION

count       resource type

---

STATE/FEDERAL AGENCY CERTIFICATION

---

FUNCTION

historic       current

---

DESCRIPTION

architectural classification  
 materials  
 descriptive text

---

SIGNIFICANCE

Period      Areas of Significance--Check and justify below

Specific dates      Builder/Architect  
Statement of Significance (in one paragraph)

summary paragraph  
 completeness  
 clarity  
 applicable criteria  
 justification of areas checked  
 relating significance to the resource  
 context  
 relationship of integrity to significance  
 justification of exception  
 other

---

BIBLIOGRAPHY

---

GEOGRAPHICAL DATA

acreage       verbal boundary description  
 UTM's       boundary justification

---

ACCOMPANYING DOCUMENTATION/PRESENTATION

sketch maps     USGS maps     photographs     presentation

---

OTHER COMMENTS

Questions concerning this nomination may be directed to

\_\_\_\_\_ Phone \_\_\_\_\_

Signed \_\_\_\_\_ Date \_\_\_\_\_



BURTON HIGH SCHOOL (SITE #2)  
BURTON, TEXAS

Washington &

JULIE STRONG

JULY 1989

NEGATIVE ON FILE - TEXAS HISTORICAL COMMISSION

CAMERA FACING SOUTH

*Burton High School*  
PHOTO 10 OF 18

Please refer to the map in the  
Multiple Property Cover Sheet  
for this property

Multiple Property Cover Sheet Reference Number: 64500629