

AUG 24 1987

United States Department of the Interior  
National Park Service

National Register of Historic Places  
Continuation Sheet

Section number all Page 39

TEXAS HISTORIC SITES INVENTORY FORM — TEXAS HISTORICAL COMMISSION (rev.8-82)

1. County COLLIN COD  
MK 5. USGS Quad No. 3396-214 Site No. 497  
City/Rural MCKINNEY UTM Sector 722-3675
2. Name HILL-WEBB GRAIN ELEVATOR 6. Date: Factual 1906/c.1920 Est. \_\_\_\_\_  
Address 400 E LOUISIANA 7. Architect/Builder Unknown  
Contractor Unknown
3. Owner Shelton Feed Co. 8. Style/Type \_\_\_\_\_  
Address 400 E. Louisiana, 75069 9. Original Use industrial - grain elevator
4. Block/Lot Andrew/Blk 1/Lots 1, 2A, 2B Present Use industrial - feed mill
10. Description Industrial complex that includes a 4-story grain elevator, 3 ware-  
houses, an office building and a feed store. The grain elevator is of frame  
construction but has sheet-metal cladding. The brick office building has  
a hip roof and double-hung windows. The oldest warehouses are on the southern
11. Present Condition fair
12. Significance COMMERCE: This facility has been in operation since 1906 and has been  
known as the Hill-Webb Elevator Co. or the McKinney Elevator Co. It originally  
functioned as a grain elevator, but by the late 1930s, it had been converted
13. Relationship to Site: Moved Date \_\_\_\_\_ or Original Site \*(describe) in an industrial area just  
east of the CBD; located near railroad tracks
14. Bibliography Tax Rolls, Sanborn Maps 15. Informant \_\_\_\_\_  
City Directories 16. Recorder Hardy-Heck-Moore Date July 1985

DESIGNATIONS

PHOTO DATA

TNRIS No. \_\_\_\_\_ Old THC Code \_\_\_\_\_  
 RTHL  HABS (no.) TEX \_\_\_\_\_  
 NR:  \*Individual  Historic District  
 Thematic  Multiple-Resource  
 NR File Name McKinney M-R Nomination  
 Other \_\_\_\_\_

B&W 4x5s \_\_\_\_\_ Slides 6  
 35mm Negs

YEAR	DRWR	ROLL	FRME		ROLL	FRME
		25	26	to	25	27
		76	12A	to	76	19A
				to		

CONTINUATION PAGE

No. 2 of 2

TEXAS HISTORIC SITES INVENTORY FORM — TEXAS HISTORICAL COMMISSION (rev.8-82)

1. County COLLIN COD  
MK 5. USGS Quad No. 3396-214 Site No. 497  
City/Rural MCKINNEY UTM Pt. 14/722B40/3675420
2. Name HILL-WEBB GRAIN ELEVATOR Acreage approximately 3 acres

Description continued: end of the lot and feature frame construction with corrugated-metal siding. The third warehouse resembles the other warehouses but has a second-story mid-section. A gable-roofed feed store of frame construction stands at the NE corner. The attached site plan indicates the estimated dates of construction and the physical relationships of the buildings. All of the structures are classified as contributing elements and were built prior to 1937. All are virtually unaltered & retain their historic integrity. Significance continued: into a feed mill. Its continued operation demonstrates the importance of agricultural production and processing to the community. It is the only historic feed mill in operation in McKinney.

United States Department of the Interior  
National Park Service

# National Register of Historic Places Continuation Sheet

Section number all Page 40

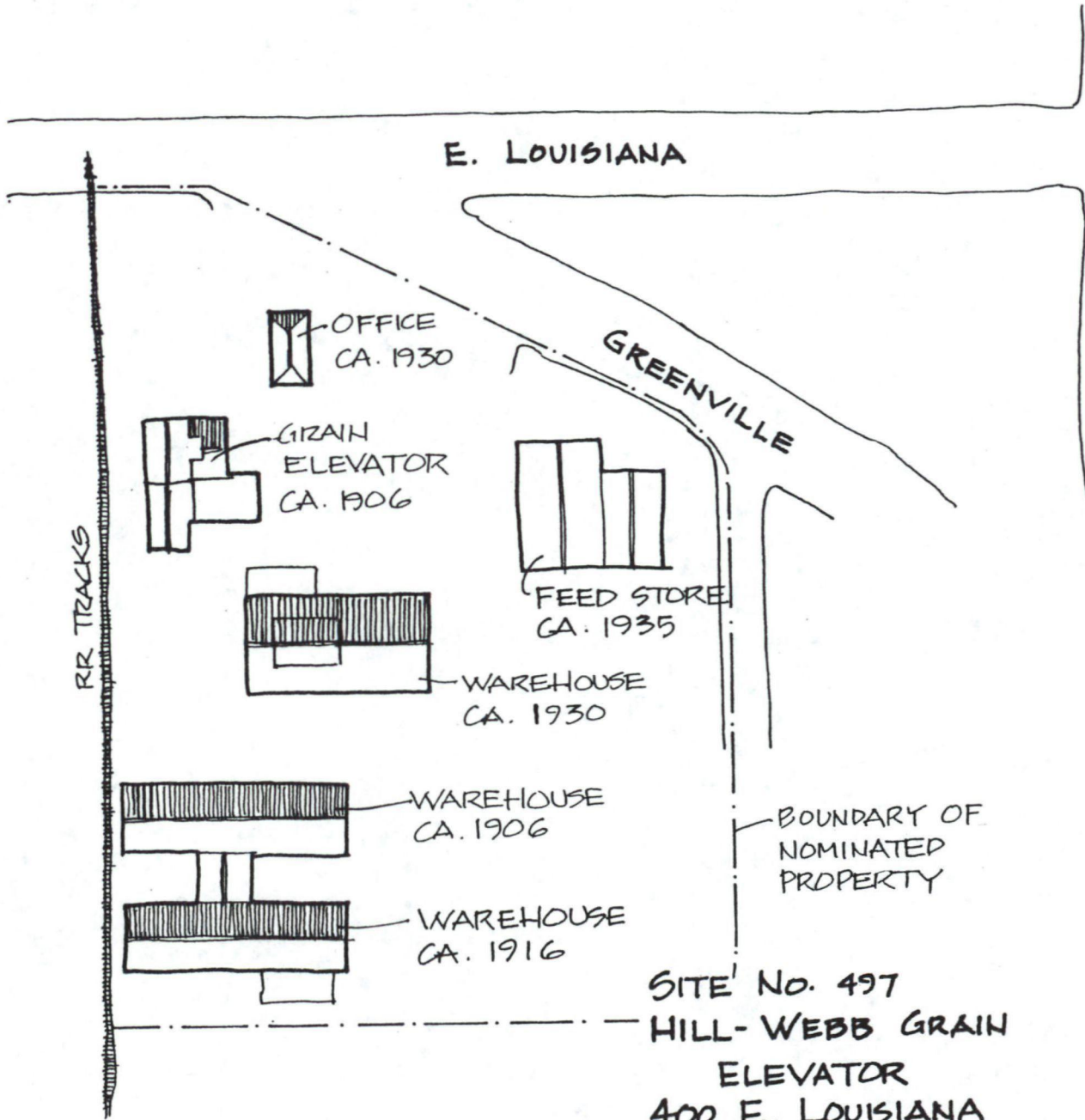

SITE No. 497  
HILL-WEBB GRAIN  
ELEVATOR  
400 E. LOUISIANA  
MCKINNEY, TEXAS

SCALE: 1" = APPX. 100'





United States Department of the Interior  
National Park Service

National Register of Historic Places  
Continuation Sheet

Section number \_\_\_\_\_ Page \_\_\_\_\_

Multiple Resource Area  
Thematic Group

Name McKinney MPS  
State Collin County, TEXAS

Nomination/Type of Review

Date/Signature

- 21. Fox, S.H., House Entered in the  
National Register *for* Keeper *Alouise Byers 10/8/87*  
Attest \_\_\_\_\_
- ✓ 22. Gouch-Hughston House Substantive Review Keeper *ret Patrick Andrus 6/27/88* S  
Attest \_\_\_\_\_
- 23. Heard-Craig House Entered in the  
National Register *for* Keeper *Alouise Byers 10/8/87*  
Attest \_\_\_\_\_
- 24. Hill, Ben, House Substantive Review *for* Keeper *Patrick Andrus 10/8/87*  
Attest \_\_\_\_\_
- 25. Hill, John B., House Entered in the  
National Register *for* Keeper *Alouise Byers 10/8/87*  
Attest \_\_\_\_\_
- 26. Hill, Moran, House Substantive Review *for* Keeper *Patrick Andrus 10/8/87*  
Attest \_\_\_\_\_
- 27. Hill, W.R., House Entered in the  
National Register *for* Keeper *Alouise Byers 10/8/87*  
Attest \_\_\_\_\_
- 28. Hill-Webb Grain Elevator Substantive Review *for* Keeper *Patrick Andrus 10/8/87*  
Attest \_\_\_\_\_
- 29. House at 1303 W. Louisiana Entered in the  
National Register *for* Keeper *Alouise Byers 10/8/87*  
Attest \_\_\_\_\_
- 30. House at 201 N. Graves Substantive Review *for* Keeper *Patrick Andrus 10/8/87*  
Attest \_\_\_\_\_



87001716

NATIONAL REGISTER OF HISTORIC PLACES  
EVALUATION/RETURN SHEET

Hill-Webb Grain Elevator (McKinney MPS)  
Collin County  
TEXAS

*substantive Review*

AUG 24 1987

Working No. \_\_\_\_\_

Fed. Reg. Date: 2/7/89

Date Due: 9/25/87 - 10/8/87

Action:  ACCEPT 10-8-87

RETURN \_\_\_\_\_

REJECT \_\_\_\_\_

Federal Agency: \_\_\_\_\_

- resubmission
- nomination by person or local government
- owner objection
- appeal

Substantive Review:  sample  request  appeal  NR decision

Reviewer's comments: *Significant for commerce as a representative example of the prominent role of grain processing and storage in the local economy. Significance was not well justified on the individual form, but this was one of the few cases where the cover form provided property specific details which helped justify the significance of an individual property. Additional photos of contributing structures would have made it easier to evaluate*

Recom./Criteria Accept - A

Reviewer Noble

Discipline Historian

Date 10/8/87

\_\_\_\_\_ see continuation sheet

Nomination returned for: \_\_\_\_\_ technical corrections cited below this property.  
\_\_\_\_\_ substantive reasons discussed below

1. Name \_\_\_\_\_

2. Location \_\_\_\_\_

3. Classification \_\_\_\_\_

Category	Ownership	Status	Present Use
	Public Acquisition	Accessible	

4. Owner of Property \_\_\_\_\_

5. Location of Legal Description \_\_\_\_\_

6. Representation in Existing Surveys

Has this property been determined eligible?  yes  no

7. Description \_\_\_\_\_

Condition	Check one	Check one
<input type="checkbox"/> excellent	<input type="checkbox"/> deteriorated	<input type="checkbox"/> original site
<input type="checkbox"/> good	<input type="checkbox"/> ruins	<input type="checkbox"/> moved date _____
<input type="checkbox"/> fair	<input type="checkbox"/> unexposed	
	<input type="checkbox"/> unaltered	
	<input type="checkbox"/> altered	

Describe the present and original (if known) physical appearance

- summary paragraph
- completeness
- clarity
- alterations/integrity
- dates
- boundary selection



---

**8. Significance**

Period \_\_\_\_\_ Areas of Significance—Check and justify below

Specific dates \_\_\_\_\_ Builder/Architect \_\_\_\_\_  
Statement of Significance (*in one paragraph*)

- summary paragraph
- completeness
- clarity
- applicable criteria
- justification of areas checked
- relating significance to the resource
- context
- relationship of integrity to significance
- justification of exception
- other

---

**9. Major Bibliographical References**

---

**10. Geographical Data**

Acreege of nominated property \_\_\_\_\_

Quadrangle name \_\_\_\_\_

UTM References \_\_\_\_\_

---

Verbal boundary description and justification

---

**11. Form Prepared By**

---

**12. State Historic Preservation Officer Certification**

The evaluated significance of this property within the state is:

\_\_\_\_ national      \_\_\_\_ state      \_\_\_\_ local

State Historic Preservation Officer signature

title \_\_\_\_\_ date \_\_\_\_\_

---

**13. Other**

- Maps
- Photographs
- Other

Questions concerning this nomination may be directed to \_\_\_\_\_

Signed \_\_\_\_\_ Date \_\_\_\_\_ Phone: \_\_\_\_\_





"Historic Resources of McKinney, Texas" Multiple-  
Resource Nomination; city limits of McKinney,  
Collin County, Texas.

Photo: Hardy-Heck-Moore, Inc.; 1985; negative  
with Texas Historical Commission, Austin.

Subject: Hill-Webb Grain Elevator, Site No. 497  
400 E. Louisiana

View: Camera looking southwest

Photo 29 of 83

Please refer to the map in the  
Multiple Property Cover Sheet  
for this property

Multiple Property Cover Sheet Reference Number: 64500643