

United States Department of the Interior
National Park ServiceNational Register of Historic Places
Inventory—Nomination Form

For NPS use only

received *SP/ML*

date entered

SEP 25 1987

Continuation sheet

Item number all

Page 4

TEXAS HISTORIC SITES INVENTORY FORM—TEXAS HISTORICAL COMMISSION (rev.8-82)

1. County Brazos BRA
City/Rural Bryan BR
2. Name St. Andrew's Episcopal Church
Address 217 W 26TH
3. Owner St. Andrew's Episcopal Church
Address c/o Romilly Thomas/ 217 W. 26th
4. Block/Lot OTS/Blk 118/Lot 7
5. USGS Quad No. 3096-424 Site No. 1417
UTM Sector _____
6. Date: Factual 1914/1920 Est. _____
7. Architect/Builder Unknown
Contractor _____
8. Style/Type Gothic Revival church
9. Original Use religious - church
Present Use religious - church
10. Description 2-story, load-bearing, masonry, church complex w/ cruciform plan;
exterior walls of buff brick; gable roof w/ composition roof; 3-bay facade;
buttresses separate bays; double-door lancet-arched entrance; lancet arched
windows w/ stone lintels; wood-sash windows w/ stained glass and tracery
11. Present Condition good; non-contiguous commercial bldg. attached on E. elev.; spire removed
12. Significance George D. Haswell led others in organizing St. Andrew's parish following
its move to Bryan in 1867 from nearby Millican. The current Gothic Revival
sanctuary was built in 1914 and the parish hall added in 1920, making it
13. Relationship to Site: Moved Date _____ or Original Site *(describe) at the western edge of
the commercial district across the street from the old U.S. Post Office
14. Bibliography Tax Rolls, Sanborn Maps
City Directory (RDS)
15. Informant _____
16. Recorder Hardy-Heck-Moore Date July 1986

DESIGNATIONS

PHOTO DATA

TNRIS No. _____ Old THC Code _____

B&W 4x5s _____ Slides 7NR: ☐ RTHL ☐ HABS (no.) TEX _____

35mm Negs

☐ *Individual ☐ Historic District

YEAR DRWR ROLL FRME

☐ Thematic ☐ Multiple-Resource

		6	12
		94	8

NR File Name _____

		94	19

Other _____

to

to

to

CONTINUATION PAGE

No. 2 of 2

TEXAS HISTORIC SITES INVENTORY FORM—TEXAS HISTORICAL COMMISSION (rev.8-82)

1. County Brazos BRA
City/Rural Bryan BR
2. Name St. Andrew's Episcopal Church
5. USGS Quad No. 3096-424 Site No. 1417
UTM Pt. 14/751520/3396180
Acreage less than one acre

Description continued: brick parapet w/ stone coping; limestone detailing articulates Gothic Revival style lancet-arched windows, doors and buttresses; classroom wing has similar detailing but with flat-arched fenestration.

Significance continued: the oldest church facility in continuous use in Bryan. Property being nominated includes only the sanctuary and the parish hall. The converted commercial building (used as an education wing) is not included.

Area of Significance: ARCHITECTURE.

Historic Name: St. Andrew's Episcopal Church and Parish Hall

United States Department of the Interior
National Park Service

National Register of Historic Places
Inventory—Nomination Form

For NPS use only

received

date entered

8/20/87

Continuation sheet

Item number all

Page 5

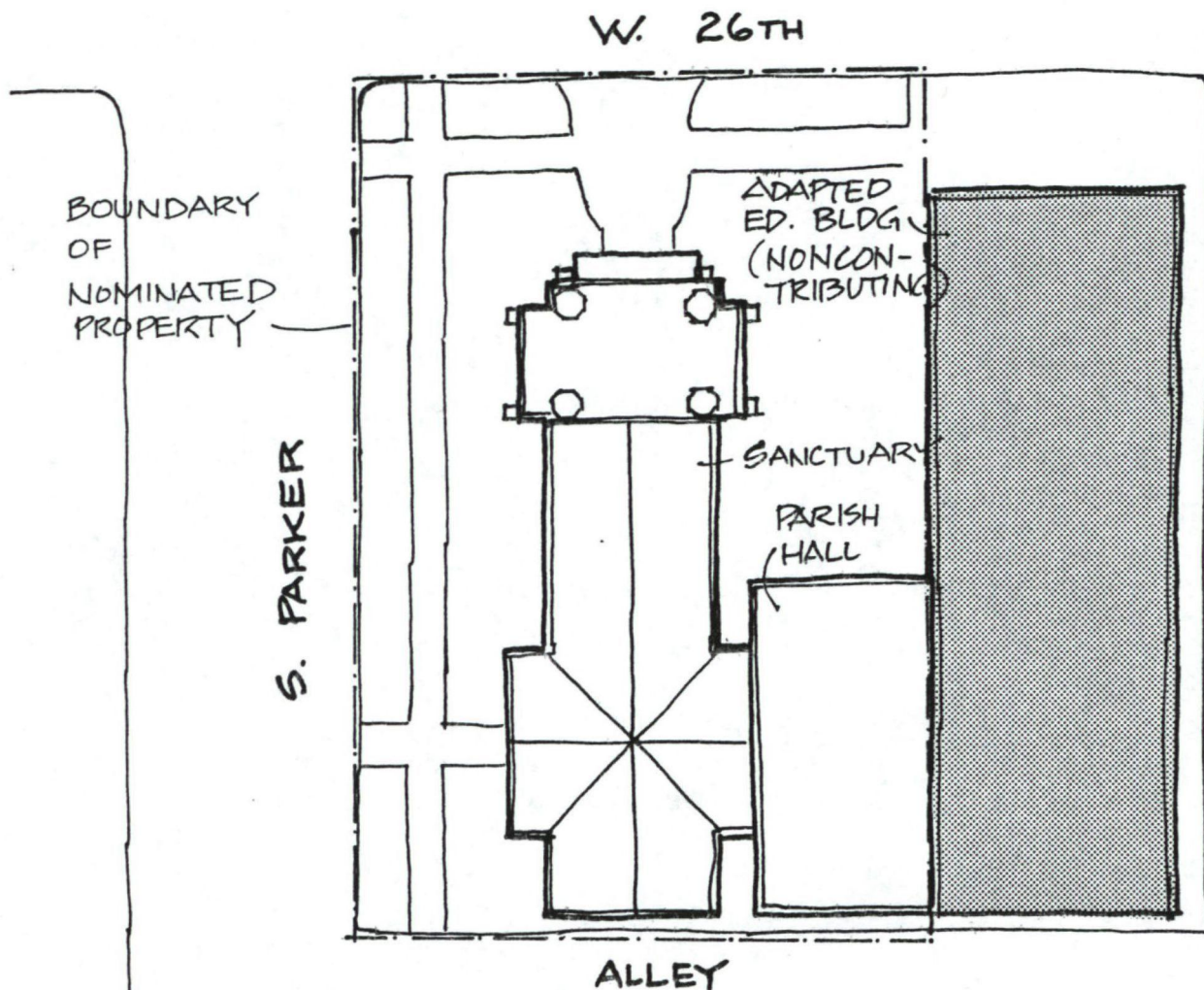

SITE NO. 1417
ST. ANDREWS EPISCOPAL CHURCH
‡ PARISH HALL
217 W. 26TH
BRYAN, TEXAS

SCALE 1" = APPX 35'



NORTH

United States Department of the Interior
National Park Service

National Register of Historic Places
Inventory—Nomination Form

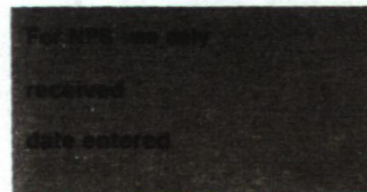

Continuation sheet

Item number

Page

Multiple Resource Area
Thematic Group

Name Bryan MRA
State Brazos County, TEXAS

Nomination/Type of Review

Date/Signature

31. Noto House

Substantive Review

for Keeper

William B. Bushong
9/25/87

Attest

32. Oliver, Dr. William Holt,
House

Entered in the
National Register

for Keeper

Alvord Byers 9/25/87

Attest

33. Parker Lumber Company Complex

Substantive Review

for Keeper

William B. Bushong
9/25/87

Attest

34. Parker, Milton, House

Entered in the
National Register

for Keeper

Alvord Byers 9/25/87

Attest

35. Sausley House

Substantive Review

for Keeper

William B. Bushong
9/25/87

Attest

36. Sinclair Station, (Old)

Entered in the
National Register

for Keeper

Alvord Byers 9/25/87

Attest

37. Smith--Barron House

Substantive Review

for Keeper

Patrick Andrews 6/20/88

Attest

38. St. Andrew's Episcopal Church

Entered in the
National Register

for Keeper

Alvord Byers 9/25/87

Attest

39. St. Anthony's Catholic Church

Substantive Review

for Keeper

William B. Bushong
9/25/87

Attest

40. Stone, Roy C., House

Entered in the
National Register

for Keeper

Alvord Byers 9/25/87

Attest

87001646

NATIONAL REGISTER OF HISTORIC PLACES
EVALUATION/RETURN SHEET

St. Andrew's Episcopal Church (Bryan MRA)
Brazos County
TEXAS

Working No. AUG 20 1987
Fed. Reg. Date: 2/2/88
Date Due: 9/17/87 - 10/4/87
Action: ☒ ACCEPT 9-25-87
☐ RETURN
☐ REJECT
Federal Agency: _____

Entered in the
National Register

- ☐ resubmission
☐ nomination by person or local government
☐ owner objection
☐ appeal

Substantive Review: ☐ sample ☐ request ☐ appeal ☐ NR decision

Reviewer's comments:

Recom./Criteria _____
Reviewer _____
Discipline _____
Date _____
_____ see continuation sheet

Nomination returned for: _____ technical corrections cited below
_____ substantive reasons discussed below

1. Name

2. Location

3. Classification

Category	Ownership	Status	Present Use
	Public Acquisition	Accessible	

4. Owner of Property

5. Location of Legal Description

6. Representation in Existing Surveys

Has this property been determined eligible? ☐ yes ☐ no

7. Description

Condition	Check one	Check one
<input type="checkbox"/> excellent	<input type="checkbox"/> deteriorated	<input type="checkbox"/> original site
<input type="checkbox"/> good	<input type="checkbox"/> ruins	<input type="checkbox"/> moved date _____
<input type="checkbox"/> fair	<input type="checkbox"/> unexposed	
	<input type="checkbox"/> unaltered	
	<input type="checkbox"/> altered	

Describe the present and original (if known) physical appearance

- ☐ summary paragraph
☐ completeness
☐ clarity
☐ alterations/integrity
☐ dates
☐ boundary selection

8. Significance

Period Areas of Significance—Check and justify below

Specific dates

Builder/Architect

Statement of Significance (*in one paragraph*)

- ☐ summary paragraph
- ☐ completeness
- ☐ clarity
- ☐ applicable criteria
- ☐ justification of areas checked
- ☐ relating significance to the resource
- ☐ context
- ☐ relationship of integrity to significance
- ☐ justification of exception
- ☐ other

9. Major Bibliographical References

10. Geographical Data

Acreage of nominated property _____

Quadrangle name _____

UTM References

Verbal boundary description and justification

11. Form Prepared By

12. State Historic Preservation Officer Certification

The evaluated significance of this property within the state is:

____ national ____ state ____ local

State Historic Preservation Officer signature

title

date

13. Other

- ☐ Maps
- ☐ Photographs
- ☐ Other

Questions concerning this nomination may be directed to _____

Signed _____ Date _____ Phone: _____



"Historic Resources of Bryan, Texas" Multiple-
Resource Nomination; city limits of Bryan,
Brazos County, Texas.

Photo: Daniel Hardy of Hardy-Heck-Moore, Inc.;
1985; negative with Texas Historical
Commission, Austin, Texas.

Subject: St. Andrew's Episcopal Church and
Parish Hall, Site No. 1417, 217 W. 26th

View: Camera looking south

Photo 4 of 52

Please refer to the map in the
Multiple Property Cover Sheet
for this property

Multiple Property Cover Sheet Reference Number: 64000831