

United States Department of the Interior
National Park ServiceNational Register of Historic Places
Inventory—Nomination Form

For NPS use only

received

8/20/87

date entered

Continuation sheet

Item number all

Page 26

TEXAS HISTORIC SITES INVENTORY FORM—TEXAS HISTORICAL COMMISSION (rev.8-82)

1. County Brazos BRA
City/Rural Bryan BR
2. Name Allen Block
Address 400-422 N MAIN
see continuation sheets 27-31
3. Owner See individual site forms
Address See individual site forms
4. Block/Lot OTS/Blk 104/see below
5. USGS Quad No. 3096-424 Site No. 329-
UTM Sector 333
6. Date: Factual 1890/1920 Est. _____
7. Architect/Builder Unknown
Contractor _____
8. Style/Type Vernacular commercial buildings
9. Original Use commercial
Present Use commercial
10. Description Row of one-story brick commercial buildings; flat roof w/ built-up
tar-and-gravel covering; 2- and 3-bay storefronts in each section; some with
double-door entries and round-arched transoms; slightly projecting brick
piers that extend past the parapet indicate each store front; simply detailed
11. Present Condition fair to poor
12. Significance ARCHITECTURE: Most of the buildings in Bryan's downtown area have
undergone extensive alterations over the years, especially during the 1950s and
1960s. This row of structures remains virtually unaltered although in
13. Relationship to Site: Moved Date _____ or Original Site *(describe) in the central business
district
14. Bibliography Tax Rolls, City Directories,
Sanborn Maps (RDS)
15. Informant _____
16. Recorder Hardy-Heck-Moore Date July 1986

DESIGNATIONS

TNRIS No. _____ Old THC Code _____

NR: ☐ RTHL ☐ HABS (no.) TEX _____

☐ *Individual ☐ Historic District

☐ Thematic ☐ Multiple-Resource

NR File Name _____

Other _____

PHOTO DATA

B&W 4x5s _____ Slides 3

35mm Negs

YEAR	DRWR	ROLL	FRME		ROLL	FRME
		97	24	to	97	27
				to		
				to		

CONTINUATION PAGE

No. 2 of 2

TEXAS HISTORIC SITES INVENTORY FORM—TEXAS HISTORICAL COMMISSION (rev.8-82)

1. County Brazos BRA
City/Rural Bryan BR
2. Name Allen Block
5. USGS Quad No. 3096-424 Site No. 329-
UTM Pt. 14/751700/3396540
Acreage less than one acre

Blk cont.: Lots, all 1, S. 30' of 2, E 50' of N 20' of 2, E 50' of 3 and 4.
Significance continued: in a somewhat poor condition. Little is known
about the types of stores that occupied these buildings and the sole source
of information comes from old (post-1937) city directories. This grouping of
buildings is being nominated as a representative example of the type of
small commercial buildings that were quite common in Bryan's downtown area.
This part of town has been severely hurt by decentralization of commercial/
retail activity in the post-World War II era and few structures remain which
have escaped remodeling efforts. The attached site plan (continuation sheet
no. 32) indicates property to be nominated. The area in gray is not included.

United States Department of the Interior
National Park ServiceNational Register of Historic Places
Inventory—Nomination Form

For NPS use only

received

date entered

Continuation sheet

Item number all

Page 27

TEXAS HISTORIC SITES INVENTORY FORM—TEXAS HISTORICAL COMMISSION (rev.8-82)

1. County <u>Brazos</u>	<div style="border: 1px solid black; padding: 2px; display: inline-block;">BRA BR</div>	5. USGS Quad No. <u>3096-424</u>	Site No. <u>333</u>
City/Rural <u>Bryan</u>		UTM Sector _____	
2. Name <u>Allen Building</u>		6. Date: Factual _____	Est. <u>1900</u>
Address <u>400-408 N MAIN</u>		7. Architect/Builder <u>Unknown</u>	
<u>part of Allen Block - 400-22 N. Main</u>		Contractor _____	
3. Owner <u>Mr. Florez</u>		8. Style/Type <u>commercial vernacular</u>	
Address <u>400 N. Main, Bryan 77803</u>		9. Original Use <u>commercial</u>	
4. Block/Lot <u>OTS/Blk 104/Lot 1</u>		Present Use <u>commercial</u>	
10. Description <u>1-story, load-bearing, masonry, commercial building w/ open plan;</u> <u>exterior walls of brick; flat roof w/ built-up tar-and-gravel covering; 6-bay</u> <u>facade; modern infill in bays; secondary side entrance; fixed aluminum-sash</u> <u>display windows; some transoms are enclosed; wood canopy; corbeled course</u>			
11. Present Condition <u>fair; alterations: storefronts changed; brick painted</u>			
12. Significance <u>This commercial building, marked as the "Allen Smith" building, was</u> <u>owned by John B. Mike and descendants for at least 25 years. Housed in the</u> <u>building were numerous small businesses, such as grocery stores, cafes,</u>			
13. Relationship to Site: Moved Date _____ or Original Site <u>*(describe) in north end of downtown</u> <u>amid small stores and industrial/agricultural suppliers</u>			
14. Bibliography <u>Tax Rolls, Sanborn Maps</u>		15. Informant _____	
<u>City Directory (RDS)</u>		16. Recorder <u>Hardy-Heck-Moore</u> Date <u>July 1986</u>	

DESIGNATIONS

PHOTO DATA

TNRIS No. _____ Old THC Code _____
☐ RTHL ☐ HABS (no.) TEX _____
NR: ☐ *Individual ☐ Historic District
☐ Thematic ☐ Multiple-Resource
NR File Name _____
Other _____

B&W 4x5s _____ Slides 1
35mm Negs
YEAR DRWR ROLL FRME

		97	24

 to

ROLL	FRME
97	27

to
to

CONTINUATION PAGE

No. 2 of 2

TEXAS HISTORIC SITES INVENTORY FORM—TEXAS HISTORICAL COMMISSION (rev.8-82)

1. County <u>Brazos</u>	<div style="border: 1px solid black; padding: 2px; display: inline-block;">BRA BR</div>	5. USGS Quad No. <u>3096-424</u>	Site No. <u>333</u>
City/Rural <u>Bryan</u>		UTM Pt. _____	
2. Name <u>Allen Building</u>		Acreage <u>less than one acre</u>	

Description continued: above transoms.

Significance continued: a laundry, a shoe shop.

United States Department of the Interior
National Park ServiceNational Register of Historic Places
Inventory—Nomination Form

For NPS use only

received

date entered

Continuation sheet

Item number all

Page 28

TEXAS HISTORIC SITES INVENTORY FORM—TEXAS HISTORICAL COMMISSION (rev.8-82)

1. County Brazos BRA
City/Rural Bryan BR
2. Name _____
Address 410 N MAIN
part of Allen Block - 400-22 N. Main
3. Owner Jose C. Montemayor
Address 1710 Austin, College Sta., 77840
4. Block/Lot OTS/Blk 104/Lots 2, p.3
5. USGS Quad No. 3096-424 Site No. 332
UTM Sector _____
6. Date: Factual _____ Est. 1890
7. Architect/Builder Unknown Contractor _____
8. Style/Type vernacular commercial
9. Original Use commercial
Present Use commercial
10. Description 1-story, load-bearing, masonry, commercial building; exterior walls
of brick; flat roof; 3-bay facade, arranged symmetrically; double-door
entrance; fixed wood-sash display windows; covered/enclosed transoms above
entry; wood canopy; brick parapet w/ corbeled and decorative brickwork; 3-bay
11. Present Condition fair; alterations: windows changed
12. Significance With other similar storefronts in the block, this contributes to one
of Bryan's few groupings of unaltered historic commercial buildings. This
structure has had numerous small businesses, including the City Market in the
13. Relationship to Site: Moved Date _____ or Original Site *(describe) north end of downtown
amid small stores and industrial and agricultural suppliers
14. Bibliography Tax Rolls, Sanborn Maps
City Directory (RDS)
15. Informant _____
16. Recorder Hardy-Heck-Moore Date July 1986

DESIGNATIONS

PHOTO DATA

TNRIS No. _____ Old THC Code _____

☐ RTHL ☐ HABS (no.) TEX _____

NR: ☐ *Individual ☐ Historic District

☐ Thematic ☐ Multiple-Resource

NR File Name _____

Other _____

B&W 4x5s _____ Slides 2

35mm Negs

YEAR	DRWR	ROLL	FRME
		7	15
		97	28

to _____

ROLL	FRME
97	31

to _____

CONTINUATION PAGE

No. 2 of 2

TEXAS HISTORIC SITES INVENTORY FORM—TEXAS HISTORICAL COMMISSION (rev.8-82)

1. County Brazos BRA
City/Rural Bryan BR
2. Name _____
5. USGS Quad No. 3096-424 Site No. 332
UTM Pt. _____
Acreage less than one acre

Description continued: facade has round-arched entry flanked by segmentally
arched windows.

Significance continued: late 1930s.

United States Department of the Interior
National Park ServiceNational Register of Historic Places
Inventory—Nomination Form

For NPS use only

received

date entered

Continuation sheet

Item number all

Page 29

TEXAS HISTORIC SITES INVENTORY FORM—TEXAS HISTORICAL COMMISSION (rev.8-82)

1. County Brazos BRA
BR City/Rural Bryan
2. Name _____ Address 412 N MAIN
part of Allen Block - 400-22 N. Main
3. Owner Jose C. Montemayor Address 1710 Austin, College Sta. 77840
4. Block/Lot OTS/Block 104/Lot p.3
5. USGS Quad No. 3096-424 Site No. 331
UTM Sector _____
6. Date: Factual _____ Est. 1890
7. Architect/Builder Unknown Contractor _____
8. Style/Type commercial vernacular
9. Original Use commercial
10. Description 1-story, load-bearing, masonry, commercial building w/ open plan;
exterior walls of brick; flat roof; 4-bay facade; brick piers; single-door
entrances; some of the transoms are covered or enclosed; wood canopy; round-
arched openings w/ brick voussoirs; 2-part brick parapet w/ corbeled and
11. Present Condition fair; alterations: north arch support removed
12. Significance With other similar storefronts in the block, this contributes to one of
Bryan's few groupings of unaltered historic commercial buildings. Two of the
many businesses housed here were Buddy's Place and Bryan's Dairy Store No. 2
13. Relationship to Site: Moved Date _____ or Original Site *(describe) in the north end of
downtown amid small stores and industrial/agricultural suppliers
14. Bibliography Tax Rolls, Sanborn Maps 15. Informant _____
City Directory (RDS) 16. Recorder Hardy-Heck-Moore Date July 1986

DESIGNATIONS

PHOTO DATA

TNRIS No. _____ Old THC Code _____

☐ RTHL ☐ HABS (no.) TEX _____

NR: ☐ *Individual ☐ Historic District

☐ Thematic ☐ Multiple-Resource

NR File Name _____

Other _____

B&W 4x5s _____ Slides 2

35mm Negs

YEAR	DRWR	ROLL	FRME		ROLL	FRME
		7	16	to		
		97	29	to		
				to		

CONTINUATION PAGE

No. 2 of 2

TEXAS HISTORIC SITES INVENTORY FORM—TEXAS HISTORICAL COMMISSION (rev.8-82)

1. County Brazos BRA
BR City/Rural Bryan
2. Name _____
5. USGS Quad No. 3096-424 Site No. 331
UTM Pt. _____
Acreage less than one acre

Description continued: decorative brickwork; 3 corbel-capped pilasters
created 2 sections or "storefronts;" north storefront has arch support removed;
5 paneled doors.

Significance continued: in the late 1930s.

United States Department of the Interior
National Park Service

National Register of Historic Places
Inventory—Nomination Form

For NPS use only

received

date entered

Continuation sheet

Item number all

Page 30

TEXAS HISTORIC SITES INVENTORY FORM — TEXAS HISTORICAL COMMISSION (rev.8-82)

1. County Brazos BRA
City/Rural Bryan BR

2. Name _____
Address 414-16 N MAIN
part of Allen Block - 400-22 N. Main

3. Owner Daryl Massey
Address 409 N. Main, Bryan 77840

4. Block/Lot OTS/Blk 104/Lot 4

5. USGS Quad No. 3096-424 Site No. 330
UTM Sector _____

6. Date: Factual _____ Est. 1890

7. Architect/Builder Unknown Contractor _____

8. Style/Type vernacular commercial

9. Original Use commercial
Present Use commercial

10. Description 1-story, load-bearing, masonry, commercial building w/ open plan;
exterior walls of brick; flat roof; 6-bay facade, arranged symmetrically;
recessed entries w/ double doors; fixed wood- and aluminum-sash windows;
covered/enclosed transoms above ground-level openings; wood canopy; round-

11. Present Condition fair; alterations: arch supports removed; display area changed

12. Significance With other similar storefronts in the block, this contributes to one of
Bryan's few groupings of unaltered historic commercial buildings. Two of many
businesses housed here were the T.S. Woodyard Confectioners and Cash & Carry

13. Relationship to Site: Moved Date _____ or Original Site *(describe) north end of downtown
amid small stores and agricultural/industrial suppliers.

14. Bibliography Tax Rolls, Sanborn Maps
City Directory (RDS)

15. Informant _____

16. Recorder Hardy-Heck-Moore Date July 1986

DESIGNATIONS

PHOTO DATA

TNRIS No. _____ Old THC Code _____

☐ RTHL ☐ HABS (no.) TEX

NR: ☐ *Individual ☐ Historic District

☐ Thematic ☐ Multiple-Resource

NR File Name _____

Other _____

B&W 4x5s _____ Slides 2

35mm Negs

YEAR	DRWR	ROLL	FRME
		7	17
		97	30

to _____

ROLL	FRME
97	32

to _____

CONTINUATION PAGE

No. 2 of 2

TEXAS HISTORIC SITES INVENTORY FORM — TEXAS HISTORICAL COMMISSION (rev.8-82)

1. County Brazos BRA
City/Rural Bryan BR

2. Name _____

5. USGS Quad No. 3096-424 Site No. 330
UTM Pt. _____
Acreage less than one acre

Description continued: arched openings w/ brick voussoirs; 2-part brick
parapet w/ corbeled and decorative brickwork; 3 corbel-capped pilasters create
2 storefronts; entries in each have round arches w/ transoms flanked by
segmental arches.

Significance continued: Cleaners in the late 1930s.

United States Department of the Interior
National Park ServiceNational Register of Historic Places
Inventory—Nomination Form

For NPS use only

received

date entered

Continuation sheet

Item number all

Page 31

TEXAS HISTORIC SITES INVENTORY FORM—TEXAS HISTORICAL COMMISSION (rev.8-82)

1. County <u>Brazos</u>	<div style="border: 1px solid black; padding: 2px; display: inline-block;">BRA BR</div>	5. USGS Quad No. <u>3096-424</u>	Site No. <u>329</u>
City/Rural <u>Bryan</u>		UTM Sector _____	
2. Name _____		6. Date: Factual _____	Est. <u>1890</u>
Address <u>418-22 N MAIN</u>		7. Architect/Builder <u>Unknown</u>	
<u>part of Allen Block - 400-22 N. Main</u>		Contractor _____	
3. Owner <u>Bryan City Mission</u>		8. Style/Type <u>vernacular commercial</u>	
Address <u>418-422 N. Main, Bryan 77803</u>		9. Original Use <u>commercial</u>	
4. Block/Lot <u>OTS/Blk 104/Lot 5</u>		Present Use <u>commercial</u>	
10. Description <u>1-story, load-bearing, masonry commercial building w/ open plan;</u> <u>exterior walls of brick; flat roof; 6-bay facade, arranged symmetrically;</u> <u>recessed entries w/ double doors; fixed wood- and aluminum-sash windows;</u> <u>covered transoms above openings; wood canopy; round-arched openings w/ brick</u>			
11. Present Condition <u>fair; alterations: arch supports removed; display area changed.</u>			
12. Significance <u>With other similar storefronts in the block, this contributes to one of</u> <u>Bryan's few groupings of unaltered historic commercial buildings. Among the</u> <u>earliest known businesses located in the building were the N. Main Cafe and</u>			
13. Relationship to Site: Moved _____ Date _____ or Original Site <u>*(describe) in the central business</u> <u>district; in the middle of the block</u>			
14. Bibliography <u>Tax Rolls, Sanborn Maps</u>		15. Informant _____	
<u>City Directories</u>		16. Recorder <u>Hardy-Heck-Moore</u> Date <u>July 1986</u>	

DESIGNATIONS

PHOTO DATA

TNRIS No. _____ Old THC Code _____

☐ RTHL ☐ HABS (no.) TEX _____

NR: ☐ *Individual ☐ Historic District

☐ Thematic ☐ Multiple-Resource

NR File Name _____

Other _____

B&W 4x5s 1 Slides _____

35mm Negs

YEAR	DRWR	ROLL	FRME
		7	18

to _____

to _____

to _____

CONTINUATION PAGE

No. 2 of 2

TEXAS HISTORIC SITES INVENTORY FORM—TEXAS HISTORICAL COMMISSION (rev.8-82)

1. County <u>Brazos</u>	<div style="border: 1px solid black; padding: 2px; display: inline-block;">BRA BR</div>	5. USGS Quad No. <u>3096-424</u>	Site No. <u>329</u>
City/Rural <u>Bryan</u>		UTM Pt. _____	
2. Name _____		Acreage <u>less than one acre</u>	

Description continued: voussoirs; 2-part brick parapet w/ corbeled and decorative brickwork; entries in each storefront have round arches w/ transoms flanked by segmental arches.

Significance: and the M.C. Shoe Shop in 1937.

United States Department of the Interior
National Park Service

National Register of Historic Places
Inventory—Nomination Form

For NPS use only

received

date entered

Continuation sheet

Item number all

Page 32

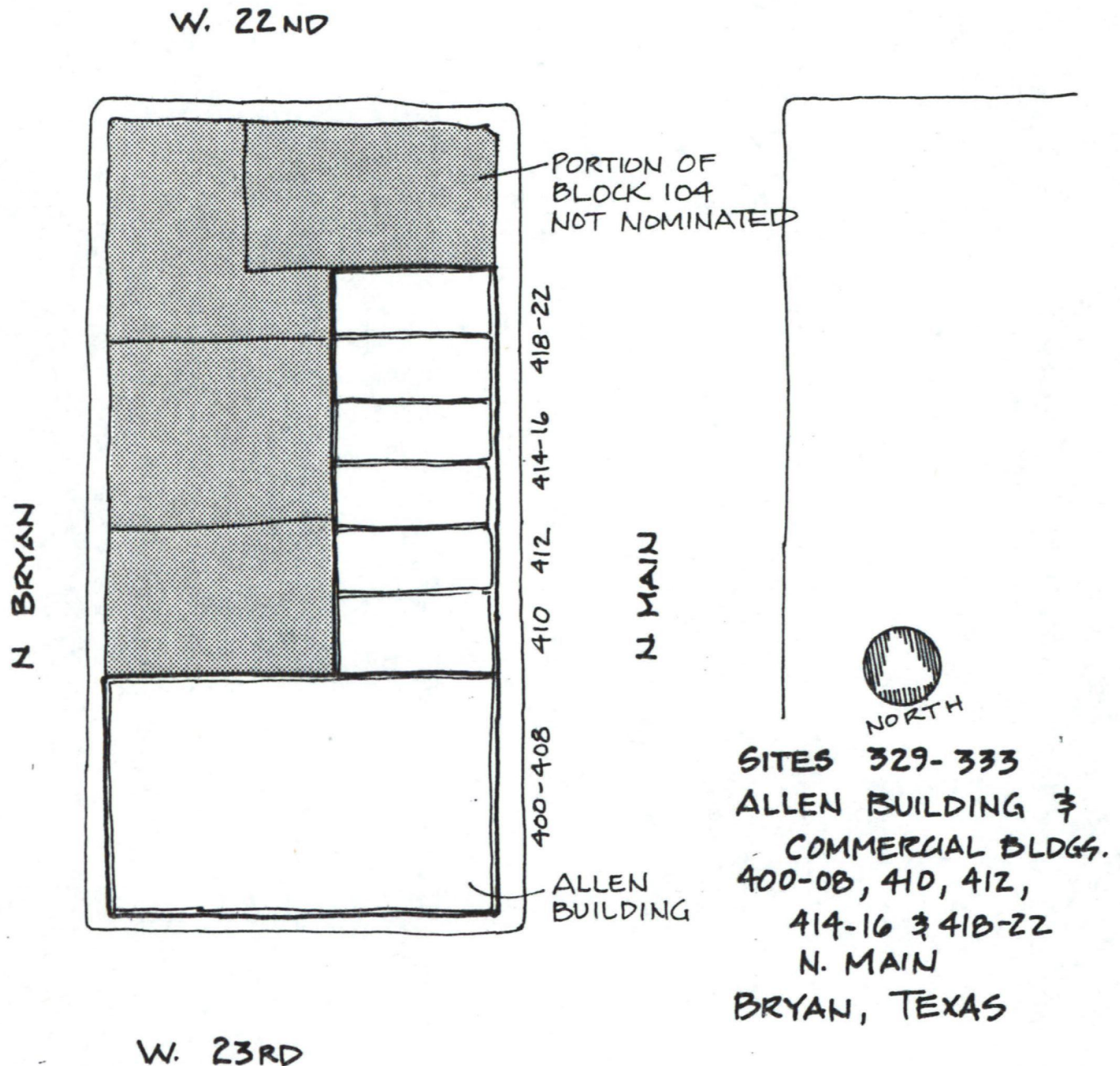

SCALE 1" = APPX 50'

8/20/87

United States Department of the Interior
National Park ServiceNational Register of Historic Places
Continuation Sheet

Section number _____ Page _____

Multiple Resource Area
Thematic GroupName Bryan MRA
State Brazos County, TEXAS

Nomination/Type of Review

Date/Signature

9/25/87

Cover

~~Substantive Review~~for Keeper William B. BushongWilliam B. Bushong

1. Allen Academy Memorial Hall

~~Substantive Review~~for Keeper William B. BushongWilliam B. Bushong

9/25/87

Attest _____

2. Allen Block

~~Substantive Review~~for Keeper William B. BushongWilliam B. Bushong

9/25/87

Attest _____

3. Allen, R.O., House-Allen Academy

~~Substantive Review~~for Keeper William B. BushongWilliam B. Bushong

9/25/87

Attest _____

4. Armstrong House-Allen Academy

Entered in the
National Registerfor Keeper Alvord ByrumAlvord Byrum

9/25/87

Attest _____

5. Astin, R.Q., House

~~Substantive Review~~for Keeper William B. BushongWilliam B. Bushong

9/25/87

Attest _____

6. Blazek, E.J., House

Entered in the
National Registerfor Keeper Alvord ByrumAlvord Byrum

9/25/87

Attest _____

7. Bryan Compress and Warehouse

~~Substantive Review~~for Keeper William B. BushongWilliam B. Bushong

9/25/87

Attest _____

8. Bryan Ice House

Entered in the
National Registerfor Keeper Alvord ByrumAlvord Byrum

9/25/87

Attest _____

9. CSPS Lodge--Griesser Bakery

~~Substantive Review~~for Keeper William B. BushongWilliam B. Bushong

9/25/87

Attest _____

10. Chance, James O., House

Entered in the
National Registerfor Keeper Alvord ByrumAlvord Byrum

9/25/87

Attest _____

87001604

NATIONAL REGISTER OF HISTORIC PLACES
EVALUATION/RETURN SHEET

Allen Block (Bryan MRA)
Brazos County
TEXAS

Substantive Review

AUG 20 1987

- ☐ resubmission
☐ nomination by person or local government
☐ owner objection
☐ appeal

Working No. _____
Fed. Reg. Date: 2/2/88
Date Due: 9/1/87 - 10/4/87
Action: ☒ ACCEPT 9/25/87
☐ RETURN
☐ REJECT
Federal Agency: _____

Substantive Review: ☐ sample ☒ request ☐ appeal ☐ NR decision

Reviewer's comments: The state requested substantive review for this nomination although the cover letter didn't explain exactly why. I assume that integrity is the issue, but there does not to be any severe integrity problems with the property. This grouping of buildings is a representative collection of the type of small commercial buildings which were once common in downtown Bryan.

Recom./Criteria Accept - C
Reviewer Noble
Discipline Historian
Date 9/25/87
_____ see continuation sheet

Nomination returned for: _____ technical corrections cited below
_____ substantive reasons discussed below

1. Name

2. Location

3. Classification

Category	Ownership	Status	Present Use
	Public Acquisition	Accessible	

4. Owner of Property

5. Location of Legal Description

6. Representation in Existing Surveys

Has this property been determined eligible? ☐ yes ☐ no

7. Description

Condition		Check one	Check one
<input type="checkbox"/> excellent	<input type="checkbox"/> deteriorated	<input type="checkbox"/> unaltered	<input type="checkbox"/> original site
<input type="checkbox"/> good	<input type="checkbox"/> ruins	<input type="checkbox"/> altered	<input type="checkbox"/> moved date _____
<input type="checkbox"/> fair	<input type="checkbox"/> unexposed		

Describe the present and original (if known) physical appearance

- ☐ summary paragraph
☐ completeness
☐ clarity
☐ alterations/integrity
☐ dates
☐ boundary selection

8. Significance

Period Areas of Significance—Check and justify below

Specific dates

Builder/Architect

Statement of Significance (*in one paragraph*)

- ☐ summary paragraph
- ☐ completeness
- ☐ clarity
- ☐ applicable criteria
- ☐ justification of areas checked
- ☐ relating significance to the resource
- ☐ context
- ☐ relationship of integrity to significance
- ☐ justification of exception
- ☐ other

9. Major Bibliographical References

10. Geographical Data

Acreage of nominated property _____

Quadrangle name _____

UTM References _____

Verbal boundary description and justification _____

11. Form Prepared By

12. State Historic Preservation Officer Certification

The evaluated significance of this property within the state is:

____ national ____ state ____ local

State Historic Preservation Officer signature

title

date

13. Other

- ☐ Maps
- ☐ Photographs
- ☐ Other

Questions concerning this nomination may be directed to _____

Signed _____ Date _____ Phone: _____



"Historic Resources of Bryan, Texas" Multiple-
Resource Nomination; city limits of Bryan,
Brazos County, Texas.

Photo: Daniel Hardy of Hardy-Heck-Moore, Inc.;
1985; negative with Texas Historical
Commission, Austin, Texas.

Subject: Allen Building; Site Nos. 329-333
400-22 N. Main

View: Camera looking northwest

Photo 24 of 52

Please refer to the map in the
Multiple Property Cover Sheet
for this property

Multiple Property Cover Sheet Reference Number: 64000831