

United States Department of the Interior
National Park ServiceNational Register of Historic Places
Inventory—Nomination Form

For NPS use only

received 8/11/86

date entered SEP 24 1986

Continuation sheet

Item number all

Page 56

TEXAS HISTORIC SITES INVENTORY FORM—TEXAS HISTORICAL COMMISSION (rev.8-82)

1. County Ellis ELL
WX 5. USGS Quad No. 3296-234 Site No. 1
City/Rural Waxahachie UTM Sector 702-3587 PHOTO NO. 54
2. Name Oscar H. Chapman House 6. Date: Factual 1929 Est. _____
Address 201 OVERHILL 7. Architect/Builder W. B. Fowler of Coburn & Fowler
Contractor Burt Building Co.
3. Owner Marcus R. & Renda L. Hickerson 8. Style/Type Georgian Revival
Address 201 Overhill, Waxahachie Tx 9. Original Use residential
4. Block/Lot Wm. Baskin, Abst 148, .51 acre Present Use residential
10. Description Two-story frame dwelling w/ brick veneer; hip roof w/ composition
shingles & box eaves; wood sash double-hung windows; single-door primary
entrance w/ transom & sidelights on S. elev.; exterior brick chimney;
pedimented entry portico w/ Tuscan entablature; pedimented dormers reflect
11. Present Condition excellent
12. Significance ARCHITECTURE: One of the city's finest examples of Georgian Revival
architecture, an uncommon style in the area. Few changes have taken place
in W. B. Fowler's original design of 1929. Built for Oscar H. Chapman,
13. Relationship to Site: Moved Date _____ or Original Site %describe in a residential area
northwest of the CBD; the oldest house in a mostly 1950s neighborhood
14. Bibliography Tax Rolls, Sanborn Maps 15. Informant Renda Hickerson
City Directories, HWI files 16. Recorder Hardy-Heck-Moore/BJ Date July, 1985

DESIGNATIONS

PHOTO DATA

TNRIS No. _____ Old THC Code _____

B&W 4x5s _____ Slides 1

- NR: ☐ RTHL ☐ HABS (no.) TEX _____
☐ Individual ☐ Historic District
☐ Thematic ☐ Multiple-Resource

35mm Negs				ROLL FRME	
YEAR	DRWR	ROLL	FRME	ROLL	FRME
		51	33	to	
		103	31	to	103 34
				to	

NR File Name _____

Other _____

CONTINUATION PAGE

No. 2 of 2

TEXAS HISTORIC SITES INVENTORY FORM—TEXAS HISTORICAL COMMISSION (rev.8-82)

1. County Ellis ELL
WX 5. USGS Quad No. 3296-234 Site No. 1
City/Rural Waxahachie UTM Pt. 14/702660/3587060
2. Name Oscar H. Chapman House Acreage Less than one acre

Description, continued: design of portico; denticulated cornice w/ frieze; lateral additions serve as porte cochere & open sun porch, reflect portico design & are surmounted by squared wood balusters; chimneypots; asymmetrical facade organization; located on a large corner lot; two-story garage/apartment house stands to the southwest of the main house.

Significance, continued: a prominent attorney in Waxahachie who lived in the house until 1958.

United States Department of the Interior
National Park Service

**National Register of Historic Places
Inventory—Nomination Form**

For NPS use only

received 8/16/86

date entered

Continuation sheet

Item number

4

Page 57

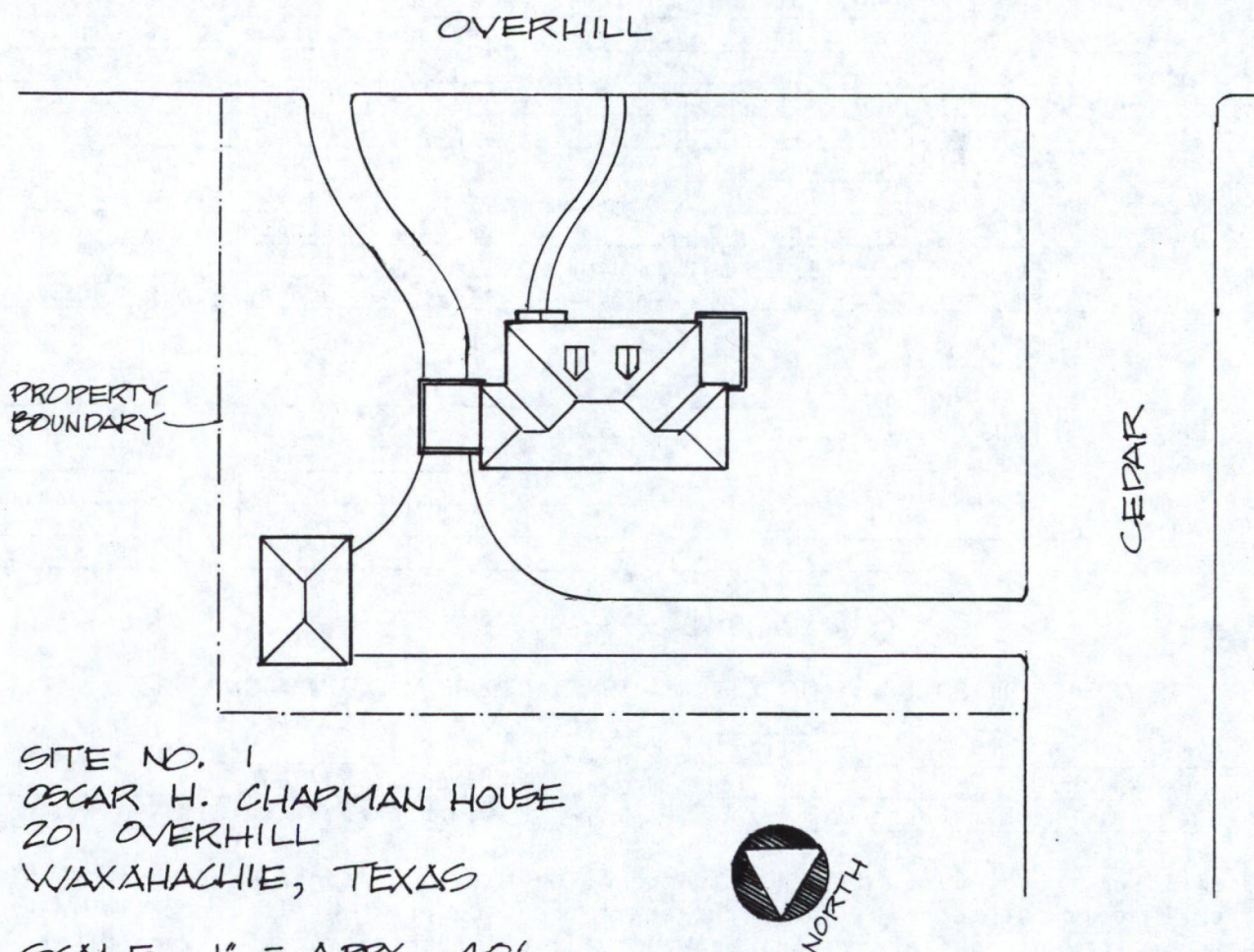

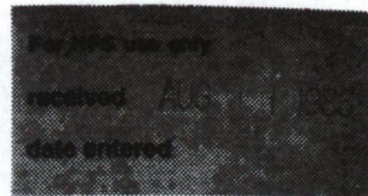
United States Department of the Interior
National Park ServiceNational Register of Historic Places
Inventory—Nomination Form

Continuation sheet

Item number

Page

Multiple Resource Area
Thematic Group

dnr-11

Substantive Review

Name Waxahachie Multiple Resource Area
State Ellis County, TEXAS

cover _____ accept 9/24/86

Nomination/Type of Review

Date/Signature

1. Adamson, F.R., House

Substantive Review Keeper

Patrick Andrus 9/24/86

Attest

2. Alderman, G.H., House

Entered in the
National Register

Keeper

Beth L. Savage 9/24/86

Attest

3. Alderdice, J.M., House

Substantive Review Keeper

Patrick Andrus 9/24/86

Attest

4. Berry, J.S., House

Entered in the
National Register

Keeper

Beth L. Savage 9/24/86

Attest

5. Building at 441 East Main

Substantive Review Keeper

Patrick Andrus 9/24/86

Attest

6. Building at 500-502 East Main

Entered in the
National Register

Keeper

Beth L. Savage 9/24/86

Attest

7. Bullard, T.J., House

Substantive Review Keeper

Patrick Andrus 9/24/86

Attest

8. Central Presbyterian Church

Keeper

Beth L. Savage 9/24/86

Attest

Patrick Andrus 9/11/87 T
Bruce J. Noble Jr. 9/11/87

9. Chapman, Oscar H., House

Substantive Review Keeper

Patrick Andrus 9/24/86

Attest

10. Cohn, Joe, House

Entered in the
National Register

Keeper

Beth L. Savage 9/24/86

Attest

36002479

UNITED STATES DEPARTMENT OF THE INTERIOR
NATIONAL PARK SERVICENATIONAL REGISTER OF HISTORIC PLACES
EVALUATION/RETURN SHEETChapman, Oscar H., House (Waxahachie MRA)
Ellis County
TEXAS

Substantive Review

AUG 1 1986

Working No. _____

Fed. Reg. Date: 2/2/88Date Due: 7/4/86 - 9/25/86Action: ☒ ACCEPT 9-24-86☐ RETURN☐ REJECT

Federal Agency: _____

- ☐ resubmission
☐ nomination by person or local government
☐ owner objection
☐ appeal

Substantive Review: ☒ sample ☐ request ☐ appeal ☐ NR decision

Reviewer's comments:

*Locally important fine example
of relatively rare Georgian
Revival Style residence.*

Recom./Criteria Accept CReviewer SavageDiscipline Architectural HistoryDate 9/24/86

____ see continuation sheet

Nomination returned for: ☐ technical corrections cited below
☐ substantive reasons discussed below

1. Name

2. Location

3. Classification

Category	Ownership	Status	Present Use
	Public Acquisition	Accessible	

4. Owner of Property

5. Location of Legal Description

6. Representation in Existing Surveys

Has this property been determined eligible? ☐ yes ☐ no

7. Description

Condition

- ☐ excellent
☐ good
☐ fair

- ☐ deteriorated
☐ ruins
☐ unexposed

Check one

- ☐ unaltered
☐ altered

Check one

- ☐ original site
☐ moved date _____

Describe the present and original (if known) physical appearance

- ☐ summary paragraph
☐ completeness
☐ clarity
☐ alterations/integrity
☐ dates
☐ boundary selection

8. Significance

Period Areas of Significance—Check and justify below

Specific dates

Builder/Architect

Statement of Significance (*in one paragraph*)

- ☐ summary paragraph
- ☐ completeness
- ☐ clarity
- ☐ applicable criteria
- ☐ justification of areas checked
- ☐ relating significance to the resource
- ☐ context
- ☐ relationship of integrity to significance
- ☐ justification of exception
- ☐ other

9. Major Bibliographical References

10. Geographical Data

Acreage of nominated property _____

Quadrangle name _____

UTM References _____

Verbal boundary description and justification _____

11. Form Prepared By

12. State Historic Preservation Officer Certification

The evaluated significance of this property within the state is:

_____ national _____ state _____ local

State Historic Preservation Officer signature

title

date

13. Other

- ☐ Maps
- ☐ Photographs
- ☐ Other

Questions concerning this nomination may be directed to _____

Signed _____ Date _____ Phone: _____



"Historic Resources of Waxahachie, Texas"

Multiple-Resource Nomination;

Waxahachie, Ellis County, Texas

Photo: Hardy-Heck-Moore, Inc., 1985-86

Negative filed at the Texas Historical
Commission, Austin, Texas

Subject: Chapman House - Site No. 1
201 Overhill

Camera looking: southwest

Photo 54 of 104

Please refer to the map in the
Multiple Property Cover Sheet
for this property

Multiple Property Cover Sheet Reference Number: 64000856