

**United States Department of the Interior
National Park Service**

**National Register of Historic Places
Inventory—Nomination Form**

For NPS use only
received 8/11/86
date entered

Continuation sheet

Item number all

Page 64

TEXAS HISTORIC SITES INVENTORY FORM — TEXAS HISTORICAL COMMISSION (rev.8-82)

1. County Ellis ELL
WX 5. USGS Quad No. 3296-234 Site No. 1963
City/Rural Waxahachie UTM Sector 702-3588 PHOTO NO. 61

2. Name John Solon House 6. Date: Factual 1894 Est. _____
Address 617 SOLON RD 7. Architect/Builder Builder--John Solon
Contractor _____

3. Owner Charles T. Burnley 8. Style/Type _____
Address Same, 75165 9. Original Use residential

4. Block/Lot Wm. Baskin Survey/Abstract 99 Present Use residential

10. Description Two-story load-bearing masonry dwelling of stone; hip roof w/ gables w/ composition shingles & box eaves; wood sash double-hung windows w/ 1/i lights; single-door primary entrance w/ transom; three-bay porch w/ hip roof within front-projecting wing w/ turned wood posts, turned wood balusters; interior

11. Present Condition excellent

12. Significance ARCHITECTURE: John Solon was an Irish immigrant who listed his occupation as stone mason. He erected numerous stone buildings in the downtown area, including the 1874 courthouse, that no longer stands. He built this house for

13. Relationship to Site: Moved Date _____ or Original Site (describe) in a rural setting at the N.W. edge of town

14. Bibliography Ellis County Genealogical Records 15. Informant _____
16. Recorder Hardy-Heck-Moore/BJ Date July 1985

DESIGNATIONS

PHOTO DATA

TNRIS No. _____ Old THC Code _____
 RTHL HABS (no.) TEX _____
NR: Individual Historic District
 Thematic Multiple-Resource
NR File Name _____
Other _____

B&W 4x5s _____ Slides 11
35mm Negs

YEAR	DRWR	ROLL	FRME	ROLL	FRME
		53	5		
		107	2		

to _____
to 107 16
to _____

CONTINUATION PAGE

No. 2 of 2

TEXAS HISTORIC SITES INVENTORY FORM — TEXAS HISTORICAL COMMISSION (rev.8-82)

1. County Ellis ELL
WX 5. USGS Quad No. 3296-234 Site No. 1963
City/Rural Waxahachie UTM Pt 14/701920/3585560

2. Name John Solon House Acreage 1.5 acres

Description, continued: stone w/ corbeled caps; jig-sawn bargeboard in gable end; horseshoe arched window & arched window surrounds of standstone; finials @ ridgeline; projecting entry bay of porch w/ gable.

Significance, continued: himself in 1894. This dwelling displays superb craftsmanship throughout and is one of Waxahachie's most architecturally noteworthy structures. One of the few stone-built structures in this area.

United States Department of the Interior
National Park Service

National Register of Historic Places
Inventory—Nomination Form

For NPS use only
received
date entered

Continuation sheet

Item number 4

Page 65

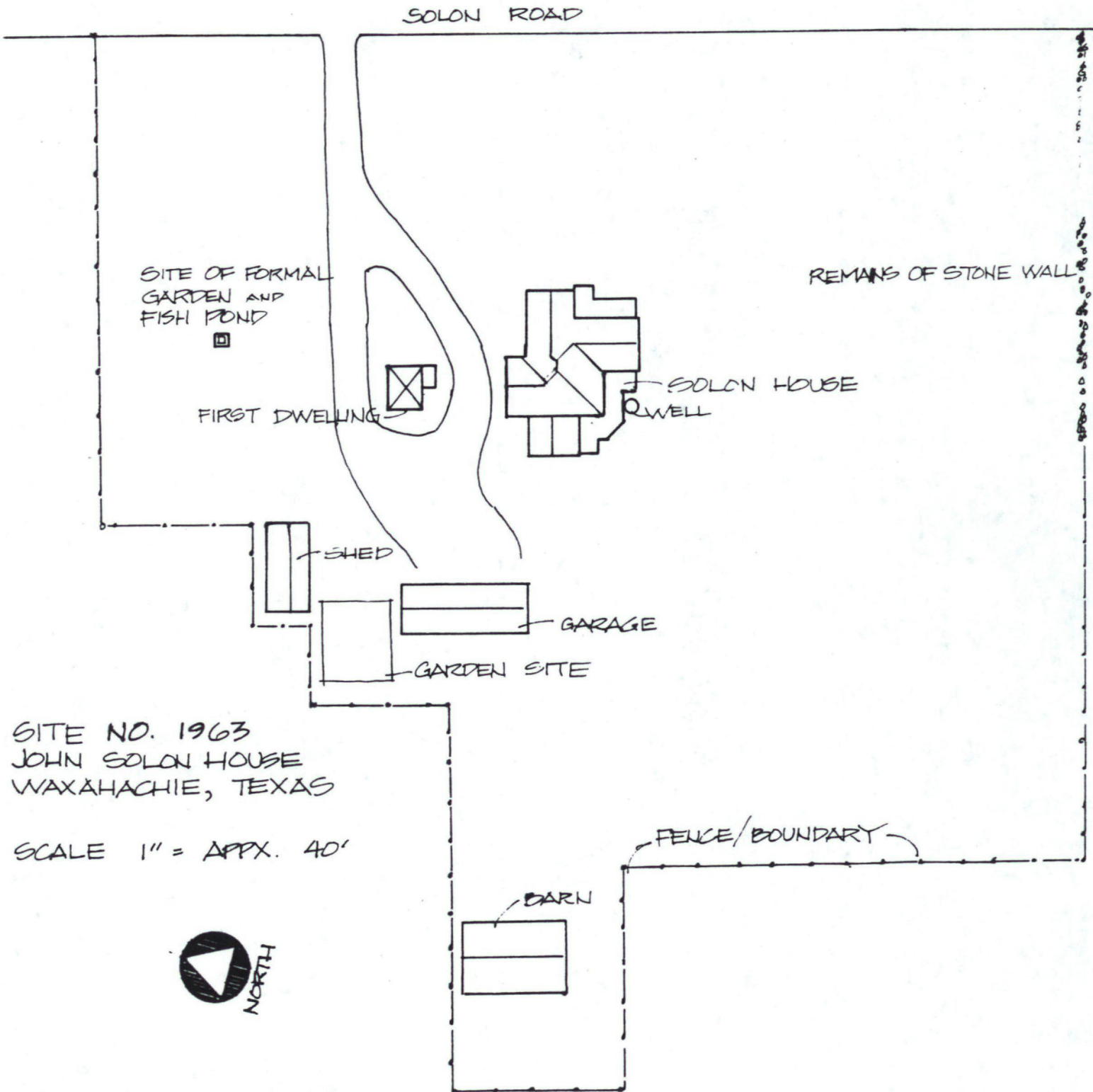

26002453

NATIONAL REGISTER OF HISTORIC PLACES
EVALUATION/RETURN SHEET

Solon, John, House (Waxahachie MRA)
Ellis County
TEXAS

AUG 11 1986

Working No. _____

Fed. Reg. Date: _____

Date Due: 9/11/86 - 9/25/86

Action: ACCEPT

RETURN 9-24-86

REJECT

Federal Agency: _____

Substantive Review

- resubmission
- nomination by person or local government
- owner objection
- appeal

Substantive Review: sample request appeal NR decision

Reviewer's comments:

*Unique and outstanding residence;
however, additional features
apparently included within the
boundary have not been
described, nor assessed as*

Recom./Criteria Return

Reviewer Swase

Discipline Architectural History

Date 9/29/86

_____ see continuation sheet

Nomination returned for: technical corrections cited below
 substantive reasons discussed below *contributing or noncontributing
to the significance of the
property.*

1. Name

2. Location

3. Classification

Category	Ownership	Status	Present Use
	Public Acquisition	Accessible	

4. Owner of Property

5. Location of Legal Description

6. Representation in Existing Surveys

Has this property been determined eligible? yes no

7. Description

Condition

- excellent
- good
- fair

- deteriorated
- ruins
- unexposed

Check one

- unaltered
- altered

Check one

- original site
- moved date _____

Describe the present and original (if known) physical appearance

- summary paragraph
- completeness
- clarity
- alterations/integrity
- dates
- boundary selection

*Please describe the additional
features of the property indicated
on sketch map.*

8. Significance

Period Areas of Significance—Check and justify below

Specific dates Builder/Architect
Statement of Significance (in one paragraph)

- summary paragraph
- completeness
- clarity
- applicable criteria
- justification of areas checked
- relating significance to the resource
- context
- relationship of integrity to significance
- justification of exception
- other

Please assess the significance of the additional features included within the boundary and classify as either contributing or noncontributing.

9. Major Bibliographical References

10. Geographical Data

Acreage of nominated property _____
Quadrangle name _____
UTM References _____

Verbal boundary description and justification

11. Form Prepared By

12. State Historic Preservation Officer Certification

The evaluated significance of this property within the state is:

___ national ___ state ___ local

State Historic Preservation Officer signature

title date

13. Other

- Maps
- Photographs
- Other

Please label sketch map in accordance w/evaluation & description previously noted.

Questions concerning this nomination may be directed to Beth Savage (202) 343-9550

Signed Patrick Adams Date 9/24/86 Phone: _____

**United States Department of the Interior
National Park Service**

**National Register of Historic Places
Inventory—Nomination Form**

For NPS use only

received

7/30/87

date entered

Continuation sheet

Item number 7, 8

Page 65A

Solon, John, House (Site No. 1963) - 617 Solon Road

Description:

All five buildings in the Solon House complex are considered contributing.

The structure labeled on the site plan as "First Dwelling" is a two-story structure that stands to the north of the main house. It features a hip roof and single rooms on each floor. It rests upon a raised foundation and it is currently used for storage purposes.

The other outbuildings indicated on the site plan are all of board-and-batten construction with gable roofs. They were built in the early twentieth century, and relatively few changes have affected their integrity.

Significance:

The 1894 Solon House is of particular note as a substantial, rural residence reflecting Romanesque stylistic influence. Both style and materials are most often associated with larger city, commercial and institutional buildings in Texas, and their use in the Solon House is exceptional.

All of the associated outbuildings shown on the site plan are at least 50 years old and remain functional structures within this rural complex. Because they are virtually unaltered, all are regarded as contributing elements. The most significant is the structure labeled "First Dwelling." According to the current owner, it was erected in the 1880s and served as John Solon's residence while he was building the main house. The other structures were built in the early twentieth century, and their historic and current functions are listed on the site plan for identification purposes. In addition to extant buildings on the grounds, historic landscaping features are noted and also contribute to the historic character of the site.

United States Department of the Interior
National Park Service

National Register of Historic Places
Inventory—Nomination Form

For NPS use only
received 7/30/87
date entered

Continuation sheet

Item number 4

Page 65B

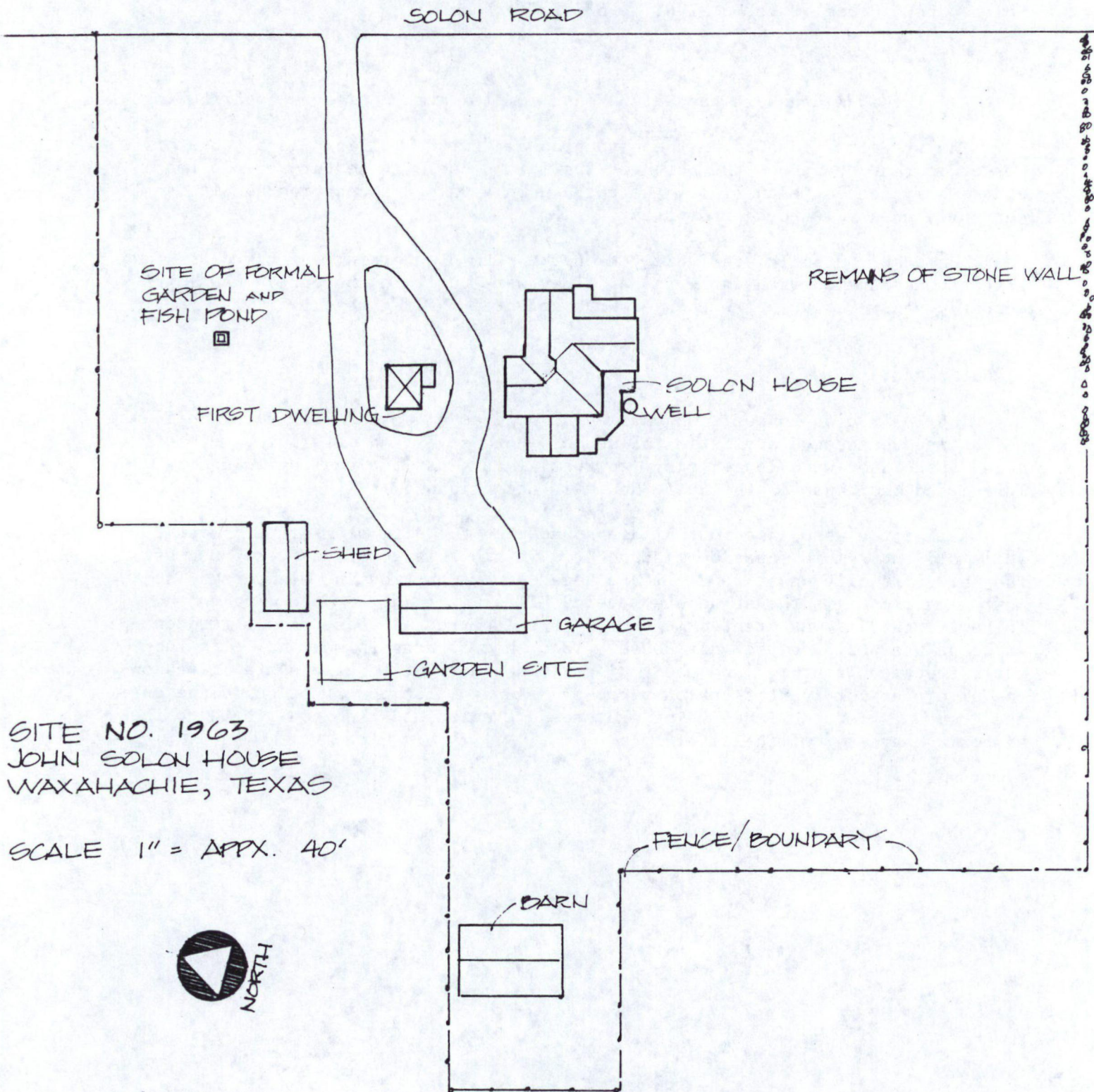

SITE NO. 1963
JOHN SOLON HOUSE
WAXAHACHIE, TEXAS

SCALE 1" = APPX. 40'



United States Department of the Interior
National Park Service

National Register of Historic Places
Inventory—Nomination Form

For NPS use only
received AUG 11 1986
date entered

Continuation sheet

Item number

Page

Multiple Resource Area
Thematic Group

Name Waxahachie Multiple Resource Area
State Ellis County, TEXAS

Nomination/Type of Review

Date/Signature

61. Second Trinity University
Campus

~~Substantive Review~~ Keeper

Patrick Andrus 9/22/87 S

Attest

Bruce J. Noble, Jr. 9/4/87

62. Sims, O.B., House

Entered in the
National Register Keeper

Melous Byers 9/24/86

Attest

63. Solon, John, House

~~Substantive Review~~ Keeper

Patrick Andrus 9/11/87

Attest

Bruce J. Noble, Jr. 9/4/87

64. St. Paul's Episcopal
Church

Entered in the
National Register Keeper

Melous Byers 9/24/86

Attest

65. Templeton, Judge M.B.,
House

~~Substantive Review~~ Keeper

Patrick Andrus 9/24/86

Attest

Betty Savage 9/24/86

66. Thompson, D.H., House

Entered in the
National Register Keeper

Melous Byers 9/24/86

Attest

67. Trippet--Shive House

~~Substantive Review~~ Keeper

Patrick Andrus 9/24/86

Attest

Betty Savage 9/24/86

68. Vickery, Richard, House

Entered in the
National Register Keeper

Melous Byers 9/25/86

Attest

69. Waxahachie Lumber Company

~~Substantive Review~~ Keeper

Patrick Andrus 9/11/87 S

Attest

Bruce J. Noble, Jr. 9/4/87

70. West End Historic District

Entered in the
National Register Keeper

Melous Byers 9/24/86

Attest

Noting
done
9/29/86

NATIONAL REGISTER OF HISTORIC PLACES
EVALUATION/RETURN SHEET

Solon, John, House (Waxahachie MRA)
Ellis County
TEXAS

Instantaneous Review

Working No. 8/11/86
Fed. Reg. Date: 2/2/88
Date Due: 9/12/87
Action: ACCEPT 9-11-87
 RETURN
 REJECT
Federal Agency: _____

- resubmission
- nomination by person or local government
- owner objection
- appeal

Substantive Review: sample request appeal NR decision

Reviewer's comments: *Significant under criterion C as one of Waxahachie's most architecturally noteworthy structures and as one of the few stone-built structures in the area. John Solon, owner builder and original occupant of the house, was an Irish immigrant stone mason. Nomination was originally returned because several other structures located within the boundaries of the nominated property were not designated*

Recom./Criteria Accept - C
Reviewer Noble
Discipline Historian
Date 9/11/87
_____ see continuation sheet

Nomination returned for: _____ technical corrections cited below
_____ substantive reasons discussed below *as contributing or non-contributing. the resubmission has designated all as contributing and justified their significance.*

1. Name

2. Location

3. Classification

Category	Ownership	Status	Present Use
	Public Acquisition	Accessible	

4. Owner of Property

5. Location of Legal Description

6. Representation in Existing Surveys

Has this property been determined eligible? yes no

7. Description

Condition excellent good fair deteriorated ruins unexposed

Check one unaltered altered

Check one original site moved date _____

Describe the present and original (if known) physical appearance

- summary paragraph
- completeness
- clarity
- alterations/integrity
- dates
- boundary selection

8. Significance

Period _____ Areas of Significance—Check and justify below

Specific dates _____ Builder/Architect _____
Statement of Significance (*in one paragraph*)

- summary paragraph
- completeness
- clarity
- applicable criteria
- justification of areas checked
- relating significance to the resource
- context
- relationship of integrity to significance
- justification of exception
- other

9. Major Bibliographical References

10. Geographical Data

Acreage of nominated property _____
Quadrangle name _____
UTM References _____

Verbal boundary description and justification _____

11. Form Prepared By

12. State Historic Preservation Officer Certification

The evaluated significance of this property within the state is:

____ national ____ state ____ local

State Historic Preservation Officer signature _____

title _____ date _____

13. Other

- Maps
- Photographs
- Other

Questions concerning this nomination may be directed to _____

Signed _____ Date _____ Phone: _____



"Historic Resources of Waxahachie, Texas"
Multiple-Resource Nomination;
Waxahachie, Ellis County, Texas
Photo: Hardy-Heck-Moore, Inc., 1985-86
Negative filed at the Texas Historical
Commission, Austin, Texas
Subject: St. Paul's Episcopal Church
Site No. 1311 - 308 N. Monroe
Camera looking: southeast
Photo 52 of 104

Please refer to the map in the
Multiple Property Cover Sheet
for this property

Multiple Property Cover Sheet Reference Number: 64000856