

United States Department of the Interior National Park Service National Register of Historic Places Inventory—Nomination Form

For NPS use only
received DEC 2 1985
date entered 11 4 1986

Continuation sheet Item number all Page 64

TEXAS HISTORIC SITES INVENTORY FORM — TEXAS HISTORICAL COMMISSION (rev.8-82)

1. County Williamson WM
City/Rural Georgetown GE
2. Name J. J. Johnson Farm
Address Rabbit Hill Road,
3.7 mi. south of County Courthouse
3. Owner C.J. Johnson
Address Route 3 Box 125-L, Georgetown
4. Block/Lot see site plan 78626
5. USGS Quad No. 3097-312 Site No. 900, Photo 60
UTM Sector 627-3383
6. Date: Factual _____ Est. 1860
7. Architect/Builder J. J. Johnson
Contractor _____
8. Style/Type I-house
9. Original Use residential
Present Use residential
10. Description Two-story stone dwelling with I-house plan; exterior walls with stucco veneer; gable roof with lock-seam metal covering; front elevation faces east; two exterior stone chimneys with corbeled cap; wood-sash double-hung windows with 6/6 lights; single-door entrance with transom and sidelights; five-bay
11. Present Condition good
12. Significance Primary area of significance: architecture, historical associations. Outstanding and rare example of finely crafted, stone, I house; one of earliest remaining structures built by Swedish immigrants in the area; has remained in
13. Relationship to Site: Moved _____ Date _____ or Original Site (describe) rural setting south of town
14. Bibliography Tax rolls
15. Informant Mr. Johnson
16. Recorder A. Taylor/HHM Date July 1984

DESIGNATIONS

PHOTO DATA

TNRIS No. _____ Old THC Code _____ B&W 4x5s _____ Slides _____

NR: RTHL HABS (no.) TEX _____
 Individual Historic District
 Thematic Multiple-Resource

Other _____

35mm Negs					
YEAR	DRWR	ROLL	FRME	ROLL	FRME
		70	3	70	15

to _____
to _____
to _____

CONTINUATION PAGE

No. 2 of 2

TEXAS HISTORIC SITES INVENTORY FORM — TEXAS HISTORICAL COMMISSION (rev.8-82)

1. County Williamson WM
City/Rural Georgetown GE
2. Name J. J. Johnson Farm
5. USGS Quad No. 3097-312 Site No. 900
UTM Pt. 14/627380/3383960
Acreage less than one acre

#10. Description (cont'd): two-story porch with shed roof across east elevation; chamfered wood posts, turned wooden balustrade; jigsaw brackets. Out-buildings include servants' house (see attached form), frame shed, and board-and-batten barn.

#12. Significance (cont'd): the family of original owner, J. J. Johnson, and has served as operating farm for over 100 years.

United States Department of the Interior
National Park Service

National Register of Historic Places
Inventory—Nomination Form

For NPS use only
received DEC 2 1985
date entered

Continuation sheet

Item number all

Page 65

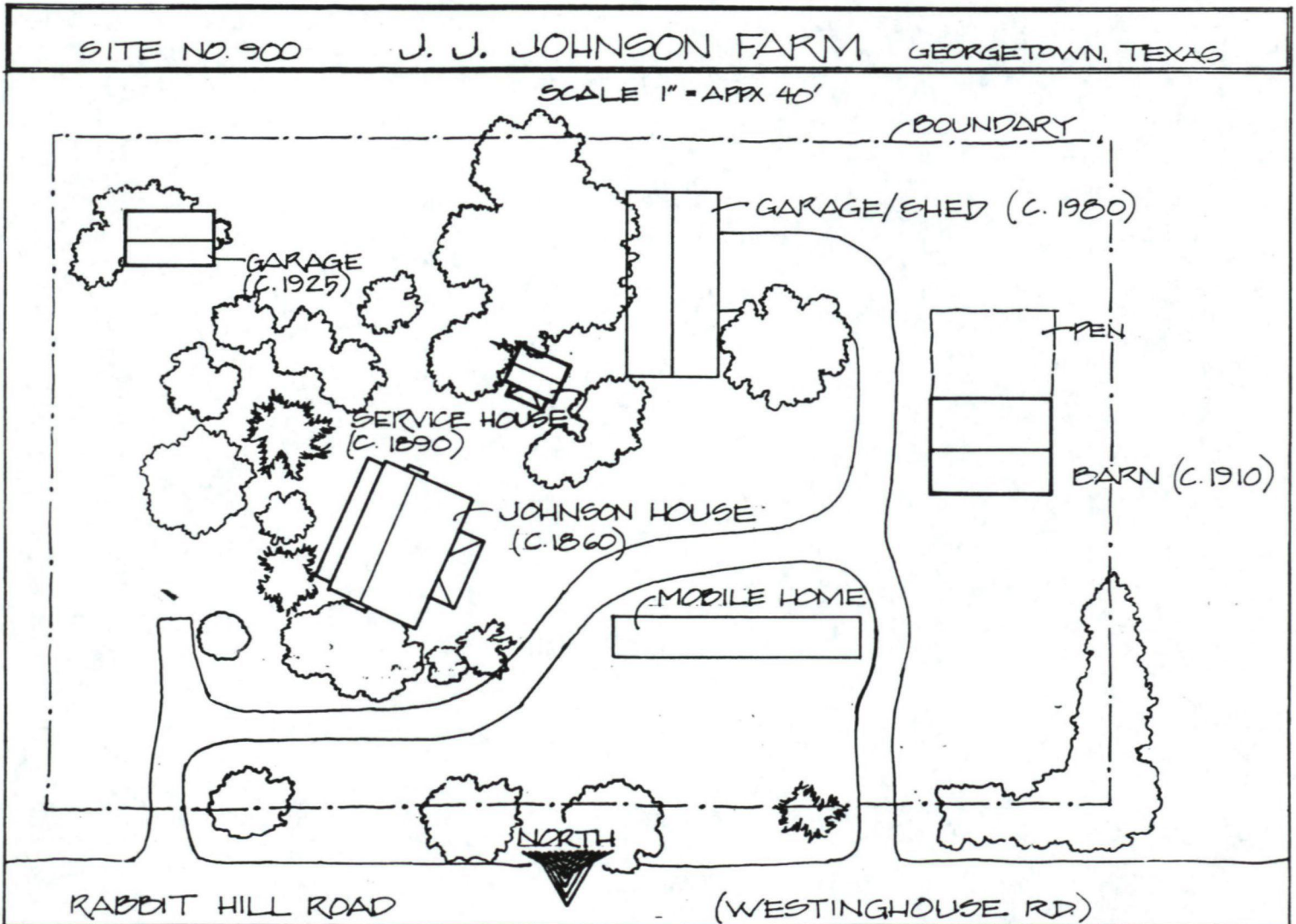

United States Department of the Interior
National Park Service

National Register of Historic Places
Inventory—Nomination Form

For NPS use only
received 12/2/85
date entered

Continuation sheet

Item number

Page

Multiple Resource Area
Thematic Group

Name Georgetown MRA
State Williamson County, TEXAS

Nomination/Type of Review

Date/Signature

21. Hawnen, A. W., House

Entered in the
National Register

for Keeper

Delores Byers 4/29/86

Attest

22. Harper-Chesser House

Entered in the
National Register

for Keeper

Delores Byers 4/29/86

Attest

23. Hyer, Dr. Robert, House

Substantive Review

Keeper

Linda McClelland 4/14/86

Attest

24. Imhoff House

Entered in the
National Register

for Keeper

Delores Byers 4/29/86

Attest

25. Irvine, George, House

Entered in the
National Register

for Keeper

Delores Byers 4/29/86

Attest

26. Johnson, J.J., Farm

Substantive Review

Keeper

Linda McClelland 4/14/86

Attest

27. Lane-Riley House

Entered in the
National Register

for Keeper

Delores Byers 4/29/86

Attest

28. Leake, Will & Mary, House

Substantive Review

Keeper

Linda McClelland 4/29/86

Attest

29. Love, Frank & Mellie,
House

Substantive Review

Keeper

Linda McClelland 4/29/86

Attest

30. Leavell, John, House

Substantive Review

Keeper

Linda McClelland 4/29/86

Attest

86000178

NATIONAL REGISTER OF HISTORIC PLACES
EVALUATION/RETURN SHEET

Substantive Review

Johnson, J. J., Farm (Georgetown MRA)
Williamson County
TEXAS

Working No. DEC 2 1985
Fed. Reg. Date: 2/3/87
Date Due: 1/3/86 - 1/14/86
Action: ACCEPT 1-14-86
 RETURN
 REJECT
Federal Agency: _____

- resubmission
- nomination by person or local government
- owner objection
- appeal

Substantive Review: sample request appeal NR decision

Reviewer's comments: *Inventory sheet is further supported by discussion of context in cover nomination to support eligibility under criterion C "Architecture": Rare surviving example of stone house, see supplementary listing sheet.*

Recom./Criteria Accept for C
Reviewer L. McClelland
Discipline Arch Hist.
Date 1/14/86
_____ see continuation sheet

Nomination returned for: technical corrections cited below *house, see supplementary listing sheet.*
 substantive reasons discussed below

1. Name _____

2. Location _____

3. Classification

Category	Ownership	Status	Present Use
	Public Acquisition	Accessible	

4. Owner of Property _____

5. Location of Legal Description _____

6. Representation in Existing Surveys

Has this property been determined eligible? yes no

7. Description

- Condition
- excellent
 - good
 - fair
 - deteriorated
 - ruins
 - unexposed
- Check one
- unaltered
 - altered
- Check one
- original site
 - moved date _____

Describe the present and original (if known) physical appearance

- summary paragraph
- completeness
- clarity
- alterations/integrity
- dates
- boundary selection

8. Significance

Period Areas of Significance—Check and justify below

Specific dates Builder/Architect

Statement of Significance (in one paragraph)

- summary paragraph
- completeness
- clarity
- applicable criteria
- justification of areas checked
- relating significance to the resource
- context
- relationship of integrity to significance
- justification of exception
- other

Historical associations have not been justified as significant to warrant eligibility under A or B. Area of Historic association has not been identified ("ethnic history"? "agriculture"? etc.).

9. Major Bibliographical References

X 10. Geographical Data

Acreage of nominated property _____

Quadrangle name _____

UTM References _____

X Verbal boundary description and justification

this is being used for VBD. Please provide scale for site map semi

11. Form Prepared By

12. State Historic Preservation Officer Certification

The evaluated significance of this property within the state is:

___ national ___ state ___ local

State Historic Preservation Officer signature

title date

13. Other

- Maps
- Photographs
- Other

Questions concerning this nomination may be directed to _____

Signed _____ Date _____ Phone: _____



"Historic Resources of Georgetown, Texas" Multiple-
Resource Nomination; city limits and extraterritorial
jurisdiction of Georgetown, Williamson County, Texas.
Photo: Daniel Hardy, 1984; neg. with Texas Historical
Commission, Austin.

Site No. 900, Johnson House, off Rabbit Hill Rd., 3.7
miles south of courthouse, camera looking
northeast.

Photo 60 of 75

Please refer to the map in the
Multiple Property Cover Sheet
for this property

Multiple Property Cover Sheet Reference Number: 64000843