

United States Department of the Interior
National Park ServiceNational Register of Historic Places
Inventory—Nomination Form

For NPS use only

received

date entered

Continuation sheet

Item number all

Page 39

SITE NO. 14

NAME

Wilson homesite

LOCATION

~~3 1/4~~ miles west of Clifton, Bosque County, Texas,
on F. Wilson survey

OWNER

Henry Sanders
Route 2
Clifton, Texas 76634

PRESENT USE

Ruins, agriculture

CATEGORY

Building, site

STATUS

Unoccupied

QUADRANGLE NAME

Sugarloaf Mountain, Texas

QUADRANGLE SCALE

1:24000

UTM REFERENCE

14/629830/3516500

ACREAGE

less than 1 acre

PHOTO REFERENCE NO.

24

DESCRIPTION

The Wilson homesite is located on level terrain at the southern end of Bee Rock Flats, in a remote location that makes it almost inaccessible by car. According to local residents, the structure burned around 1950; thus it now stands without a roof. The house was rectangular in plan, had a gabled roof, and faced west. Its plaster finish has deteriorated to such an extent that the limestone construction is visible, along with the original mud and clay mortar. Large stone lintels span each of the openings, but all of the original doors and window sashes are gone. The ends of the north and south walls are steeply pitched. An exterior stone chimney rises from the north end, and window openings on both floors flank either side of this chimney. On the south wall, a central doorway and a window opening pierce the ground level and an off-center doorway pierces the gable. An external stairway probably extended from the southwest corner of the house to this doorway, allowing access to a loft. A concrete wall and stone-lined underground cistern are located west of the house. Other significant features

**United States Department of the Interior
National Park Service**

**National Register of Historic Places
Inventory—Nomination Form**

For NPS use only

received

date entered

Continuation sheet

Item number all

Page 40

on the farm include the remains of a dug-out cellar, the foundations of two outbuildings, and what may be the graves of the settlers. A rich surface scatter of potshards and historic refuse was observed.

SIGNIFICANCE

This housesite, which has been abandoned since it burned about 1950, was apparently the home of either Fred or John Wilson. Its age is unknown, but its construction with mud and clay mortar seems to indicate an early date, possibly to the 1860s. Close inspection of the site revealed a quantity of crockery shards, wood fragments, and other historic objects that argue for its archeological potential.

United States Department of the Interior
National Park Service

National Register of Historic Places
Inventory—Nomination Form

For NPS use only

received

date entered

Continuation sheet

Item number a11

Page 41

AREA TO BE NOMINATED

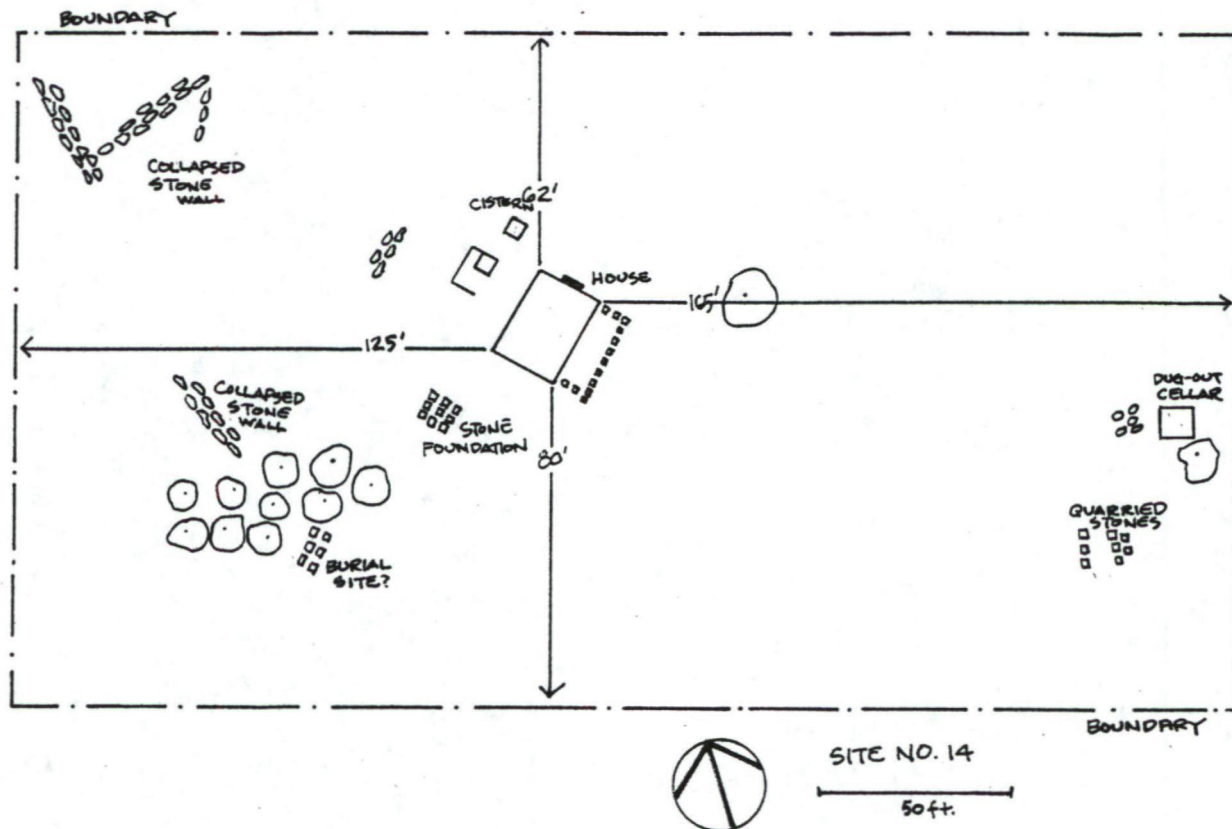

United States Department of the Interior
National Park Service

**National Register of Historic Places
Inventory—Nomination Form**

For NPS use only

received

date entered

Continuation sheet

Item number

Page 4 of 4

Multiple Resource Area
Thematic Group

Name Norwegian Settlement of Bosque County Thematic Resources
State Texas

Nomination/Type of Review

Date/Signature

191 31. Ringness, Jens and Kari,
Farm

Entered in the
National Register

for Keeper

7/22/83 Delores Byers

Attest

32. Rogstad, Tom and Martha,
Farm

Entered in the
National Register

for Keeper

7/22/83 Delores Byers

Attest

33. Schultz, Tobias and
Wilhelmine, Farm

Entered in the
National Register

for Keeper

7/22/83 Delores Byers

Attest

34. Shefstad, Gunarus and
Ingerborg, House

Entered in the
National Register

for Keeper

7/22/83 Delores Byers

Attest

201 35. Upper Settlement Rural
Historic District

Substantive Review

Keeper

Bob Grosvenor 7/22/83

Attest

202 36. Wilson Homesite

Entered in the
National Register

for Keeper

7/22/83 Delores Byers

Attest

37.

Keeper

Attest

38.

Keeper

Attest

39.

Keeper

Attest

40.

Keeper

Attest

NATIONAL REGISTER OF HISTORIC PLACES

EVALUATION / RETURN SHE

United States Department of the Interior
National Park Service

Wilson Homesite (Norwegian Settlement of
Bosque County TR)
Bosque County
TEXAS

Working No. JUN 9 1983
Fed. Reg. Date: 2.7.84
Date Due: 7/7/83-7/24/83
Action: ☒ ACCEPT 7/22/83
☐ RETURN
☐ REJECT
Entered in ~~the~~ National Register
Federal Agency: _____

☐ resubmission
☐ nomination by person or local government
☐ owner objection
☐ appeal

Substantive Review: ☐ sample ☐ request ☐ appeal ☐ NR decision

Reviewer's comments: _____

Recom./Criteria _____
Reviewer _____
Discipline _____
Date _____
☐ see continuation sheet

Nomination returned for: ☐ technical corrections cited below
☐ substantive reasons discussed below

1. Name

2. Location

3. Classification

Category	Ownership	Status	Present Use
	Public Acquisition	Accessible	

4. Owner of Property

5. Location of Legal Description

6. Representation in Existing Surveys

Has this property been determined eligible? ☐ yes ☐ no

7. Description

Condition	Check one	Check one
<input type="checkbox"/> excellent	<input type="checkbox"/> deteriorated	<input type="checkbox"/> original site
<input type="checkbox"/> good	<input type="checkbox"/> ruins	<input type="checkbox"/> moved date _____
<input type="checkbox"/> fair	<input type="checkbox"/> unexposed	

Describe the present and original (if known) physical appearance

☐ summary paragraph
☐ completeness
☐ clarity
☐ alterations/integrity
☐ dates
☐ boundary selection

8. Significance

Period _____ Areas of Significance—Check and justify below

Specific dates _____ Builder/Architect _____

Statement of Significance (in one paragraph)

- _____ summary paragraph
- _____ completeness
- _____ clarity
- _____ applicable criteria
- _____ justification of areas checked
- _____ relating significance to the resource
- _____ context
- _____ relationship of integrity to significance
- _____ justification of exception
- _____ other

9. Major Bibliographical References

10. Geographical Data

Acreage of nominated property _____

Quadrangle name _____

USGS References

Verbal boundary description and justification

11. Form Prepared By

12. State Historic Preservation Officer Certification

The evaluated significance of this property within the state is:

_____ national _____ state _____ local

State Historic Preservation Officer signature _____

title _____ date _____

13. Other

- _____ Maps
- _____ Photographs
- _____ Other

Questions concerning this nomination may be directed to _____

Signed _____ Date _____ Phone: 202 272 - 3504

Comments for any item may be continued on an attached sheet



The Norwegian Settlement of Bosque County

Site No. 14, Wilson Homesite, 3¼ miles west
of Clifton, Bosque County, Texas

Photograph: July 1979, by Daniel Hardy

On file, Texas Historical Commission

View of house, looking southeast

Photo 24 of 72

Please refer to the map in the
Multiple Property Cover Sheet
for this property

Multiple Property Cover Sheet Reference Number: 64000849