

United States Department of the Interior
National Park ServiceNational Register of Historic Places
Inventory—Nomination Form

For NPS use only

received

date entered

Continuation sheet

Item number all

Page 74

SITE NO. 26

NAME Tobias and Wilhelmine Schultz farm

LOCATION ~~10 miles~~ southwest of Clifton, Bosque County,
Texas, on W. Winkler surveyOWNER Fred Braun
Box 866
Southlake, Texas 76092

PRESENT USE Private residence, agriculture

CATEGORY Buildings

STATUS Unoccupied

QUADRANGLE NAME Hurst Springs, Texas

QUADRANGLE SCALE 1:24000

UTM REFERENCE 14/618880/3512930

ACREAGE about 3 acres

PHOTO REFERENCE NO. 39

DESCRIPTION

Situated atop a gently rolling hill, the Tobias and Wilhelmine Schultz farm is in good condition and includes a complex of structures retaining much of their historic integrity. A one-and-a-half-story, wood-frame structure with a T-shaped plan, the house serves as a residence today. With its symmetrical composition and central gable, the front (south) facade strongly, resembles that of the Bekken (no. 27) and Dahl houses (no. 25). A one-story porch with balcony extends over the single-door front entrance and is decorated with a broad band of diamond-shaped shingles across the top. The porch is supported by turned posts. The jig-cut wooden balusters of this balcony are in poor condition. Double-hung windows have two-over-two lights with vertical muntins. A one-

**United States Department of the Interior
National Park Service**

**National Register of Historic Places
Inventory—Nomination Form**

For NPS use only

received

date entered

Continuation sheet

Item number all

Page 75

story addition extends across the rear of the house and is the only significant exterior alteration. Wooden shingles in poor condition cover the intersecting gables, and interior brick chimneys rise out of the west and north gable ends. A number of outbuildings stand behind the house and include a stuccoed stone smokehouse, frame barn, and several small sheds. All these structures contribute to the historic character of the farm.

SIGNIFICANCE

This house is believed to have been built for Tobias and Wilhelmine Schultz. According to tax records, they owned this land by 1893. The date of the frame house is not known, but judging from similarly styled houses whose completion dates are well documented, it was probably built about 1895. Since that time it has remained virtually unaltered and, along with its associated outbuildings, provides one of the best and most intact examples of a late 19th-century farm in the area.

United States Department of the Interior
National Park Service

National Register of Historic Places
Inventory—Nomination Form

For NPS use only

received

date entered

Continuation sheet

Item number all

Page 76

AREA TO BE NOMINATED

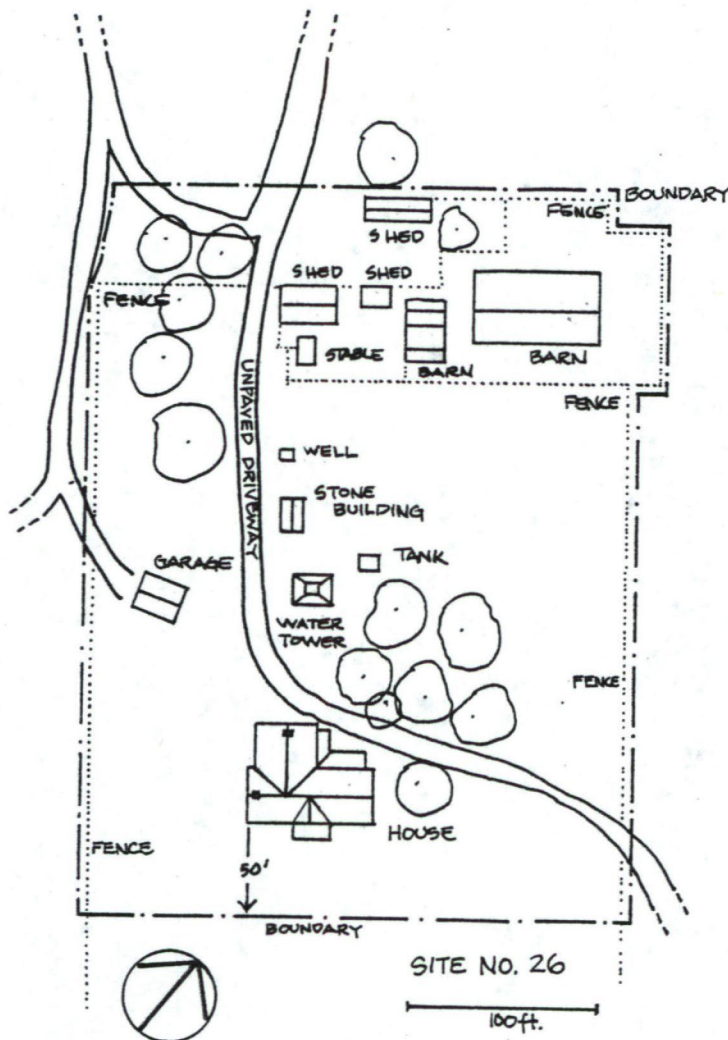

United States Department of the Interior
National Park Service

**National Register of Historic Places
Inventory—Nomination Form**

For NPS use only

received

date entered

Continuation sheet

Item number

Page 4 of 4

Multiple Resource Area
Thematic Group

Name Norwegian Settlement of Bosque County Thematic Resources

State Texas

Nomination/Type of Review

Date/Signature

191 31. Ringness, Jens and Kari,
Farm

Entered in the
National Register

for Keeper

7/22/83 Delores Byers

Attest

32. Rogstad, Tom and Martha,
Farm

Entered in the
National Register

for Keeper

7/22/83 Delores Byers

Attest

33. Schultz, Tobias and
Wilhelmine, Farm

Entered in the
National Register

for Keeper

7/22/83 Delores Byers

Attest

34. Shefstad, Gunarus and
Ingerborg, House

Entered in the
National Register

for Keeper

7/22/83 Delores Byers

Attest

201 35. Upper Settlement Rural
Historic District

Substantive Review

Keeper

Bob Groszner 7/22/83

Attest

202 36. Wilson Homesite

Entered in the
National Register

for Keeper

7/22/83 Delores Byers

Attest

37.

Keeper

Attest

38.

Keeper

Attest

39.

Keeper

Attest

40.

Keeper

Attest

NATIONAL REGISTER OF HISTORIC PLACES

EVALUATION / RETURN SHE

United States Department of the Interior
National Park Service

Schultz, Tobias and Wilhelmine, Farm
(Norwegian Settlement of Bosque County TR)
Bosque County
TEXAS

Working No. JUN 9 1983

Fed. Reg. Date: 2.7.84

Date Due: 7/7/83 - 7/24/83

Action: ☒ ACCEPT 7/22/83

Entered in ~~TR~~ ☐ RETURN

National Register ☐ REJECT

Federal Agency: _____

- ☐ resubmission
☐ nomination by person or local government
☐ owner objection
☐ appeal

Substantive Review: ☐ sample ☐ request ☐ appeal ☐ NR decision

Reviewer's comments: _____

Recom./Criteria _____

Reviewer _____

Discipline _____

Date _____

see continuation sheet

Nomination returned for: ☐ technical corrections cited below
☐ substantive reasons discussed below

1. Name

2. Location

3. Classification

Category	Ownership	Status	Present Use
	Public Acquisition	Accessible	

4. Owner of Property

5. Location of Legal Description

6. Representation in Existing Surveys

has this property been determined eligible? ☐ yes ☐ no

7. Description

Condition		Check one	Check one
<input type="checkbox"/> excellent	<input type="checkbox"/> deteriorated	<input type="checkbox"/> unaltered	<input type="checkbox"/> original site
<input type="checkbox"/> good	<input type="checkbox"/> ruins	<input type="checkbox"/> altered	<input type="checkbox"/> moved date _____
<input type="checkbox"/> fair	<input type="checkbox"/> unexposed		

Describe the present and original (if known) physical appearance

- ☐ summary paragraph
☐ completeness
☐ clarity
☐ alterations/integrity
☐ dates
☐ boundary selection

8. Significance

Period _____ Areas of Significance—Check and justify below

Specific dates _____ Builder/Architect _____

Statement of Significance (in one paragraph)

- _____ summary paragraph
- _____ completeness
- _____ clarity
- _____ applicable criteria
- _____ justification of areas checked
- _____ relating significance to the resource
- _____ context
- _____ relationship of integrity to significance
- _____ justification of exception
- _____ other

9. Major Bibliographical References

10. Geographical Data

Acreage of nominated property _____

Quadrangle name _____

UMT References _____

Verbal boundary description and justification _____

11. Form Prepared By

12. State Historic Preservation Officer Certification

The evaluated significance of this property within the state is:

_____ national _____ state _____ local

State Historic Preservation Officer signature _____

Title _____ Date _____

13. Other

- _____ Maps
- _____ Photographs
- _____ Other

Questions concerning this nomination may be directed to _____

Signed _____ Date _____ Phone: 202 272-3504

Comments for any item may be continued on an attached sheet



The Norwegian Settlement of Bosque County

Site No. 26, Tobias and Wilhelmine Schultz
Farm, 10 miles southwest of Clifton, Bosque
County, Texas

Photograph: March 1979, by Daniel Hardy
On file, Texas Historical Commission
View of front facade, looking northeast
Photo 39 of 72

Please refer to the map in the
Multiple Property Cover Sheet
for this property

Multiple Property Cover Sheet Reference Number: 64000849