

United States Department of the Interior
National Park ServiceNational Register of Historic Places
Inventory—Nomination Form

For NPS use only

received

date entered

Continuation sheet

Item number all

Page 22

SITE NO. 8

NAME Olson-Nelson farm

LOCATION 4½ miles west of Clifton, Bosque County,
Texas, on E. Sessom survey

OWNER Orval O. Allen
8450 Westfield
Indianapolis, Indiana 46240

PRESENT USE Vacant, agriculture

CATEGORY Buildings

STATUS Unoccupied

QUADRANGLE NAME Sugarloaf Mountain, Texas

QUADRANGLE SCALE 1:24000

UTM REFERENCE 14/626660/3517740

ACREAGE about 2 acres

PHOTO REFERENCE NO. 17

DESCRIPTION

Overlooking the Meridian Creek valley, the Olson-Nelson farm is situated prominently about a mile south of Meridian Creek, near a pass between Round Mountain and Big Bee Rock. The farm, although presently unoccupied, is in good condition and retains much of its historic integrity. It includes a one-and-a-half-story residence of limestone construction, which conforms to the symmetrical stone-house type. The front, or south, facade has a five-bay composition with a central door. A markedly curved segmental arch with stone voussoirs spans this opening, while stone lintels cap the windows, which are all double hung with six-over-six lights. The east and west ends of the house are virtually identical and have exterior stone chimneys at the gable ends. They originally also had two loft windows, flanking each chimney in the attic story, but these have been

**United States Department of the Interior
National Park Service**

**National Register of Historic Places
Inventory—Nomination Form**

For NPS use only

received

date entered

Continuation sheet

Item number all

Page 23

filled in. A detached, one-story stone structure, which may have been the original kitchen, has been joined to the rear of the house to make a T-shaped overall plan. The entire structure is presently covered with a standing-seam metal roof. A small stone outbuilding with a cellar has been dug into the side of the hill just below the main house. This and the two wood-frame barns that stand nearby contribute to the historic character of the farm.

SIGNIFICANCE

This house was constructed by Ole and Antonette Olson, who apparently arrived in Bosque County in the 1850s. They probably built the house in the 1860s. It was later sold to O. D. (Dan) Nelson, who lived in it for many years. In plan, it is a good example of the symmetrical type of stone house with a kitchen attached at the rear to form a "T". It is majestically sited on a small hill near Round Mountain, along with several other stone and wood-frame structures. Its precise date of construction is unknown.

United States Department of the Interior
National Park Service

National Register of Historic Places
Inventory—Nomination Form

For NPS use only

received

date entered

Continuation sheet

Item number all

Page 24

AREA TO BE NOMINATED

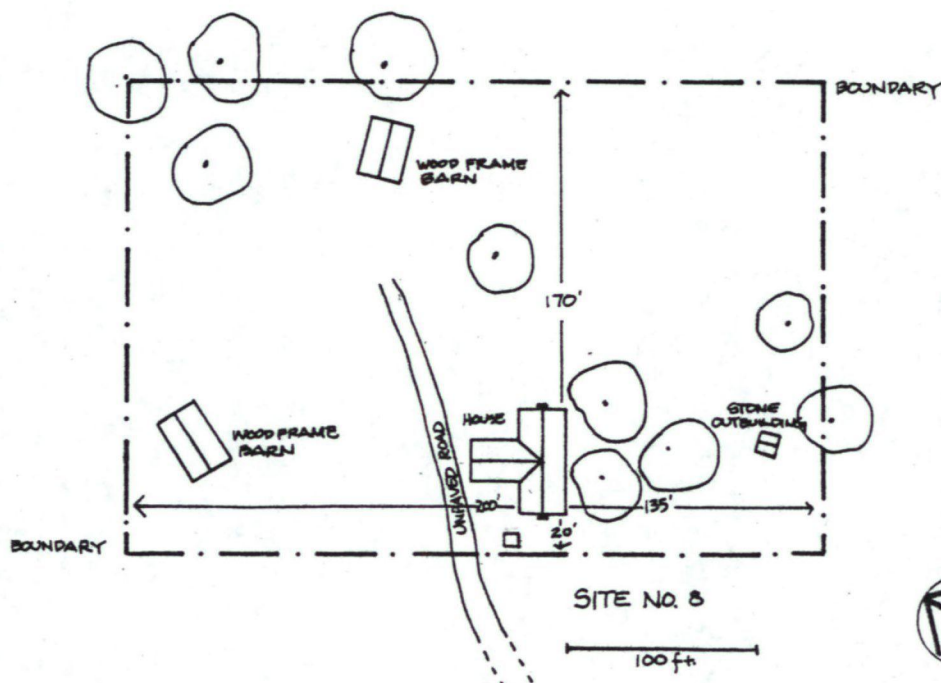

United States Department of the Interior
National Park ServiceNational Register of Historic Places
Inventory—Nomination Form

For NPS use only

received

date entered

Continuation sheet

Item number

Page 3 of 4

Multiple Resource Area
Thematic GroupName Norwegian Settlement of Bosque County Thematic Resources
State Texas

Nomination/Type of Review

			Date/Signature
21. Norway Mill	Entered in the National Register	Keeper	7/22/83 <u>Delores Byers</u>
	Entered in the National Register	Attest	
22. Olson-Hanson Farm		Keeper	7/22/83 <u>Delores Byers</u>
	Entered in the National Register	Attest	
23. Olson, Joseph and Anna, Farm		Keeper	7/22/83 <u>Delores Byers</u>
	Entered in the National Register	Attest	
24. Olson-Nelson Farm		Keeper	7/22/83 <u>Delores Byers</u>
		Attest	
25. Our Savior's Lutheran Church	Substantive Review	Keeper	Return
		Attest	
26. Pederson, John, Farm	Entered in the National Register	Keeper	7/22/83 <u>Delores Byers</u>
		Attest	
27. Pierson, Ole and Ann, Farm	Entered in the National Register	Keeper	7/22/83 <u>Delores Byers</u>
		Attest	
28. Questad, Carl and Sedsel, Farm	Entered in the National Register	Keeper	7/22/83 <u>Delores Byers</u>
	Entered in the National Register	Attest	
29. Reeder-Omenson Farm		Keeper	7/22/83 <u>Delores Byers</u>
		Attest	
30. Reiersen, Hans and Berthe, House	Entered in the National Register	Keeper	7/22/83 <u>Delores Byers</u>
		Attest	

NATIONAL REGISTER OF HISTORIC PLACES

EVALUATION / RETURN SHE

United States Department of the Interior
National Park ServiceOlson-Nelson Farm (Norwegian Settlement of
Bosque County TR)
Bosque County
TEXASWorking No. JUN 9 1983Fed. Reg. Date: 2.7.84Date Due: 7/2/83 - 7/24/83Action: ☒ ACCEPT 7/22/83Entered in ~~the~~ National Register ☐ RETURN☐ REJECT

Federal Agency: _____

- ☐ resubmission
☐ nomination by person or local government
☐ owner objection
☐ appeal

Substantive Review: ☐ sample ☐ request ☐ appeal ☐ NR decision

Reviewer's comments: _____

Recom./Criteria _____

Reviewer _____

Discipline _____

Date _____

☐ see continuation sheet

Nomination returned for: ☐ technical corrections cited below
☐ substantive reasons discussed below

1. Name2. Location3. Classification

Category	Ownership	Status	Present Use
	Public Acquisition	Accessible	

4. Owner of Property5. Location of Legal Description6. Representation in Existing Surveyshas this property been determined eligible? ☐ yes ☐ no7. Description

Condition	Check one	Check one
<input type="checkbox"/> excellent	<input type="checkbox"/> deteriorated	<input type="checkbox"/> unaltered
<input type="checkbox"/> good	<input type="checkbox"/> ruins	<input type="checkbox"/> altered
<input type="checkbox"/> fair	<input type="checkbox"/> unexposed	<input type="checkbox"/> moved date _____

Describe the present and original (if known) physical appearance

- ☐ summary paragraph
☐ completeness
☐ clarity
☐ alterations/integrity
☐ dates
☐ boundary selection

8. Significance

Period _____ Areas of Significance—Check and justify below

Specific dates _____

Builder/Architect _____

Statement of Significance (in one paragraph)

- _____ summary paragraph
- _____ completeness
- _____ clarity
- _____ applicable criteria
- _____ justification of areas checked
- _____ relating significance to the resource
- _____ context
- _____ relationship of integrity to significance
- _____ justification of exception
- _____ other

9. Major Bibliographical References

10. Geographical Data

Acreage of nominated property _____

Quadrangle name _____

USFT References _____

Verbal boundary description and justification _____

11. Form Prepared By

12. State Historic Preservation Officer Certification

The evaluated significance of this property within the state is:

_____ national _____ state _____ local

State Historic Preservation Officer signature _____

title _____

date _____

13. Other

- _____ Maps
- _____ Photographs
- _____ Other

Questions concerning this nomination may be directed to _____

Signed _____ Date _____ Phone: 202 272-3504

Comments for any item may be continued on an attached sheet



The Norwegian Settlement in Bosque County

Site No. 8, Olson-Nelson Farm, $4\frac{1}{2}$ miles west
of Clifton, Bosque County, Texas

Photograph: July 1982, by Ken Breisch

On file, Texas Historical Commission

View of front facade, looking northeast

Photo 17 of 72

Please refer to the map in the
Multiple Property Cover Sheet
for this property

Multiple Property Cover Sheet Reference Number: 64000849