

United States Department of the Interior
National Park ServiceNational Register of Historic Places
Inventory—Nomination Form

For NPS use only

received

date entered

Continuation sheet

Item number all

Page 83

SITE NO. 29

NAME

A.H. Lahlum house

LOCATION

~~7½~~ miles southwest of Clifton, Bosque County,
Texas, on U. Boswell survey

OWNER

Alton Aars
Route 2
Clifton, Texas 76634

PRESENT USE

Storage

CATEGORY

Building

STATUS

Unoccupied

QUADRANGLE NAME

Hurst Springs, Texas

QUADRANGLE SCALE

1:24000

UTM REFERENCE

14/626120/3508360

ACREAGE

less than 1 acre

PHOTO REFERENCE NO. 44

DESCRIPTION

The August Lahlum house is a small one-story farmhouse of board-and-batten construction. The structure was relocated to its present position on the west bank of Neils Creek in 1893, when a new house was erected on its first site. Its original plan was T-shaped, but the addition of a second section on to the back, or western side, of the building in 1893 produced an H-shaped configuration. Small shed-roof porches extend over the single-door entrances of the east and south elevations. The lower, central portion of the roof is pierced by a single brick chimney. This roof of intersecting gables is now covered by deteriorated composition shingles. The windows are double hung with four-over-four lights. Presently used for storage, the structure remains in fair condition.

SIGNIFICANCE

The A.H. Lahlum house is a rare example of a late 19th-century residence in the area that features board-and-batten construction. Its present owner states that it was moved in 1893 to its present location about one-third mile south of the original site. The date of construction is not known, but it was probably erected in the 1880s and is one of the oldest frame houses in the Norwegian settlement.

United States Department of the Interior
National Park Service

**National Register of Historic Places
Inventory—Nomination Form**

For NPS use only

received

date entered

Continuation sheet

Item number all

Page 84

AREA TO BE NOMINATED

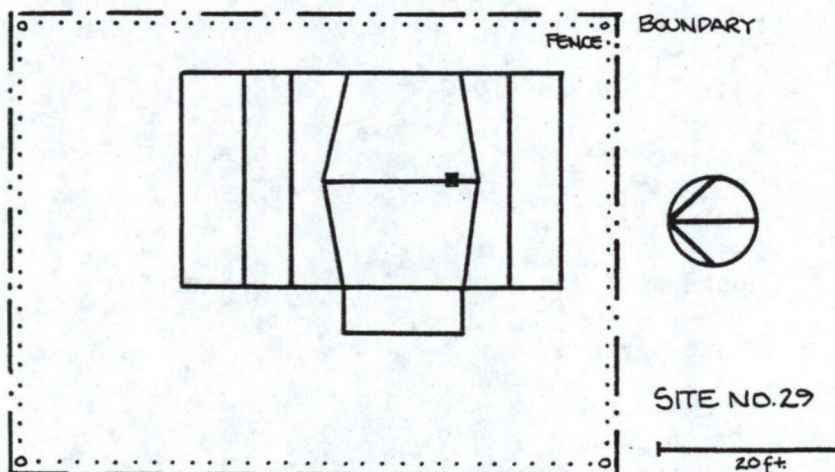

United States Department of the Interior
National Park ServiceNational Register of Historic Places
Inventory—Nomination Form

For NPS use only

received

date entered

Continuation sheet

Item number

Page 2 of 4

Multiple Resource Area
Thematic GroupName Norwegian Settlement of Bosque County Thematic Resources
State Texas

Nomination/Type of Review

Date/Signature

- | | | | |
|--|-------------------------------------|------------|------------------------------|
| 11. Grimland, Gunsten and Lofise, House | Entered in the
National Register | for Keeper | 7/22/83 <i>Delores Byers</i> |
| | | Attest | _____ |
| 12. Grimland, Keddel and Liv, Farm | Entered in the
National Register | for Keeper | 7/22/83 <i>Delores Byers</i> |
| | | Attest | _____ |
| 13. Hanson, Hans, Farm | Substantive Review | Keeper | <i>Return</i> |
| | | Attest | _____ |
| 14. Hoff-Ulland Farm | Entered in the
National Register | for Keeper | 7/22/83 <i>Delores Byers</i> |
| | | Attest | _____ |
| 15. Holen Farm | Substantive Review | Keeper | <i>Return</i> |
| | | Attest | _____ |
| 16. Jenson, James Jens and Martha, House | Entered in the
National Register | for Keeper | 7/22/83 <i>Delores Byers</i> |
| | | Attest | _____ |
| 17. Knudson, Christen and Johanne, Farm | Entered in the
National Register | for Keeper | 7/22/83 <i>Delores Byers</i> |
| | | Attest | _____ |
| 18. Lahlum, A. H., House | Entered in the
National Register | for Keeper | 7/22/83 <i>Delores Byers</i> |
| | | Attest | _____ |
| 19. Larson, Martin, House | Entered in the
National Register | for Keeper | 7/22/83 <i>Delores Byers</i> |
| | | Attest | _____ |
| 20. Linberg, Eric and Martha, Farm | Entered in the
National Register | for Keeper | 7/22/83 <i>Delores Byers</i> |
| | | Attest | _____ |

NATIONAL REGISTER OF HISTORIC PLACES

EVALUATION / RETURN SHE

United States Department of the Interior
National Park ServiceLahlum, A.H., House (Norwegian Settlement of
Bosque County TR)
Bosque County
TEXASWorking No. JUN 9 1983Fed. Reg. Date: 2.7.84Date Due: 7/7/83 - 7/24/83Action: ☒ ACCEPT 7/22/83Entered in the ☐ RETURNNational Register ☐ REJECT

Federal Agency: _____

- ☐ resubmission
☐ nomination by person or local government
☐ owner objection
☐ appeal

Substantive Review: ☐ sample ☐ request ☐ appeal ☐ NR decision

Reviewer's comments: _____

Recom./Criteria _____

Reviewer _____

Discipline _____

Date _____

☐ see continuation sheet

Nomination returned for: ☐ technical corrections cited below
☐ substantive reasons discussed below

1. Name2. Location3. Classification

Category	Ownership	Status	Present Use
	Public Acquisition	Accessible	

4. Owner of Property5. Location of Legal Description6. Representation in Existing Surveyshas this property been determined eligible? ☐ yes ☐ no7. Description

Condition	Check one	Check one
<input type="checkbox"/> excellent	<input type="checkbox"/> deteriorated	<input type="checkbox"/> unaltered
<input type="checkbox"/> good	<input type="checkbox"/> ruins	<input type="checkbox"/> altered
<input type="checkbox"/> fair	<input type="checkbox"/> unexposed	<input type="checkbox"/> moved date _____

Describe the present and original (if known) physical appearance

- ☐ summary paragraph
☐ completeness
☐ clarity
☐ alterations/integrity
☐ dates
☐ boundary selection

8. Significance

Period _____ Areas of Significance—Check and justify below

Specific dates _____ Builder/Architect _____

Statement of Significance (in one paragraph)

- _____ summary paragraph
- _____ completeness
- _____ clarity
- _____ applicable criteria
- _____ justification of areas checked
- _____ relating significance to the resource
- _____ context
- _____ relationship of integrity to significance
- _____ justification of exception
- _____ other

9. Major Bibliographical References

10. Geographical Data

Acreage of nominated property _____

Quadrangle name _____

UMT References _____

Verbal boundary description and justification _____

11. Form Prepared By

12. State Historic Preservation Officer Certification

The evaluated significance of this property within the state is:

_____ national _____ state _____ local

State Historic Preservation Officer signature _____

title _____ date _____

13. Other

- _____ Maps
- _____ Photographs
- _____ Other

Questions concerning this nomination may be directed to _____

Signed _____ Date _____ Phone: 202 272-3504

Comments for any item may be continued on an attached sheet



The Norwegian Settlement of Bosque County

Site No. 29, A.H. Lahlum House, 7½ miles
southwest of Clifton, Bosque County, Texas

Photograph: June 1979, by David Moore

On file, Texas Historical Commission

View of side elevation, looking north

Photo 44 of 72

Please refer to the map in the
Multiple Property Cover Sheet
for this property

Multiple Property Cover Sheet Reference Number: 64000849