

United States Department of the Interior
National Park ServiceNational Register of Historic Places
Inventory—Nomination Form

For NPS use only

received

date entered

Continuation sheet

Item number all

Page 31

SITE NO. 11

NAME

Christen and Johanne Knudson farm

LOCATION

FM 219, 4 $\frac{1}{4}$ miles southwest of Clifton, Bosque
County, Texas, on C. Knutzen survey

OWNER

Emma Byford
Route 2
Clifton, Texas 76634

PRESENT USE

Private residence

CATEGORY

Building

STATUS

Occupied

QUADRANGLE NAME

Sugarloaf Mountain, Texas

QUADRANGLE SCALE

1:24000

UTM REFERENCE

14/628950/3514090

ACREAGE

less than 1 acre

PHOTO REFERENCE NO.

20

DESCRIPTION

The Christen and Johanne Knudson house faces southeast from its prominent position atop a gently rolling hill north of FM 219 and west of Turkey Creek. This structure is in good condition and is still in active use as a residence. Despite several additions and alterations, the house retains its basic integrity. The original structure was a small, one-and-a-half-story residence with a two-room, asymmetrical plan on the ground floor and a sleeping loft above. Built of limestone, it originally had a three-bay facade with a centrally located, single-door entrance. At some later date a frame extension was made to the northeast end of the house, creating a five-bay front with two single, front doors that flank a center window, with two additional windows toward each end. Recently, this frame addition has been covered with aluminum siding. A large gabled porch has been constructed in the center of this extended facade. In spite of

**United States Department of the Interior
National Park Service**

**National Register of Historic Places
Inventory—Nomination Form**

For NPS use only

received

date entered

Continuation sheet

Item number all

Page 32

these additions the original stone portion of the house remains intact. With its gable-end chimney and two-part plan, it represents a good example of the asymmetrical type of stone house. Because of alterations to the corn crib and wellhouse, the residence is the only building of this complex that is to be nominated.

SIGNIFICANCE

Christen and Johanne Knudson arrived in Bosque County in 1868, and were well established by the time of the 1870 U.S. Census and Special Farm Schedule, where they appear as Cris and Johhanna Cannudeson. Presumably, the asymmetrical, two-room stone section of the house was constructed at about that time. Despite the extensive alterations, this early stone house is significant because of its association with the Norwegian settlers of Bosque County.

United States Department of the Interior
National Park Service

National Register of Historic Places
Inventory—Nomination Form

For NPS use only

received

date entered

Continuation sheet

Item number all

Page 33

AREA TO BE NOMINATED

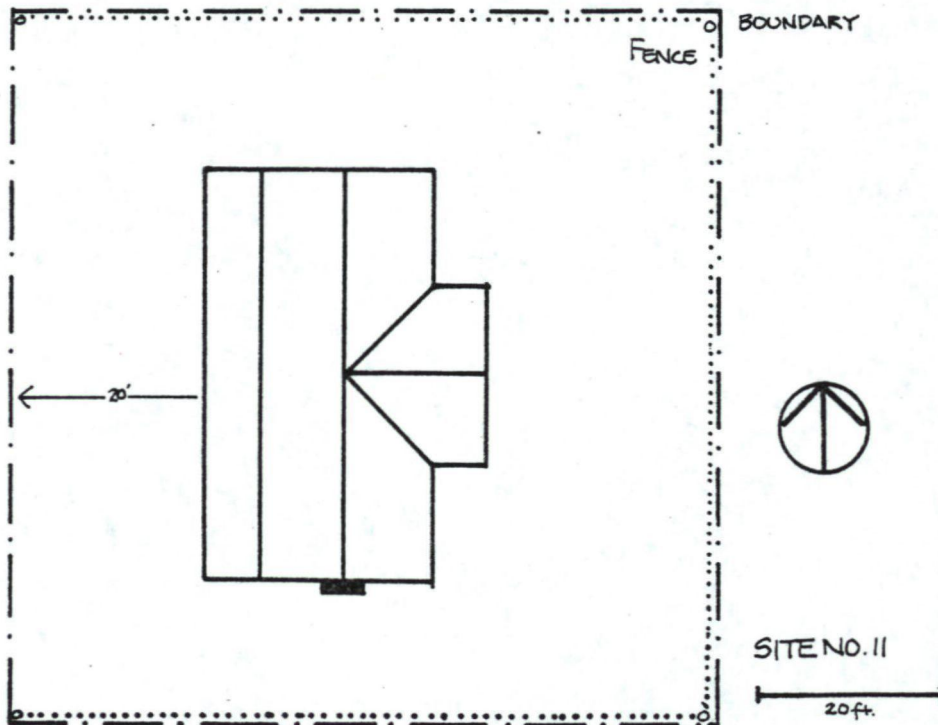

United States Department of the Interior
National Park ServiceNational Register of Historic Places
Inventory—Nomination Form

For NPS use only

received

date entered

Continuation sheet

Item number

Page 2 of 4

Multiple Resource Area
Thematic GroupName Norwegian Settlement of Bosque County Thematic Resources
State Texas

Nomination/Type of Review

Date/Signature

- | | | | |
|--|-------------------------------------|------------|------------------------------|
| 11. Grimland, Gunsten and Lofise, House | Entered in the
National Register | for Keeper | 7/22/83 <u>Delores Byers</u> |
| | | Attest | _____ |
| 12. Grimland, Keddel and Liv, Farm | Entered in the
National Register | for Keeper | 7/22/83 <u>Delores Byers</u> |
| | | Attest | _____ |
| 13. Hanson, Hans, Farm | Substantive Review | Keeper | <u>Return</u> |
| | | Attest | _____ |
| 14. Hoff-Ulland Farm | Entered in the
National Register | for Keeper | 7/22/83 <u>Delores Byers</u> |
| | | Attest | _____ |
| 15. Holen Farm | Substantive Review | Keeper | <u>Return</u> |
| | | Attest | _____ |
| 16. Jensen, James Jens and Martha, House | Entered in the
National Register | for Keeper | 7/22/83 <u>Delores Byers</u> |
| | | Attest | _____ |
| 17. Knudson, Christen and Johanne, Farm | Entered in the
National Register | for Keeper | 7/22/83 <u>Delores Byers</u> |
| | | Attest | _____ |
| 18. Lahlum, A. H., House | Entered in the
National Register | for Keeper | 7/22/83 <u>Delores Byers</u> |
| | | Attest | _____ |
| 19. Larson, Martin, House | Entered in the
National Register | for Keeper | 7/22/83 <u>Delores Byers</u> |
| | | Attest | _____ |
| 20. Linberg, Eric and Martha, Farm | Entered in the
National Register | for Keeper | 7/22/83 <u>Delores Byers</u> |
| | | Attest | _____ |

NATIONAL REGISTER OF HISTORIC PLACES

EVALUATION / RETURN SHE

United States Department of the Interior
National Park ServiceKnudson, Christen and Johanne, Farm
(Norwegian Settlement of Bosque County TR)
Bosque County
TEXASWorking No. JUN 9 1983
Fed. Reg. Date: 2-7-84
Date Due: 7/7/83 - 7/24/83
Action: ☒ ACCEPT 7/22/83
Entered in the ☐ RETURN
National Register ☐ REJECT
Federal Agency: _____☐ resubmission
☐ nomination by person or local government
☐ owner objection
☐ appealSubstantive Review: ☐ sample ☐ request ☐ appeal ☐ NR decision

Reviewer's comments: _____

Recom./Criteria _____
Reviewer _____
Discipline _____
Date _____
☐ see continuation sheetNomination returned for: ☐ technical corrections cited below
☐ substantive reasons discussed below1. Name2. Location3. Classification

Category	Ownership	Status	Present Use
	Public Acquisition	Accessible	

4. Owner of Property5. Location of Legal Description6. Representation in Existing SurveysHas this property been determined eligible? ☐ yes ☐ no7. Description

Condition	Check one	Check one
<input type="checkbox"/> excellent	<input type="checkbox"/> deteriorated	<input type="checkbox"/> original site
<input type="checkbox"/> good	<input type="checkbox"/> ruins	<input type="checkbox"/> moved date _____
<input type="checkbox"/> fair	<input type="checkbox"/> unexposed	

Describe the present and original (if known) physical appearance

☐ summary paragraph
☐ completeness
☐ clarity
☐ alterations/integrity
☐ dates
☐ boundary selection

8. Significance

Period _____ Areas of Significance—Check and justify below

Specific dates _____ Builder/Architect _____

Statement of Significance (in one paragraph)

- _____ summary paragraph
- _____ completeness
- _____ clarity
- _____ applicable criteria
- _____ justification of areas checked
- _____ relating significance to the resource
- _____ context
- _____ relationship of integrity to significance
- _____ justification of exception
- _____ other

9. Major Bibliographical References

10. Geographical Data

Address of nominated property _____

Quadrangle name _____

USMT References _____

Verbal boundary description and justification _____

11. Form Prepared By

12. State Historic Preservation Officer Certification

The evaluated significance of this property within the state is:

_____ national _____ state _____ local

State Historic Preservation Officer signature _____

Title _____ date _____

13. Other

- _____ Maps
- _____ Photographs
- _____ Other

Questions concerning this nomination may be directed to _____

Signed _____ Date _____ Phone: 202 272-3504

Comments for any item may be continued on an attached sheet



The Norwegian Settlement of Bosque County

Site No. 11, Christen and Johanne Knudson Farm,
FM 219, 4 $\frac{1}{4}$ miles southwest of Clifton, Bosque
County, Texas

Photograph: July 1979, by Daniel Hardy

On file, Texas Historical Commission

View of front facade, looking north

Photo 20 of 72

Please refer to the map in the
Multiple Property Cover Sheet
for this property

Multiple Property Cover Sheet Reference Number: 64000849