

United States Department of the Interior
National Park ServiceNational Register of Historic Places
Inventory—Nomination Form

For NPS use only

received

date entered

Continuation sheet

Item number all

Page 50

SITE NO. 18

NAME Hoff-Ulland farm

LOCATION ~~5~~⁹/₁₆ miles southwest of Clifton, Bosque County,
Texas, on S. Durnett survey

OWNER A.B. Ulland
107 N. Avenue
Clifton, Texas 76634

PRESENT USE Private residence, agriculture

CATEGORY Building

STATUS Unoccupied

QUADRANGLE NAME Hurst Springs, Texas

QUADRANGLE SCALE 1:24000

UTM REFERENCE 14/629420/3510500

ACREAGE less than 1 acre

PHOTO REFERENCE NO. 28

DESCRIPTION

Located about five miles southwest of Clifton, the Hoff-Ulland farm stands on relatively level terrain about one mile north of Neils Creek. The house is unoccupied and is in a fair state of repair. The first house was a two-story stone structure that was built in 1881. Little is known of its appearance, but the present design retains its original gabled roof and double-hung windows with six-over-six lights. In 1912 a much larger stone structure was built to the north of the first residence, and joined to the older portion by wood-frame construction. Facing north, the present front is symmetrical and features a two-tiered porch with a balcony. The second-floor porch is the smaller of the two. A single-door entry with sidelights opens onto the ground level, while French doors provide access to the second-story balcony, which lies beneath a prominent gable. Double-hung windows with one-over-one lights pierce the stuccoed walls. Exterior stone and brick chimneys on the east and west ends of the house extend above the gables and add to the overall symmetry of the facade. The ends of the front gable and of the two end gables of the main addition are covered by wooden shingles applied in a saw-toothed pattern. The entire roof is presently covered by composition shingles.

**United States Department of the Interior
National Park Service**

**National Register of Historic Places
Inventory—Nomination Form**

For NPS use only

received

date entered

Continuation sheet

Item number all

Page 51

A frame barn, with horizontal siding and stone-lined cellars, is the most significant outbuilding on the farm. Other structures included in the nomination are an above-ground cistern, a frame corn crib, and two modern storage sheds with metal siding.

SIGNIFICANCE

This house was constructed in 1881 by Mikkell and Johanna Hoff and is presently owned by their granddaughter, Lila Pauline and her husband, A. B. (Bert) Ulland. In 1912 a major addition was built onto the front of this structure, making it one of the largest houses in the settlement. The house is deemed significant, for it reveals the changes in the architectural tastes of second-generation Norwegians.

**United States Department of the Interior
National Park Service**

National Register of Historic Places Inventory—Nomination Form

For NPS use only

received

date entered

Continuation sheet

Item number all

Page 52

AREA TO BE NOMINATED

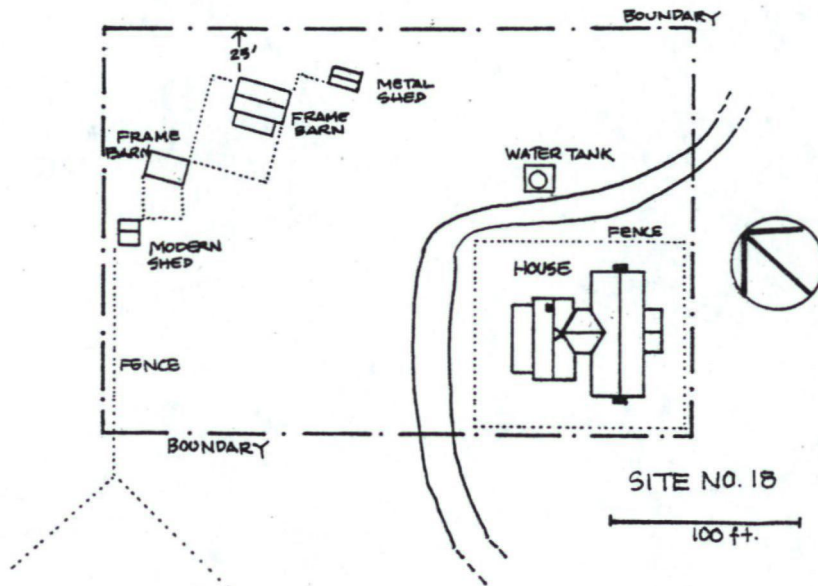

United States Department of the Interior
National Park Service

**National Register of Historic Places
Inventory—Nomination Form**

For NPS use only

received

date entered

Continuation sheet

Item number

Page 2 of 4

Multiple Resource Area
Thematic Group

Name Norwegian Settlement of Bosque County Thematic Resources
State Texas

Nomination/Type of Review

Date/Signature

- | | | | |
|--|-------------------------------------|------------|------------------------------|
| 11. Grimland, Gunsten and Lofise, House | Entered in the
National Register | for Keeper | 7/22/83 <u>Delores Byers</u> |
| | | Attest | |
| 12. Grimland, Keddel and Liv, Farm | Entered in the
National Register | for Keeper | 7/22/83 <u>Delores Byers</u> |
| | | Attest | |
| 13. Hanson, Hans, Farm | Substantive Review | Keeper | <u>Return</u> |
| | | Attest | |
| 14. Hoff-Ulland Farm | Entered in the
National Register | for Keeper | 7/22/83 <u>Delores Byers</u> |
| | | Attest | |
| 15. Holen Farm | Substantive Review | Keeper | <u>Return</u> |
| | | Attest | |
| 16. Jenson, James Jens and Martha, House | Entered in the
National Register | for Keeper | 7/22/83 <u>Delores Byers</u> |
| | | Attest | |
| 17. Knudson, Christen and Johanne, Farm | Entered in the
National Register | for Keeper | 7/22/83 <u>Delores Byers</u> |
| | | Attest | |
| 18. Lahlum, A. H., House | Entered in the
National Register | for Keeper | 7/22/83 <u>Delores Byers</u> |
| | | Attest | |
| 19. Larson, Martin, House | Entered in the
National Register | for Keeper | 7/22/83 <u>Delores Byers</u> |
| | | Attest | |
| 20. Linberg, Eric and Martha, Farm | Entered in the
National Register | for Keeper | 7/22/83 <u>Delores Byers</u> |
| | | Attest | |

United States Department of the Interior
National Park Service

Hoff-Ulland Farm (Norwegian Settlement of
Bosque County TR)
Bosque County
TEXAS

Working No. JUN 9 1983
Fed. Reg. Date: 2.7.84
Date Due: 7/7/83 - 7/24/83
Action: ACCEPT 7/22/83
Entered in the National Register RETURN
REJECT
Federal Agency:

- resubmission
- nomination by person or local government
- owner objection
- appeal

Substantive Review: sample request appeal NR decision

Reviewer's comments:

Recom. / Criteria
Reviewer
Discipline
Date
see continuation sheet

Nomination returned for: technical corrections cited below
substantive reasons discussed below

1. Name

2. Location

3. Classification

Category	Ownership	Status	Present Use
	Public Acquisition	Accessible	

4. Owner of Property

5. Location of Legal Description

6. Representation in Existing Surveys

has this property been determined eligible? yes no

7. Description

Condition		Check one	Check one
excellent	deteriorated	unaltered	original site
good	ruins	altered	moved date
fair	unexposed		

Describe the present and original (if known) physical appearance

- summary paragraph
- completeness
- clarity
- alterations/integrity
- dates
- boundary selection

8. Significance

Period _____ Areas of Significance—Check and justify below

Specific dates _____ Builder/Architect _____

Statement of Significance (in one paragraph)

- _____ summary paragraph
- _____ completeness
- _____ clarity
- _____ applicable criteria
- _____ justification of areas checked
- _____ relating significance to the resource
- _____ context
- _____ relationship of integrity to significance
- _____ justification of exception
- _____ other

9. Major Bibliographical References

10. Geographical Data

Acreage of nominated property _____

Quadrangle name _____

UMT Reference _____

Verbal boundary description and justification _____

11. Form Prepared By

12. State Historic Preservation Officer Certification

The evaluated significance of this property within the state is:

_____ national _____ state _____ local

State Historic Preservation Officer signature _____

Title _____ date _____

13. Other

- _____ Maps
- _____ Photographs
- _____ Other

Questions concerning this nomination may be directed to _____

Signed _____ Date _____ Phone: 202 272-3504

Comments for any item may be continued on an attached sheet



The Norwegian Settlement of Bosque County

Site No. 18, Hoff-Ulland Farm, $5\frac{1}{4}$ miles
southwest of Clifton, Bosque County, Texas
Photograph: March 1979, by Daniel Hardy
On file, Texas Historical Commission
View of side, looking northeast
Photo 28 of 72

Please refer to the map in the
Multiple Property Cover Sheet
for this property

Multiple Property Cover Sheet Reference Number: 64000849