

United States Department of the Interior
National Park ServiceNational Register of Historic Places
Inventory—Nomination Form

For NPS use only

received

date entered

Continuation sheet

Item number all

Page 25

SITE NO. 9

NAME

Gunsten and Lofise Grimland house

LOCATION

FM 219, 8 1/2 miles southwest of Clifton, Bosque
County, Texas, on J. Houston survey

OWNER

Tilden Pederson
Route 2
Clifton, Texas 76634

PRESENT USE

Agriculture

CATEGORY

Building

STATUS

Unoccupied

QUADRANGLE NAME

Hurst Springs, Texas

QUADRANGLE SCALE

1:24000

UTM REFERENCE

14/622160/3510610

ACREAGE

less than 1 acre

PHOTO REFERENCE NO.

18

DESCRIPTION

The Gunsten and Ingerborg Grimland house is a one-and-a-half-story stone structure with a wood-frame addition to one end. It stands abandoned in a field near the Keddel and Liv Grimland farm (no. 10). Although its plan is of the asymmetrical type of stone house, both of its major facades are symmetrically composed. The north, or front, elevation shows two windows flanking a central doorway, while the south wall has two doorways and a central window. The east end has a window opening on the ground floor and another in the loft. The original west end is presently obscured by a wood-frame addition, but its stone chimney pierces the roof of corrugated metal. Because the house has been unoccupied and used as a barn for over 40 years, the interior has been gutted and the doors and window sashes have been removed. The frame addition was probably built about the turn-of-the-century. A cistern is located a few feet south of the house.

**United States Department of the Interior
National Park Service**

**National Register of Historic Places
Inventory—Nomination Form**

For NPS use only

received

date entered

Continuation sheet

Item number all

Page 26

SIGNIFICANCE

According to Tilden Pederson, who presently owns the property, the two-room, stone portion of this house was erected by Gunsten and Lofise Grimland about 1869 or 1870. A frame addition was added on one end at a later date, to form a row-house type of plan. The structure stands in close proximity to the larger Keddel and Liv Grimland farm, and is a good illustration of an early pioneer farmhouse in the area.

United States Department of the Interior
National Park Service

**National Register of Historic Places
Inventory—Nomination Form**

For NPS use only

received

date entered

Continuation sheet

Item number all

Page 27

AREA TO BE NOMINATED

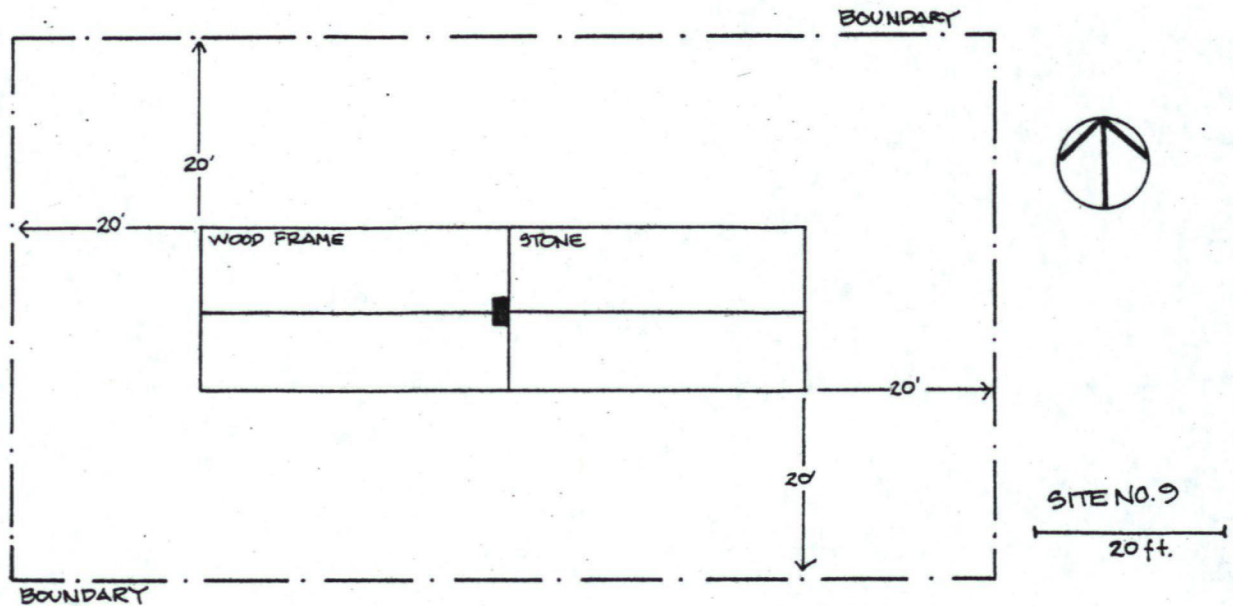

United States Department of the Interior
National Park Service

**National Register of Historic Places
Inventory—Nomination Form**

For NPS use only

received

date entered

Continuation sheet

Item number

Page 2 of 4

Multiple Resource Area
Thematic Group

Name Norwegian Settlement of Bosque County Thematic Resources
State Texas

Nomination/Type of Review

Date/Signature

11. Grimland, Gunsten and
Lofise, House

Entered in the
National Register

for Keeper

7/22/83 Delmar Byers

Attest

12. Grimland, Keddel and Liv,
Farm

Entered in the
National Register

for Keeper

7/22/83 Delmar Byers

Attest

13. Hanson, Hans, Farm

Substantive Review

Keeper

Return

Attest

14. Hoff-Ulland Farm

Entered in the
National Register

for Keeper

7/22/83 Delmar Byers

Attest

15. Holen Farm

Substantive Review

Keeper

Return

Attest

16. Jenson, James Jens and
Martha, House

Entered in the
National Register

for Keeper

7/22/83 Delmar Byers

Attest

17. Knudson, Christen and
Johanne, Farm

Entered in the
National Register

for Keeper

7/22/83 Delmar Byers

Attest

18. Lahlum, A. H., House

Entered in the
National Register

for Keeper

7/22/83 Delmar Byers

Attest

19. Larson, Martin, House

Entered in the
National Register

for Keeper

7/22/83 Delmar Byers

Attest

20. Linberg, Eric and Martha,
Farm

Entered in the
National Register

for Keeper

7/22/83 Delmar Byers

Attest

Grimland, Gunsten and Lofise, House
(Norwegian Settlement of Bosque County TR)
Bosque County
TEXAS

Working No. JUN 9 1983

Fed. Reg. Date: 2.7.84

Date Due: 7/7/83 - 7/24/83

Action: ☒ ACCEPT 7/27/83
☐ RETURN
☐ REJECT

Entered in the
National Register

Federal Agency:

- resubmission
- nomination by person or local government
- owner objection
- appeal

Substantive Review: sample request appeal NR decision

Reviewer's comments:

Recom./Criteria

Reviewer

Discipline

Date

see continuation sheet

Nomination returned for: technical corrections cited below
 substantive reasons discussed below

1. Name

2. Location

3. Classification

Category	Ownership	Status	Present Use
	Public Acquisition	Accessible	

4. Owner of Property

5. Location of Legal Description

6. Representation in Existing Surveys

has this property been determined eligible? yes no

7. Description

Condition		Check one	Check one
— excellent	— deteriorated	— unaltered	— original site
— good	— ruins	— altered	— moved date
— fair	— unexposed		

Describe the present and original (if known) physical appearance

- summary paragraph
- completeness
- clarity
- alterations/integrity
- dates
- boundary selection

8. Significance

Period _____ Area of Significance—Check and justify below _____

Specific dates _____

Builder/Architect _____

Statement of Significance (in one paragraph)

- _____ summary paragraph
- _____ completeness
- _____ clarity
- _____ applicable criteria
- _____ justification of areas checked
- _____ relating significance to the resource
- _____ context
- _____ relationship of integrity to significance
- _____ justification of exception
- _____ other

9. Major Bibliographical References

10. Geographical Data

Address of nominated property _____

Quadrangle name _____

USGS Reference _____

Verbal boundary description and justification _____

11. Form Prepared By

12. State Historic Preservation Officer Certification

The evaluated significance of this property within the state is:

_____ national _____ state _____ local

State Historic Preservation Officer signature _____

title _____

date _____

13. Other

- _____ Maps
- _____ Photographs
- _____ Other

Questions concerning this nomination may be directed to _____

Signed _____ Date _____ Phone: 202 272-3504

Comments for any item may be continued on an attached sheet



The Norwegian Settlement of Bosque County

Site No. 9, Gunsten and Lofise Grimland House,
FM 219, 8½ miles southwest of Clifton, Bosque
County, Texas

Photograph: March 1979, by Daniel Hardy

On file, Texas Historical Commission

View of front facade, looking northwest

Photo 18 of 72

Please refer to the map in the
Multiple Property Cover Sheet
for this property

Multiple Property Cover Sheet Reference Number: 64000849