

**United States Department of the Interior
National Park Service**

**National Register of Historic Places
Inventory—Nomination Form**

For NPS use only
received
date entered

Continuation sheet

Item number all

Page 56

SITE NO. 20

NAME Even and Petrine Erickson farm

LOCATION 9 miles northwest of Clifton, Bosque County,
Texas, on E. Erickson survey

OWNER Selma Paulson
P.O. Box 364
Meridian, Texas 76665

PRESENT USE Storage, agriculture

CATEGORY Buildings/site

STATUS Unoccupied

QUADRANGLE NAME Sugarloaf Mountain, Texas

QUADRANGLE SCALE 1:24000

UTM REFERENCE 14/623920/3526700

ACREAGE less than 1 acre

PHOTO REFERENCE NO. 31, 32

DESCRIPTION

The Even and Petrine Erickson farm is the northernmost property included in the nomination. It is located near Bee Creek, about a half mile south of State Highway 22. Of log and stone construction, the house remains virtually unaltered and is in fair, but stable, condition. The one-room log cabin is the oldest part of the structure. Its irregular logs were hewn flat on their inside and outside faces, and the irregular spaces between them were filled with stone chinking that was plastered over. A variety of notching techniques was used at the corners, including saddle-notching, V-notching, and half-dovetail notching. A slightly offset doorway pierces the front, or south, facade. The west wall has a centrally located door, but the east facade, which is covered with board-and-batten wood siding, has two window openings on the ground level. The gable roof has a corrugated metal covering. A small stone lean-to is attached to the rear elevation of the cabin, and its walls have been plastered over.

**United States Department of the Interior
National Park Service**

**National Register of Historic Places
Inventory—Nomination Form**

For NPS use only

received

date entered

Continuation sheet

Item number all

Page 57

A tall stone chimney rises from this addition. Other structures on the old farm include a log barn, a log corn crib, a stone-lined cistern, hand-dug well, and sections of a stone fence, all of which stand within the nominated property and contribute to the historic character of the farm. Somewhat overgrown with vegetation, the grounds of the complex contain a large number of old agricultural implements. To the east side of the stone fence, an early 20th century frame house and an old mobile home serve as the present residences, but neither is included within the property to be nominated.

SIGNIFICANCE

According to the Paulson family, who presently occupy this farm, the Erickson Cabin was erected in 1874. This is corroborated, approximately, by the 1876 date assigned to the Erickson patent for this land, for to acquire a patent a person must have occupied a piece of land at least three years previous to the grant. The cabin, which is the only completely intact structure of its kind in this nomination, is accompanied on its site by a log corncrib and barn. Both these structures also appear to date to the 1870s. In addition, there is also a hand-dug well, cistern, and frame outbuilding on the property, which make it one of the most complete pioneer farmsteads in the settlement, and one worthy of archeological investigation.

United States Department of the Interior
National Park Service

National Register of Historic Places
Inventory—Nomination Form

For NPS use only
received
date entered

Continuation sheet

Item number a11

Page 58

AREA TO BE NOMINATED

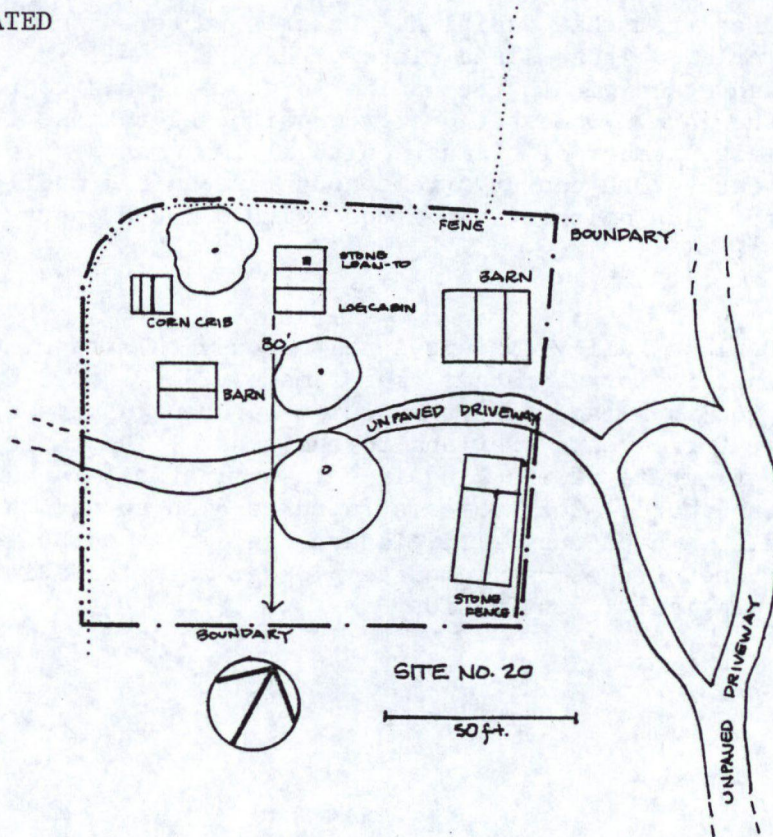

United States Department of the Interior
National Park Service

National Register of Historic Places
Inventory—Nomination Form

For NPS use only
received
date entered

Continuation sheet

Item number

Page 1 of 1

Multiple Resource Area
Thematic Group

dnr-11

Name Norwegian Settlement of Bosque County Thematic Resources
State Texas

Nomination/Type of Review

Date/Signature

- | | | | |
|---|-------------------------------------|---------------------------|----------------------------|
| 1. Bekken, J. H., House | Entered in the
National Register | Keeper <i>[Signature]</i> | 7/22/83 <i>[Signature]</i> |
| | | Attest _____ | |
| 2. Brandhagen Houses | Entered in the
National Register | Keeper <i>[Signature]</i> | 7/22/83 <i>[Signature]</i> |
| | | Attest _____ | |
| 3. Brogdon Farm | Entered in the
National Register | Keeper <i>[Signature]</i> | 7/22/83 <i>[Signature]</i> |
| | | Attest _____ | |
| 4. Bronstad House | Entered in the
National Register | Keeper <i>[Signature]</i> | 7/22/83 <i>[Signature]</i> |
| | | Attest _____ | |
| 5. Colwick, John and Mary, Farm | Substantive Review | Keeper <i>[Signature]</i> | 7/22/83 <i>[Signature]</i> |
| | | Attest _____ | |
| 6. Dahl, Peder, Farm | Entered in the
National Register | Keeper <i>[Signature]</i> | 7/22/83 <i>[Signature]</i> |
| | | Attest _____ | |
| 7. Ellingson Farm | Entered in the
National Register | Keeper <i>[Signature]</i> | 7/22/83 <i>[Signature]</i> |
| | | Attest _____ | |
| 8. Erickson, Even and Petrine,
Farm | Entered in the
National Register | Keeper <i>[Signature]</i> | 7/22/83 <i>[Signature]</i> |
| | | Attest _____ | |
| 9. Finstad, Ole and Elizabeth,
Homesite | Entered in the
National Register | Keeper <i>[Signature]</i> | 7/22/83 <i>[Signature]</i> |
| | | Attest _____ | |
| 10. Godager, Adolf and
Christine, Homesite | Entered in the
National Register | Keeper <i>[Signature]</i> | 7/22/83 <i>[Signature]</i> |
| | | Attest _____ | |

United States Department of the Interior
National Park Service

Erickson, Even and Petrine, Farm (Norwegian
Settlement of Bosque County TR)
Bosque County
TEXAS

Working No. JUN 9 1983

Fed. Reg. Date: 2.7.84

Date Due: 7/7/83 - 7/24/83

Action: ACCEPT 7/22/83

Entered in the RETURN

National Register REJECT

Federal Agency: _____

- resubmission
- nomination by person or local government
- owner objection
- appeal

Substantive Review: sample request appeal NR decision

Reviewer's comments: _____

Recom./Criteria _____

Reviewer _____

Discipline _____

Date _____

see continuation sheet

Nomination returned for: technical corrections cited below
 substantive reasons discussed below

1. Name

2. Location

3. Classification

Category	Ownership	Status	Present Use
	Public Acquisition	Accessible	

4. Owner of Property

5. Location of Legal Description

6. Representation in Existing Surveys

Has this property been determined eligible? yes no

7. Description

Condition		Check one	Check one
<input type="checkbox"/> excellent	<input type="checkbox"/> deteriorated	<input type="checkbox"/> unaltered	<input type="checkbox"/> original site
<input type="checkbox"/> good	<input type="checkbox"/> ruins	<input type="checkbox"/> altered	<input type="checkbox"/> moved date _____
<input type="checkbox"/> fair	<input type="checkbox"/> unexposed		

Describe the present and original (if known) physical appearance

- summary paragraph
- completeness
- clarity
- alterations/integrity
- dates
- boundary selection

8. Significance

Period _____ Area of Significance—Check and justify below

Specific dates _____ Builder/Architect _____

Statement of Significance (in one paragraph)

- _____ summary paragraph
- _____ completeness
- _____ clarity
- _____ applicable criteria
- _____ justification of areas checked
- _____ relating significance to the resource
- _____ context
- _____ relationship of integrity to significance
- _____ justification of exception
- _____ other

9. Major Bibliographical References

10. Geographical Data

Address of nominated property _____

Quadrangle name _____

UMT References _____

Verbal boundary description and justification _____

11. Form Prepared By

12. State Historic Preservation Officer Certification

The evaluated significance of this property within the state is:

_____ national _____ state _____ local

State Historic Preservation Officer signature _____

title _____ date _____

13. Other

- _____ Maps
- _____ Photographs
- _____ Other

Questions concerning this nomination may be directed to _____

Signed _____ Date _____ Phone: 202 272-3504

Comments for any item may be continued on an attached sheet



The Norwegian Settlement of Bosque County

Site No. 20, Even and Petrine Erickson Farm,
9 miles northwest of Clifton, Bosque County,
Texas

Photograph: July 1982, by Ken Breisch

On file Texas Historical Commission

View of front facade, looking northwest

Photo 31 of 72



The Norwegian Settlement of Bosque County

Site No. 20, Even and Petrine Erickson Farm,
9 miles northwest of Clifton, Bosque County,
Texas

Photograph: July 1982, by Ken Briesch

On file, Texas Historical Commission

View of front facade, looking northeast

Photo 32 of 72

Please refer to the map in the
Multiple Property Cover Sheet
for this property

Multiple Property Cover Sheet Reference Number: 64000849