

United States Department of the Interior
National Park Service

**National Register of Historic Places
Inventory—Nomination Form**

For NPS use only

received

date entered

Continuation sheet

Item number all

Page 71

SITE NO. 25

NAME

Peder Dahl farm

LOCATION

FM 219, 2 3/4 miles southwest of Clifton on FM 219
Bosque County, Texas, on G. Hail survey

OWNER

E.M. Colwick
Route 2
Clifton, Texas 76634

PRESENT USE

Private residence

CATEGORY

Buildings

STATUS

Occupied

REPRESENTATION IN EXISTING SURVEYS

Family Land Heritage Program
1974
General Land Office
Austin, Texas

QUADRANGLE NAME

Clifton, Texas

QUADRANGLE SCALE

1:24000

UTM REFERENCE

14/631990/3513740

ACREAGE

about 2 3/4 acres

PHOTO REFERENCE NO.

38

DESCRIPTION

The Peder Dahl farm stands atop a hill which overlooks the Neils Creek valley. Located about a quarter mile southeast of FM 219, the house is in good condition, and only minor alterations affect its integrity. The original plan of the house was T-shaped, although, small additions onto the north and south sides of the rear ell have changed this somewhat. The front faces east and, with its steep central gable, features

**United States Department of the Interior
National Park Service**

**National Register of Historic Places
Inventory—Nomination Form**

For NPS use only

received

date entered

Continuation sheet

Item number all

Page 72

a symmetrical facade that is similar to that of the Bekken (no. 27) and Schultz houses (no. 26). With shingled siding, this central gable has a jig-cut wooden bargeboard at the apex, which is composed of a king post with braces and cut-out wooden brackets. A single doorway pierces this gable and opens onto a small porch balcony added in 1947. Sidelights and transoms frame the ground-level main entrance. The windows are double hung with two-over-two lights. The steeply pitched, cross-gabled roof is covered with composition shingles and pierced by an internal brick chimney at each side.

SIGNIFICANCE

In 1893 Johan Nordahl built this frame residence for Peder Dahl, who was the son of one of the earliest Norwegian settlers of Bosque County. The present house, which is prominently sited atop a hill, is one of the most noteworthy and intact late 19th-century farmhouses in the area.

United States Department of the Interior
National Park Service

National Register of Historic Places
Inventory—Nomination Form

For NPS use only

received

date entered

Continuation sheet

Item number all

Page 73

AREA TO BE NOMINATED

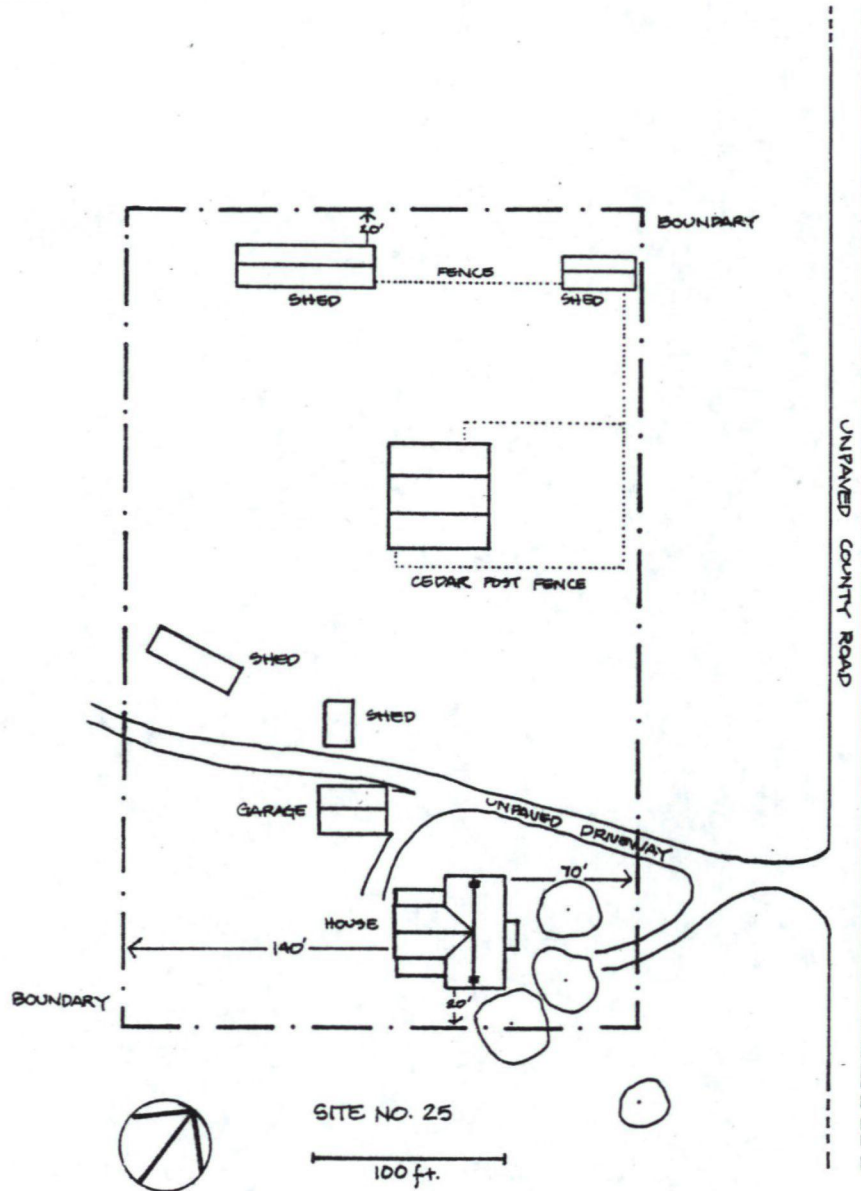

United States Department of the Interior
National Park Service

National Register of Historic Places
Inventory—Nomination Form

For NPS use only

received

date entered

Continuation sheet

Item number

Page 1/1

Multiple Resource Area
Thematic Group

dnr-11

Name Norwegian Settlement of Bosque County Thematic Resources
State Texas

Nomination/Type of Review

Date/Signature

- | | | | |
|---|-------------------------------------|---------------------------|----------------------------|
| 1. Bekken, J. H., House | Entered in the
National Register | Keeper <u>[Signature]</u> | 7/22/83 <u>[Signature]</u> |
| | | Attest _____ | |
| 2. Brandhagen Houses | Entered in the
National Register | Keeper <u>[Signature]</u> | 7/22/83 <u>[Signature]</u> |
| | | Attest _____ | |
| 3. Brogdon Farm | Entered in the
National Register | Keeper <u>[Signature]</u> | 7/22/83 <u>[Signature]</u> |
| | | Attest _____ | |
| 4. Bronstad House | Entered in the
National Register | Keeper <u>[Signature]</u> | 7/22/83 <u>[Signature]</u> |
| | | Attest _____ | |
| 5. Colwick, John and Mary, Farm | Substantive Review | Keeper <u>[Signature]</u> | 7/22/83 <u>[Signature]</u> |
| | | Attest _____ | |
| 6. Dahl, Peder, Farm | Entered in the
National Register | Keeper <u>[Signature]</u> | 7/22/83 <u>[Signature]</u> |
| | | Attest _____ | |
| 7. Ellingson Farm | Entered in the
National Register | Keeper <u>[Signature]</u> | 7/22/83 <u>[Signature]</u> |
| | | Attest _____ | |
| 8. Erickson, Even and Petrine,
Farm | Entered in the
National Register | Keeper <u>[Signature]</u> | 7/22/83 <u>[Signature]</u> |
| | | Attest _____ | |
| 9. Finstad, Ole and Elizabeth,
Homesite | Entered in the
National Register | Keeper <u>[Signature]</u> | 7/22/83 <u>[Signature]</u> |
| | | Attest _____ | |
| 10. Godager, Adolf and
Christine, Homesite | Entered in the
National Register | Keeper <u>[Signature]</u> | 7/22/83 <u>[Signature]</u> |
| | | Attest _____ | |

NATIONAL REGISTER OF HISTORIC PLACES

EVALUATION / RETURN SHEET

United States Department of the Interior
National Park ServiceDahl, Peder, Farm (Norwegian Settlement of
Bosque County TR)
Bosque County
TEXASWorking No. JUN 9 1983Fed. Reg. Date: 2.7.84Date Due: 7/7/83 - 7/24/83Action: ☒ ACCEPT 7/22/83Entered in the ☐ RETURNNational Register ☐ REJECT

Federal Agency: _____

- ☐ resubmission
☐ nomination by person or local government
☐ owner objection
☐ appeal

Substantive Review: ☐ sample ☐ request ☐ appeal ☐ NR decision

Reviewer's comments: _____

Recom./Criteria _____

Reviewer _____

Discipline _____

Date _____

☐ see continuation sheet

Nomination returned for: ☐ technical corrections cited below
☐ substantive reasons discussed below

1. Name2. Location3. Classification

Category	Ownership	Status	Present Use
	Public Acquisition	Accessible	

4. Owner of Property5. Location of Legal Description6. Representation in Existing SurveysHas this property been determined eligible? ☐ yes ☐ no7. Description

Condition		Check one	Check one
<input type="checkbox"/> excellent	<input type="checkbox"/> deteriorated	<input type="checkbox"/> unaltered	<input type="checkbox"/> original site
<input type="checkbox"/> good	<input type="checkbox"/> ruins	<input type="checkbox"/> altered	<input type="checkbox"/> moved date _____
<input type="checkbox"/> fair	<input type="checkbox"/> unexposed		

Describe the present and original (if known) physical appearance

- ☐ summary paragraph
☐ completeness
☐ clarity
☐ alterations/integrity
☐ dates
☐ boundary selection

8. Significance

Period _____ Areas of Significance—Check and justify below

Specific dates _____ Builder/Architect _____

Statement of Significance (in one paragraph)

- _____ summary paragraph
- _____ completeness
- _____ clarity
- _____ applicable criteria
- _____ justification of areas checked
- _____ relating significance to the resource
- _____ context
- _____ relationship of integrity to significance
- _____ justification of exception
- _____ other

9. Major Bibliographical References

10. Geographical Data

Address of nominated property _____

Quadrangle name _____

USIT References _____

Verbal boundary description and justification _____

11. Form Prepared By

12. State Historic Preservation Officer Certification

The evaluated significance of this property within the state is:

_____ national _____ state _____ local

State Historic Preservation Officer signature _____

Title _____ date _____

13. Other

- _____ Maps
- _____ Photographs
- _____ Other

Questions concerning this nomination may be directed to _____

Signed _____ Date _____ Phone: 202 272-3504

Comments for any item may be continued on an attached sheet



The Norwegian Settlement of Bosque County

Site No. 25, Peder Dahl Farm, FM 219, 2 3/4 miles
southwest of Clifton, Bosque County, Texas

Photograph: March 1979, by Daniel Hardy

On file, Texas Historical Commission

View of front facade, looking northwest

Photo 38 of 72

Please refer to the map in the
Multiple Property Cover Sheet
for this property

Multiple Property Cover Sheet Reference Number: 64000849