

United States Department of the Interior
National Park ServiceNational Register of Historic Places
Inventory—Nomination Form

For NPS use only

received

date entered

Continuation sheet

Item number all

Page 62

SITE NO. 22

NAME

John and Mary Colwick, farm

LOCATION

~~8 3/4~~ miles southwest of Clifton, Bosque
County, Texas, on H. Mailand survey

OWNERS

Mary Orbeck
403 S. Avenue J
Clifton, Texas 76634Rex Colwick
1006 S. Montgomery
Starksville, Mississippi 39759

PRESENT USE

Private residence

CATEGORY

Buildings

STATUS

Occupied

QUADRANGLE NAME

Hurst Spring, Texas

QUADRANGLE SCALE

1:24000

UTM REFERENCE

14/623440/3508870

ACREAGE

about 2 acres

PHOTO REFERENCE NO.

34

DESCRIPTION

Located atop a hill that overlooks the Neils Creek valley, the John and Mary Colwick farm includes a one-and-a-half-story frame house with a modified T-shaped plan. It is still used as a residence and is in good condition. The front faces east and has a double-door entrance with narrow sidelights and transom. A one-story porch, which was screened in about 1937, extends across the setback section of the front. This shed-roof porch replaced an earlier one that, according to the historic photos of the present owners, had turned wooden posts with jig-cut brackets and balusters. Most of the original windows with four-over-four lights have been replaced with those having two-over-two lights. A cross-gabled roof with composition shingles caps the house. The north facade features an off-center, gable-like dormer which was an early addition. A rear porch that was added about 1915 encloses the entrance to the partial basement.

EXP. 12/31/84

**United States Department of the Interior
National Park Service**

**National Register of Historic Places
Inventory—Nomination Form**

For NPS use only

received

date entered

Continuation sheet

Item number all

Page 63

An underground, stone-lined cistern is located a few feet southwest of the house. The frame barn, standing northwest of the house, was built about the same time as the residence, and has been covered with corrugated-metal siding. It contributes to the historic character of the farm. The cedar stake fence, which surrounds the barn, remains in good condition and is typical of the Norwegian farms of Bosque County.

SIGNIFICANCE

The John and Mary Colwick farm is one of the oldest frame houses within the Norwegian settlement. Its present owners, who are direct descendents of the Colwicks, state that it was built in 1889 by Norwegian carpenter Johan Nordahl. It is believed to be the first of at least six structures erected by this skilled craftsman. When completed, it was the scene of a community-wide celebration, as reported in the August 9, 1889, issue of The Alliance Sun, a Meridian newspaper.

United States Department of the Interior
National Park Service

National Register of Historic Places
Inventory—Nomination Form

For NPS use only

received

date entered

Continuation sheet

Item number all

Page 64

AREA TO BE NOMINATED

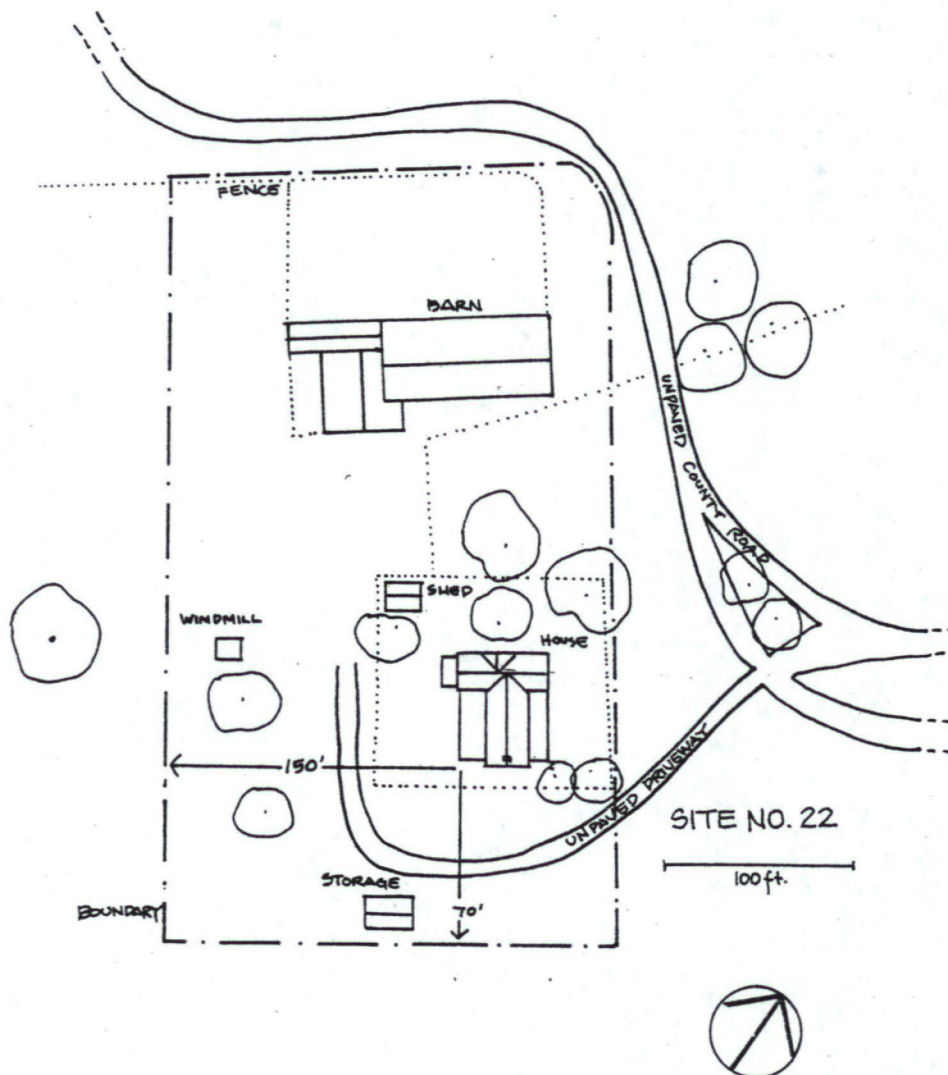

United States Department of the Interior
National Park Service

National Register of Historic Places
Inventory—Nomination Form

For NPS use only

received

date entered

Continuation sheet

Item number

Page 141

Multiple Resource Area
Thematic Group

dnr-11

Name Norwegian Settlement of Bosque County Thematic Resources
State Texas

Nomination/Type of Review

Date/Signature

- | | | | |
|---|-------------------------------------|-----------------------------------|--------------|
| 1. Bekken, J. H., House | Entered in the
National Register | Keeper <i>[Signature]</i> 7/22/83 | Attest _____ |
| 2. Brandhagen Houses | Entered in the
National Register | Keeper <i>[Signature]</i> 7/22/83 | Attest _____ |
| 3. Brogdon Farm | Entered in the
National Register | Keeper <i>[Signature]</i> 7/22/83 | Attest _____ |
| 4. Bronstad House | Entered in the
National Register | Keeper <i>[Signature]</i> 7/22/83 | Attest _____ |
| 5. Colwick, John and Mary, Farm | Substantive Review | Keeper <i>[Signature]</i> 7/22/83 | Attest _____ |
| 6. Dahl, Peder, Farm | Entered in the
National Register | Keeper <i>[Signature]</i> 7/22/83 | Attest _____ |
| 7. Ellingson Farm | Entered in the
National Register | Keeper <i>[Signature]</i> 7/22/83 | Attest _____ |
| 8. Erickson, Even and Petrine,
Farm | Entered in the
National Register | Keeper <i>[Signature]</i> 7/22/83 | Attest _____ |
| 9. Finstad, Ole and Elizabeth,
Homesite | Entered in the
National Register | Keeper <i>[Signature]</i> 7/22/83 | Attest _____ |
| 10. Godager, Adolf and
Christine, Homesite | Entered in the
National Register | Keeper <i>[Signature]</i> 7/22/83 | Attest _____ |

NATIONAL REGISTER OF HISTORIC PLACES

EVALUATION / RETURN SHE

United States Department of the Interior
National Park Service

Substantive Review

Colwick, John and Mary, Farm (Norwegian
Settlement of Bosque County TR)
Bosque County
TEXASWorking No. JUN 9 1983
Fed. Reg. Date: 2.7.84
Date Due: 7/7/83 - 7/24/83
Action: ☒ ACCEPT 7/22/83
☐ RETURN
☐ REJECT

Federal Agency: _____

- ☐ resubmission
☐ nomination by person or local government
☐ owner objection
☐ appeal

Substantive Review: ☒ sample ☐ request ☐ appeal ☐ NR decision

Reviewer's comments:

Although the barn has been designated as contributing in the nomination, this has not been adequately substantiated - it is covered by metal siding without a further discussion of the features that make it significant and an assessment of integrity, we can't consider it contributing.

Recom. / Criteria Accept - A, C
Reviewer Greene
Discipline Historic
Date 7/22/83
☐ see continuation sheetNomination returned for: ☐ technical corrections cited below
☐ substantive reasons discussed below1. Name2. Location3. Classification

Category	Ownership	Status	Present Use
	Public Acquisition	Accessible	

4. Owner of Property5. Location of Legal Description6. Representation in Existing SurveysHas this property been determined eligible? ☐ yes ☐ no7. Description

Condition		Check one	Check one
<input type="checkbox"/> excellent	<input type="checkbox"/> deteriorated	<input type="checkbox"/> unaltered	<input type="checkbox"/> original site
<input type="checkbox"/> good	<input type="checkbox"/> ruins	<input type="checkbox"/> altered	<input type="checkbox"/> moved date _____
<input type="checkbox"/> fair	<input type="checkbox"/> unexposed		

Describe the present and original (if known) physical appearance

- ☐ summary paragraph
☐ completeness
☐ clarity
☐ alterations/integrity
☐ dates
☐ boundary selection

8. Significance

Period _____ Areas of Significance—Check and justify below

Specific dates _____

Builder/Architect _____

Statement of Significance (in one paragraph)

- _____ summary paragraph
- _____ completeness
- _____ clarity
- _____ applicable criteria
- _____ justification of areas checked
- _____ relating significance to the resource
- _____ context
- _____ relationship of integrity to significance
- _____ justification of exception
- _____ other

9. Major Bibliographical References

10. Geographical Data

Acreage of nominated property _____

Quadrangle name _____

USFT References _____

Verbal boundary description and justification _____

11. Form Prepared By

12. State Historic Preservation Officer Certification

The evaluated significance of this property within the state is:

_____ national _____ state _____ local

State Historic Preservation Officer signature _____

Title _____

date _____

13. Other

- _____ Maps
- _____ Photographs
- _____ Other

Questions concerning this nomination may be directed to _____

Signed _____ Date _____ Phone: 202 272-3504

Comments for any item may be continued on an attached sheet



The Norwegian Settlement of Bosque County

Site No. 22, John and Mary Colwick Farm,
8 3/4 miles southwest of Clifton, Bosque
County, Texas

Photograph: March 1979, by Daniel Hardy

On file, Texas Historical Commission

View of front facade, looking northwest

Photo 34 of 72

Please refer to the map in the
Multiple Property Cover Sheet
for this property

Multiple Property Cover Sheet Reference Number: 64000849