

United States Department of the Interior
National Park ServiceNational Register of Historic Places
Inventory—Nomination Form

For NPS use only

received

date entered

Continuation sheet

Item number all

Page 88

SITE NO. 31

NAME Bronstad house

LOCATION ~~4 1/2~~ miles southwest of Clifton, Bosque County,
Texas, on J. Brown survey

OWNER Joe V. Guinn
Route 2 Box 36 A
Clifton, Texas 76634

PRESENT USE Private residence, agriculture

CATEGORY Building

STATUS Occupied

QUADRANGLE NAME Sugarloaf Mountain, Texas

QUADRANGLE SCALE 1:24000

UTM REFERENCE 14/628580/3514560

ACREAGE less than 1 acre

PHOTO REFERENCE 47

DESCRIPTION

The Bronstad house is a two-story residence that stands on relatively level terrain near Turkey Creek, about one half mile west of FM 219. Of wood-frame construction, with walls sheathed in shiplapped novelty siding, this house is in good condition and shows relatively few modern alterations. Its present plan is L-shaped, although the rear wing is an early addition. The symmetrical front faces southeast, and displays three dormer-like gables crowned with metal ridge cresting. The double-door entrance opens onto a small one-story porch that is supported by turned-wood columns with brackets. The posts are joined by a railing with simply turned balusters. All of the windows are double hung, usually with four-over-four lights. Interior brick chimneys extend upward at each end of the front, adding to the symmetry of the facade. The cross-gabled roof is covered with composition shingles. The house is the only structure on this property to be nominated.

SIGNIFICANCE

Little is known of the history of this house, but tax records at the county courthouse indicate that this property was owned by Ole Bronstad during the late 19th century. Because of its similarity to other frame house in the area, the residence is believed to have been erected in the 1890's. Retaining much of its integrity, it provides a good example of the symmetrical frame house popular throughout the area around 1900.

United States Department of the Interior
National Park Service

National Register of Historic Places
Inventory—Nomination Form

For NPS use only

received

date entered

Continuation sheet

Item number a11

Page 89

AREA TO BE NOMINATED

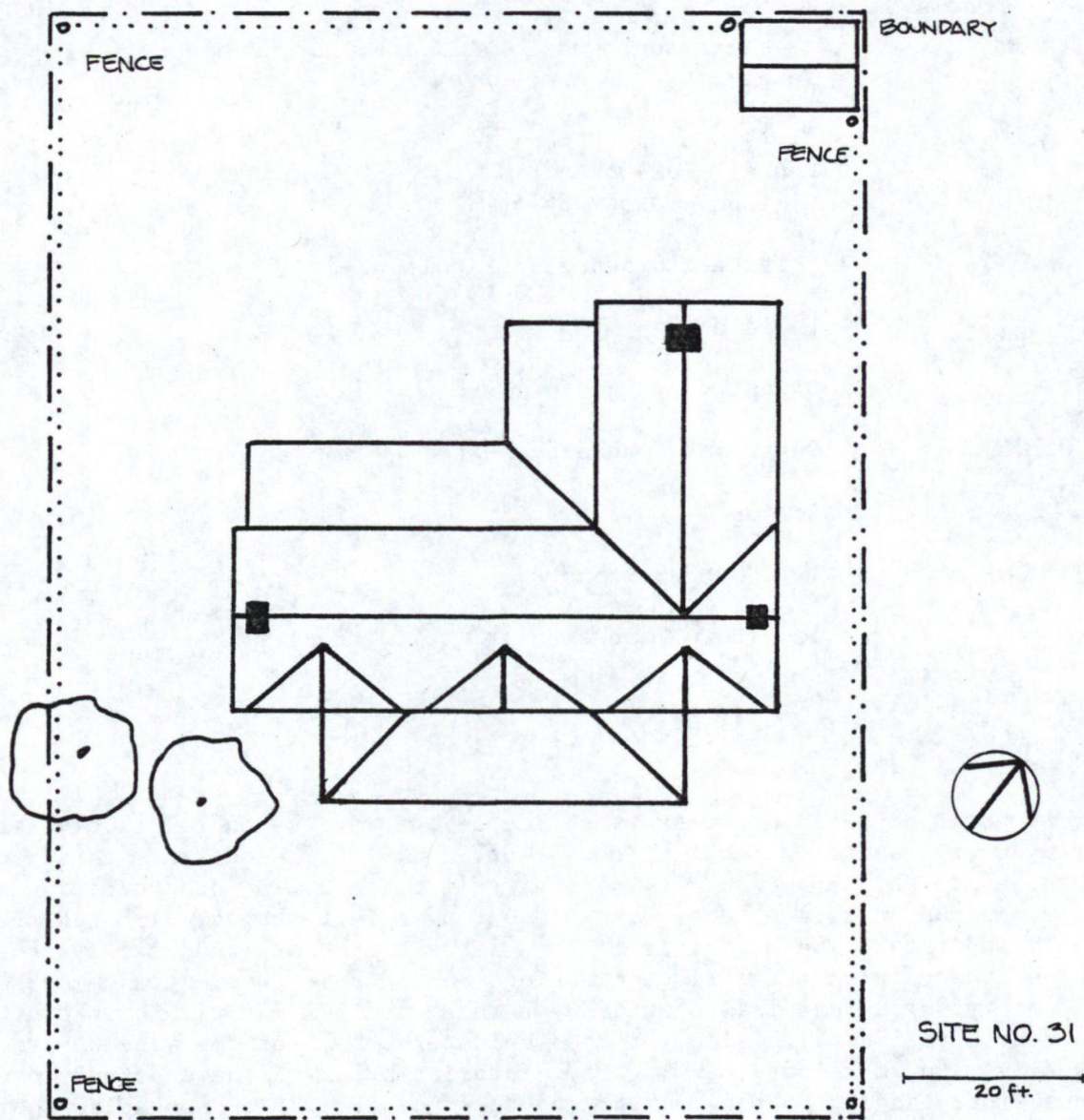

United States Department of the Interior
National Park Service

National Register of Historic Places
Inventory—Nomination Form

For NPS use only

received

date entered

Continuation sheet

Item number

Page 1/1

Multiple Resource Area
Thematic Group

dnr-11

Name Norwegian Settlement of Bosque County Thematic Resources
State Texas

Nomination/Type of Review

Date/Signature

1. Bekken, J. H., House

Entered in the
National Register

Keeper

7/22/83 Delores Byers

Attest

2. Brandhagen Houses

Entered in the
National Register

Keeper

7/22/83 Delores Byers

Attest

3. Brogdon Farm

Entered in the
National Register

Keeper

7/22/83 Delores Byers

Attest

4. Bronstad House

Entered in the
National Register

Keeper

7/22/83 Delores Byers

Attest

5. Colwick, John and Mary, Farm

Substantive Review

Keeper

Bob Grosvenor 7/22/83

Attest

6. Dahl, Peder, Farm

Entered in the
National Register

Keeper

7/22/83 Delores Byers

Attest

7. Ellingson Farm

Entered in the
National Register

Keeper

7/22/83 Delores Byers

Attest

8. Erickson, Even and Petrine,
Farm

Entered in the
National Register

Keeper

7/22/83 Delores Byers

Attest

9. Finstad, Ole and Elizabeth,
Homesite

Entered in the
National Register

Keeper

7/22/83 Delores Byers

Attest

10. Godager, Adolf and
Christine, Homesite

Entered in the
National Register

Keeper

7/22/83 Delores Byers

Attest

NATIONAL REGISTER OF HISTORIC PLACES

EVALUATION / RETURN SHEET

United States Department of the Interior
National Park Service

Bronstad House (Norwegian Settlement of
Bosque County TR)
Bosque County
TEXAS

Working No. JUN 9 1983

Fed. Reg. Date: 2789

Date Due: 7/7/83 - 7/24/83

Action: ☒ ACCEPT 7/22/83

Entered in the National Register

☐ RETURN

☐ REJECT

Federal Agency: _____

- ☐ resubmission
☐ nomination by person or local government
☐ owner objection
☐ appeal

Substantive Review: ☐ sample ☐ request ☐ appeal ☐ NR decision

Reviewer's comments: _____

Recom./Criteria _____

Reviewer _____

Discipline _____

Date _____

see continuation sheet

Nomination returned for: ☐ technical corrections cited below
☐ substantive reasons discussed below

1. Name

2. Location

3. Classification

Category	Ownership	Status	Present Use
	Public Acquisition	Accessible	

4. Owner of Property

5. Location of Legal Description

6. Representation in Existing Surveys

Has this property been determined eligible? ☐ yes ☐ no

7. Description

Condition		Check one	Check one
<input type="checkbox"/> excellent	<input type="checkbox"/> deteriorated	<input type="checkbox"/> unaltered	<input type="checkbox"/> original site
<input type="checkbox"/> good	<input type="checkbox"/> ruins	<input type="checkbox"/> altered	<input type="checkbox"/> moved date _____
<input type="checkbox"/> fair	<input type="checkbox"/> unexposed		

Describe the present and original (if known) physical appearance

- ☐ summary paragraph
☐ completeness
☐ clarity
☐ alterations/integrity
☐ dates
☐ boundary selection

8. Significance

Period _____ Area of Significance—Check and justify below

Specific dates _____ Builder/Architect _____

Statement of Significance (in one paragraph)

- _____ summary paragraph
- _____ completeness
- _____ clarity
- _____ applicable criteria
- _____ justification of areas checked
- _____ relating significance to the resource
- _____ context
- _____ relationship of integrity to significance
- _____ justification of exception
- _____ other

9. Major Bibliographical References

10. Geographical Data

Address of nominated property _____

Quadrangle name _____

USFT Reference _____

Verbal boundary description and justification _____

11. Form Prepared By

12. State Historic Preservation Officer Certification

The evaluated significance of this property within the state is:

_____ national _____ state _____ local

State Historic Preservation Officer signature _____

title _____ date _____

13. Other

- _____ Maps
- _____ Photographs
- _____ Other

Questions concerning this nomination may be directed to _____

Signed _____ Date _____ Phone: 202 272-3504

Comments for any item may be continued on an attached sheet



The Norwegian Settlement of Bosque County

Site No. 31, Bronstad House, 4½ miles south-
west of Clifton, Bosque County, Texas

Photograph: June 1979, by David Moore

On file, Texas Historical Commission

View of front facade, looking west

Photo 47 of 72

Please refer to the map in the
Multiple Property Cover Sheet
for this property

Multiple Property Cover Sheet Reference Number: 64000849