

United States Department of the Interior
National Park Service

National Register of Historic Places
Inventory—Nomination Form

For NPS use only

received

date entered

Continuation sheet

Item number 2, 4, 7, 10

Page 40

19.

COUNTY QUAD BLOCK BEL
CITY LOT SL 3097-344, Salado 7.5

NAME: White-Aiken House COUNTY: Bell

ADDRESS: IH 35, app. 1 mile north of town CITY: Salado

UTM: 14/640140/3425900

ARCHITECT/BUILDER: A.M. (Gus) White DATE: ca. 1910 PERIOD: FDT

OWNER: Mr. and Mrs. Benny Williams STYLE: rural vernacular farmhouse

Salado, Texas, 76571 THEME:

DESCRIPTION: 2-story asymmetrical plan, frame with clapboard, double hip with intersecting gable roof and hipped dormers, 2/2 and 1/1 windows, ridge cresting, porch wraps two sides of house, supported with heavy round columns, rear addition ca. 1975

fishscale shingling infill in gable ends, one end chimney on south gable

BUILDING MATERIAL: wall: frame/clapboard roof: composition shingle

PHYSICAL CONDITION: good SITE: original or moved date ca. 1918

ALTERATIONS: believed to be enlarged when moved, also addition in mid-1970's

SIGNIFICANCE: good example of early 20th-century farmhouse, still used as such, only example found in immediate area, original owner, White, and second owner, Aiken, who moved and enlarged structure were both prominent local farmers

AREA OF SIGNIFICANCE: architectural/historical LEVEL OF SIGNIFICANCE: local

DESIGNATION: NR NHL RTHL HABS HAER HESI HSI OTHER: _____

ORIGINAL USE: residence PRESENT USE: residence

RELATIONSHIP TO SURROUNDINGS: occupies large site on rise north of town, surrounded by farm land

ACREAGE/BOUNDARY DESCRIPTION: see map

BIBLIOGRAPHIC DATA: see Major Bibliographic References

SEE INFO/CORRESPONDENCE FILES: Salado file at Texas Historical Commission

RECORDED BY: S. Klein, M. Yancy; L. Flory INFORMANT: Mrs. Benny Williams, Mrs. Pat Barto

DATE: 3/77; 5/81 PHOTO DATA: B & W; color slides

(rev. 6-79)

United States Department of the Interior
National Park Service

National Register of Historic Places
Inventory—Nomination Form

For NPS use only
received
date entered

Continuation sheet

Item number 2, 4, 7, 10

Page 41

Acreeage of nominated property less than one

Verbal boundary description and justification

Beginning at a point approximately 44' east of front entrance to house, proceed approximately 45' north along fence line; then proceed west approximately 145' then proceed south approximately 114'; then proceed east approximately 162'; then proceed north approximately 69' to point of origin.

Nominated property includes house with apron of land and outbuildings which date from early 20th century.

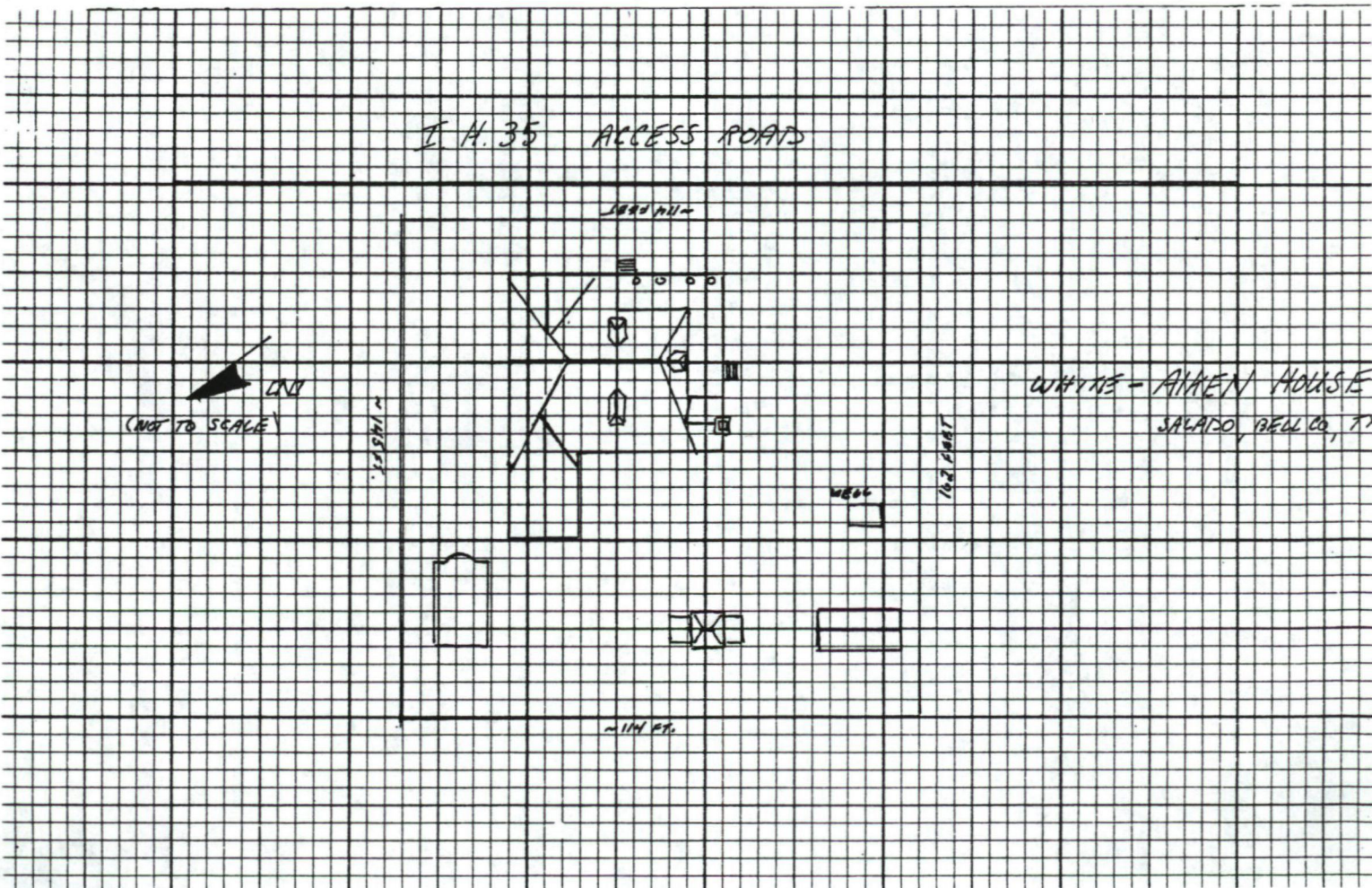

United States Department of the Interior
National Park Service

National Register of Historic Places
Inventory—Nomination Form

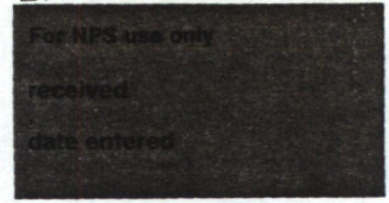

Continuation sheet

Item number

Page 1 of 2

Multiple Resource Area
Thematic Group

dnr-11

Name Salado Multiple Resource Area
State Texas

Nomination/Type of Review

Date/Signature

- | | | | | |
|-----|-------------------------------------------------------------|-------------------------------------|---------------------------|---------------|
| 1. | Stagecoach Inn | Entered in the
National Register | Keeper <u>[Signature]</u> | <u>4/5/83</u> |
| | | | Attest | |
| 2. | Barbee-Berry Mercantile Building | Substantive Review | Keeper <u>[Signature]</u> | <u>4/5/83</u> |
| | | | Attest | |
| 3. | Baines, George Washington, House | Entered in the
National Register | Keeper <u>[Signature]</u> | <u>4/5/83</u> |
| | | | Attest | |
| 4. | Robertson, Col. Elijah Sterling
Clack, Plantation | Entered in the
National Register | Keeper <u>[Signature]</u> | <u>4/5/83</u> |
| | | | Attest | |
| 5. | Rose House | Substantive Review | Keeper <u>[Signature]</u> | <u>4/5/83</u> |
| | | | Attest | |
| 6. | White-Aiken House | Entered in the
National Register | Keeper <u>[Signature]</u> | <u>4/5/83</u> |
| | | | Attest | |
| 7. | Armstrong-Adams House | Entered in the
National Register | Keeper <u>[Signature]</u> | <u>4/5/83</u> |
| | | | Attest | |
| 8. | Davis House | Entered in the
National Register | Keeper <u>[Signature]</u> | <u>4/5/83</u> |
| | | | Attest | |
| 9. | Pace Memorial Park
Archeological Site/Davis
Mill Site | Substantive Review | Keeper <u>[Signature]</u> | <u>4/5/83</u> |
| | | | Attest | |
| 10. | Salado College Archeological
Site | Substantive Review | Keeper <u>[Signature]</u> | <u>3/1/85</u> |
| | | | Attest | |

United States Department of the Interior
National Park Service

White-Aiken House (Salado MRA)
Bell County
TEXAS

Working No. FEB 23 1983

Fed. Reg. Date: 2.7.84

Date Due: 3/24/83 - 4/9/83

Action: ACCEPT 4/5/83

Entered in the RETURN

National Register REJECT

Federal Agency: _____

- resubmission
- nomination by person or local government
- owner objection
- appeal

Substantive Review: sample request appeal NR decision

Reviewer's comments:

Recom./Criteria _____

Reviewer _____

Discipline _____

Date _____

____ see continuation sheet

Nomination returned for: technical corrections cited below
 substantive reasons discussed below

1. Name

2. Location

3. Classification

Category	Ownership	Status	Present Use
	Public Acquisition	Accessible	

4. Owner of Property

5. Location of Legal Description

6. Representation in Existing Surveys

Has this property been determined eligible? yes no

7. Description

Condition		Check one	Check one
<input type="checkbox"/> excellent	<input type="checkbox"/> deteriorated	<input type="checkbox"/> unaltered	<input type="checkbox"/> original site
<input type="checkbox"/> good	<input type="checkbox"/> ruins	<input type="checkbox"/> altered	<input type="checkbox"/> moved date _____
<input type="checkbox"/> fair	<input type="checkbox"/> unexposed		

Describe the present and original (if known) physical appearance

- summary paragraph
- completeness
- clarity
- alterations/integrity
- dates
- boundary selection

8. Significance

Period _____ Area of Significance—Check and justify below

Specific dates _____ Builder-Architect _____

Statement of Significance (in one paragraph)

- _____ summary paragraph
- _____ completeness
- _____ clarity
- _____ applicable criteria
- _____ justification of areas checked
- _____ relating significance to the resource
- _____ context
- _____ relationship of integrity to significance
- _____ justification of exception
- _____ other

9. Major Bibliographical References

10. Geographical Data

Average of nominated property _____

Quadrangle name _____

USIT References _____

Verbal boundary description and justification _____

11. Form Prepared By

12. State Historic Preservation Officer Certification

The evaluated significance of this property within the state is:

_____ national _____ state _____ local

State Historic Preservation Officer signature _____

Title _____ date _____

13. Other

- _____ Maps
- _____ Photographs
- _____ Other

Questions concerning this nomination may be directed to _____

Signed _____ Date _____ Phone: 202 272-3504

Comments for any item may be continued on an attached sheet



White-Aiken House

North I H 35

Salado, Bell County, Texas

Photo: THC Staff, 1978, (note, subsequent survey
revealed that appearance of structure has
not changed since photo was taken)

Negative on file at THC

Southeast oblique, camera facing northwest

Photo # 40 of 44



White-Aiken House

North I H 35

Salado, Bell County, Texas

Photo: THC Staff, 1981

Negative on file at THC

Southwest oblique, camera facing northeast

Photo # 41 of 44

Please refer to the map in the
Multiple Property Cover Sheet
for this property

Multiple Property Cover Sheet Reference Number: 64000851