

United States Department of the Interior
National Park Service

National Register of Historic Places
Inventory—Nomination Form

For NPS use only

received

date entered

Continuation sheet

Item number 2, 4, 7, 10

Page 19

9. COUNTY BEL BLOCK SL 3097-344, Salado 7.5
CITY Salado QUAD 7.5 LOT 7.5

NAME: Davis House COUNTY: Bell
ADDRESS: Main Street CITY: Salado
UTM: 14/639810/3424220

ARCHITECT/BUILDER: James Madison Griffeth Davis DATE: ca. 1874 PERIOD: VT
OWNER: Lt. Col. and Mrs. Marvin H. Larsen STYLE: frame vernacular
P. O. Box 175, Salado, Texas, 76571 THEME:

DESCRIPTION: originally single-story double-pen dogrun house with two end fireplaces, modified ca. 1900 with the addition of a wood frame commercial structure moved up from nearby creek, north wing added ca. 1920; board-and-batten and clapboard siding with wood shake roof, 6/6 double-hung windows

BUILDING MATERIAL: wall: log/frame/clpbd./bd. and batten roof: wood shake
PHYSICAL CONDITION: good SITE: original or moved date 1970

ALTERATIONS: south wing added ca. 1900, north wing ca. 1920, sun porch on sw corner ca.

SIGNIFICANCE: home of early Salado resident and merchant active in local affairs, typical vernacular house form that has evolved to meet the changing needs of its occupants

AREA OF SIGNIFICANCE: architectural LEVEL OF SIGNIFICANCE: local

DESIGNATION: NR NHL RTHL HABS HAER HESI HSI OTHER:

ORIGINAL USE: residence PRESENT USE: residence

RELATIONSHIP TO SURROUNDINGS: occupies corner lot on Main Street close to creek and center of community

ACREAGE/BOUNDARY DESCRIPTION: see map

BIBLIOGRAPHIC DATA: see Major Bibliographic References

SEE INFO/CORRESPONDENCE FILES: Salado file at Texas Historical Commission

RECORDED BY: S. Klein, M. Yancy; D. Hardy INFORMANT: Lt. Col and Mrs. Marvin H, Larsen
DATE: 3/77; 9/77 PHOTO DATA: B & W; color slides

United States Department of the Interior
National Park Service

National Register of Historic Places
Inventory—Nomination Form

For NPS use only
received
date entered

Continuation sheet

Item number

2, 4, 7, 10

Page

20

Acreage of nominated property less than one

Verbal boundary description and justification

Beginning at a point approximately 44' south of center front of house, proceed west along north side of Pace Park Drive approximately 40'; then proceed north approximately 183' to a cedar fence; then proceed east along fence approximately 100'; then proceed south along fence line approximately 183'; then proceed west approximately 60' to point of origin.

Nominated property includes structure with apron of land surrounding.

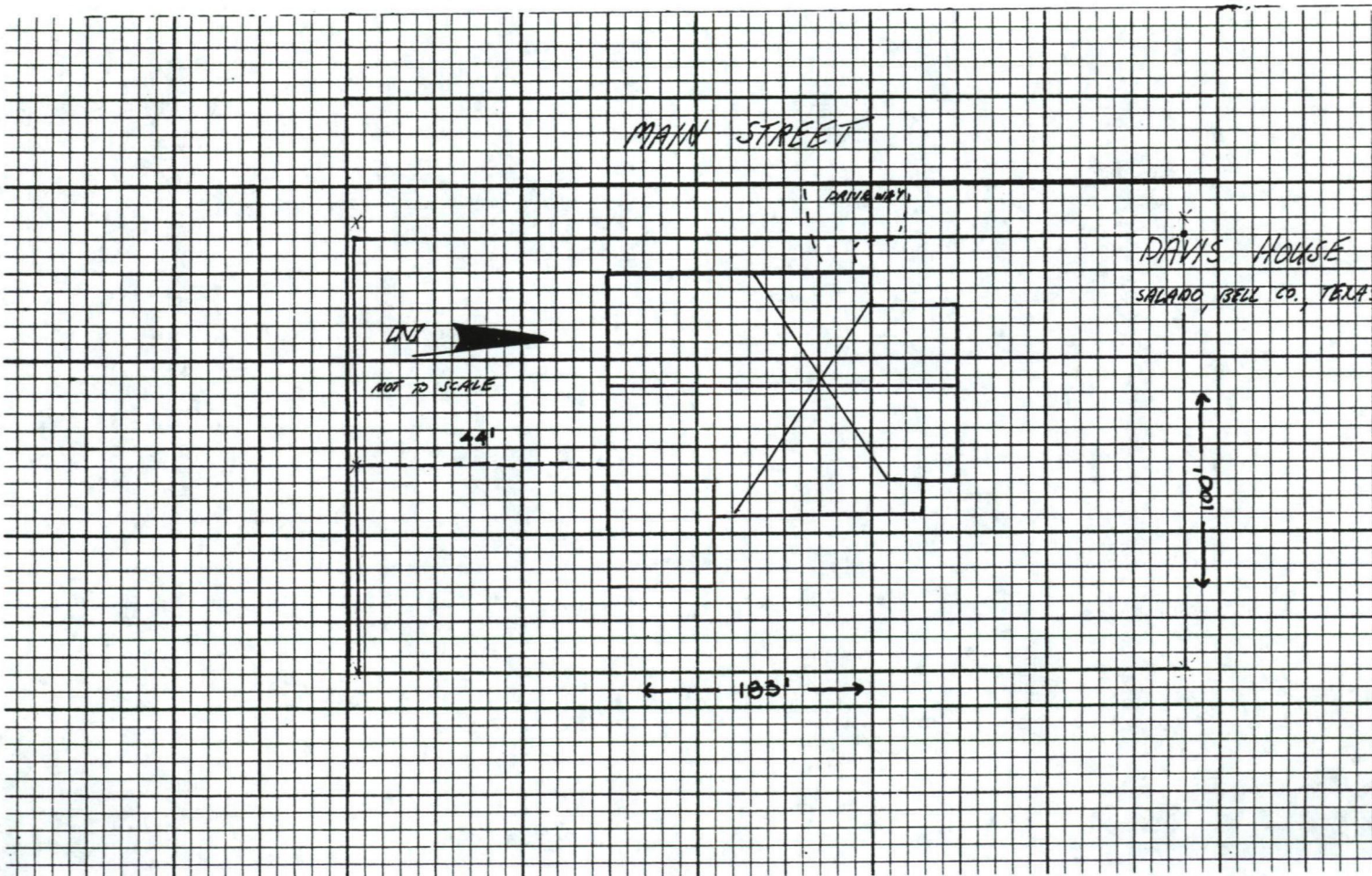

United States Department of the Interior
National Park Service

National Register of Historic Places
Inventory—Nomination Form

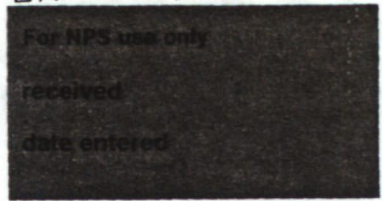

Continuation sheet

Item number

Page 1 of 2

Multiple Resource Area
Thematic Group

dnr-11

Name Salado Multiple Resource Area
State Texas

Nomination/Type of Review

Date/Signature

- | | | | | |
|-----|---|-------------------------------------|------------|----------------------------------|
| 1. | Stagecoach Inn | Entered in the
National Register | for Keeper | <u>Melvyn Byers</u> 4/5/83 |
| | | | Attest | _____ |
| 2. | Barbee-Berry Mercantile Building | Substantive Review | Keeper | <u>Beth Grosvenor</u> 8/20/84 |
| | | | Attest | _____ |
| 3. | Baines, George Washington, House | Entered in the
National Register | for Keeper | 4/5/83 <u>Melvyn Byers</u> |
| | | | Attest | _____ |
| 4. | Robertson, Col. Elijah Sterling
Clack, Plantation | Entered in the
National Register | for Keeper | 4/5/83 <u>Melvyn Byers</u> |
| | | | Attest | _____ |
| 5. | Rose House | Substantive Review | Keeper | <u>Return</u> S |
| | | | Attest | _____ |
| 6. | White-Aiken House | Entered in the
National Register | for Keeper | 4/5/83 <u>Melvyn Byers</u> |
| | | | Attest | _____ |
| 7. | Armstrong-Adams House | Entered in the
National Register | for Keeper | 4/5/83 <u>Melvyn Byers</u> |
| | | | Attest | _____ |
| 8. | Davis House | Entered in the
National Register | for Keeper | 4/5/83 <u>Melvyn Byers</u> |
| | | | Attest | _____ |
| 9. | Pace Memorial Park
Archeological Site/Davis
Mill Site | Substantive Review | Keeper | <u>Return</u> S |
| | | | Attest | _____ |
| 10. | Salado College Archeological
Site | Substantive Review | for Keeper | 3/1/85 <u>Spencer B. Stewart</u> |
| | | | Attest | _____ |

United States Department of the Interior
National Park Service

Davis House (Salado MRA)
Bell County
TEXAS

Working No. FEB 23 1983

Fed. Reg. Date: 2.7.84

Date Due: 3/24/83 - 4/9/83

Action: ACCEPT 4/5/83

Entered in the RETURN

National Register REJECT

Federal Agency: _____

- resubmission
- nomination by person or local government
- owner objection
- appeal

Substantive Review: sample request appeal NR decision

Reviewer's comments: _____

Recom./Criteria _____

Reviewer _____

Discipline _____

Date _____

see continuation sheet

Nomination returned for: technical corrections cited below
 substantive reasons discussed below

1. Name

2. Location

3. Classification

Category	Ownership	Status	Present Use
	Public Acquisition	Accessible	

4. Owner of Property

5. Location of Legal Description

6. Representation in Existing Surveys

Has this property been determined eligible? yes no

7. Description

Condition		Check one	Check one
<input type="checkbox"/> excellent	<input type="checkbox"/> deteriorated	<input type="checkbox"/> unaltered	<input type="checkbox"/> original site
<input type="checkbox"/> good	<input type="checkbox"/> ruins	<input type="checkbox"/> altered	<input type="checkbox"/> moved date _____
<input type="checkbox"/> fair	<input type="checkbox"/> unexposed		

Describe the present and original (if known) physical appearance

- summary paragraph
- completeness
- clarity
- alterations/integrity
- dates
- boundary selection

8. Significance

Period _____ Areas of Significance—Check and justify below

Specific dates _____ Builder/Architect _____

Statement of Significance (in one paragraph)

- _____ summary paragraph
- _____ completeness
- _____ clarity
- _____ applicable criteria
- _____ justification of areas checked
- _____ relating significance to the resource
- _____ context
- _____ relationship of integrity to significance
- _____ justification of exception
- _____ other

9. Major Bibliographical References

10. Geographical Data

Average of nominated property _____

Geographic name _____

USPT References _____

Verbal boundary description and justification _____

11. Form Prepared By

12. State Historic Preservation Officer Certification

The evaluated significance of this property within the state is:

_____ national _____ state _____ local

State Historic Preservation Officer signature _____

Title _____ date _____

13. Other

- _____ Maps
- _____ Photographs
- _____ Other

Questions concerning this nomination may be directed to _____

Signed _____ Date _____ Phone: 202 272-3504

Comments for any item may be continued on an attached sheet



805E
1400
1978

Davis House
Main Street
Salado, Bell County, Texas
Photo: THC Staff, 1978, (note, subsequent survey
revealed that appearance of structure has
not changed since photo was taken)
Northwest oblique, camera facing Southeast
Photo # 24 of 44

Please refer to the map in the
Multiple Property Cover Sheet
for this property

Multiple Property Cover Sheet Reference Number: 64000851