

**United States Department of the Interior
National Park Service**

**National Register of Historic Places
Inventory—Nomination Form**

For NPS use only
received
date entered

Continuation sheet

Item number 2, 4, 7, 10

Page 32

15.

COUNTY BLOCK BEL
CITY QUAD LOT SL 3097-344, Salado 7.5

NAME: Barton House COUNTY: Bell
ADDRESS: Main Street CITY: Salado
UTM: 14/639920/3424520

ARCHITECT/BUILDER: John Hendrickson, contractor DATE: 1866 PERIOD: RP
OWNER: Mr. and Mrs. Robert E. Denman STYLE: stone vernacular
Rt. 1, Salado, Texas, 76571 THEME:

DESCRIPTION: 2 story with full cellar, rectangular plan, random limestone ashlar construction, gable roof with chimney on north end, prominent cornice with carved-stone detail, flat arc above 6/6 double-hung windows, 1-story room projects from north end, entrance placed off-center with projecting portico, rear addition of frame/clapboard

BUILDING MATERIAL: wall: limestone roof: standing seam metal
PHYSICAL CONDITION: good SITE: original or moved _____ date _____

ALTERATIONS: rear addition in mid-20th century

SIGNIFICANCE: home of early Salado physician who held a partnership with Dr. B.D. McKie; house exhibits skilled stonemasonry but unusual in the asymmetrical placement of door and north wing on a house of this period, full cellar not common to area

AREA OF SIGNIFICANCE: architectural/historical LEVEL OF SIGNIFICANCE: local

DESIGNATION: NR NHL RTHL HABS HAER HESI HSI OTHER: _____

ORIGINAL USE: residence PRESENT USE: residence

RELATIONSHIP TO SURROUNDINGS: set back from Main Street on large lot that backs up to creek

ACREAGE/BOUNDARY DESCRIPTION: see map

BIBLIOGRAPHIC DATA: see Major Bibliographic References

SEE INFO/CORRESPONDENCE FILES: Salado file at Texas Historical Commission

RECORDED BY: D. Hardy, M. Heck; L. Flory INFORMANT: Mr. and Mrs. Robert Denman

DATE: 9/77; 5/81 PHOTO DATA: B & W; color slides

(rev. 6-79)

United States Department of the Interior
National Park Service

National Register of Historic Places
Inventory—Nomination Form

For NPS use only
received
date entered

Continuation sheet

Item number 2, 4, 7, 10

Page 33

Acreage of nominated property less than one

Verbal boundary description and justification

Beginning at a point approximately 15' west of front door of structure, proceed north approximately 60'; then proceed east approximately 80'; then proceed south approximately 75'; then proceed west approximately 80'; then proceed north approximately 15' to point of origin.

Nominated property includes structure with apron of land.

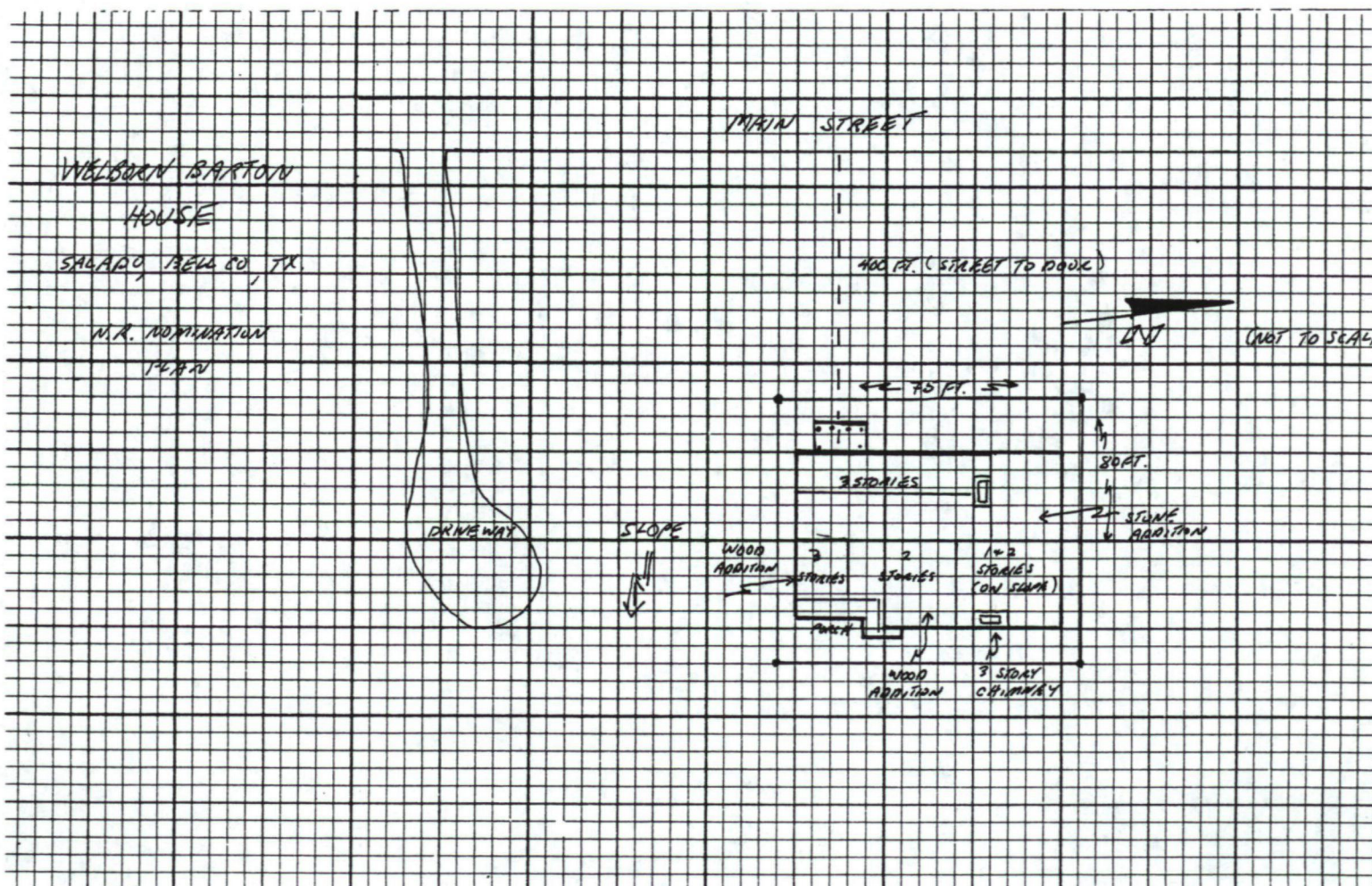

United States Department of the Interior National Park Service National Register of Historic Places Inventory—Nomination Form

For NPS use only
received
date entered

Continuation sheet Item number Page 2 of 2

Multiple Resource Area
Thematic Group

Name Salado Multiple Resource Area
State Texas

Nomination/Type of Review	Date/Signature
11. Vickrey House Entered in the National Register	<i>for</i> Keeper <u>4/5/83 Melvyn Byers</u> Attest _____
12. Twelve Oaks (McKie House) Entered in the National Register	<i>for</i> Keeper <u>4/5/83 Melvyn Byers</u> Attest _____
13. Barton House Entered in the National Register	<i>for</i> Keeper <u>4/5/83 Melvyn Byers</u> Attest _____
14. Jones, Thomas, Mill <i>nc</i> Archeological Site Substantive Review	Keeper <u>Return</u> 5 Attest _____
15. Tyler House Entered in the National Register	<i>for</i> Keeper <u>4/5/83 Melvyn Byers</u> Attest _____
16. Tenney, Levi, House Entered in the National Register	<i>for</i> Keeper <u>4/5/83 Melvyn Byers</u> Attest _____
17. Fowler House Entered in the National Register	<i>for</i> Keeper <u>4/5/83 Melvyn Byers</u> Attest _____
18. Anderson House and Store Entered in the National Register	<i>for</i> Keeper <u>4/5/83 Melvyn Byers</u> Attest _____
19. Salado United Methodist Church Substantive Review	Keeper <u>Beth Garwood 8/22/84</u> Attest _____
20. Halley, Capt. Robert, House Entered in the National Register	<i>for</i> Keeper <u>4/5/83 Melvyn Byers</u> Attest _____

United States Department of the Interior
National Park Service

Barton House (Salado MRA)
Bell County
TEXAS

Working No. FEB 23 1983
Fed. Reg. Date: 2.7.84
Date Due: 3/24/83 - 4/9/83
Action: ACCEPT 4/5/83
 RETURN
 REJECT
Entered in the
National Register
Federal Agency: _____

- resubmission
- nomination by person or local government
- owner objection
- appeal

Substantive Review: sample request appeal NR decision

Reviewer's comments:

Recom./Criteria _____
Reviewer _____
Discipline _____
Date _____
see continuation sheet

Nomination returned for: technical corrections cited below
 substantive reasons discussed below

1. Name

2. Location

3. Classification

Category Ownership Status Present Use
 Public Acquisition Accessible

4. Owner of Property

5. Location of Legal Description

6. Representation in Existing Surveys

Has this property been determined eligible? yes no

7. Description

Condition Check one Check one
 excellent deteriorated unaltered original site
 good ruins altered moved date _____
 fair unexposed

Describe the present and original (if known) physical appearance

- summary paragraph
- completeness
- clarity
- alterations/integrity
- dates
- boundary selection

8. Significance

Period _____ Area of Significance—Check and justify below

Specific dates _____ Builder/Architect _____

Statement of Significance (in one paragraph)

- _____ summary paragraph
- _____ completeness
- _____ clarity
- _____ applicable criteria
- _____ justification of areas checked
- _____ relating significance to the resource
- _____ context
- _____ relationship of integrity to significance
- _____ justification of exception
- _____ other

9. Major Bibliographical References

10. Geographical Data

Address of nominated property _____

Geographic name _____

USIT References _____

Verbal boundary description and justification _____

11. Form Prepared By

12. State Historic Preservation Officer Certification

The evaluated significance of this property within the state is:

_____ national _____ state _____ local

State Historic Preservation Officer signature _____

title _____ date _____

13. Other

- _____ Maps
- _____ Photographs
- _____ Other

Questions concerning this nomination may be directed to _____

Signed _____ Date _____ Phone: 202 272-3504

Comments for any item may be continued on an attached sheet



Barton House
Main Street
Salado, Bell County, Texas
Photo: THC Staff, 1978, (note, subsequent survey
revealed that appearance of structure
has not changed since photo was taken)
Negative on file at THC
Southwest oblique, camera facing Northeast
Photo # 32 of 44

Please refer to the map in the
Multiple Property Cover Sheet
for this property

Multiple Property Cover Sheet Reference Number: 64000851