

PH0660701

DATA SHEET

UNITED STATES DEPARTMENT OF THE INTERIOR

NATIONAL PARK SERVICE

HCRS

FOR NPS USE ONLY

RECEIVED

JAN 24 1978

DATE ENTERED

MAY 5 1978

NATIONAL REGISTER OF HISTORIC PLACES INVENTORY -- NOMINATION FORM

SEE INSTRUCTIONS IN HOW TO COMPLETE NATIONAL REGISTER FORMS
TYPE ALL ENTRIES -- COMPLETE APPLICABLE SECTIONS

1 NAME

HISTORIC

**

Stiles Old Reagan County Courthouse

AND/OR COMMON

Stiles Courthouse

2 LOCATION

STREET & NUMBER

off TX 137

NOT FOR PUBLICATION

CITY, TOWN

Stiles

CONGRESSIONAL DISTRICT

21

STATE

Texas

VICINITY OF

CODE
048

COUNTY

Reagan

CODE
383 ✓

3 CLASSIFICATION

CATEGORY

- DISTRICT
- BUILDING(S)
- STRUCTURE
- SITE
- OBJECT

OWNERSHIP

- PUBLIC
- PRIVATE
- BOTH
- PUBLIC ACQUISITION**
- IN PROCESS
- BEING CONSIDERED

STATUS

- OCCUPIED
- UNOCCUPIED
- WORK IN PROGRESS
- ACCESSIBLE**
- YES: RESTRICTED
- YES: UNRESTRICTED
- NO

PRESENT USE

- AGRICULTURE
- COMMERICAL
- EDUCATIONAL
- ENTERTAINMENT
- GOVERNMENT
- INDUSTRIAL
- MILITARY
- MUSEUM
- PARK
- PRIVATE RESIDENCE
- RELIGIOUS
- SCIENTIFIC
- TRANSPORTATION
- OTHER:

4 OWNER OF PROPERTY

NAME

Reagan County

STREET & NUMBER

CITY, TOWN

Big Lake

VICINITY OF

STATE

Texas

5 LOCATION OF LEGAL DESCRIPTION

COURTHOUSE,
REGISTRY OF DEEDS, ETC.

County Courthouse

STREET & NUMBER

CITY, TOWN

Big Lake

STATE

Texas

6 REPRESENTATION IN EXISTING SURVEYS

TITLE

none

DATE

FEDERAL STATE COUNTY LOCAL

DEPOSITORY FOR
SURVEY RECORDS

CITY, TOWN

STATE

7 DESCRIPTION

CONDITION

EXCELLENT
 GOOD
 FAIR

DETERIORATED
 RUINS
 UNEXPOSED

CHECK ONE

UNALTERED
 ALTERED

CHECK ONE

ORIGINAL SITE
 MOVED DATE _____

DESCRIBE THE PRESENT AND ORIGINAL (IF KNOWN) PHYSICAL APPEARANCE

The old Stiles Courthouse now stands alone on a fading courthouse square in Stiles, Texas. The white board fence that once surrounded the courthouse property and the town buildings that circumscribed the square have all disappeared since the County Seat was moved twenty miles to the south of Stiles over fifty years ago. The stone courthouse and associated records vault are the only survivors of this early community that has now faded into the desolate plains of West Texas.

The courthouse is a square building, 50' long at each elevation. The four facades of the two-story limestone rusticated structure are identical and symmetrically organized in an A-B-A pattern. The center section of the facade consists of a projecting one-story stone portico with arched entranceway. A pair of 4-over-4 single-hung windows are located in the projection continuation above the portico. A wooden balustrade originally capped the portico but has since been removed. On either side of the portico are two 4-over-4 windows, one on each floor.

The building has a hip roof with four small gables located over the central projection on each facade. A small semicircular window is located within the pediment of the gables. The cornice is simply detailed with an enclosed soffit. Four stone chimneys penetrate the roof at the outside corners. The roof structure was originally crowned by a cupola which has since been removed.

The first floor interior plan is a Greek cross with intersecting center hallways and four corner rooms measuring 16' square. The stairway is located in the west hallway. The courtroom and two other offices are located on the second floor. Interior detailing includes plaster walls, simple door/window trim and baseboard, transoms over doorways and a wooden chair rail in the courtroom. The ceiling on both floors is pressed tin and the floors are wooden. A small raised platform is the only distinguishing feature in the courtroom.

A limestone records vault is located to the east of the main structure. It was originally built to provide fireproof storage for the earlier frame courthouse that occupied the site. It has a stone barrel vault, but was originally roofed over with a shingle roof. The steel vault doors are still in possession of the owner.

8 SIGNIFICANCE

PERIOD	AREAS OF SIGNIFICANCE -- CHECK AND JUSTIFY BELOW			
<input type="checkbox"/> PREHISTORIC	<input type="checkbox"/> ARCHEOLOGY-PREHISTORIC	<input type="checkbox"/> COMMUNITY PLANNING	<input type="checkbox"/> LANDSCAPE ARCHITECTURE	<input type="checkbox"/> RELIGION
<input type="checkbox"/> 1400-1499	<input type="checkbox"/> ARCHEOLOGY-HISTORIC	<input type="checkbox"/> CONSERVATION	<input checked="" type="checkbox"/> LAW	<input type="checkbox"/> SCIENCE
<input type="checkbox"/> 1500-1599	<input type="checkbox"/> AGRICULTURE	<input type="checkbox"/> ECONOMICS	<input type="checkbox"/> LITERATURE	<input type="checkbox"/> SCULPTURE
<input type="checkbox"/> 1600-1699	<input checked="" type="checkbox"/> ARCHITECTURE	<input checked="" type="checkbox"/> EDUCATION	<input type="checkbox"/> MILITARY	<input checked="" type="checkbox"/> SOCIAL/HUMANITARIAN
<input type="checkbox"/> 1700-1799	<input type="checkbox"/> ART	<input type="checkbox"/> ENGINEERING	<input type="checkbox"/> MUSIC	<input type="checkbox"/> THEATER
<input type="checkbox"/> 1800-1899	<input type="checkbox"/> COMMERCE	<input type="checkbox"/> EXPLORATION/SETTLEMENT	<input type="checkbox"/> PHILOSOPHY	<input type="checkbox"/> TRANSPORTATION
<input checked="" type="checkbox"/> 1900-	<input type="checkbox"/> COMMUNICATIONS	<input type="checkbox"/> INDUSTRY	<input checked="" type="checkbox"/> POLITICS/GOVERNMENT	<input type="checkbox"/> OTHER (SPECIFY)
		<input type="checkbox"/> INVENTION		

SPECIFIC DATES 1911 BUILDER/ARCHITECT William Martin

STATEMENT OF SIGNIFICANCE

The Stiles Courthouse was the first substantial courthouse built in Reagan County. The rusticated stone complex, consisting of the courthouse and jail and a separate stone vault, was built on the Public Square in 1911. The four symmetrical facades of the courthouse were a source of pride for Reagan County citizens until the county seat was moved to Big Lake in 1925. Since that time, the courthouse has been used as a community center for parties, barbecues and dances. It was used as a school for one year.

Stiles was the only town in Reagan County when that county was organized in May, 1903. Located on Centralia Draw, Stiles is approximately in the center of the county. Property for the Public Square was deeded to the county by G. W. (Rome) Shields for \$579.44. The first courthouse built on the square was a small frame building costing less than \$500. The next year, \$5000 in bonds were voted to build a more substantial courthouse containing a jail, and a separate stone vault. A subsequent bond election in November, 1910, provided \$20,000 in 40-year bonds for a two-story stone building on the Public Square. The first contractor hired to build the courthouse was August Balfanz of San Angelo. When Balfanz had failed to begin work on the structure within 30 days, the court rescinded his contract on February 2, 1911. The next day the court awarded the contract to William Martin of Comanche, Texas. Mr. Martin was required to begin work immediately and have the building completed in eight months. The new courthouse was finished and inspected by the Commissioners Court on October 25, 1911. The old frame courthouse was sold at public auction for \$107.50 on November 13, 1911, to the highest bidder, T. D. Lucas.

The new courthouse was built of native stone quarried from a hillside a half a mile from the site. The stones were hauled to the site in mule- and donkey-drawn wagons by Tom Lucas, a Mr. Sheppard, and A. H. Garner.

UNITED STATES DEPARTMENT OF THE INTERIOR
NATIONAL PARK SERVICE

**NATIONAL REGISTER OF HISTORIC PLACES
INVENTORY -- NOMINATION FORM**

FOR NPS USE ONLY

RECEIVED

JAN 27 1978

DATE ENTERED

CONTINUATION SHEET

ITEM NUMBER 8 PAGE 2

Mr. Garner, a new resident of the county, was a stonemason by trade. He was unable to work on the courthouse in that capacity, however, because he belonged to the Stonemasons Union, and the courthouse was not built with union labor.

In 1912 the Kansas City, Mexico and Orient Railroad planned to build a line up Centralia Draw from San Angelo through Stiles to Fort Stockton. A prominent land owner in Reagan County refused to sell a right-of-way, so the line swung twenty miles to the south, bypassing Stiles. Big Lake was organized in 1912, as a result of the railroad, and had reached the size of Stiles by 1919. In 1923 the famed Santa Rita oil well was brought in west of Big Lake, near the railroad. Big Lake boomed, and was voted the new county seat by a margin of 292 to 94 in 1925. Since then the town of Stiles has slowly dwindled. Its old courthouse, however, remained a central gathering place for the West Texas community for many years. It was last occupied in the early 1950's and has remained unoccupied until this day. An advanced state of deterioration has prompted the present owner, Reagan County, to pursue restoration of the structure for future community use.

9 MAJOR BIBLIOGRAPHICAL REFERENCES

THC Marker Files, "Stiles Courthouse," Texas Historical Commission, Austin, Texas, 1969.

10 GEOGRAPHICAL DATA

ACREAGE OF NOMINATED PROPERTY 3 acres

QUADRANGLE NAME Stiles, TX

QUADRANGLE SCALE 1:24000

UTM REFERENCES

A 14 256980 3477300

B

ZONE EASTING NORTHING

ZONE EASTING NORTHING

C

D

E

F

G

H

VERBAL BOUNDARY DESCRIPTION

Public Square of Stiles, Texas

LIST ALL STATES AND COUNTIES FOR PROPERTIES OVERLAPPING STATE OR COUNTY BOUNDARIES

STATE	CODE	COUNTY	CODE
-------	------	--------	------

STATE	CODE	COUNTY	CODE
-------	------	--------	------

11 FORM PREPARED BY

NAME / TITLE

David Hoffman, Architect; Binnie McCreary, Historian

ORGANIZATION

Bell, Klein & Hoffman

DATE

January 6, 1978

STREET & NUMBER

920 B Congress Ave.

TELEPHONE

476-3033

CITY OR TOWN

Austin

STATE

Texas 78701

12 STATE HISTORIC PRESERVATION OFFICER CERTIFICATION

THE EVALUATED SIGNIFICANCE OF THIS PROPERTY WITHIN THE STATE IS:

NATIONAL

STATE

LOCAL

As the designated State Historic Preservation Officer for the National Historic Preservation Act of 1966 (Public Law 89-665), I hereby nominate this property for inclusion in the National Register and certify that it has been evaluated according to the criteria and procedures set forth by the National Park Service.

STATE HISTORIC PRESERVATION OFFICER SIGNATURE

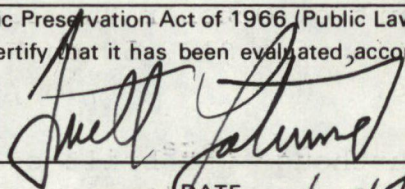

TITLE Texas Historic Preservation Officer

DATE

1-18-78

FOR NPS USE ONLY

I HEREBY CERTIFY THAT THIS PROPERTY IS INCLUDED IN THE NATIONAL REGISTER

DATE

5/5/78

ATTEST:

KEEPER OF THE NATIONAL REGISTER



DATE

4-26-78

CHIEF OF REGISTRATION

78002976

Property Old Reagan County Courthouse

State IN.

Working Number 1.24.78.2260

Reagan

TECHNICAL

Photos 3
Maps 1

CONTROL

OK ^{pl} 1.25.78

HISTORIAN

Shufy
3-23-78
accept

Good building. ~~is~~ so this a
case where "old" can remain
in title?

ARCHITECTURAL HISTORIAN

accept
Brigham
3.6.78

The county is planning
restoration -

ARCHEOLOGIST

OTHER

HAER

Inventory _____
Review _____

REVIEW UNIT CHIEF

see last sentence #8
of significance a County courthouse

Accept
Leovich
4/14/78

BRANCH CHIEF

KEEPER

[Signature]
5/15/78

National Register Write-up _____
Federal Register Entry 6.6.78

Send-back _____
Re-submit _____

Entered MAY 5 1978

INT:2106-74



PROPERTY OF THE NATIONAL REGISTER

Old Reagan County Courthouse
Stiles, Reagan County, Texas

Ty Cox, 1977
Negatives filed at THC

West elevation

Photo #1 ²³

JAN 24 1978

MAY 5 1978



PROPERTY OF THE NATIONAL REGISTER

Old Reagan County Courthouse
Stiles, Reagan County, Texas

Ty Cox, 1977
Negatives filed at THC

Southeast oblique

Photo #2 *q3*

JAN 24 1978

MAY 5 1978



PROPERTY OF THE NATIONAL REGISTER

PROPERTY OF THE NATIONAL REGISTER

Old Reagan County Courthouse
Stiles, Reagan County, Texas

Ty Cox, 1977
Negatives filed at THC

Northeast oblique showing the
remains of the vault on the
east side of the building.

Photo #3 ²³

JAN 24 1978

MAY 5 1978

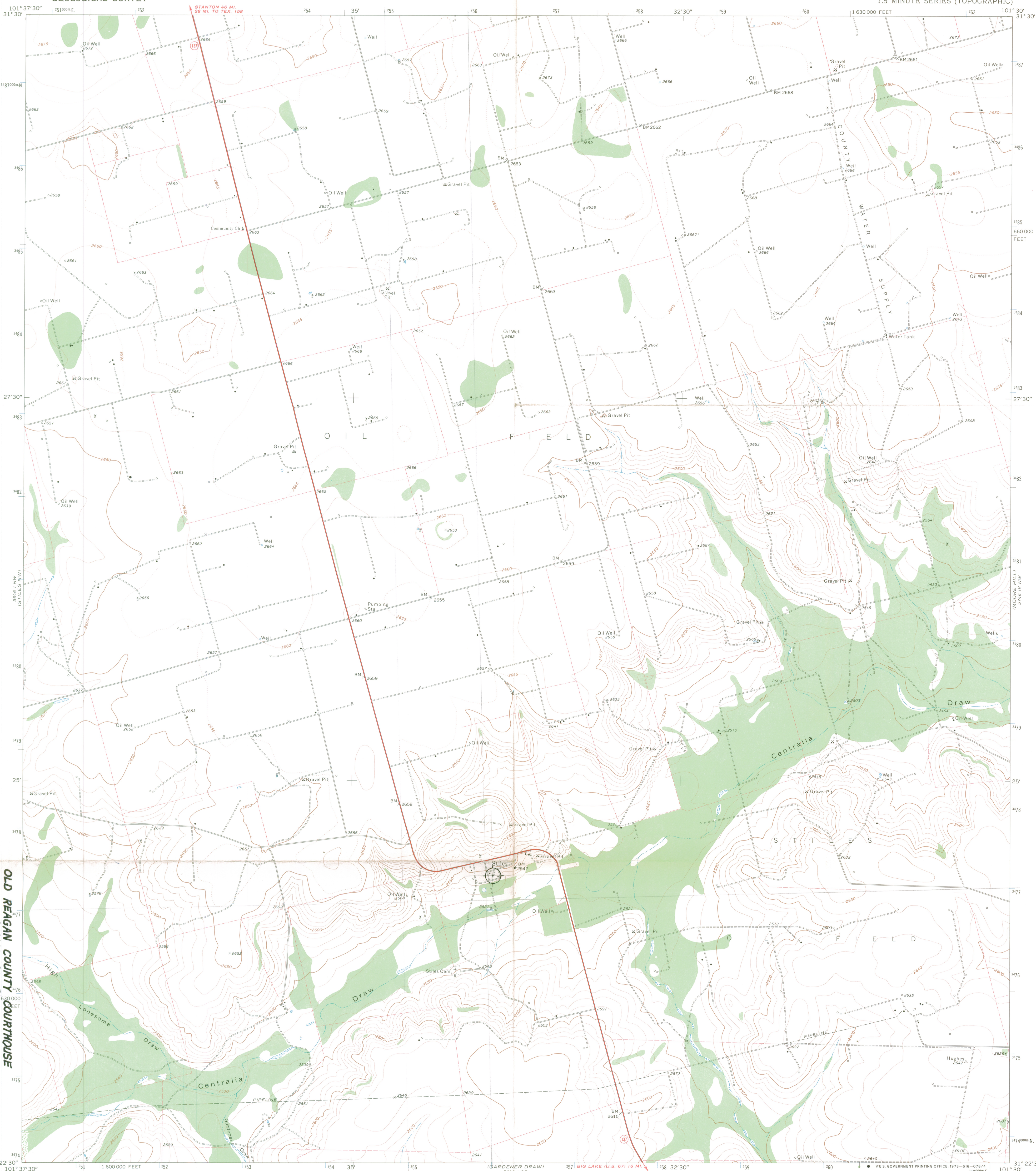

OLD REAGAN COUNTY COURTHOUSE
STILES, REAGAN COUNTY, TEXAS
UTM REFERENCE: 14J256080/3471300

Mapped, edited, and published by the Geological Survey
Control by USGS and USC&GS
Topography by photogrammetric methods from aerial photographs taken 1968. Field checked 1970
Polyconic projection. 1927 North American datum
10,000-foot grid based on Texas coordinate system,
central zone
1,000-meter Universal Transverse Mercator grid ticks,
zone 14 shown in blue
Fine red dashed lines indicate selected fence lines

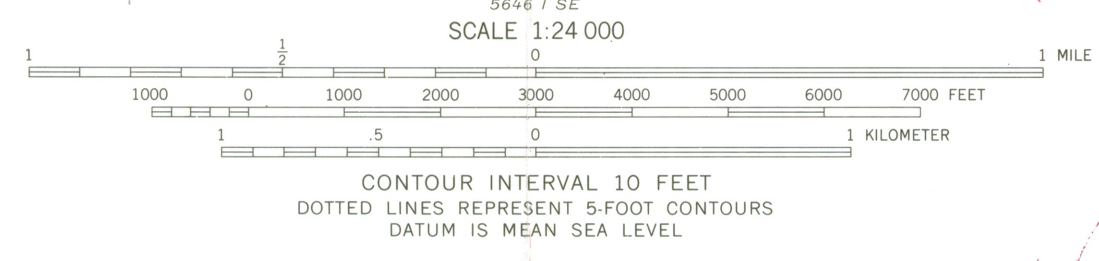
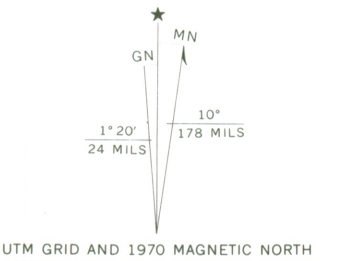

ROAD CLASSIFICATION

Primary highway, hard surface	Light-duty road, hard or improved surface
Secondary highway, hard surface	Unimproved road
Interstate Route	U. S. Route
	State Route

THIS MAP COMPLIES WITH NATIONAL MAP ACCURACY STANDARDS
FOR SALE BY U. S. GEOLOGICAL SURVEY, DENVER, COLORADO 80225, OR WASHINGTON, D. C. 20242
A FOLDER DESCRIBING TOPOGRAPHIC MAPS AND SYMBOLS IS AVAILABLE ON REQUEST

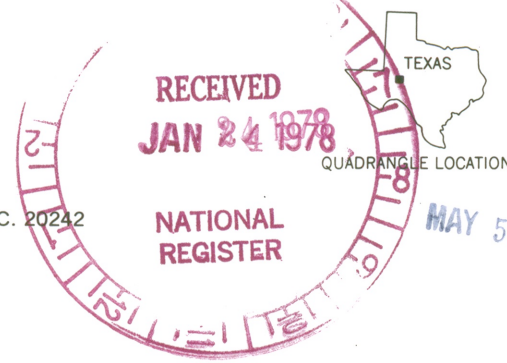

MAY 7 1973

3101-244

STILES, TEX.
N3122.5-W10130/7.5
1970
AMS 5646 1E—SERIES V882



TEXAS HISTORICAL COMMISSION

P. O. BOX 12276 CAPITOL STATION AUSTIN, TEXAS 78711

TRUETT LATIMER
EXECUTIVE DIRECTOR

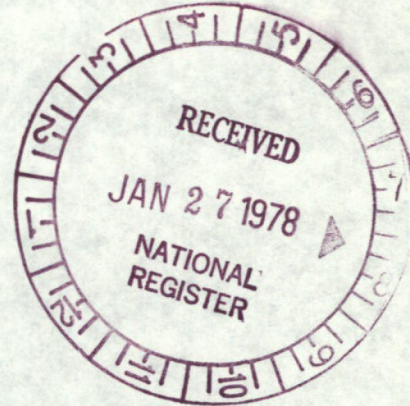

January 24, 1978

National Register
of Historic Places
Dept. of the Interior
National Park Service
Washington, D. C. 20240

To Whom It May Concern:

The enclosed continuation sheet for the Old Reagan County Courthouse was inadvertently left out of the nomination which was sent to you on January 18, 1978.

Please excuse this inconvenience.

Sincerely,

A handwritten signature in cursive script that reads "Daisy Schwartz".

National Register Department

Enclosure

ENTRIES IN THE NATIONAL REGISTER

STATE TEXAS

Date Entered MAY 5 1978

<u>Name</u>	<u>Location</u>
Wilson County Courthouse and Jail	Floresville Wilson County
Old Reagan County Courthouse	Stiles Reagan County
41 CX 110	Crockett County

Also Notified

Hon. John G. Tower
Hon. Lloyd M. Bentsen
Hon. Abraham Kazen, Jr.
Hon. Robert C. Krueger

NR Mott 5/8/78

State Historic Preservation Officer
Mr. Truett Latimer
Executive Director
Texas Historical Commission
P. O. Box 12276, Capitol Station
Austin, Texas 78711

NATIONAL REGISTER DATA SHEET

① NAME as it appears on federal register: Old Reagan County Courthouse		② OTHER NAMES: Stiles Courthouse		③ date of entry: MAY 5 1978	④ county code: 383
⑤ LOCATION street & number off TX 137		city / town Stiles	vicinity of	state TX	county Reagan
⑦ OWNER <input type="checkbox"/> PRIVATE <input type="checkbox"/> STATE <input type="checkbox"/> MUNICIPAL <input checked="" type="checkbox"/> COUNTY <input type="checkbox"/> MULTIPLE <input type="checkbox"/> FEDERAL (agency name)				⑧ ADMINISTRATOR:	
⑨ EXISTING SURVEYS <input type="checkbox"/> NABS <input type="checkbox"/> HAER <input type="checkbox"/> NHL		⑩ FUNDED? <input type="checkbox"/> YES <input type="checkbox"/> NO	⑪ CONGRESS. DISTRICT 21st	⑫ SOURCE of NOMINATION <input checked="" type="checkbox"/> STATE <input type="checkbox"/> FEDERAL	
⑬ WITHIN NATIONAL REGISTER HISTORIC DISTRICT? <input type="checkbox"/> YES, NAME <input type="checkbox"/> NO		⑭ WITHIN NATIONAL HISTORIC LANDMARK? <input type="checkbox"/> YES, NAME <input type="checkbox"/> NO		⑮ ACREAGE	
⑯ CONDITION		⑰ FEATURES:		⑱ ADMINISTRATOR: Bell, Klein and Hoffman if state who prepared form? <input type="checkbox"/> LOCAL <input type="checkbox"/> PRIVATE ORGANIZATION	
<input type="checkbox"/> deteriorated <input type="checkbox"/> excellent <input type="checkbox"/> good <input type="checkbox"/> fair		<input type="checkbox"/> altered <input type="checkbox"/> unaltered <input type="checkbox"/> reconstructed <input type="checkbox"/> excavated		<input type="checkbox"/> original site <input type="checkbox"/> moved <input type="checkbox"/> unknown	
<input type="checkbox"/> SUBSTANTIALLY INTACT-1 <input type="checkbox"/> NOT INTACT-0 <input type="checkbox"/> UNKNOWN-4 <input type="checkbox"/> NOT APPLICABLE-7		<input type="checkbox"/> SUBSTANTIALLY INTACT-2 <input type="checkbox"/> NOT INTACT-0 <input type="checkbox"/> UNKNOWN-5 <input type="checkbox"/> NOT APPLICABLE-8		<input type="checkbox"/> SUBSTANTIALLY INTACT-3 <input type="checkbox"/> NOT INTACT-0 <input type="checkbox"/> UNKNOWN-6 <input type="checkbox"/> NOT APPLICABLE-9	
⑲ ACCESS <input type="checkbox"/> YES-Restricted <input type="checkbox"/> YES-Unrestricted <input type="checkbox"/> No Access <input type="checkbox"/> Unknown		⑳ ADAPTIVE USE <input type="checkbox"/> YES <input type="checkbox"/> NO		㉑ SAVED? <input type="checkbox"/> YES <input type="checkbox"/> NO	
⑳ AREAS OF SIGNIFICANCE :		㉒ CLAIMS: explain		IS PROPERTY A HISTORIC DISTRICT? <input type="checkbox"/> yes <input type="checkbox"/> no	
<input type="checkbox"/> ARCHAEOLOGY-prehistoric-2 <input type="checkbox"/> ARCHAEOLOGY-historic-1 <input type="checkbox"/> AGRICULTURE-3 <input type="checkbox"/> ARCHITECTURE-4 <input type="checkbox"/> ART-5		<input type="checkbox"/> ENGINEERING-11 <input type="checkbox"/> ENTERTAINMENT-26 <input type="checkbox"/> COMMUNICATIONS-7 <input type="checkbox"/> CONSERVATION-8 <input type="checkbox"/> ECONOMICS-9 <input type="checkbox"/> EDUCATION-10		<input type="checkbox"/> LANDSCAPE ARCH.-15 <input type="checkbox"/> LAW-16 <input type="checkbox"/> LITERATURE-17 <input type="checkbox"/> MILITARY-18 <input type="checkbox"/> MUSIC-19 <input type="checkbox"/> PHILOSOPHY-20	
<input type="checkbox"/> POLITICS/GOVT.-21 <input type="checkbox"/> RELIGION-22 <input type="checkbox"/> SCIENCE-23 <input type="checkbox"/> SOCIAL/HUMANITARIAN-24 <input type="checkbox"/> SOCIAL/CULTURAL-30 <input type="checkbox"/> TRANSPORTATION-25		<input type="checkbox"/> RECREATION-28 <input type="checkbox"/> SETTLEMENT-29 <input type="checkbox"/> URBAN PLANNING-31 <input type="checkbox"/> OTHER (SPECIFY)		<input type="checkbox"/> 'first' <input type="checkbox"/> 'oldest' <input type="checkbox"/> 'only'	
㉓ functions WHEN HISTORICALLY SIGNIFICANT: CURRENTLY:		㉔ dates of initial construction: major alterations: historic events:		㉕ ETHNIC GROUP ASSOCIATION	
㉖ architectural style(s):		㉗ architect:		㉘ master builder:	
㉙ architectural style(s):		㉚ interior decorator:		㉛ artist:	
㉜ landscape architect / garden designer:		㉝ interior decorator:		㉞ artisan:	
㉟ builder/contractor:		㊱ names give role & date		PERSONAL:	
EVENTS:		INSTITUTIONAL:		NATIONAL REGISTER WRITE-UP	