

3-7-74

NATIONAL REGISTER OF HISTORIC PLACES  
INVENTORY - NOMINATION FORM

(Type all entries - complete applicable sections)

STATE:	Texas
COUNTY:	Galveston
FOR NPS USE ONLY	
ENTRY DATE	JAN 2 1974

**1. NAME**

COMMON:  
Grand Opera House

AND/OR HISTORIC:

**2. LOCATION**

STREET AND NUMBER:  
2012-2020 Ave. E (Postoffice)

CITY OR TOWN:  
Galveston

CONGRESSIONAL DISTRICT:  
Jack Brooks-9

STATE: Texas      CODE:      COUNTY: Galveston      CODE: 423

**3. CLASSIFICATION**

CATEGORY (Check One)	OWNERSHIP	STATUS	ACCESSIBLE TO THE PUBLIC
<input type="checkbox"/> District <input checked="" type="checkbox"/> Building <input type="checkbox"/> Site <input type="checkbox"/> Structure <input type="checkbox"/> Object <input type="checkbox"/> Both	<input type="checkbox"/> Public <input checked="" type="checkbox"/> Private <input type="checkbox"/> Both	Public Acquisition: <input type="checkbox"/> In Process <input checked="" type="checkbox"/> Being Considered	<input checked="" type="checkbox"/> Occupied <input type="checkbox"/> Unoccupied <input type="checkbox"/> Preservation work in progress
PRESENT USE (Check One or More as Appropriate)			
<input type="checkbox"/> Agricultural <input type="checkbox"/> Commercial <input type="checkbox"/> Educational <input checked="" type="checkbox"/> Entertainment	<input type="checkbox"/> Government <input type="checkbox"/> Industrial <input type="checkbox"/> Military <input type="checkbox"/> Museum	<input type="checkbox"/> Park <input type="checkbox"/> Private Residence <input type="checkbox"/> Religious <input type="checkbox"/> Scientific	<input type="checkbox"/> Transportation <input type="checkbox"/> Other (Specify)

**4. OWNER OF PROPERTY**

OWNER'S NAME:  
Interstate Circuit

STREET AND NUMBER:

CITY OR TOWN:  
Galveston

STATE: Texas      CODE: 048

**5. LOCATION OF LEGAL DESCRIPTION**

COURTHOUSE, REGISTRY OF DEEDS, ETC.:  
Galveston County Courthouse

STREET AND NUMBER:

CITY OR TOWN:  
Galveston

STATE: Texas      CODE: 048

**6. REPRESENTATION IN EXISTING SURVEYS**

TITLE OF SURVEY:  
Historic American Buildings Survey

DATE OF SURVEY: 1966       Federal     State     County     Local

DEPOSITORY FOR SURVEY RECORDS:  
Library of Congress

STREET AND NUMBER:

CITY OR TOWN:  
Washington, D. C.

STATE: D. C.      CODE: 08

SEE INSTRUCTIONS

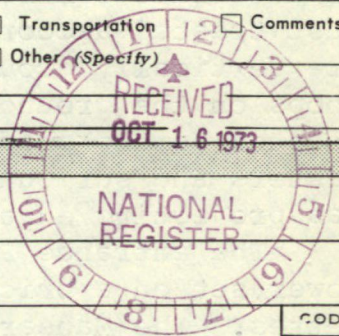

STATE: \_\_\_\_\_

COUNTY: \_\_\_\_\_

FOR NPS USE ONLY

ENTRY NUMBER: \_\_\_\_\_

DATE: JAN 2 1974

(continued)

7 DESCRIPTION

CONDITION	(Check One)					
	<input type="checkbox"/> Excellent	<input checked="" type="checkbox"/> Good	<input type="checkbox"/> Fair	<input type="checkbox"/> Deteriorated	<input type="checkbox"/> Ruins	<input type="checkbox"/> Unexposed
	(Check One)			(Check One)		
	<input checked="" type="checkbox"/> Altered	<input type="checkbox"/> Unaltered	<input type="checkbox"/> Moved	<input checked="" type="checkbox"/> Original Site		

DESCRIBE THE PRESENT AND ORIGINAL (if known) PHYSICAL APPEARANCE

The Grand Opera House and Hotel Grand were erected in 1894 in a regional version of the Romanesque Revival style. The Grand Opera House block, including the adjoining Grand Hotel building, was completed in late 1894 at a cost of \$67,548. The front of the building is encased with St. Louis pressed brick and trimmed in buff stone and contains ornaments of Terra Cotta. The architect was Frank Cox, of Cox Brothers, a New Orleans architectural firm. In addition to the structure itself, Cox also designed the interior decorations of the structure and the scenery for the theater. The Opera House was opened to the public on January 3rd, 1895. The double function structure is somewhat unique in that a narrow space separates the opera house from the hotel and the two are connected only at the main entrance located at the west end of the building.

The main facade or street elevation, reflects the four story Hotel Grand. The elevation of the building is divided into six bays with the end bays on the east and west treated as corner pavilions. The center four bays are vertically grouped in Richardsonian fashion with shops on the ground level and the upper three levels treated as the shaft of the column—are separated by pilasters and surmounted by double arches. A brick cornice has projecting engaged colonettes demarcating the bays.

The entrance Pavilion is accentuated by a Mansard tower set on a brick arcade with projecting corner colonettes. The Mansard roof has oiel d' beouf windows. The street entrance to the opera house is through a large semicircular arch which evidences Sullivanesque influence in its form and carving. This arch has been covered in recent years, but remains intact.

The double structure is located on a lot 128 feet wide and 120 feet deep. The hotel occupies the portion of the lot adjacent to Postoffice Street and is the width of the street front and forty-three feet deep. An air space five feet wide separates the hotel and the opera house on the rear of the lot. (See attached plan and section through building)

The ground floor originally contained hotel offices, cafe, and additional store space. The hotel has seventy-five rooms, most of them "ensuite", located on the

(see continuation sheet #1)

SEE INSTRUCTIONS

NATIONAL REGISTER OF HISTORIC PLACES  
INVENTORY - NOMINATION FORM

(Continuation Sheet) #1

STATE	
Texas	
COUNTY	
Galveston	
FOR NPS USE ONLY	
ENTRY NUMBER	DATE
	JAN 2 1974

(Number all entries)

upper three floors. The opera house auditorium, which seats nearly fifteen hundred, was one of the first to use modern theories of acoustics in its design. "The general plan tended to eliminate echoes and gave excellent acoustics by avoiding square corners. Another tradition broken was that the ground floor was not separated into a dress circle, family circle, and pit, but all seats were in a curve and stepped downward towards the stage. The entire floor was called the parquette. In this new theater the older form of a horse-shoe gallery was not used, but instead the gallery repeated the curve of the balcony." (C.M. McConnell, The Transition of Galveston's Grand Opera House, p.44,45)

The opera house contained the most advanced mechanical equipment available in its day. Both gas and electricity were used for lighting; the stage for reasons of fire safety was lit entirely by electricity. Two hot-air furnaces were contained in the basement, one heated the auditorium and the other heated the stage. A ventilator in the ceiling and an ample number of windows allowed the air to circulate through the building.



8. SIGNIFICANCE

PERIOD (Check One or More as Appropriate)

- Pre-Columbian |  16th Century |  18th Century |  20th Century  
 15th Century |  17th Century |  19th Century

SPECIFIC DATE(S) (If Applicable and Known) 1894

AREAS OF SIGNIFICANCE (Check One or More as Appropriate)

- |  |   |  |  |
|--|---|--|--|
| <input type="checkbox"/> Aboriginal              | <input type="checkbox"/> Education              | <input type="checkbox"/> Political           | <input type="checkbox"/> Urban Planning        |
| <input type="checkbox"/> Prehistoric             | <input type="checkbox"/> Engineering            | <input type="checkbox"/> Religion/Philosophy | <input type="checkbox"/> Other (Specify) _____ |
| <input type="checkbox"/> Historic                | <input type="checkbox"/> Industry               | <input type="checkbox"/> Science             | _____  |
| <input type="checkbox"/> Agriculture             | <input type="checkbox"/> Invention              | <input type="checkbox"/> Sculpture           | _____  |
| <input checked="" type="checkbox"/> Architecture | <input type="checkbox"/> Landscape Architecture | <input type="checkbox"/> Social/Humanitarian | _____  |
| <input type="checkbox"/> Art                     | <input type="checkbox"/> Literature             | <input checked="" type="checkbox"/> Theater  | _____  |
| <input type="checkbox"/> Commerce                | <input type="checkbox"/> Military               | <input type="checkbox"/> Transportation      | _____  |
| <input type="checkbox"/> Communications          | <input checked="" type="checkbox"/> Music       |  |  |
| <input type="checkbox"/> Conservation            |   |  |  |

STATEMENT OF SIGNIFICANCE

With its opening in January, 1895, the Grand Opera House in Galveston replaced a smaller theater, the Tremont Opera House, and provided the city with the best in opera and various dramatic performances at the height of theatrical popularity in the United States. The theater only served its original purpose a short time before the emergence of the motion picture. The story of this theater, however, did not end with the rise of film entertainment as did similar performance theaters. The Grand Opera House, now called the State, adapted to the changes of the time, and remains a record of the transition from a stage theater to a movie theater.

As Texas' leading city in the mid-~~eighteenth~~<sup>NINETEENTH</sup> century, Galveston wanted to begin to provide its citizens with cultural entertainment. Neitsch's Theater, a three story structure built in 1854, was Galveston's first theater. The people failed to support this initial attempt to provide dramatic performances, however, and the building was converted into a livery stable. Mrs. Harry Hunter, an actress interested in revitalizing the building to its original purpose, restored and reopened the third floor of Neitsch's in 1866. A few weeks after the completion of its restoration, Mrs. Hunter rented the theater to an opera troupe, who brought the first opera performance to Texas. Not until the Greenwall brothers took over management of Neitsch's in 1867, however, did it finally begin to attract audiences. The theater continued successfully until the building burned in 1869.

A second theater, the Tremont Opera House, modeled after Booth's Theater in New York, opened its doors to the public in February 1871. Henry Greenwall, one of the

(see continuation sheet #2)

SEE INSTRUCTIONS

9. MAJOR BIBLIOGRAPHICAL REFERENCES

Gallegly, Joseph S., Early Days of Grand Opera in Houston and Galveston. An offprint from Rice University Studies, Vol. 57, No. 1, Winter 1971.

McConnell, C. M., The Transitions of Galveston's Grand Opera House. Unpublished Masters Thesis, Sul Ross State College, Alpine, Texas, 1956.

10. GEOGRAPHICAL DATA

LATITUDE AND LONGITUDE COORDINATES DEFINING A RECTANGLE LOCATING THE PROPERTY			O R	LATITUDE AND LONGITUDE COORDINATES DEFINING THE CENTER POINT OF A PROPERTY OF LESS THAN TEN ACRES		
CORNER	LATITUDE			LATITUDE		LONGITUDE
	Degrees	Minutes	Seconds	Degrees	Minutes	Seconds
NW	0	'	"	29	18'	19"
NE	0	'	"	97	47'	25"
SE	0	'	"			
SW	0	'	"			

APPROXIMATE ACREAGE OF NOMINATED PROPERTY: 1 acre

LIST ALL STATES AND COUNTIES FOR PROPERTIES OVERLAPPING STATE OR COUNTY BOUNDARIES

STATE:	CODE	COUNTY	CODE

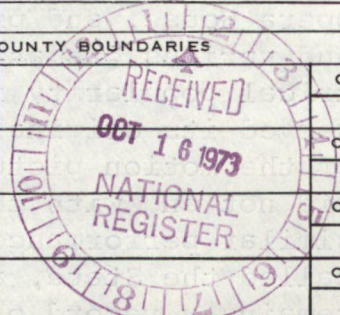

UTM  
15/326085  
3241980  
14L

SEE INSTRUCTIONS

11. FORM PREPARED BY

NAME AND TITLE: **Gary L. Hume, Project Director**  
**Marie Deacon, Historian**

ORGANIZATION: **Texas Historical Commission** DATE: **Oct. 10, 1973**

STREET AND NUMBER: **P. O. Box 12276, Capitol Station**

CITY OR TOWN: **Austin** STATE: **Texas** CODE: **048**

12. STATE LIAISON OFFICER CERTIFICATION

As the designated State Liaison Officer for the National Historic Preservation Act of 1966 (Public Law 89-665), I hereby nominate this property for inclusion in the National Register and certify that it has been evaluated according to the criteria and procedures set forth by the National Park Service. The recommended level of significance of this nomination is:

National  State  Local

Name: Truett Latimer  
Title: State Historic Preservation Officer  
Date: October 10, 1973

NATIONAL REGISTER VERIFICATION

I hereby certify that this property is included in the National Register.

Ernest A. Annally  
~~Director, Office of Archeology and Historic Preservation~~  
Associate Director, Professional Services  
Date: JAN 2 1974

ATTEST:  
Gene Smith  
Keeper of The National Register  
Date: 12-27-73

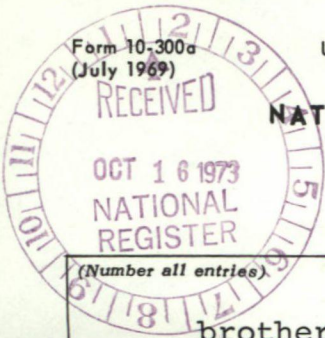

UNITED STATES DEPARTMENT OF THE INTERIOR  
NATIONAL PARK SERVICE

**NATIONAL REGISTER OF HISTORIC PLACES  
INVENTORY - NOMINATION FORM**

(Continuation Sheet) #2

STATE Texas	
COUNTY Galveston	
FOR NPS USE ONLY	
ENTRY NUMBER	DATE
	JAN 2 1974

(Number all entries)

brothers who had reopened Neitsch's, became the lessee of the Tremont. For twenty-three years the Tremont staged opera, plays, vaudeville and musical comedies as dramatic performances continued to gain popularity within Texas.

By the 1890's the Tremont had become overcrowded and needed extensive renovation. Henry Greenwall, widely known throughout the country as one of the leading theatrical magnates, began to call for a larger and more adequate structure. Greenwall had now extended his fame and influence throughout the United States. He established the Greenwall Theatrical Circuit, which had theaters located in many states. He controlled opera houses in New Orleans, Galveston, Waco, San Antonio, Nashville, Louisville, Memphis, Atlanta, Ft. Worth, Dallas, Houston, Austin, and Little Rock. He was also the manager of the Texas Circuit including Galveston, Ft. Worth, Dallas, Houston, San Antonio, Austin and Waco. Thus, when Greenwall threatened to cancel the Galveston circuit, unless safer and more deserving facilities were provided, the citizens of Galveston responded quickly. Being one of Texas' major cities, Galveston businessmen were eager to encourage people to seek amusement in their city instead of going to New Orleans. Greenwall concentrated his efforts in securing funds for a new theater by selling stock. Leading businessmen and financiers of Galveston--Leon Blum, C. H. Moore, R. B. Hawley, John Sealy, George Sealy, Charles Fowler, David Fahey--invested in the Grand Opera House Company and enthusiastically gave their support to the new theater.

Frank Cox, the architect for the Grand Opera House, designed the structure and the interior decorations and scenery. Barnes and Palliser of Galveston began construction of the building in 1894. The completed structure was four stories on the front side where a hotel was located. The ground floor had a hotel office, cafe and space for other stores. The theater was located behind the front section with an entrance from the street at the west end of the building. The auditorium had all the latest improvements and equipment and was one of the first theaters to use modern theories of acoustics. The basic structure remains intact today. The original

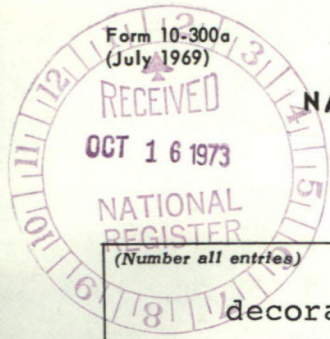

**NATIONAL REGISTER OF HISTORIC PLACES  
INVENTORY - NOMINATION FORM**

(Continuation Sheet) #3

STATE Texas	
COUNTY Galveston	
FOR NPS USE ONLY	
ENTRY NUMBER	DATE
	JAN 2 1974

(Number all entries)

decorations are painted over and the boxes have been removed, but the building as a whole remains the same as it was originally. The rebuilding after the 1900 storm did not alter it except for minor changes in the decorations.

From its opening in January 1895, the popular Grand Opera House staged melodrama, musical comedy, operettas, operas, plays, and concert artists with continued success for twenty-four years. However, a new form of entertainment, the motion picture, began exceeding the popularity of theatrical performances in the early part of the Twentieth century. The Grand Opera House actually showed its first film, a bull fight, in 1896 in addition to the production of Carmen. In 1897 stock companies at the Grand used the early forms of motion pictures as entertainment between acts.

By 1908 the moving pictures were causing a revolution in entertainment and several movie houses had sprung up in Galveston. At the Grand Opera House, however, films continued to be shown only in addition to the featured theatrical performances. This began to change in 1915 when the motion picture was improved. In Galveston the new form of motion picture arrived in October 1915, when the Grand Opera House exhibited D. W. Griffith's, The Birth of a Nation accompanied by a symphony orchestra playing the special score written for the picture.

Despite the fact that the Grand Opera House began to book an increasing number of films and fewer theatrical performances, the theater retained its original name until 1924 when its new owner Mr. A. Martini gave his name to it. At this time the building was remodeled, an organ was added to provide music for the silent films, and two modern picture machines were installed. The theater still booked vaudeville as well as feature pictures. Martini claimed that he had the only theater in the South equipped to handle "feature pictures, majestic vaudeville and traveling road shows." In 1937 Martini built a new theater and he gave the former Grand Opera House its present name, the State.

(see continuation sheet #4)

**NATIONAL REGISTER OF HISTORIC PLACES  
INVENTORY - NOMINATION FORM**

(Continuation Sheet) #4

STATE	
Texas	
COUNTY	
Galveston	
FOR NPS USE ONLY	
ENTRY NUMBER	DATE
JAN 2	1974

(Number all entries)

The Grand Opera House was the only theater in Galveston that offered legitimate drama around the turn of the century. As the motion picture became popular several movie houses began to open. Instead of trying to compete with the films and failing as did many theaters throughout the United States, the Grand Opera House joined the movement. Thus, it represents the evolution of an old building that has maintained its original integrity as a theater by adapting to the changing times.



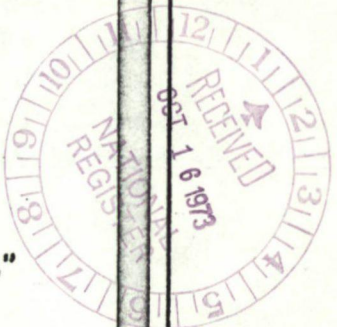
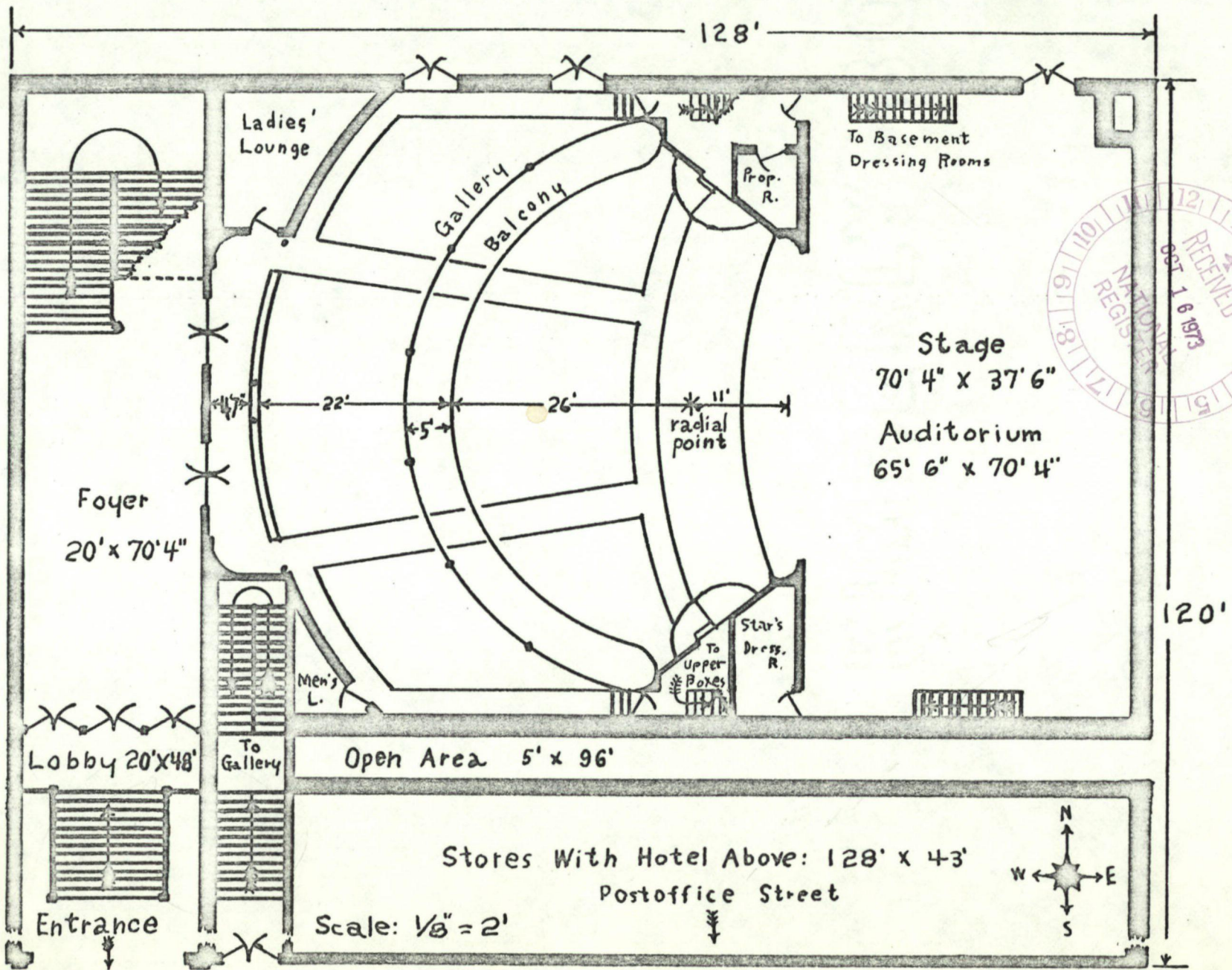

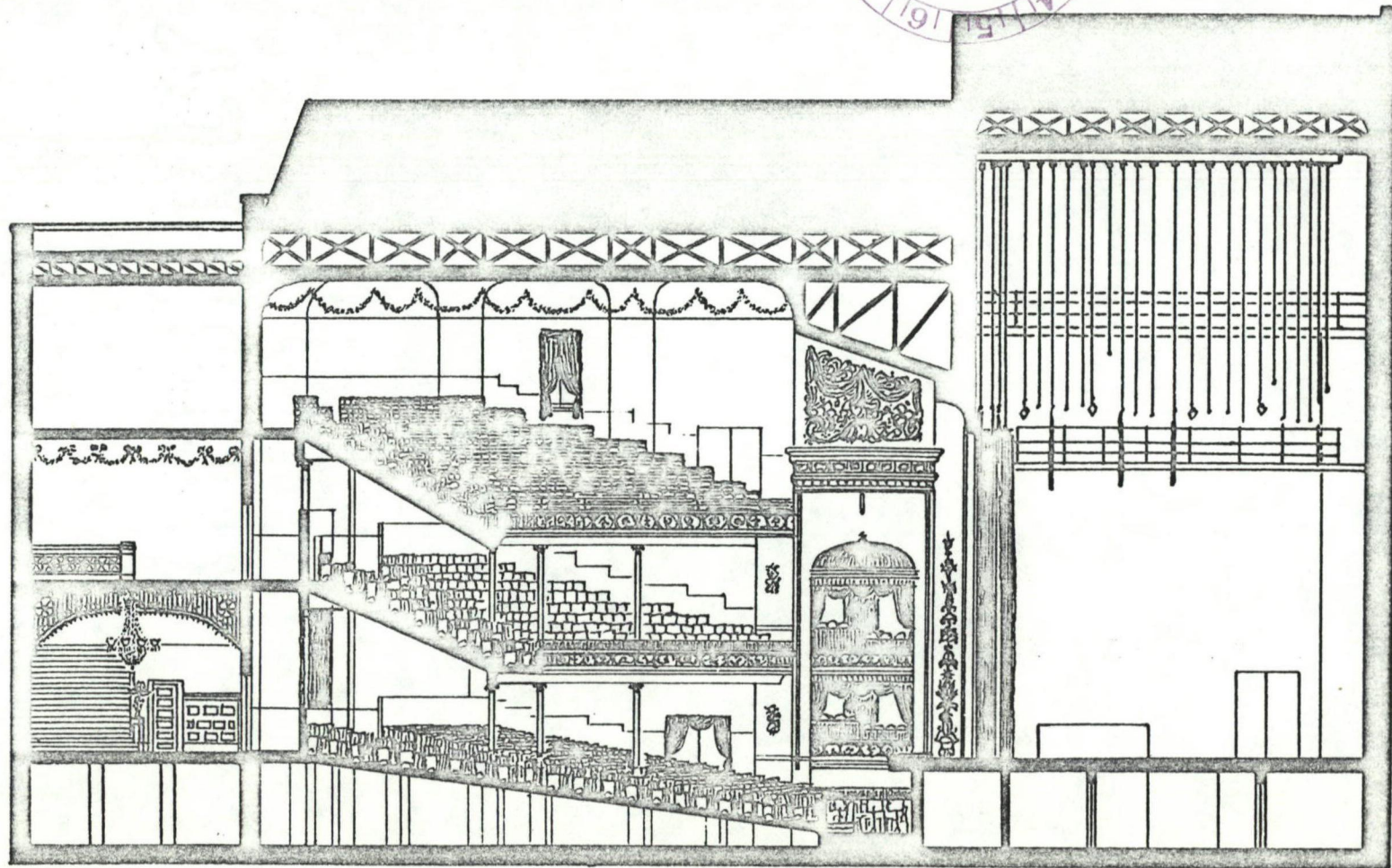
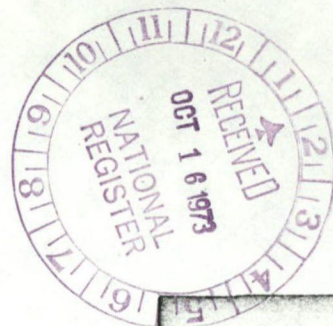

Scale  $\frac{1}{8}'' = 2'$

C.M.W. July 1958

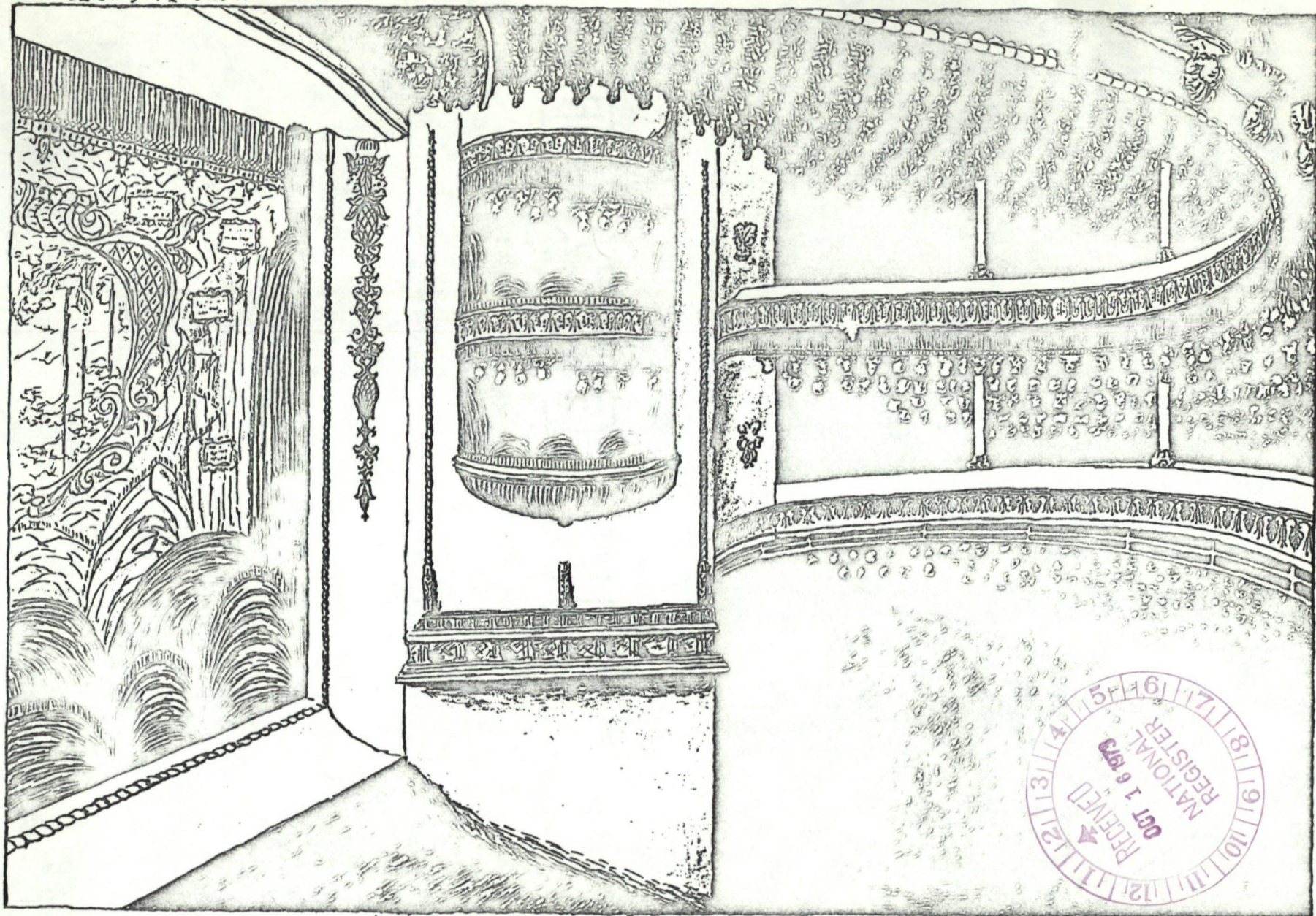

NAME OF PROPERTY Carroll County Courthouse

The attached National Register Inventory-Nomination form is being returned to your office for clarification of the information indicated below.

1. Name. \_\_\_\_\_

2. Location. \_\_\_\_\_

3. Classification. \_\_\_\_\_

✓ 4. Owner of Property. Does the County still own it?

5. Location of Legal Description. (YES) SEE ITEM #4

6. Representation in Existing Surveys. \_\_\_\_\_

7. Description. \_\_\_\_\_

✓ 8. Statement of Significance. Not sufficient for review team to make a judgment nor for editorial staff to prepare an extract for publications. Please provide more details. With a bibliography like this, there must be more information.

9. Bibliography. \_\_\_\_\_

10. Geographical Data.  
a. Longitude and Latitude Coordinates: \_\_\_\_\_

b. Acreage. \_\_\_\_\_

11. Form Prepared By. \_\_\_\_\_

12. Certification. \_\_\_\_\_

Photographic Coverage. \_\_\_\_\_

Map Coverage. \_\_\_\_\_

✓ Other. We will expedite review upon resubmission

Clarification or correction of the above items must be made prior to the initiation of our professional review. Correction of these technical errors does not necessarily insure that the nomination will then satisfy National Register criteria in full.

Thank you for your attention to the above items checked.

SIGNED: [Signature]

RECEIVED

NOV 1 1972

DIRECTOR'S OFFICE  
DEPARTMENT OF CONSERVATION

RECEIVED  
NOV 1 1972  
CONSERVATION  
DIVISION OF LONG RANGE PLANNING

PROPERTY Grand Opera House STATE Tex.

WORKING NUMBER 10.16.73.3784

*Galveston, County*

TECH REVIEW  
PHOTOS 2  
MAPS 1

Ref. # 74002071

CONTROL REVIEW #10 message

*cm  
10.17.  
73*

HISTORIAN

*OK  
Accept  
Amel  
10/17/73*

ARCHITECTURAL HISTORIAN

ARCHEOLOGIST

REVIEW UNIT CHIEF Interesting property.

*ACCEPT  
KHC  
12/6/73*

BRANCH CHIEF

*accept  
Cals  
12/17/73*

KEEPER

*Wm  
12/27/73*

National Register Write-up 3-7-74

Send-back \_\_\_\_\_

Federal Register entry 3-5-74

Re-submit \_\_\_\_\_

Entered JAN 2 1974



HOTEL  
GRAND  
PLAN.

EUROPEAN  
PLAN.

ALBERT HOTEL

UNITED STATES DEPARTMENT OF THE INTERIOR  
NATIONAL PARK SERVICE

NATIONAL REGISTER OF HISTORIC PLACES  
PROPERTY PHOTOGRAPH FORM

(Type all entries - attach to or enclose with photograph)

1. NAME		
COMMON	AND/OR HISTORIC	NUMERIC CODE (Assigned by NPS)
Grand Opera House		JAN 2 1974
2. LOCATION		
STATE	COUNTY	TOWN
Texas	Galveston	Galveston
STREET AND NUMBER		
2012-2020 Ave. E. (Postoffice)		
3. PHOTO REFERENCE		
PHOTO CREDIT	DATE	NEGATIVE FILED AT
Galveston Historical Foundation	ca.1900	Texas Historical Commission
4. IDENTIFICATION		

DESCRIBE VIEW, DIRECTION, ETC.

Southeast oblique of Grand Opera House.



GPO 932-009

PROPERTY OF THE NATIONAL REGISTER



STATE THEATRE

WILLIAM HOLDEN ROBERT RYAN  
ERNEST BORGNINE  
THE WILD BUNCH  
TECHNICOLOR

Ga 509

FORM 10-301 A  
(6/72)

UNITED STATES DEPARTMENT OF THE INTERIOR  
NATIONAL PARK SERVICE

NATIONAL REGISTER OF HISTORIC PLACES  
PROPERTY PHOTOGRAPH FORM

(Type all entries - attach to or enclose with photograph)

1. NAME		
COMMON	AND/OR HISTORIC	NUMERIC CODE (Assigned by NPS)
Grand Opera House		JAN 2 1974
2. LOCATION		
STATE	COUNTY	TOWN
Texas	Galveston	Galveston
STREET AND NUMBER		
2012-2020 Ave. E. (Postoffice)		
3. PHOTO REFERENCE		
PHOTO CREDIT	DATE	NEGATIVE FILED AT
Texas Historical Commission	ca.1971	Texas Historical Commission
4. IDENTIFICATION		
DESCRIBE VIEW, DIRECTION, ETC.		

Southeast oblique of Grand Opera House.

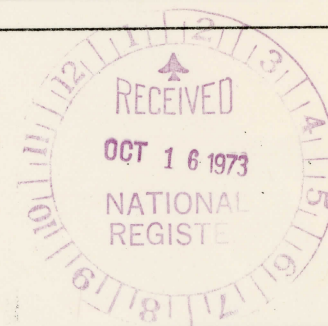

GPO 932-009

PROPERTY OF THE NATIONAL REGISTER

**NATIONAL REGISTER OF HISTORIC PLACES  
PROPERTY MAP FORM**

*(Type all entries - attach to or enclose with map)*

STATE	Texas	
COUNTY	Galveston	
FOR NPS USE ONLY		
ENTRY NUMBER	DATE	
	JAN 2	1974

SEE INSTRUCTIONS

**1. NAME**

COMMON: Grand Opera House  
AND/OR HISTORIC:

**2. LOCATION**

STREET AND NUMBER:  
2012-2020 Ave. E (Postoffice)

CITY OR TOWN:  
Galveston

STATE:	CODE	COUNTY:	CODE
Texas	048	Galveston	423

**3. MAP REFERENCE**

SOURCE:  
USGS 7.5' Series, Galveston, Texas Quadrangle

SCALE: 1:24000

DATE: 1954

**4. REQUIREMENTS**

- TO BE INCLUDED ON ALL MAPS
- Property boundaries where required.
  - North arrow.
  - Latitude and longitude reference.

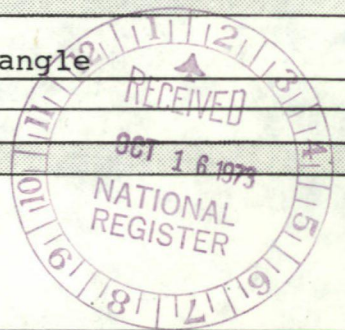

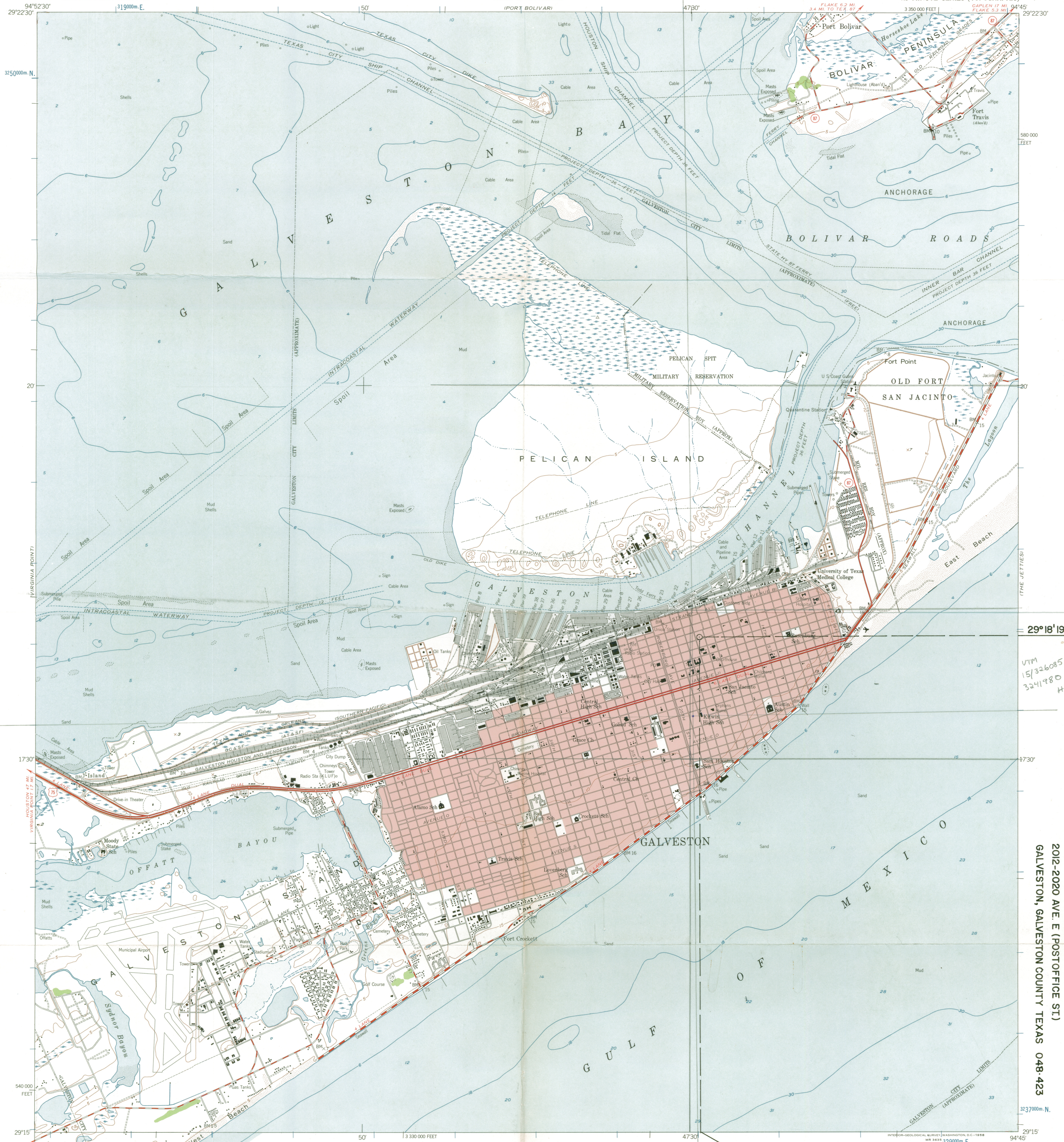

94°52'30"  
29°22'30"  
3250000m. N.  
20  
1730  
540000 FEET  
29°15'  
94°52'30"

4780'  
3350000 FEET  
580000 FEET  
29°18'19"  
1730  
3237000m. N.  
94°45'

Mapped by the Army Map Service  
Published for civil use by the Geological Survey  
Control by USC&GS, USCE and TVA  
Topography from aerial photographs by multiplex methods  
and by planetable surveys 1943. Revised by photogrammetric  
methods from aerial photographs taken 1952. Field check 1954  
Hydrography compiled from USC&GS charts 520,886  
and 1282 (1953)  
Polyconic projection. 1927 North American datum  
10,000-foot grid based on Texas coordinate system,  
south central zone  
1000 meter Universal Transverse Mercator grid ticks,  
zone 15, shown in blue  
Red tint indicates area in which only  
landmark buildings are shown

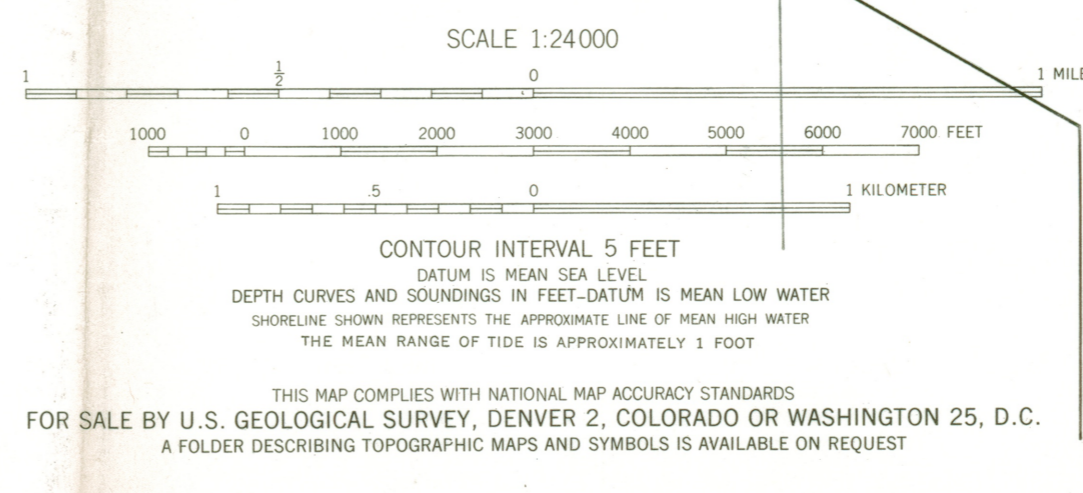

ROAD CLASSIFICATION

Heavy-duty	Light-duty
Medium-duty	Unimproved dirt

U.S. Route      State Route

RECEIVED  
NOV 16 1973  
NATIONAL REGISTER

GALVESTON, TEX.  
N2915-W9445/7.5

2994-231

NOV 18 1968

GRAND OPERA HOUSE  
2012-2020 AVE. E. (POSTOFFICE ST.)  
GALVESTON, GALVESTON COUNTY TEXAS 048-423

VTM  
15/326085  
3241880  
HL

ENTRIES IN THE NATIONAL REGISTER

STATE **TEXAS**

Date Entered **JAN 2 1974**

<u>Name</u>	<u>Location</u>
<b>Grand Opera House</b>	<b>Galveston Galveston County</b>

Also Notified

Hon. John G. Tower  
Hon. Lloyd M. Bentsen  
Hon. Jack Brooks  
Director, Southwest Region

State Historic Preservation Officer  
Mr. Truett Latimer, Executive Director  
Texas State Historical Survey Committee  
Post Office Box 12276  
Capitol Station  
Austin, Texas 78711

PR MMott/row 1/9/74