

Form 10-300  
(July 1969)

UNITED STATES DEPARTMENT OF THE INTERIOR  
NATIONAL PARK SERVICE

**NATIONAL REGISTER OF HISTORIC PLACES  
INVENTORY - NOMINATION FORM**

(Type all entries - complete applicable sections)

STATE: <b>TEXAS</b>	
COUNTY: <b>Bexar</b>	
FOR NPS USE ONLY	
ENTRY NUMBER	DATE
	<b>FEB 23 1972</b>

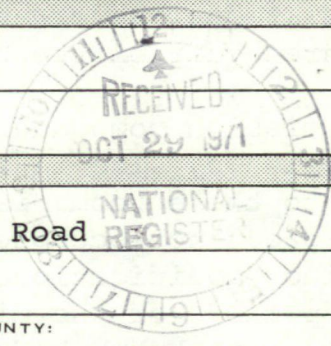

**1. NAME**

COMMON:  
**Mission San Juan Capistrano**

AND/OR HISTORIC:

**2. LOCATION**

STREET AND NUMBER:  
**.8 mile north of Loop 410 on Mission Road**

CITY OR TOWN:  
**San Antonio**

STATE <b>Texas</b>	CODE <b>048</b>	COUNTY: <b>Bexar</b>	CODE <b>029</b>
-----------------------	--------------------	-------------------------	--------------------

**3. CLASSIFICATION**

CATEGORY (Check One)	OWNERSHIP	STATUS	ACCESSIBLE TO THE PUBLIC
<input type="checkbox"/> District <input type="checkbox"/> Building <input checked="" type="checkbox"/> Site <input type="checkbox"/> Structure <input type="checkbox"/> Object	<input type="checkbox"/> Public <input checked="" type="checkbox"/> Private <input type="checkbox"/> Both	Public Acquisition: <input type="checkbox"/> In Process <input type="checkbox"/> Being Considered	<input checked="" type="checkbox"/> Occupied <input type="checkbox"/> Unoccupied <input checked="" type="checkbox"/> Preservation work in progress
PRESENT USE (Check One or More as Appropriate)			
<input type="checkbox"/> Agricultural <input type="checkbox"/> Commercial <input type="checkbox"/> Educational <input type="checkbox"/> Entertainment	<input type="checkbox"/> Government <input type="checkbox"/> Industrial <input type="checkbox"/> Military <input checked="" type="checkbox"/> Museum	<input type="checkbox"/> Park <input checked="" type="checkbox"/> Private Residence <input checked="" type="checkbox"/> Religious <input type="checkbox"/> Scientific	<input type="checkbox"/> Transportation <input type="checkbox"/> Other (Specify) _____ _____ <input type="checkbox"/> Comments _____ _____

**4. OWNER OF PROPERTY**

OWNER'S NAME:  
**Catholic Archdiocese of San Antonio**

STREET AND NUMBER:  
**Chancery Office, P.O. Box 13190**

CITY OR TOWN: **San Antonio**      STATE: **Texas**      CODE: **048**

**5. LOCATION OF LEGAL DESCRIPTION**

COURTHOUSE, REGISTRY OF DEEDS, ETC.:  
**Chancery Office, Archdiocese of Bexar County Courthouse and San Antonio**

STREET AND NUMBER:  
**P.O. Box 13190**

CITY OR TOWN: **San Antonio**      STATE: **Texas**      CODE: **048**

**6. REPRESENTATION IN EXISTING SURVEYS**

TITLE OF SURVEY:  
**Historic American Buildings Survey TEX-321**

DATE OF SURVEY: **1934**       Federal     State     County     Local

DEPOSITORY FOR SURVEY RECORDS:  
**Library of Congress**

STREET AND NUMBER:  
**Washington**

CITY OR TOWN: **Washington**      STATE: **DC**      CODE: **008**

SEE INSTRUCTIONS

STATE:  
COUNTY:  
FOR NPS USE ONLY  
ENTRY NUMBER  
DATE

**FEB 23 1972**

7. DESCRIPTION

CONDITION	(Check One)					
	<input checked="" type="checkbox"/> Excellent	<input type="checkbox"/> Good	<input type="checkbox"/> Fair	<input type="checkbox"/> Deteriorated	<input checked="" type="checkbox"/> Ruins	<input checked="" type="checkbox"/> Unexposed
	(Check One)			(Check One)		
	<input checked="" type="checkbox"/> Altered	<input type="checkbox"/> Unaltered	<input type="checkbox"/> Moved	<input checked="" type="checkbox"/> Original Site		

DESCRIBE THE PRESENT AND ORIGINAL (if known) PHYSICAL APPEARANCE

The Mission San Juan Capistrano, one of the five San Antonio missions, underwent several building periods during its ninety-three-year existence as a Spanish outpost in the New World.

The mission compound follows a traditional plan of rooms arranged side by side in a rough quadrangle around a plaza. Entrance to these rooms is gained through walls facing the plaza. Spaces not occupied by structures are walled (see site map). Minor modifications on this plan were made in the several building periods of the mission's life.

By 1756 a church had been completed, with a cloistered convent and a granary. The Indian quarters were composed of jacales, homes made up of upright posts plastered with adobe for walls and thatched roofs. Evidence of these jacales (rows of post holes evenly and closely spaced along the south wall) were revealed during excavations at the site in 1971 (Mardith K. Schuetz, personal communication).

In 1762 Fray Mariano Francisco de los Dolores inspected the mission. He states that a second church was under construction and the convent expanded. Indians were still living in the temporary quarters (Schuetz; 1968: 40-42).

The apex of mission development is considered to be that period between 1756 and 1777 when the economic stability of the mission allowed it to supply goods to other missions.

In 1794 Mission San Juan Capistrano was partially secularized. Twelve Indian families received ownership of mission land and properties, but by 1823 (the complete secularization of the mission) when San Juan property was sold at auction nearly all the Indian population had disappeared and only four or five Indians were left at the mission (Schuetz, 1968: 58).

What remains now are the ruins of the second church (c. 1756-1763/64) and the third church (post 1762), originally the granary, that chapel which is now in use. During excavations conducted in January-March 1971 foundations of what is believed to be the first church (1731) were uncovered. (Mardith K. Schuetz, personal communication).

Additional remains of the mission complex are the walls surrounding it, foundations of some of the Indian quarters, the convent, granary foundations, the well and an old residence (c. 1824) built within the mission walls after its secularization (see site plan).

Restoration done by the Works Progress Administration in the 1930s was located for the most part on the south and east walls. Excavations conducted by them at this time also uncovered part of the complex located within the plaza. Additional res-

(see continuation sheet #1)

S E E I N S T R U C T I O N S

NATIONAL REGISTER OF HISTORIC PLACES  
INVENTORY - NOMINATION FORM

(Continuation Sheet) #1

STATE	TEXAS	
COUNTY	Bexar	
FOR NPS USE ONLY		
ENTRY NUMBER		DATE
		FEB 23 1972

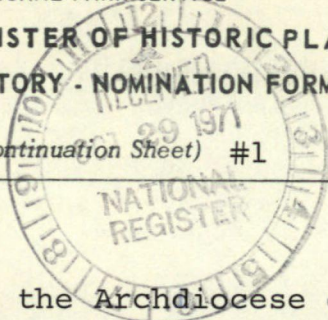

(Number all entries)

7. (contd.)

toration sponsored by the Archdiocese of San Antonio in 1967 followed archeological work conducted by the Texas State Historical Survey Committee (Schuetz, 1968). Continuing restoration of the major buildings is being directed by the architectural firm of Ford, Powell and Carson of San Antonio for the archdiocese.

Beginning on the west wall with the chapel and moving clockwise, those standing buildings and ruins are:

Post 1763 chapel (present church; originally a granary)

The most prominent building at the site is the recently restored chapel. The rectangular building is of rubble construction with buttresses along the east and west walls. The east wall buttresses occur at regular intervals along a decorative arcade of segmental arches. A two-tiered espadaña, located at the north end of the east facade, has three bells arranged with one in the center of the top tier, two in the bottom tier. Finials on either side of both tiers, as well as one on the top of the highest section, complete the decoration of the wall belfry.

The flat roof, which is surrounded by a parapet, slopes on the west. Canales project from this west wall. The exterior of the building is stuccoed.

Entrance to the chapel is gained along the east wall through double doors at the north end under the belfry. There is also another door in the center of the building and a third at the south end.

Indian quarters

Two restored Indian quarters stand to the immediate north of the chapel. The building now serves as residences for the caretakers. The small cottages are rectangular buildings of stuccoed covered rubble construction. The side walls (south and north) extend to create a parapet for the thatched hip roof. An entrance is located at the north end of the east facade. Two windows are adjacent to the door on the south. The houses have chimneys on the north walls.

1824 house

A third residence--a small, one room, square house with a hip roof--stands against the east wall. Construction is of limestone blocks. This house was built on the mission grounds after the completed secularization of the mission (1824).

1756-1763/64 church ruins

Located along the east wall of the complex are the ruins of the large stone church built c. 1756-1763/64, which was the second church constructed at the site. The octagonal baptistry

(see continuation sheet #2)

NATIONAL REGISTER OF HISTORIC PLACES  
INVENTORY - NOMINATION FORM

(Continuation Sheet) #2

STATE	
TEXAS	
COUNTY	
Bexar	
FOR NPS USE ONLY	
ENTRY NUMBER	DATE
	FEB 23 1972

(Number all entries)

7. (contd. 2)

on the southeast corner and the south wall were reconstructed by the Works Progress Administration in the 1930s.

Convento

The convento, located along the west wall adjacent to the chapel is of rubble construction. The rectangular building has two entrances on the east. The flat roof is surrounded by a parapet and slopes toward the west. Canales project from the west wall. The building has been restored and now serves as a museum.

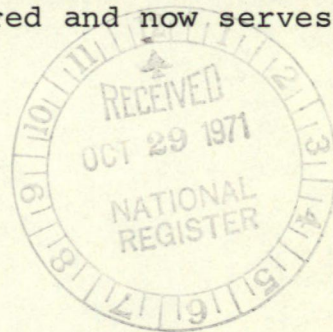

**8. SIGNIFICANCE**

PERIOD (Check One or More as Appropriate)

- |  |                                       |  |                                       |
|--|---------------------------------------|--|---------------------------------------|
| <input type="checkbox"/> Pre-Columbian | <input type="checkbox"/> 16th Century | <input checked="" type="checkbox"/> 18th Century | <input type="checkbox"/> 20th Century |
| <input type="checkbox"/> 15th Century  | <input type="checkbox"/> 17th Century | <input checked="" type="checkbox"/> 19th Century |                                       |

SPECIFIC DATE(S) (If Applicable and Known) **1731**

AREAS OF SIGNIFICANCE (Check One or More as Appropriate)

- |  |                                       |   |  |
|--|---------------------------------------|---|--|
| <input type="checkbox"/> Aboriginal              | <input type="checkbox"/> Education    | <input type="checkbox"/> Political                      | <input type="checkbox"/> Urban Planning  |
| <input type="checkbox"/> Prehistoric             | <input type="checkbox"/> Engineering  | <input checked="" type="checkbox"/> Religion/Philosophy | <input type="checkbox"/> Other (Specify) |
| <input checked="" type="checkbox"/> Historic     | <input type="checkbox"/> Industry     | <input type="checkbox"/> Science                        |  |
| <input type="checkbox"/> Agriculture             | <input type="checkbox"/> Invention    | <input type="checkbox"/> Sculpture                      |  |
| <input checked="" type="checkbox"/> Architecture | <input type="checkbox"/> Landscape    | <input type="checkbox"/> Social/Humanitarian            |  |
| <input type="checkbox"/> Art                     | <input type="checkbox"/> Architecture | <input type="checkbox"/> Theater                        |  |
| <input type="checkbox"/> Commerce                | <input type="checkbox"/> Literature   | <input type="checkbox"/> Transportation                 |  |
| <input type="checkbox"/> Communications          | <input type="checkbox"/> Military     |   |  |
| <input type="checkbox"/> Conservation            | <input type="checkbox"/> Music        |   |  |

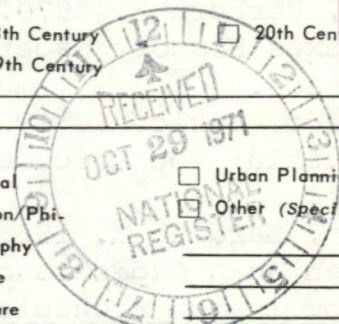

STATEMENT OF SIGNIFICANCE

Spanish interest in the occupation of Texas was based on the presence of the French in Louisiana and the native inhabitants of the area. The basis of the mission/presidio system was the extension of controls to hold the area through Christianizing the natives and settlement of the area.

"The center and defense of the western settlements was the presidio of San Antonio de Bexar, founded in 1718. By its side stood the mission of San Antonio de Valero... Within a stretch of twelve miles down the river there were four other missions, named Concepción, San José, San Juan Capistrano, and San Francisco della Espada, and located in the order here given" (Bolton, 1970: 5).

After a succession of moves beginning in East Texas, San Juan was finally established in 1731 along the banks of the San Antonio River. The sporadic life in East Texas, move to Central Texas, and final permanency in San Antonio came as a result of the inability of the Spanish to send supplies, equipment and personnel to the outposts.

Missionary activity at San Juan lasted from 1731 (the establishment of the mission) through its complete secularization in 1824. Its longevity is evidenced by the fact that today, 240 years after its establishment, it is still a functioning parish.

Mission San Juan Capistrano stands, with its companion missions, as an historical and political symbol of the Spanish colonial empire in Texas and its principal vehicle, the mission system. Additionally, it is an architectural reminder of and memorial to the "accomplishments of Spain's Franciscan missionaries" built because of the success of the padres in their cultural and religious conversion of the Indian population.

SEE INSTRUCTIONS

9. MAJOR BIBLIOGRAPHICAL REFERENCES

Bolton, Herbert E. 1970. Texas in the Middle Eighteenth Century. Texas History Paperbacks TH-8. Austin: University of Texas Press.

Castaneda, Carlos E. 1936. Our Catholic Heritage in Texas. III. Austin: Von Boeckman-Jones.

Schuetz, Mardith K. 1968. The History and Archeology of Mission San Juan Capistrano, San Antonio, Texas. 2 vols. State Building Commission Archeological Program. Reports #11 and 12.

10. GEOGRAPHICAL DATA

LATITUDE AND LONGITUDE COORDINATES DEFINING A RECTANGLE LOCATING THE PROPERTY			O R	LATITUDE AND LONGITUDE COORDINATES DEFINING THE CENTER POINT OF A PROPERTY OF LESS THAN TEN ACRES		
CORNER	LATITUDE	LONGITUDE		LATITUDE	LONGITUDE	
	Degrees Minutes Seconds	Degrees Minutes Seconds		Degrees Minutes Seconds	Degrees Minutes Seconds	
NW	29 ° 20 ' 00 "	98 ° 27 ' 21 "		° ' "	° ' "	
NE	29 ° 20 ' 00 "	98 ° 27 ' 10 "				
SE	29 ° 19 ' 51 "	98 ° 27 ' 10 "				
SW	29 ° 19 ' 51 "	98 ° 27 ' 21 "				

APPROXIMATE ACREAGE OF NOMINATED PROPERTY: **15 acres**

LIST ALL STATES AND COUNTIES FOR PROPERTIES OVERLAPPING STATE OR COUNTY BOUNDARIES

STATE:	CODE	COUNTY	CODE

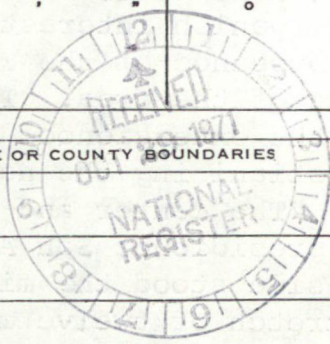

11. FORM PREPARED BY

NAME AND TITLE: **Wayne Bell, Project Director**  
**Marsha Jackson, Research Associate**

ORGANIZATION: **Texas State Historical Survey Committee** DATE: **10-20-71**

STREET AND NUMBER: **108 W. 15th Street**

CITY OR TOWN: **Austin** STATE: **Texas** CODE: **048**

12. STATE LIAISON OFFICER CERTIFICATION

NATIONAL REGISTER VERIFICATION

As the designated State Liaison Officer for the National Historic Preservation Act of 1966 (Public Law 89-665), I hereby nominate this property for inclusion in the National Register and certify that it has been evaluated according to the criteria and procedures set forth by the National Park Service. The recommended level of significance of this nomination is:

National  State  Local

Name *Walter Johnson*

Title **State Liaison Officer**

Date 10-26-71

I hereby certify that this property is included in the National Register.

*Ernest A. Connelly*  
Chief, Office of Archeology and Historic Preservation

**FEB 23 1972**

Date \_\_\_\_\_

ATTEST:

*William J. Stuebel*  
Keeper of The National Register

Date \_\_\_\_\_

SEE INSTRUCTIONS  
 NW 552830 / HA  
 SW 552830 / 3244860  
 SE 553120 / 3244580  
 NE 553120 / 3244580  
 147

Mission San Juan

Bexar

RECEIPT PROPERTY Capistrano STATE TEX.

DATE OF RECEIPT 10/29/71 YES \_\_\_\_\_ NO \_\_\_\_\_ NUMBER \_\_\_\_\_

DATA PAGE \_\_\_\_\_

PHOTO (S) \_\_\_\_\_

PHOTO DESCRIPTION (S) \_\_\_\_\_

MAP (S) \_\_\_\_\_

MAP DESCRIPTION (S) \_\_\_\_\_

LOGGED \_\_\_\_\_

ACKNOWLEDGE 11/1/71 \_\_\_\_\_

RESUBMIT \_\_\_\_\_

REGISTER NUMBER:  
FEB 23 1972

*4-24-72*  
*G. H. H. H. H.*

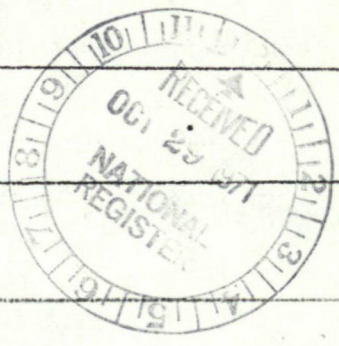

REVIEWER \_\_\_\_\_

HISTORIAN \_\_\_\_\_ *Obey. Sails 1/13/72.*

ARCHAEOLOGIST \_\_\_\_\_

ARCHITECT \_\_\_\_\_ *OK Chambers 1-18-72*

ASST. KEEPER \_\_\_\_\_

KEEPER \_\_\_\_\_ *OK Wm 1/27/72*

WRITER/EDITOR \_\_\_\_\_ *OK 5 Maurice 1/14/72*

CHIEF, OAHF \_\_\_\_\_ *OK 2-23*

MEMORIAL PROCESSING, EDITOR \_\_\_\_\_ *OK ED 1/26/72*

Federal Register Entry 4-4-72 Annual Edition Entry \_\_\_\_\_

Logged FEB 23 1972 Card FEB 23 1972

COMMENTS: \_\_\_\_\_ WORKING NUMBER 10.29.71.2

CONGRESSIONAL DISTRICT: San. Henry B. Gonzales





UNITED STATES DEPARTMENT OF THE INTERIOR  
NATIONAL PARK SERVICE

NATIONAL REGISTER OF HISTORIC PLACES

PROPERTY PHOTOGRAPH FORM

(Type all entries - attach to or enclose with photograph)

STATE

TEXAS

COUNTY

Bexar

FOR NPS USE ONLY

ENTRY NUMBER

DATE

FEB 23 1972

SEE INSTRUCTIONS

1. NAME

COMMON: Mission San Juan Capistrano

AND/OR HISTORIC:

2. LOCATION

STREET AND NUMBER:

.8 mile north of Loop 410 on Mission Road

CITY OR TOWN:

San Antonio

STATE:

Texas

CODE

048

COUNTY:

Bexar

CODE

029

3. PHOTO REFERENCE

PHOTO CREDIT: Texas State Historical Survey Committee

DATE OF PHOTO: March, 1971

NEGATIVE FILED AT: Texas State Historical Survey Committee

108 W. 15th Street, Austin, Texas 78711

4. IDENTIFICATION

DESCRIBE VIEW, DIRECTION, ETC.

East facade. View southwest.



UNITED STATES DEPARTMENT OF THE INTERIOR  
NATIONAL PARK SERVICE

NATIONAL REGISTER OF HISTORIC PLACES  
PROPERTY PHOTOGRAPH FORM

(Type all entries - attach to or enclose with photograph)

STATE

TEXAS

COUNTY

Bexar

FOR NPS USE ONLY

ENTRY NUMBER

DATE

FEB 23 1972

1. NAME

COMMON: Mission San Juan Capistrano  
AND/OR HISTORIC:

2. LOCATION

STREET AND NUMBER:  
.8 mile north of Loop 410 on Mission Road  
CITY OR TOWN:  
San Antonio

STATE:

Texas

CODE

048

COUNTY:

Bexar

CODE

029

3. PHOTO REFERENCE

PHOTO CREDIT: Texas State Historical Survey Committee  
DATE OF PHOTO: March, 1971  
NEGATIVE FILED AT: Texas State Historical Survey Committee  
108 W. 15th Street, Austin, Texas 78711

4. IDENTIFICATION

DESCRIBE VIEW, DIRECTION, ETC.

View toard wouth wall. Excavation at left foreground  
of 1731 church.

SEE INSTRUCTIONS



UNITED STATES DEPARTMENT OF THE INTERIOR  
NATIONAL PARK SERVICE

NATIONAL REGISTER OF HISTORIC PLACES  
PROPERTY PHOTOGRAPH FORM

(Type all entries - attach to or enclose with photograph)

STATE	
TEXAS	
COUNTY	
Bexar	
FOR NPS USE ONLY	
ENTRY NUMBER	DATE
	FEB 23 1972

SEE INSTRUCTIONS

1. NAME

COMMON: Mission San Juan Capistrano  
AND/OR HISTORIC:

2. LOCATION

STREET AND NUMBER:  
.8 mile north of Loop 410 on Mission Road

CITY OR TOWN:  
San Antonio

STATE:	CODE	COUNTY:	CODE
Texas	048	Bexar	029

3. PHOTO REFERENCE

PHOTO CREDIT: Texas State Historical Survey Committee

DATE OF PHOTO: March, 1971

NEGATIVE FILED AT Texas State Historical Survey Committee  
108 W. 15th Street, Austin, Texas 78711

4. IDENTIFICATION

DESCRIBE VIEW, DIRECTION, ETC.  
  
Ruins in east wall area of second church--1756-1763/64.  
View east.



UNITED STATES DEPARTMENT OF THE INTERIOR  
NATIONAL PARK SERVICE

NATIONAL REGISTER OF HISTORIC PLACES

PROPERTY PHOTOGRAPH FORM

(Type all entries - attach to or enclose with photograph)

STATE

TEXAS

COUNTY

Bexar

FOR NPS USE ONLY

ENTRY NUMBER

DATE

FEB 23 1972

1. NAME

COMMON: Mission San Juan Capistrano

AND/OR HISTORIC:

2. LOCATION

STREET AND NUMBER:

.8 mile north of Loop 410 on Mission Road

CITY OR TOWN:

San Antonio

STATE:

Texas

CODE

048

COUNTY:

Bexar

CODE

029

3. PHOTO REFERENCE

PHOTO CREDIT: Texas State Historical Survey Committee

DATE OF PHOTO: March, 1971

NEGATIVE FILED AT: Texas State Historical Survey Committee  
108 W. 15th Street, Austin, Texas 78711

4. IDENTIFICATION

DESCRIBE VIEW, DIRECTION, ETC.

View across quadrangle toward chapel and restored  
Indian quarters. Excavations in progress reveal in  
foreground probable foundations of first church (1731)  
View northwest

SEE INSTRUCTIONS

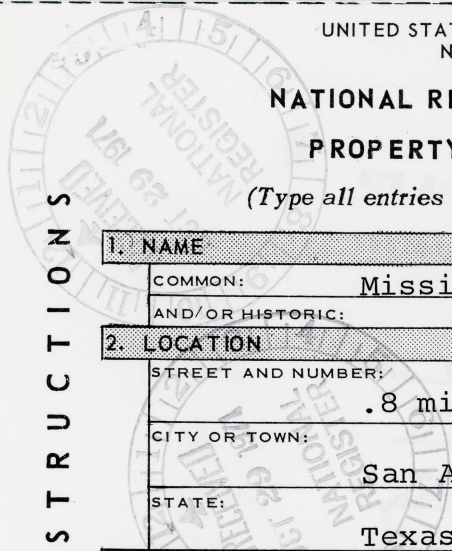





UNITED STATES DEPARTMENT OF THE INTERIOR  
NATIONAL PARK SERVICE

NATIONAL REGISTER OF HISTORIC PLACES

PROPERTY PHOTOGRAPH FORM

(Type all entries - attach to or enclose with photograph)

STATE

TEXAS

COUNTY

Bexar

FOR NPS USE ONLY

ENTRY NUMBER

DATE

FEB. 23 1972

SEE INSTRUCTIONS

1. NAME

COMMON:

Mission San Juan Capistrano

AND/OR HISTORIC:

2. LOCATION

STREET AND NUMBER:

.8 miles north of Loop 410 on Mission Road

CITY OR TOWN:

San Antonio

STATE:

Texas

CODE

048

COUNTY:

Bexar

CODE

029

3. PHOTO REFERENCE

PHOTO CREDIT:

Texas State Historical Survey Committee

DATE OF PHOTO:

March, 1971

NEGATIVE FILED AT

Texas State Historical Survey Committee  
108 W. 15th Street, Austin, Texas 78711

4. IDENTIFICATION

DESCRIBE VIEW, DIRECTION, ETC.

House along east wall. Built 1824. View northeast.

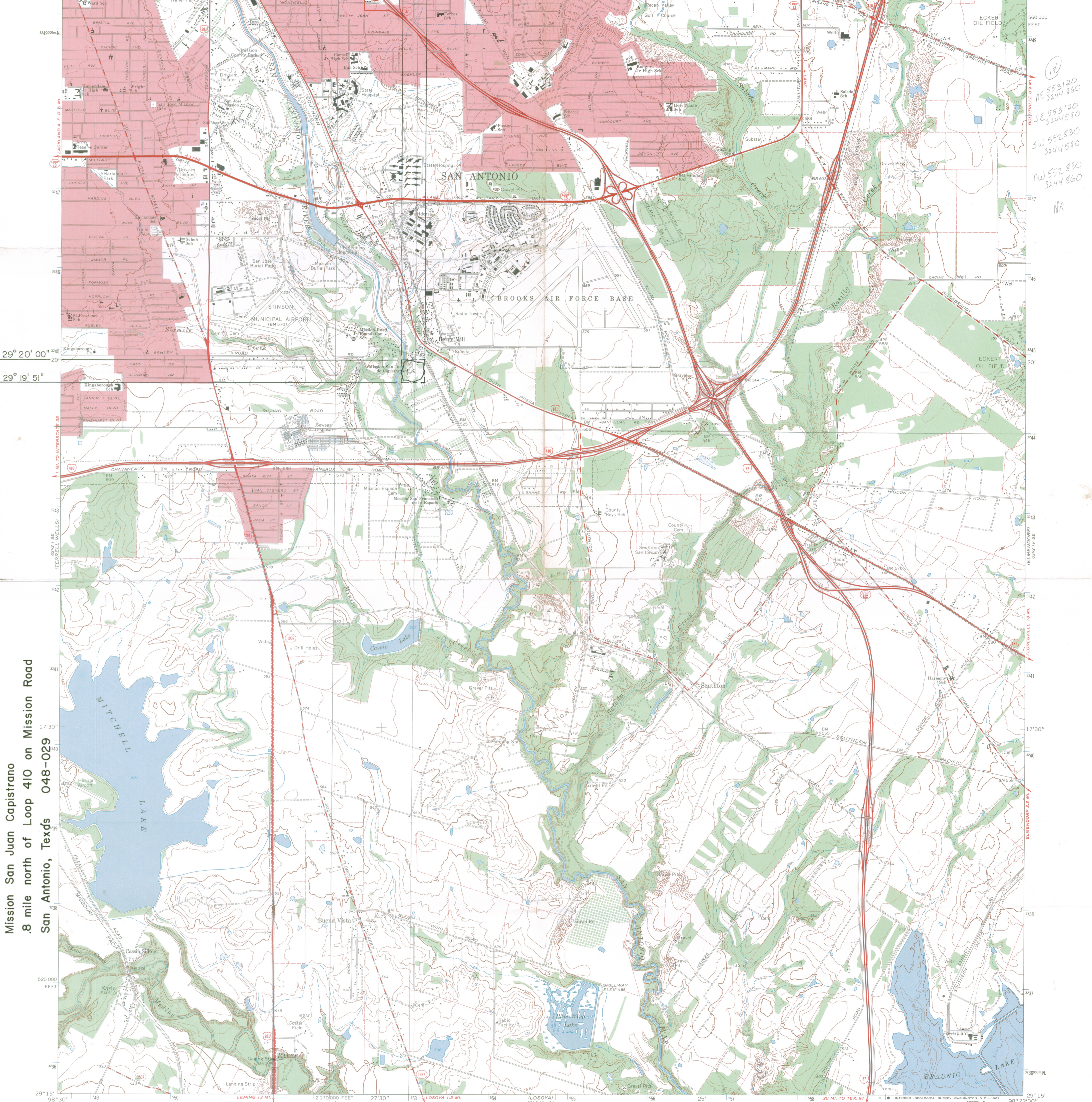

Mission San Juan Capistrano  
.8 mile north of Loop 410 on Mission Road  
San Antonio, Texas 048-029

14  
NE 553120  
SE 553120  
SW 552830  
NW 552830  
3244860  
3244570  
NA

Mapped by the Army Map Service  
Edited and published by the Geological Survey  
Control by USGS, USC&GS, and USCE  
Topography by photogrammetric methods from aerial photographs  
taken 1952. Field annotated 1953. Revised by Geological Survey  
from aerial photographs taken 1966. Field checked 1967.  
Polyconic projection. 1927 North American datum  
10,000-foot grid based on Texas coordinate system,  
south central zone  
1000-meter Universal Transverse Mercator grid ticks,  
zone 14, shown in blue  
Red tint indicates areas in which only landmark buildings are shown  
Fine red dashed lines indicate selected fence lines

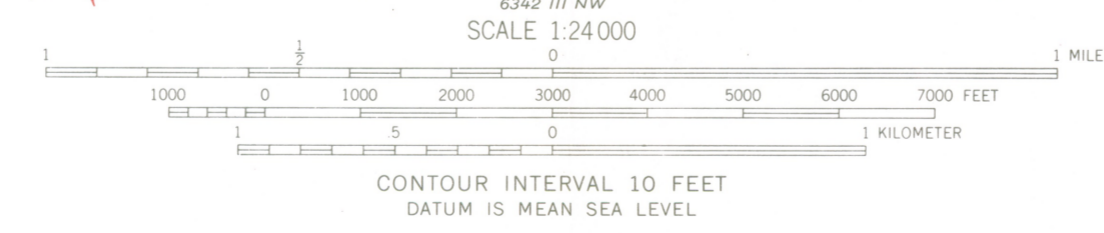
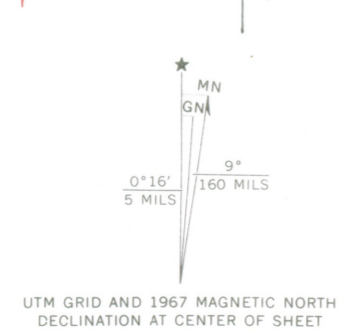

SOUTHTON, TEX.  
N2915-W9822.5/7.5

THIS MAP COMPLIES WITH NATIONAL MAP ACCURACY STANDARDS  
FOR SALE BY U.S. GEOLOGICAL SURVEY, DENVER, COLORADO 80225, OR WASHINGTON, D. C. 20242  
A FOLDER DESCRIBING TOPOGRAPHIC MAPS AND SYMBOLS IS AVAILABLE ON REQUEST

2998-132

1967  
AMS 6342 IV SW-SERIES V882

UNITED STATES DEPARTMENT OF THE INTERIOR  
NATIONAL PARK SERVICE

NATIONAL REGISTER OF HISTORIC PLACES  
PROPERTY MAP FORM

(Type all entries - attach to or enclose with map)

STATE	
TEXAS	
COUNTY	
Bexar	
FOR NPS USE ONLY	
ENTRY NUMBER	DATE
	FEB 23 1972

SEE INSTRUCTIONS

<b>1. NAME</b>			
COMMON:		Mission San Juan Capistrano	
AND/OR HISTORIC:			
<b>2. LOCATION</b>			
STREET AND NUMBER:			
.8 mile north of Loop 410 on Mission Road			
CITY OR TOWN:			
San Antonio			
STATE:	CODE	COUNTY:	CODE
Texas	048	Bexar	029
<b>3. MAP REFERENCE</b>			
SOURCE:			
United States Department of the Interior Geological Survey			
SCALE:			
1:24000			
DATE:			
1967			
<b>4. REQUIREMENTS</b>			
TO BE INCLUDED ON ALL MAPS			
1. Property boundaries where required.		Texas Map Reference #2998-132	
2. North arrow.		Southton Quadrangle	
3. Latitude and longitude reference.			

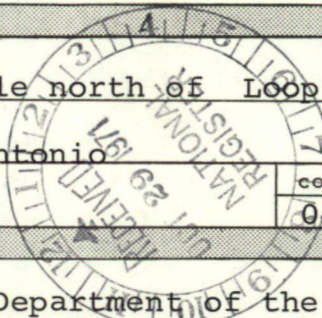

Adapted from Schuetz (1968: Figure 1)

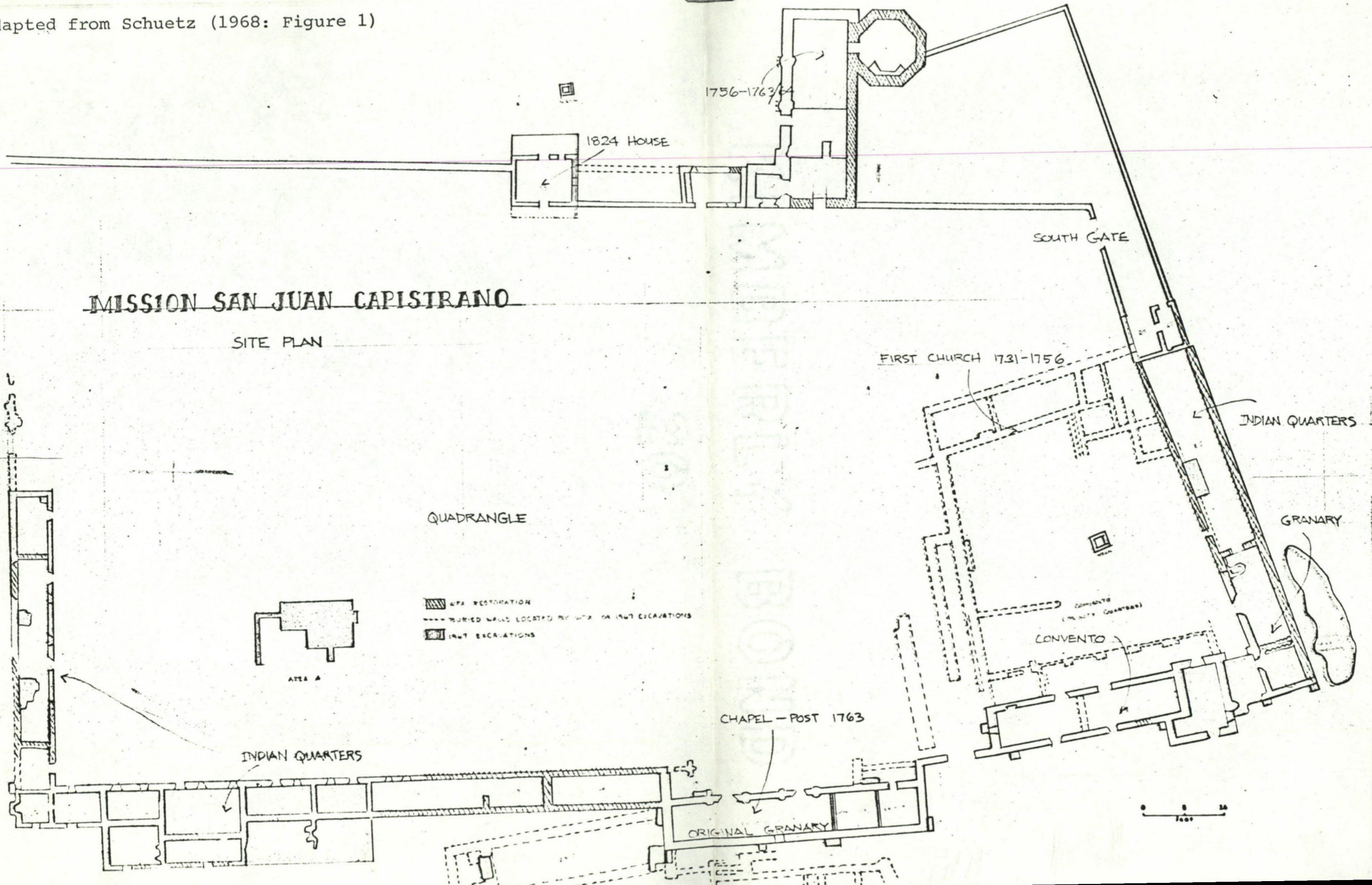

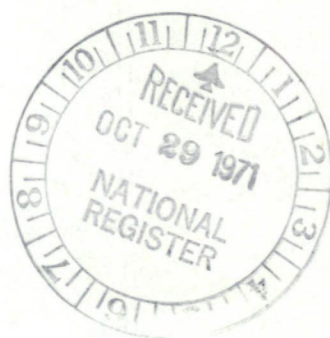

KIMBERLY BOND

50

NOV 11 1971

ENTRIES IN THE NATIONAL REGISTER

STATE TEXAS

Date Entered FEB 23 1972

<u>Name</u>	<u>Location</u>
Mission San Francisco de la Espada	San Antonio Bexar County
Mission San Juan Capistrano	San Antonio Bexar County
Rocky Dell (41 OL 4)	Adrian Oldham County
Hardenan House	Austin Travis County
Old Fort Bliss, 1878-1893	El Paso El Paso County
Garcia Pasture Site (41 CF 8)	Port Isabel Cameron County

Also Notified

Hon. John G. Tower  
Hon. Lloyd M. Bentsen, Jr.  
Hon. Henry B. Gonzales  
Hon. Robert D. Price  
Hon. J. J. (Jake) Pickle  
Hon. Richard C. White  
Hon. Eligio de la Garza

State Liaison Officer  
Mr. Truett Latimer  
Executive Director  
Texas State Historical Survey  
Committee  
Post Office Box 12276  
Capitol Station  
Austin, Texas 78711

Director, Southwest Region

2/10/72

NRowland:mm

HR

NOTIFICATION OF GRANT-IN-AID ACTION

Do Not Use This Space

1. STATE APPLICATION IDENTIFIER

48-75-00139-00

2. (Reserved for use by State central information reception agency)

3. GRANTOR: a. Federal agency

Department of the Interior

b. Organizational unit

National Park Service

c. Administering office - (1) Name

Division of Grants

(2) Address - Street or P.O. Box

18th and C Streets NW.

City

Washington

State

DC

Zip Code

20240

4. FEDERAL AGENCY GRANT IDENTIFIER: a. Code

48-75-00139-00

b. Title

Mission San Juan Capistrano Development, Phase I

c. Purpose Archeological investigation to establish original construction of building.

5. GRANTEE: a. Name

Texas Mr. Truett Latimer, Exec. Dir., Texas State Historical Survey Committee

b. Address - Street or P.O. Box

Post Office Box 12276, Capitol Station

City

Austin

State

Texas

Zip Code

78711

6. GRANTEE TYPE (Check only the single most applicable box)

a. State  b. Inter-state  c. County  d. City  e. School district  f. Special unit  g. Community action  h. Sponsored organization  i. Other

7. APPLICATION RECEIPT DATE

Year Month Day  
75 04 07

8. ACTION DATE

Year Month Day  
75 04 29

9. EFFECTIVE STARTING DATE

Year Month Day  
75 04 29

10. ENDING DATE

Year Month Day  
78 04 28

11. TYPE OF ACTION (Check as many boxes as apply to this action)

a. New grant  b. Continuation grant  c. Supplemental grant (identify agency in item 16)  d. Change in existing grant (1) Increase in duration  (2) Decrease in duration  (3) Cancellation  (4) Increase(\$)  
(5) Decrease(\$)

12. AMOUNT OF CONTRIBUTION

a. Federal - (1) basic \$10,498 (2) Supplemental \$

b. State \$10,498\*

c. Local \$

d. Other \$

13. CATALOG OF FEDERAL DOMESTIC ASSISTANCE PROGRAM (if none, clarify in item 16)

a. Program Number 15.904

b. Supplemental Program Number

14. AUTHORIZATION

a. Federal Budget Accounts 10-58-1040-0-1-405

b. Public Laws PL Title Sec. 89 665

c. U.S. Code 16 U.S.C. 470

15. FACILITY LOCATION: (For facility grant actions only)

a. City Mission Road, San Antonio

b. County Bexar

16. REMARKS

\*Archdiocese of San Antonio