

**NATIONAL REGISTER OF HISTORIC PLACES
INVENTORY - NOMINATION FORM**

(Type all entries - complete applicable sections)

STATE: TEXAS	
COUNTY: Fayette	
FOR NPS USE ONLY	
ENTRY NUMBER 70.6.42.000	DATE 6/22/70

1. NAME

COMMON: **Winedale Inn**

AND/OR HISTORIC: **Stagecoach Inn/Winedale**

2. LOCATION

STREET AND NUMBER: **Off FM 1457**

CITY OR TOWN: **Winedale**

STATE Texas	CODE 042	COUNTY: Fayette	CODE 149
-----------------------	--------------------	---------------------------	--------------------

3. CLASSIFICATION

CATEGORY (Check One)	OWNERSHIP	STATUS	ACCESSIBLE TO THE PUBLIC
<input type="checkbox"/> District <input type="checkbox"/> Site <input type="checkbox"/> Object	<input checked="" type="checkbox"/> Public <input type="checkbox"/> Private <input type="checkbox"/> Both	Public Acquisition: <input type="checkbox"/> In Process <input type="checkbox"/> Being Considered	Yes: <input type="checkbox"/> Restricted <input checked="" type="checkbox"/> Unrestricted <input type="checkbox"/> No
PRESENT USE (Check One or More as Appropriate)			
<input type="checkbox"/> Agricultural <input type="checkbox"/> Commercial <input checked="" type="checkbox"/> Educational <input type="checkbox"/> Entertainment	<input type="checkbox"/> Government <input type="checkbox"/> Industrial <input type="checkbox"/> Military <input checked="" type="checkbox"/> Museum	<input type="checkbox"/> Park <input type="checkbox"/> Private Residence <input type="checkbox"/> Religious <input checked="" type="checkbox"/> Scientific	<input checked="" type="checkbox"/> Transportation <input type="checkbox"/> Other (Specify) _____ _____ _____

4. OWNER OF PROPERTY

OWNER'S NAME: **University of Texas System c/o Board of Regents**

STREET AND NUMBER: _____

CITY OR TOWN: **University of Texas at Austin**

Austin,

STATE: Texas	CODE: 042
---------------------	------------------

5. LOCATION OF LEGAL DESCRIPTION

COURTHOUSE, REGISTRY OF DEEDS, ETC.: **Fayette County Courthouse**

STREET AND NUMBER: _____

CITY OR TOWN: **La Grange**

STATE: Texas	CODE: 042
---------------------	------------------

6. REPRESENTATION IN EXISTING SURVEYS

TITLE OF SURVEY: **Texas State Historical Survey**

DATE OF SURVEY: **1967** Federal State County Local

DEPOSITORY FOR SURVEY RECORDS: **Texas State Historical Survey Committee**

STREET AND NUMBER: **108 W. 15th Street**

CITY OR TOWN: **Austin**

STATE: Texas	CODE: 042
---------------------	------------------

SEE INSTRUCTIONS



STATE:

COUNTY:

ENTRY NUMBER

DATE

FOR NPS USE ONLY

7. DESCRIPTION

CONDITION	(Check One)					
	<input checked="" type="checkbox"/> Excellent	<input type="checkbox"/> Good	<input type="checkbox"/> Fair	<input type="checkbox"/> Deteriorated	<input type="checkbox"/> Ruins	<input type="checkbox"/> Unexposed
	(Check One)			(Check One)		
	<input type="checkbox"/> Altered	<input checked="" type="checkbox"/> Unaltered		<input type="checkbox"/> Moved	<input checked="" type="checkbox"/> Original Site	

DESCRIBE THE PRESENT AND ORIGINAL (if known) PHYSICAL APPEARANCE

The site complex consists of the Inn itself, a two story eight room double frame structure of native cedar and several out buildings of cedar and oak, among them a log kitchen, log smoke house, a barn made up of two double log cabins, and a barn now altered into a theater. Also on the property are "Lauderdale House", a 19th century residence moved onto the site and used now for classrooms and dormitory for scholars, "Hazel's Lone Oak", an 1854 cottage brought in & restored for use as an exhibition area and curator's office, and MacGregor House, a two story late Greek revival house with excellent detail.

The Inn itself was probably built in several stages and includes the original one room and loft structure of about 1834 in the present structure which was brought to its present size in about 1850 by turning the loft into a second story and adding an identical section to the north with a wide open central hall separating the two halves of the building at each level. There is a large, steeply pitched roof, two chimneys, and a wide inset double gallery with wooden railing and carefully spaced posts. The building is of native cedar.

There are eight rooms in the Inn. German painted and stenciled motifs were added to the ceilings and walls in several rooms. The ceiling of one room is totally decorated with garlands of fruit and flowers. In the center is a bright green parrot and at the sides a sheath of wheat, a cluster of roses, a peach, and a fire, probably representing the four seasons surrounding the symbol of longevity, the parrot. These freehand paintings were probably the work of Rudolf Melchoir.

The log smokehouse was moved in to go on to the site of a log structure of the same dimensions. Half of the smokehouse has a puncheon floor, the other half is of clay. The log kitchen was moved in to replace the destroyed original kitchen. The "Four Square" barn is two double log houses under one roof and was on the property when acquired for restoration. It is now used to display a woodworking shop, farm tools, and blacksmith tools. Moved on to the property also are "Hazel's Lone Oak", a one story and loft dog trot house with inset front gallery and with a decorative railing on the stairs leading to the loft which has openings over the porch for ventilation; the "Theater Barn" altered to seat three hundred and with a stage area and two dressing rooms for theatrical productions; Lauderdale House, a nineteenth century residence converted into a dormitory with classrooms for conferences; an innkeeper's cottage; the MacGregor House, a two story late Greek revival house of 1859, with excellent detail and painted decoration related to that of the Inn itself.

SEE INSTRUCTIONS

B. SIGNIFICANCE

PERIOD (Check One or More as Appropriate)

- | | | | |
|--|---------------------------------------|--|---------------------------------------|
| <input type="checkbox"/> Pre-Columbian | <input type="checkbox"/> 16th Century | <input type="checkbox"/> 18th Century | <input type="checkbox"/> 20th Century |
| <input type="checkbox"/> 15th Century | <input type="checkbox"/> 17th Century | <input checked="" type="checkbox"/> 19th Century | |

SPECIFIC DATE(S) (If Applicable and Known)

Not applicable

AREAS OF SIGNIFICANCE (Check One or More as Appropriate)

- | | | | |
|--|---------------------------------------|--|--|
| <input type="checkbox"/> Aboriginal | <input type="checkbox"/> Education | <input type="checkbox"/> Political | <input type="checkbox"/> Urban Planning |
| <input type="checkbox"/> Prehistoric | <input type="checkbox"/> Engineering | <input type="checkbox"/> Religion/Philosophy | <input type="checkbox"/> Other (Specify) |
| <input type="checkbox"/> Historic | <input type="checkbox"/> Industry | | _____ |
| <input type="checkbox"/> Agriculture | <input type="checkbox"/> Invention | <input type="checkbox"/> Science | _____ |
| <input checked="" type="checkbox"/> Architecture | <input type="checkbox"/> Landscape | <input type="checkbox"/> Sculpture | _____ |
| <input type="checkbox"/> Art | <input type="checkbox"/> Architecture | <input type="checkbox"/> Social/Humanitarian | _____ |
| <input type="checkbox"/> Commerce | <input type="checkbox"/> Literature | <input type="checkbox"/> Theater | _____ |
| <input type="checkbox"/> Communications | <input type="checkbox"/> Military | <input type="checkbox"/> Transportation | _____ |
| <input type="checkbox"/> Conservation | <input type="checkbox"/> Music | | _____ |

STATEMENT OF SIGNIFICANCE

The Stagecoach Inn at Winedale in northeast Fayette County was purchased by Miss Ima Hogg, daughter of former Governor Jim Hogg, and given to the University of Texas. It is historically significant, though not in the more obvious sense. No major political or military events occurred in or around this building. It is not even claimed that the peripatetic Sam Houston ever slept here. Of its half dozen early owners, none was spectacularly famous and only two were widely known in the Texas of their day.

Still, this lovely restoration in the valley of Jack's Creek is a striking symbol of much that is important in the history of Texas. It is on a homestead established in the Mexican colonial period in the heart of an area which drew settlers even before Stephen Austin, made it a part of his first colony.

The Inn itself is believed to have been built by Will Townsend in 1834 as a stout one room frame structure with heavy cedar timbers and a loft above. The property was purchased by Samuel K. Lewis and in about 1850 this structure was more than doubled, the loft turned into a full second story and an identical section added to the north with a wide, open hallway between the two halves of the house, upstairs and down. A broad two-story gallery was added across the front.

Architecturally and historically, the Inn combines the Anglo-American and German elements which flowed together in Fayette County to contribute to the cultural ferment which eventually produced one aspect of Texas culture. Paintings in the Inn, for example, are thought to have been done by Rudolph Melchoir, one of a family of artistic German immigrants who settled Round Top in the 1860's. German decorative motifs abound throughout the Inn.

Winedale Properties include various outlying buildings: Hazel's Lone Oak Cottage, built in 1854; the Lauderdale House, an Innkeeper's cottage; two barns; a log kitchen, smoke house, and the MacGregor House of 1859. Today, the University of

SEE INSTRUCTIONS

9. MAJOR BIBLIOGRAPHICAL REFERENCES

R. Henderson Shuffler, "Winedale Inn, at Early Texas' Cultural Crossroad", The Texas Quarterly, Summer, 1965. Reprint.

SW 14/727170
3329840
NW 14/727140
3330840
HL

10. GEOGRAPHICAL DATA

LATITUDE AND LONGITUDE COORDINATES DEFINING A RECTANGLE LOCATING THE PROPERTY			O R	LATITUDE AND LONGITUDE COORDINATES DEFINING THE CENTER POINT OF A PROPERTY OF LESS THAN TEN ACRES		
CORNER	LATITUDE	LONGITUDE		LATITUDE	LONGITUDE	
	Degrees Minutes Seconds	Degrees Minutes Seconds		Degrees Minutes Seconds	Degrees Minutes Seconds	
NW	30° 5' 22"	96° 38' 35"		0	0	
NE	30° 5' 22"	96° 37' 58"				
SE	30° 4' 49"	96° 37' 58"				
SW	30° 4' 49"	96° 38' 35"				

APPROXIMATE ACREAGE OF NOMINATED PROPERTY: **130 acres**

LIST ALL STATES AND COUNTIES FOR PROPERTIES OVERLAPPING STATE OR COUNTY BOUNDARIES

STATE:	CODE	COUNTY	CODE



UTM NE 14/728120
3330860
SE 14/728120
3329860

SEE INSTRUCTIONS

11. FORM PREPARED BY M. Wayne Bell, Project Director

NAME AND TITLE: **Roxanne Williamson, Architectural Historian
Martha Doty, Cultural Historian (SB)**

ORGANIZATION: **Texas State Historical Survey Committee** DATE: **4/7/70**

STREET AND NUMBER: **108 W. 15th Street**

CITY OR TOWN: **Austin** STATE: **Texas** CODE: **042**

12. STATE LIAISON OFFICER CERTIFICATION NATIONAL REGISTER VERIFICATION

As the designated State Liaison Officer for the National Historic Preservation Act of 1966 (Public Law 89-665), I hereby nominate this property for inclusion in the National Register and certify that it has been evaluated according to the criteria and procedures set forth by the National Park Service. The recommended level of significance of this nomination is:

National State Local

Name: *Juett Salmer* Title: State Liaison Officer Date: 4-28-70

I hereby certify that this property is included in the National Register.

Ernest Allen Connally
Chief, Office of Archeology and Historic Preservation

Date: JUN 22 1970

ATTEST:

William J. Smutge
Keeper of The National Register

Date: JUN 1 1970

**NATIONAL REGISTER OF HISTORIC PLACES
INVENTORY - NOMINATION FORM**

(Continuation Sheet)

STATE	TEXAS	
COUNTY	Fayette	
FOR NPS USE ONLY		
ENTRY NUMBER	7	DATE
70.6.42.000		5/22/70

(Number all entries)

8. (cont'd)

Texas uses the Winedale buildings for conferences and festivals. There is a day school and there are museum and restoration workshops. Scholars performing area research in academic fields related to ethnic studies frequently visit the Inn, and a museum which depicts early German settlement in Texas is open to the public. Recorded Texas Historic Landmark - 1967. (The Stagecoach Inn.)

R.H. Shuffler. "Winedale Inn, at Early Texas' Cultural Crossroad", The Texas Quarterly, Summer, 1965. Reprint.

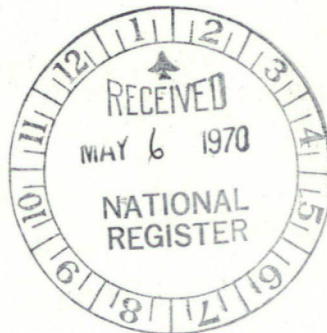



MAC GREGOR HOUSE

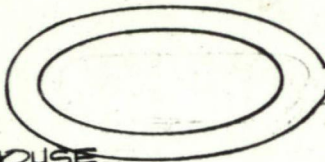

APPROX. 200 YDS.

WINEDALE INN PROPERTIES

UNIVERSITY OF TEXAS SYSTEM

CODE: 42-149 SCALE: 1" = 100'

ROUND TOP, TEXAS: FM 2714

4-1-70

LAUDERDALE HOUSE

4-SQUARE BARN

THEATER BARN

LONE OAK COTTAGE

KITCHEN & SMOKE HOUSE

INN

FM 2714

INNKEEPER'S COTTAGE
(CONTEMPORARY BLDG.)

NORTH

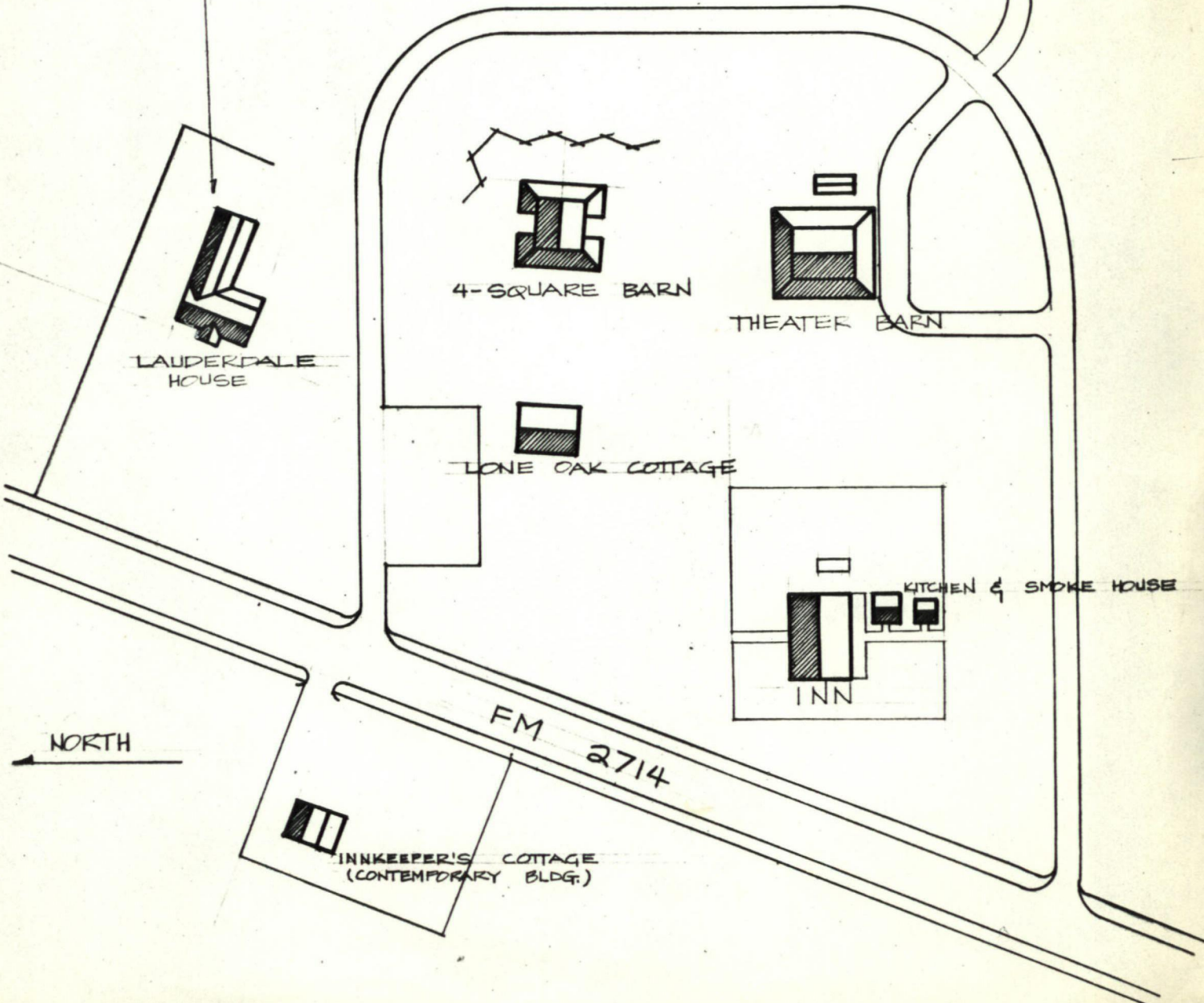

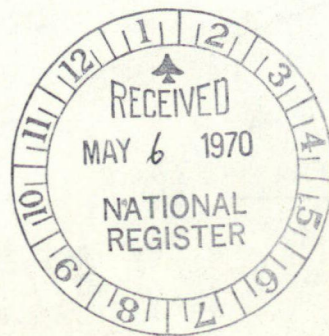

7/6/70

70000745

Fayette TEX

Kinsdale Inn

70.6.42.000

SIGN

RECEIPT

	DATE OF RECEIPT	YES	NO	REG. NUMBER
DATA PAGE	5/4/70	✓		10
PHOTO (S)		✓		10
PHOTO DESCRIPTION (S)		✓		
MAPS (S)		✓		1
MAP DESCRIPTIONS (S)		✓		
LOGGED		✓		
ACKNOWLEDGE	5/6/70	✓		

MM 5/6/70

REVIEW

ROLE	COMMENTS
HISTORIAN	mottley collection but qualifies I believe
HISTORIAN	Unless certain individual specimens are of particular importance I think only the Inn qualifies. Don't believe we should encourage these collections although it is a useful complex most of it could be reassembled elsewhere
ARCHITECT	see note

Gamble
5/11/70
B.F.
5/24/70
Chambers
5/22/70

Chief Architect _____ Chief Archeologist _____ Chief Historian _____

NO. Texas can do better Bradford, 5/26/70

Keper
OK

Smiley
6/1/70

ENTRY

CHIEF, OAHP COMMENTS

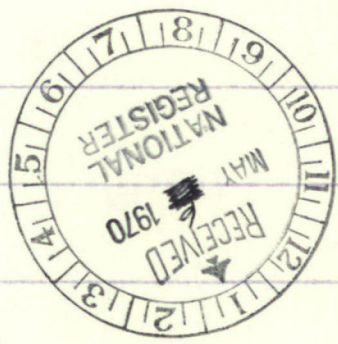

EDITORIAL PROCESSING

EDITOR
Federal Register Entry
Annual Edition Entry
Date 8/4/70

ED 5/12

FILE FILE FILE WORKING NUMBER

5-1-70-4

X



NPS Number 70-6-42-0007

Title: Wineville Inn

Loc. Fayette County, Texas ①

Handerdale House from the
last

PROPERTY OF THE NATIONAL REGISTER

UNITED STATES DEPARTMENT OF THE INTERIOR
NATIONAL PARK SERVICE

NATIONAL REGISTER OF HISTORIC PLACES

PROPERTY PHOTOGRAPH FORM

(Type all entries - attach to or enclose with photograph)

STATE		TEXAS
COUNTY		Fayette
FOR NPS USE ONLY		
ENTRY NUMBER	DATE	
70-6-42-000-17	6/22/70	

SEE INSTRUCTIONS

1. NAME			
COMMON:	Winedale Inn		
AND/OR HISTORIC:	Stagecoach Inn/Winedale		
2. LOCATION			
STREET AND NUMBER:	Off FM 1457		
CITY OR TOWN:	Winedale		
STATE:	CODE	COUNTY:	CODE
Texas	042	Fayette	149
3. PHOTO REFERENCE			
PHOTO CREDIT:	Texas State Historical Survey Committee		
DATE OF PHOTO:	9/4/69		
NEGATIVE FILED AT:	Texas State Historical Survey Committee 108 W. 15th Street, Austin, Texas 78712		
4. IDENTIFICATION			
DESCRIBE VIEW, DIRECTION, ETC.			
Lauderdale House from the west			

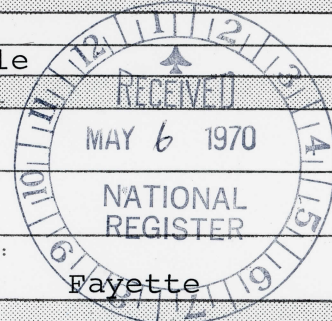



NPS Number 70-6-42-0007

Title: Windale Inn

Loc. Fayette County, Texas
Four square bars, new
from south

②

UNITED STATES DEPARTMENT OF THE INTERIOR
NATIONAL PARK SERVICE

NATIONAL REGISTER OF HISTORIC PLACES

PROPERTY PHOTOGRAPH FORM

(Type all entries - attach to or enclose with photograph)

STATE Texas	
COUNTY Fayette	
FOR NPS USE ONLY	
ENTRY NUMBER 70.6.42.0007	DATE 6/22/70

SEE INSTRUCTIONS

1. NAME			
COMMON:	Winedale Inn		
AND/OR HISTORIC:	Stagecoach Inn/Winedale		
2. LOCATION			
STREET AND NUMBER:	Off FM 1457		
CITY OR TOWN:	Winedale		
STATE:	CODE	COUNTY:	CODE
Texas	042	Fayette	149
3. PHOTO REFERENCE			
PHOTO CREDIT:	Texas State Historical Survey Committee		
DATE OF PHOTO:	9/4/69		
NEGATIVE FILED AT:	Texas State Historical Survey Committee 108 W. 15th Street, Austin, Texas 78711		
4. IDENTIFICATION			
DESCRIBE VIEW, DIRECTION, ETC.			
Four square barn, view from south			

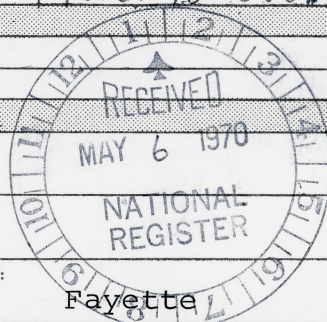



NPS Number 70-6-42-0007

Title: Wiedale Inn

Loc.

Layette County, Texas

Wheeler Barn showing sides

up

(3)

PROPERTY OF THE NATIONAL REGISTER

UNITED STATES DEPARTMENT OF THE INTERIOR
NATIONAL PARK SERVICE

NATIONAL REGISTER OF HISTORIC PLACES
PROPERTY PHOTOGRAPH FORM

(Type all entries - attach to or enclose with photograph)

STATE TEXAS	
COUNTY Fayette	
FOR NPS USE ONLY	
ENTRY NUMBER 70-6142-0007	DATE 6/22/70

SEE INSTRUCTIONS

1. NAME			
COMMON:	Winedale Inn		
AND/OR HISTORIC:	Stagecoach Inn/Winedale		
2. LOCATION			
STREET AND NUMBER: Foff FM 1457			
CITY OR TOWN: Winedale			
STATE:	Texas	CODE 042	COUNTY: Fayette
			CODE 149
3. PHOTO REFERENCE			
PHOTO CREDIT:	Texas State Historical Survey Committee		
DATE OF PHOTO:	9/4/69		
NEGATIVE FILED AT:	Texas State Historical Survey Committee 108 W. 15th Street, Austin, Texas 78712		
4. IDENTIFICATION			
DESCRIBE VIEW, DIRECTION, ETC. Theater barn showing sides up			

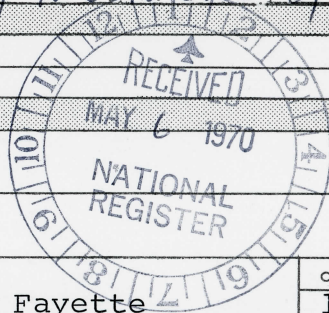



NPS Number

70-6-42-0007

Title:

Meredale Inn

Loc.

Fayette County, Texas

Theater barn, view from
south

(4)

PROPERTY OF THE NATIONAL REGISTER 8

UNITED STATES DEPARTMENT OF THE INTERIOR
NATIONAL PARK SERVICE

NATIONAL REGISTER OF HISTORIC PLACES

PROPERTY PHOTOGRAPH FORM

(Type all entries - attach to or enclose with photograph)

STATE Texas	
COUNTY Fayette	
FOR NPS USE ONLY	
ENTRY NUMBER 70.6.42.000	DATE 6/22/70

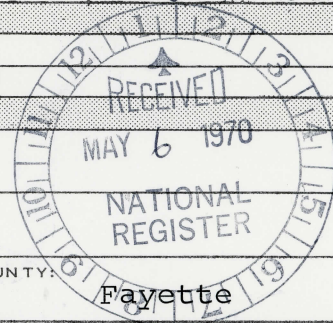

SEE INSTRUCTIONS

1. NAME			
COMMON:	Winedale Inn		
AND/OR HISTORIC:	Stagecoach Inn/Winedale		
2. LOCATION			
STREET AND NUMBER:			
	off FM 1457		
CITY OR TOWN:			
	Winedale		
STATE:	Texas	CODE	COUNTY:
		042	Fayette
			CODE 149
3. PHOTO REFERENCE			
PHOTO CREDIT:	Texas State Historical Survey Committee		
DATE OF PHOTO:	9/4/69		
NEGATIVE FILED AT:	Texas State Historical Survey Committee 108 W. 15th Street, Austin, Texas 78711		
4. IDENTIFICATION			
DESCRIBE VIEW, DIRECTION, ETC.			
Theater barn, view from south			



NPS Number 70-6-42-0007

Title: Windale Inn

Loc. Fayette County, Texas

Four square barn, view
from North

(5)

UNITED STATES DEPARTMENT OF THE INTERIOR
NATIONAL PARK SERVICE

NATIONAL REGISTER OF HISTORIC PLACES

PROPERTY PHOTOGRAPH FORM

(Type all entries - attach to or enclose with photograph)

STATE Texas	
COUNTY Fayette	
FOR NPS USE ONLY	
ENTRY NUMBER 70-6-42-000	DATE 6/22/70

SEE INSTRUCTIONS

1. NAME

COMMON: Winedale Inn
AND/OR HISTORIC: Stagecoach Inn/Winedale

2. LOCATION

STREET AND NUMBER:
Off FM 1457

CITY OR TOWN:
Winedale

STATE: Texas	CODE 042	COUNTY: Fayette	CODE 149
-----------------	-------------	--------------------	-------------

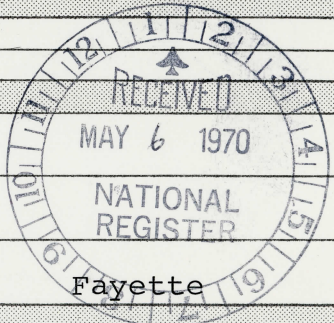

3. PHOTO REFERENCE

PHOTO CREDIT: Texas State Historical Survey Committee
DATE OF PHOTO: 9/4/69
NEGATIVE FILED AT: Texas State Historical Survey Committee
108 W. 15th Street, Austin, Texas 78711

4. IDENTIFICATION

DESCRIBE VIEW, DIRECTION, ETC.
Four square barn, view from North



For Rent
Call 1234

NPS Number 70-6-42-0007

Title: Winedale Inn

Loc. Fayette County, Texas (6)
Hazel's home Oak from
the west

UNITED STATES DEPARTMENT OF THE INTERIOR
NATIONAL PARK SERVICE

NATIONAL REGISTER OF HISTORIC PLACES
PROPERTY PHOTOGRAPH FORM

(Type all entries - attach to or enclose with photograph)

STATE		TEXAS
COUNTY		Fayette
FOR NPS USE ONLY		
ENTRY NUMBER	DATE	
70-6-42-000-17	6/22/70	

SEE INSTRUCTIONS

1. NAME			
COMMON:	Winedale Inn		
AND/OR HISTORIC:	Stagecoach Inn/Winedale		
2. LOCATION			
STREET AND NUMBER:			
Off FM 1457			
CITY OR TOWN:			
Winedale			
STATE:	CODE	COUNTY:	CODE
Texas	042	Fayette	149
3. PHOTO REFERENCE			
PHOTO CREDIT:	Texas State Historical Survey Committee		
DATE OF PHOTO:	9/4/69		
NEGATIVE FILED AT:	Texas State Historical Survey Committee 108 W. 15th Street, Austin, Texas 78712		
4. IDENTIFICATION			
DESCRIBE VIEW, DIRECTION, ETC.			
Hazel's Lone Oak from the west			

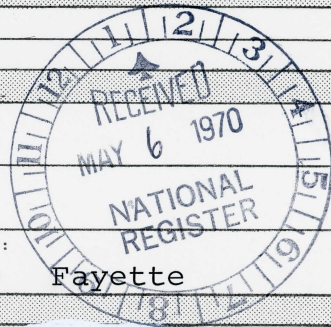



NPS Number

70-6-42-0007

Title:

Woodole Inn

Loc.

Jayette County, Texas

bag kitchen & smoke
house

7

UNITED STATES DEPARTMENT OF THE INTERIOR
NATIONAL PARK SERVICE

NATIONAL REGISTER OF HISTORIC PLACES

PROPERTY PHOTOGRAPH FORM

(Type all entries - attach to or enclose with photograph)

STATE		TEXAS	
COUNTY		Fayette	
FOR NPS USE ONLY			
ENTRY NUMBER	7	DATE	6/22/70
70-6-42-000			

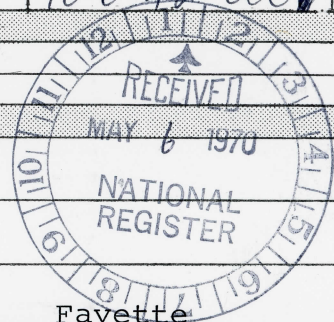

SEE INSTRUCTIONS

1. NAME			
COMMON:	Winedale Inn		
AND/OR HISTORIC:	Stagecoach Inn/Winedale		
2. LOCATION			
STREET AND NUMBER:			
Off FM 1457			
CITY OR TOWN:			
Winedale			
STATE:	CODE	COUNTY:	CODE
Texas	042	Fayette	149
3. PHOTO REFERENCE			
PHOTO CREDIT:	Texas State Historical Survey Committee		
DATE OF PHOTO:	9/4/69		
NEGATIVE FILED AT:	Texas State Historical Survey Committee 108 W. 15th Street, Austin, Texas 78712		
4. IDENTIFICATION			
DESCRIBE VIEW, DIRECTION, ETC.			
Log Kitchen, & smoke house			



NPS Number 70-6-42-0007

Title: Winedale Inc

Loc. Fayette County, Texas
hog Kitcher, interior
view

⑧

UNITED STATES DEPARTMENT OF THE INTERIOR
NATIONAL PARK SERVICE

NATIONAL REGISTER OF HISTORIC PLACES

PROPERTY PHOTOGRAPH FORM

(Type all entries - attach to or enclose with photograph)

STATE	Texas	
COUNTY	Fayette	
FOR NPS USE ONLY		
ENTRY NUMBER	7	DATE
70.6.42.000		6/22/70

SEE INSTRUCTIONS

1. NAME			
COMMON:	Winedale Inn		
AND/OR HISTORIC:	Stagecoach Inn/Winedale		
2. LOCATION			
STREET AND NUMBER:	Off FM 1457		
CITY OR TOWN:	Winedale		
STATE:	Texas	CODE	COUNTY:
		042	Fayette
			CODE
			149
3. PHOTO REFERENCE			
PHOTO CREDIT:	Texas State Historical Survey Committee		
DATE OF PHOTO:	9/4/69		
NEGATIVE FILED AT:	Texas State Historical Survey Committee 108 W. 15th Street, Austin, Texas 78712		
4. IDENTIFICATION			
DESCRIBE VIEW, DIRECTION, ETC.			
Log Kitchen, interior view			

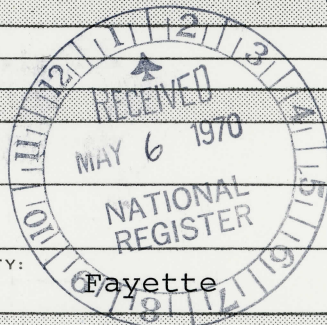



NPS Number 70-6-42-0007

Title: Winedale Inn

(9)

Loc. Fayette County, Texas
near Inn, side of rear
elevations

PROPERTY OF THE NATIONAL REGISTER

UNITED STATES DEPARTMENT OF THE INTERIOR
NATIONAL PARK SERVICE

NATIONAL REGISTER OF HISTORIC PLACES

PROPERTY PHOTOGRAPH FORM

(Type all entries - attach to or enclose with photograph)

STATE		TEXAS	
COUNTY			
Fayette			
FOR NPS USE ONLY			
ENTRY NUMBER		DATE	
70.6.42-000		6/22/70	

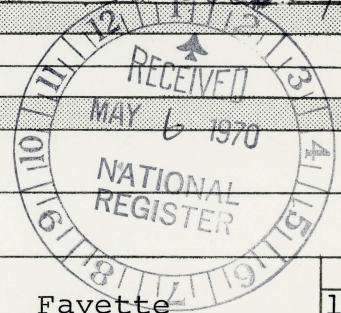

SEE INSTRUCTIONS

1. NAME			
COMMON:	Winedale Inn		
AND/OR HISTORIC:	Stagecoach Inn/Winedale		
2. LOCATION			
STREET AND NUMBER:			
Off FM 1457			
CITY OR TOWN:			
Winedale			
STATE:	CODE	COUNTY:	CODE
Texas	042	Fayette	149
3. PHOTO REFERENCE			
PHOTO CREDIT:	Texas State Historical Survey Committee		
DATE OF PHOTO:	9/4/69		
NEGATIVE FILED AT:	Texas State Historical Survey Committee 108 W. 15th Street, Austin, Texas 78712		
4. IDENTIFICATION			
DESCRIBE VIEW, DIRECTION, ETC.			
The Inn, side & rear elevations			



NPS Number 70-6-42-0007

Title: Winedale Inn

Loc. Fayette County, Texas

10

The Inn, front and side
elevations

PROPERTY OF THE NATIONAL REGISTER

UNITED STATES DEPARTMENT OF THE INTERIOR
NATIONAL PARK SERVICE

NATIONAL REGISTER OF HISTORIC PLACES
PROPERTY PHOTOGRAPH FORM

(Type all entries - attach to or enclose with photograph)

STATE	
Texas	
COUNTY	
Fayette	
FOR NPS USE ONLY	
ENTRY NUMBER	DATE
70.6.42.000	6/22/70

SEE INSTRUCTIONS

1. NAME

COMMON: Winedale Inn
AND/OR HISTORIC: Stagecoach Inn/Winedale

2. LOCATION

STREET AND NUMBER: Off FM 1457
CITY OR TOWN: Winedale
STATE: Texas CODE 042 COUNTY: Fayette CODE 149

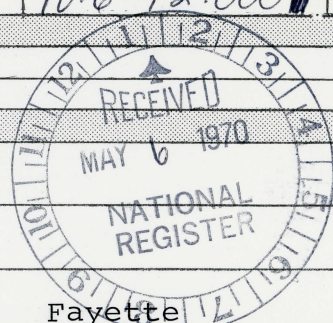

3. PHOTO REFERENCE

PHOTO CREDIT: Texas State Historical Survey Committee
DATE OF PHOTO: 9/4/69
NEGATIVE FILED AT: Texas State Historical Survey Committee
108 W. 15th Street, Austin, Texas 78712

4. IDENTIFICATION

DESCRIBE VIEW, DIRECTION, ETC.
The Inn, front and side elevations

**NATIONAL REGISTER OF HISTORIC PLACES
PROPERTY MAP FORM**

(Type all entries - attach to or enclose with map)

STATE	TEXAS	
COUNTY	Fayette	
FOR NPS USE ONLY		
ENTRY NUMBER	7	DATE
70-6-42-000		6/22/70

SEE INSTRUCTIONS

1. NAME

COMMON:	Winedale Inn
AND/OR HISTORIC:	Stagecoach Inn/Winedale

2. LOCATION

STREET AND NUMBER:			
Off FM 1457			
CITY OR TOWN:			
Winedale			
STATE:	CODE	COUNTY:	CODE
Texas	042	Fayette	149

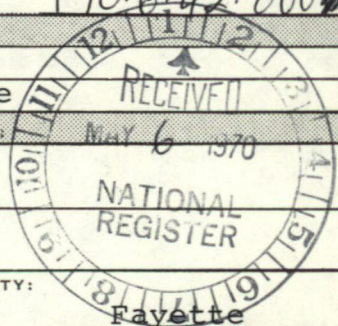

3. MAP REFERENCE

SOURCE:	United States Department of Interior Geological Survey
SCALE:	1:24000
DATE:	1956

4. REQUIREMENTS

TO BE INCLUDED ON ALL MAPS

- Property boundaries where required.
- North arrow.
- Latitude and longitude reference.

Texas Map Reference #3096-212

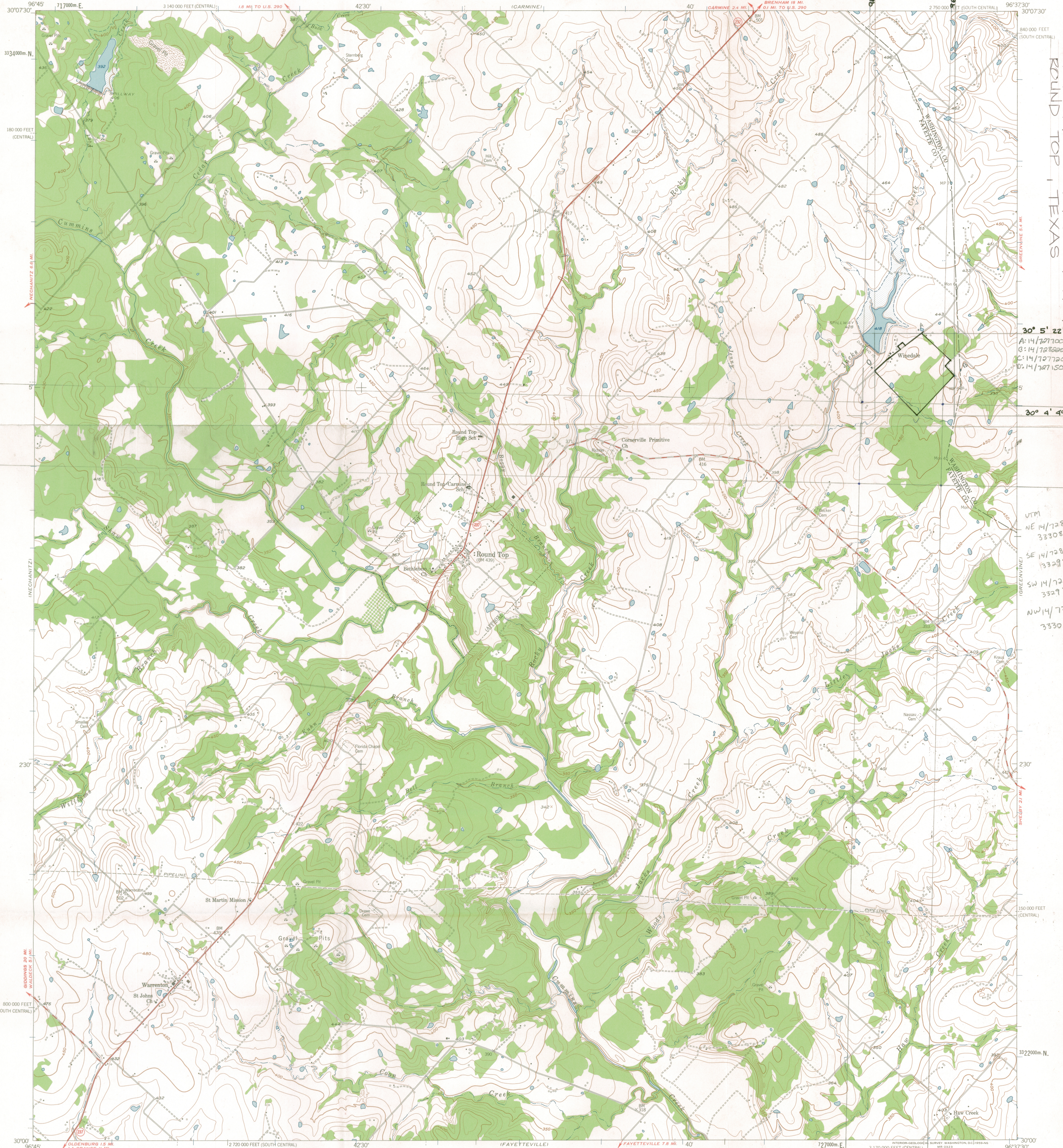

WINEPALE INN PROPERTIES
UNIVERSITY OF TEXAS SYSTEM
ROUND TOP, TEXAS

30° 5' 22"
A: 14/72700/3330875
B: 14/72800/3330395
C: 14/72700/3330815
D: 14/727150/3330345

30° 4' 49"

UTM
NE 14/728120
3330860
SE 14/728120
3329860
SW 14/727170
3329840
NW 14/727110
3330840
HL

Mapped, edited, and published by the Geological Survey
Control by USGS and USC&GS
Topography from aerial photographs by multiplex methods
Aerial photographs taken 1956. Field check 1958
Polyconic projection. 1927 North American datum
10,000-foot grid based on Texas coordinate system,
south central and central zones
1,000-meter Universal Transverse Mercator grid ticks,
zone 14, shown in blue
Areas covered by dashed light-blue pattern
are subject to controlled inundation

TRUE NORTH
MAGNETIC NORTH
APPROXIMATE MEAN
DECLINATION, 1958

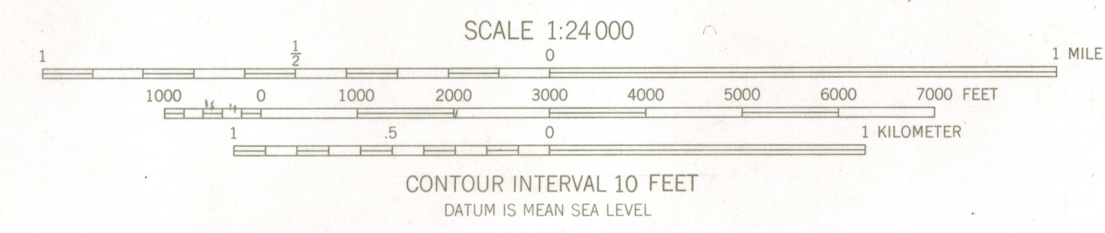

ROAD CLASSIFICATION
Heavy-duty ——— Light-duty - - - - -
Medium-duty ——— Unimproved dirt = = = = =
○ State Route

ROUND TOP, TEX.
N3000-W9637.5/7.5
1958

JUL 22 1968

THIS MAP COMPLIES WITH NATIONAL MAP ACCURACY STANDARDS
FOR SALE BY U.S. GEOLOGICAL SURVEY, DENVER 25, COLORADO OR WASHINGTON 25, D.C.
A FOLDER DESCRIBING TOPOGRAPHIC MAPS AND SYMBOLS IS AVAILABLE ON REQUEST

3096-212 18

Photocopy to

Publications

6/24/75

JE

6/22/70

Green
Winddale Sun

H30-HR

JUN 22 1970

Mr. Truett Latimer
Executive Director
Texas State Historical Survey Committee
108 West 15th Street
Austin, Texas 78701

Dear Mr. Latimer:

We are pleased to inform you that the historic properties listed on the enclosure have been placed on the National Register of Historic Places. Senators Ralph W. Yarborough and John G. Tower and the appropriate Representatives have also been notified. Please withhold any publicity on this until you have received a carbon copy of the Congressional correspondence.

Sincerely yours,

(Signed)

Ernest Allen Connally
Chief, Office of Archeology
and Historic Preservation

Enclosure

Entered in the National Register

JUN 22 1970

cc:

HR

RGamble:mas

6/22/70

BASIC FILE RETAINED IN HR

*Gamble
6/22/70*

Properties added to the National Register of Historical Places

TEXAS

Texas State Capitol Building	Austin, Texas
Waco Suspension Bridge	Waco, Texas
Winedale Inn	Winedale, Texas

3 2/70

an
Gamble
6/22/70
Carmichael 6-22
Eaton 6/25/70
Wood 6/26
J. Stanton 6/29
Jensen 6/30

H30-HR

JUN 30 1970

Bayette Co + W

BASIC FILE RETAINED IN HR

Hon. John Young
House of Representatives
Washington, D. C.

Dear Mr. Young:

We are pleased to inform you that the Winedale Inn in Winedale, Texas, has been nominated by the State Liaison Officer appointed by the Governor for the implementation of the National Historic Preservation Program in Texas and has been entered into the National Register of Historic Places. Senators Ralph W. Yarborough and John G. Tower have also been provided with this information. By copy of this letter, the State Liaison Officer, Mr. Truett Latimer, Executive Director, Texas State Historical Survey Committee, 108 West 15th Street, Austin, Texas 78701, has likewise been notified. A leaflet explaining the National Register is enclosed.

6/22/70

RGamble:imm

Sincerely yours,

(Sgd) Thomas F. Flynn

DEPUTY Director

Enclosure

JUN 22 1970

Entered in the National Register

cc: Mr. Truett Latimer, Executive Director, Texas State Historical Survey Committee, 108 West 15th Street, Austin, Texas 78701

Director, Southwest Region

cc: Mr. Charles Steen, Southwest Regional Office
LL-Mr. Melvin
HR

Green
Gamble
6/22/70
Carroll
6-22
Eaton 6/22/70
Wood
6/22
J. Stenning
6/22

BASIC FILE REMAINED IN HR

H30-HR

JUN 30 1970

Hon. Ralph W. Yarborough
United States Senate
Washington, D. C.

Dear Senator Yarborough:

We are pleased to inform you that the historic properties listed on the enclosure have been nominated by the State Liaison Officer appointed by the Governor for the implementation of the National Historic Preservation Program in Texas and have been entered into the National Register of Historic Places. Senator John G. Tower and the appropriate Representatives have also been provided with this information. By copy of this letter, the State Liaison Officer, Mr. Truett Latimer, Executive Director, Texas State Historical Survey Committee, 108 West 15th Street, Austin, Texas 78701, has likewise been notified. A leaflet explaining the National Register is enclosed.

Sincerely yours,

(Sgd) Thomas F. Flynn

DEPUTY Director

Enclosures

Entered in the National Register

JUN 22 1970

cc:
Mr. Truett Latimer, Executive Director, Texas State Historical Survey Committee, 108 West 15th Street, Austin, Texas 78701

Duplicate letter sent to: Hon. John G. Tower
United States Senate
Washington, D. C.

cc: Director, Southwest Region
Mr. Charles Sleen, Southwestern Regional Office
LL-Mr. Melvin
T
HR
RGamble:mm
6/22/70

6/20/27
4/22/27

Properties added to the National Register of Historical Places

TEXAS

Texas State Capitol Building	Austin, Texas
Waco Suspension Bridge	Waco, Texas
Winedale Inn	Winedale, Texas